

CONTRACT NO. 62417

FAP R/L	SECTION	COUNTY	TOTAL SHEETS	SHEET NO.
338	(113 & 114) R-5	WILL	525	93
STA. 3246+00	TO STA. 3260+00			
FED. ROAD DIST. NO.	DISTRICT	FAP 338 (IL RTE. 59)		

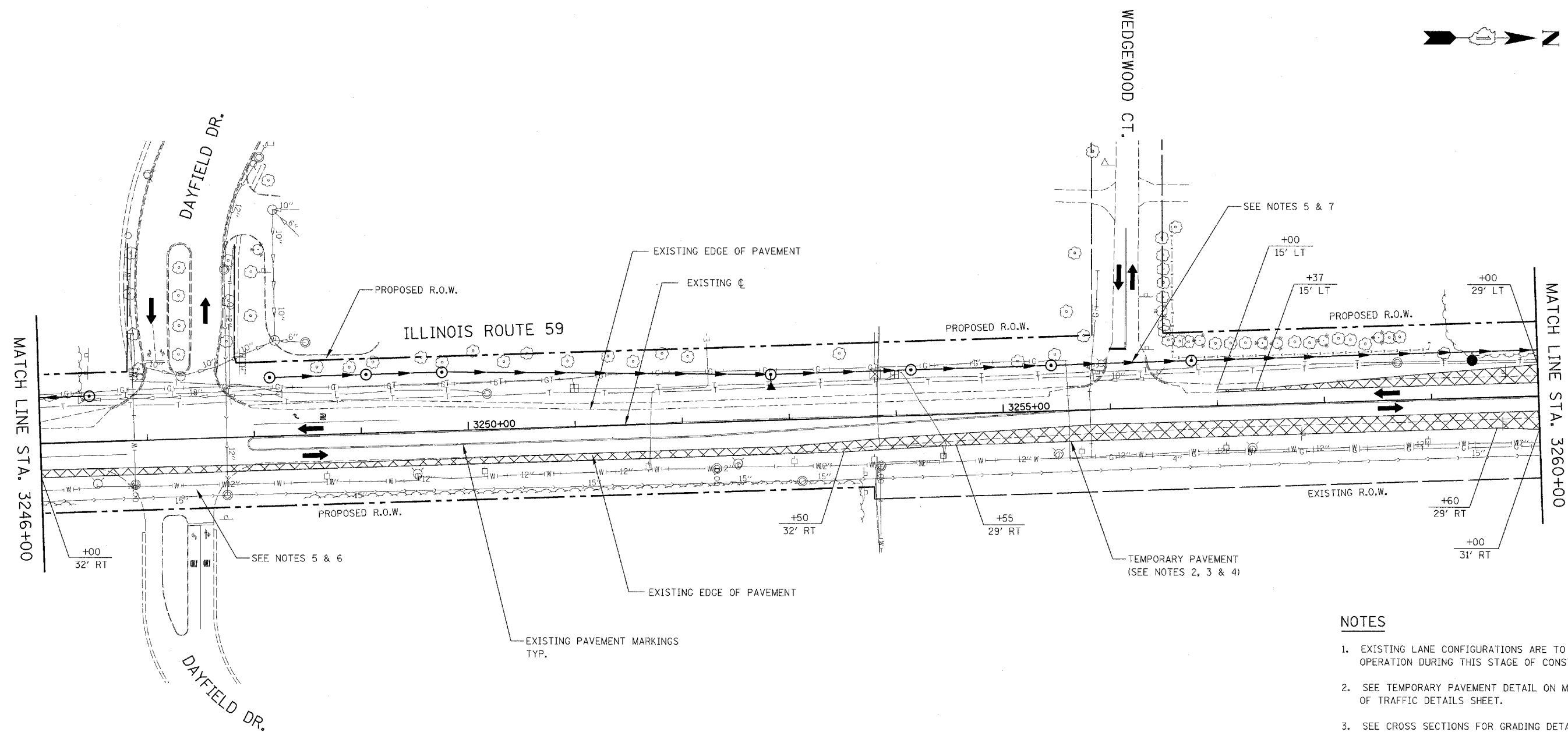

FOR TEMPORARY PAVEMENT CONSTRUCTION  
 USE HIGHWAY STANDARDS NO. 701326 & 701701  
  
 FOR STORM SEWER AND WATER MAIN CONSTRUCTION  
 USE HIGHWAY STANDARDS NO. 701001, 701006 & 701011

**NOTES**

1. EXISTING LANE CONFIGURATIONS ARE TO REMAIN IN OPERATION DURING THIS STAGE OF CONSTRUCTION.
2. SEE TEMPORARY PAVEMENT DETAIL ON MAINTENANCE OF TRAFFIC DETAILS SHEET.
3. SEE CROSS SECTIONS FOR GRADING DETAILS.
4. SEE MAINTENANCE OF TRAFFIC GENERAL NOTE 25.
5. SEE MAINTENANCE OF TRAFFIC GENERAL NOTE 26.
6. WHEN DIRECTED BY THE ENGINEER, 2" OF HMA SURFACE COURSE SHALL BE PLACED OVER TEMPORARY AGGREGATE. THIS WORK SHALL BE PAID FOR AT THE CONTRACT UNIT PRICE FOR HMA SURFACE COURSE, MIX "C", N50.
7. SEE MAINTENANCE OF TRAFFIC GENERAL NOTE 27.

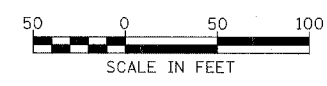

ILLINOIS DEPARTMENT OF TRANSPORTATION  
 DISTRICT NO. 1 SCHAUMBURG  
 STAGING PLANS  
 ILLINOIS ROUTE 59  
 PRE-STAGE 1

SCALE AS SHOWN      DRAWN BY REW  
 DATE MARCH 18, 2008      CHECKED BY JCM