

FAP DIST.	SECTION	COUNTY	TOTAL SHEETS	SHEET NO.
338 (113 & 114) R-5	WILL		525	104
STA. 3330+00 TO STA. 3337+00				
FED. ROAD DIST. NO.	ILLINOIS	FAP 338 (IL RTE. 59)		

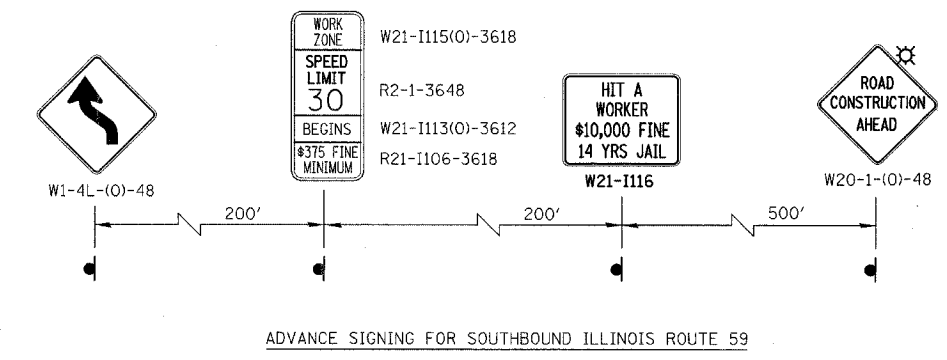
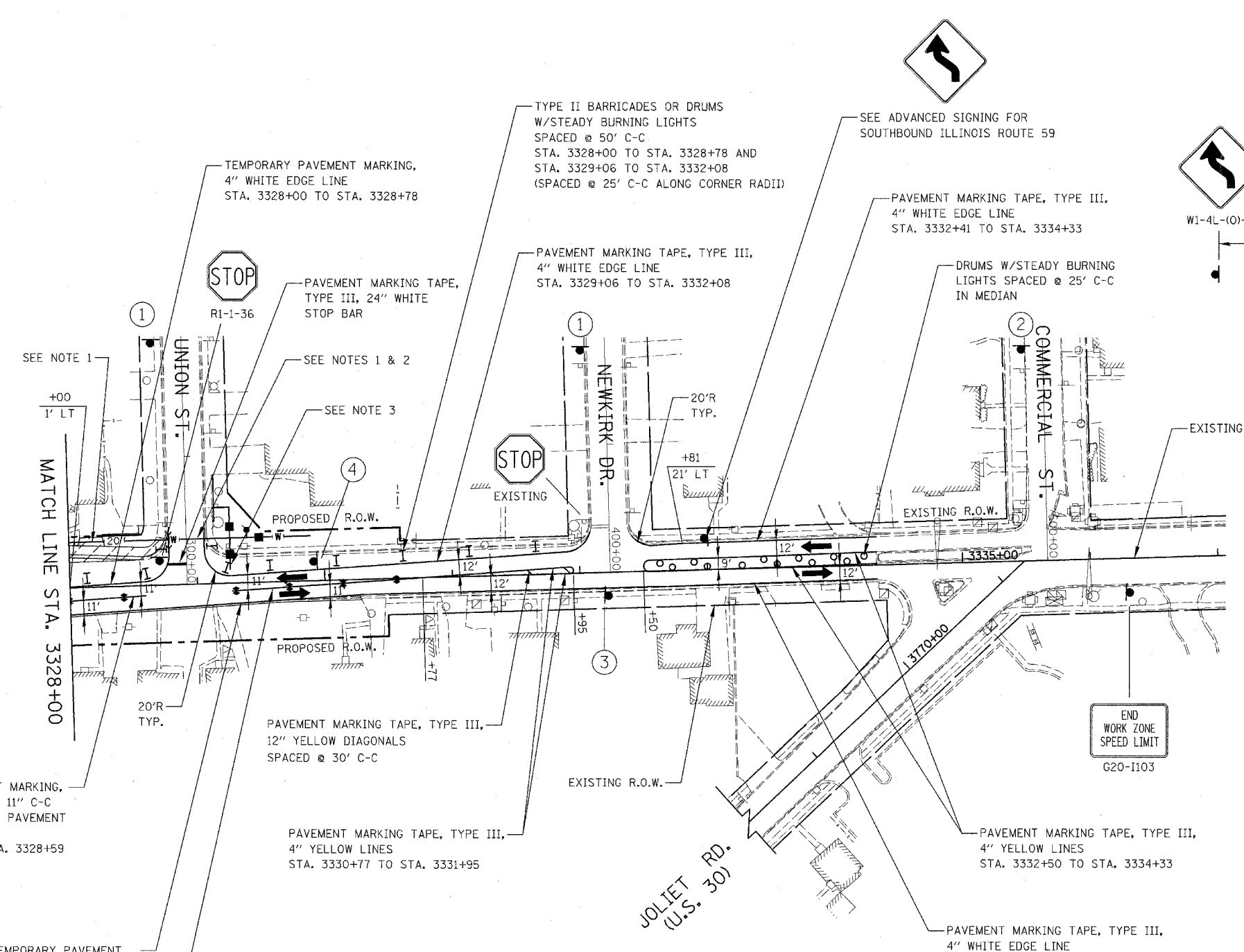
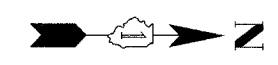

TEMPORARY PAVEMENT MARKING,
4" DOUBLE YELLOW @ 11" C-C
W/TEMPORARY RAISED PAVEMENT
MARKERS @ 40' C-C
STA. 3328+00 TO STA. 3328+59

EDGE OF TEMPORARY PAVEMENT
PLACED IN PREVIOUS STAGE, TYP.

PAVEMENT MARKING TAPE, TYPE III,
4" DOUBLE YELLOW @ 11" C-C
W/ TEMPORARY RAISED PAVEMENT
MARKERS @ 40' C-C
STA. 3329+27 TO STA. 3330+77

SIGN LEGEND

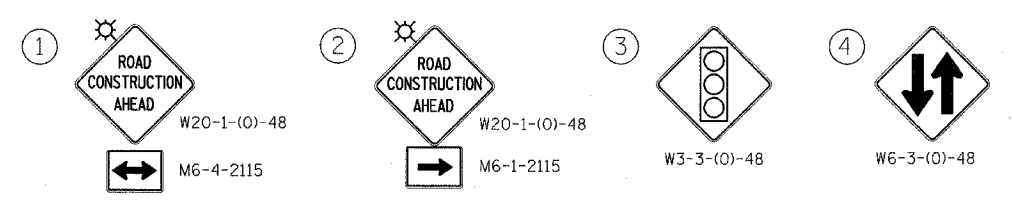

NOTES

1. SEE MAINTENANCE OF TRAFFIC GENERAL NOTE 26.
2. SEE MAINTENANCE OF TRAFFIC GENERAL NOTES 27, 29 & 30.
3. SEE MAINTENANCE OF TRAFFIC GENERAL NOTES 27 & 34.
4. SEE MAINTENANCE OF TRAFFIC GENERAL NOTES 35 & 36.

ILLINOIS DEPARTMENT OF TRANSPORTATION
DISTRICT NO. 1 SCHAUMBURG
STAGING PLANS
ILLINOIS ROUTE 59
STAGE 1

SCALE AS SHOWN
DATE MARCH 18, 2008
DRAWN BY REW
CHECKED BY JCM

