

FAP NO.	SECTION	COUNTY	TOTAL SHEETS	SHEET NO.
338	(113 & 114) R-5	WILL	525	107
STA.	3190+00	TO STA.	3204+00	
FED. ROAD DIST. NO.	ILLINOIS		FAP 338 (IL RTE. 59)	

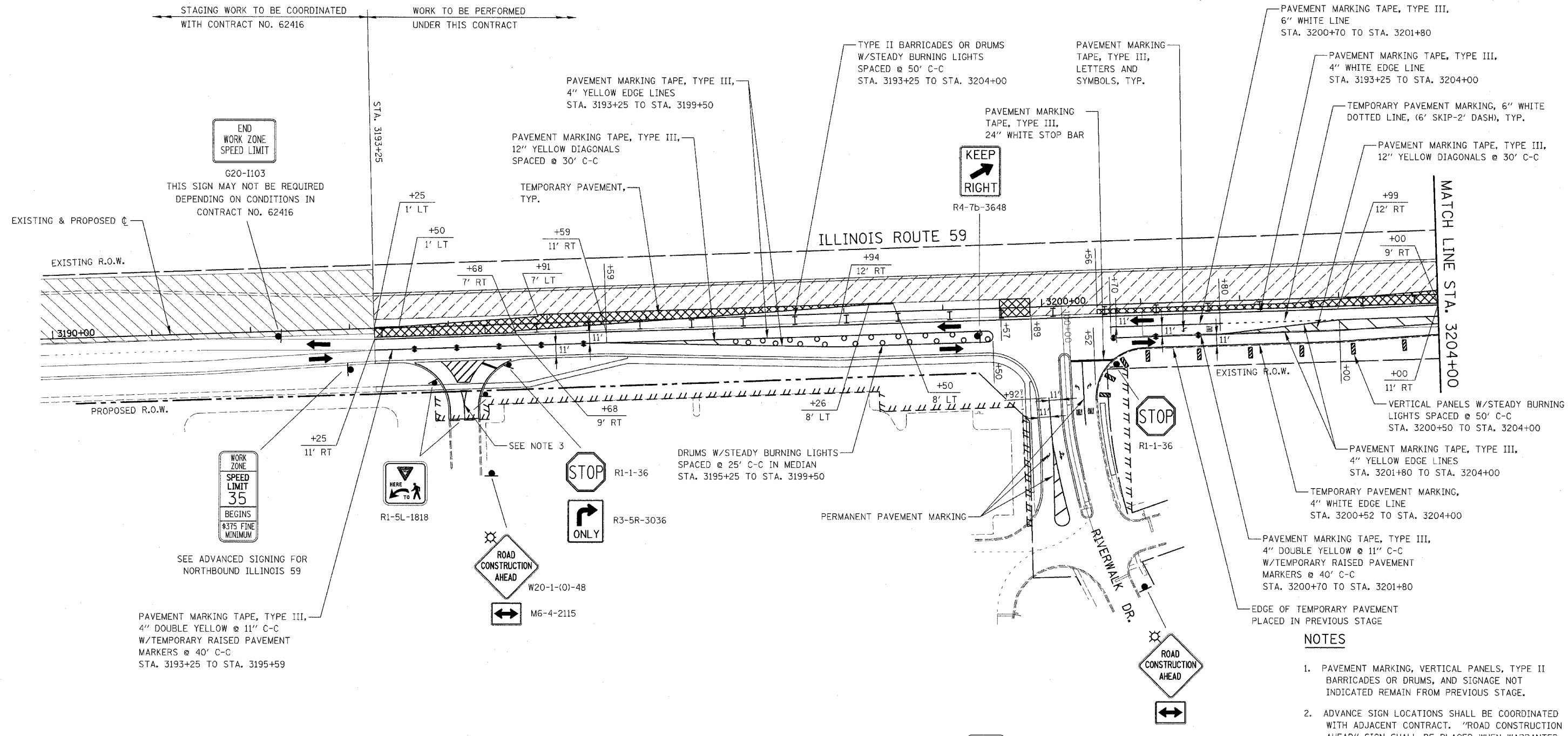

STAGING WORK TO BE COORDINATED WITH CONTRACT NO. 62416
 WORK TO BE PERFORMED UNDER THIS CONTRACT



END WORK ZONE SPEED LIMIT
 G20-1103
 THIS SIGN MAY NOT BE REQUIRED DEPENDING ON CONDITIONS IN CONTRACT NO. 62416

WORK ZONE SPEED LIMIT 35
 BEGINS #375 FINE MINIMUM

SEE ADVANCED SIGNING FOR NORTHBOUND ILLINOIS 59

PAVEMENT MARKING TAPE, TYPE III, 4" DOUBLE YELLOW @ 11" C-C W/TEMPORARY RAISED PAVEMENT MARKERS @ 40' C-C STA. 3193+25 TO STA. 3195+59

PAVEMENT MARKING TAPE, TYPE III, 4" YELLOW EDGE LINES STA. 3193+25 TO STA. 3199+50

PAVEMENT MARKING TAPE, TYPE III, 12" YELLOW DIAGONALS SPACED @ 30' C-C

TEMPORARY PAVEMENT, TYP.

TYPE II BARRICADES OR DRUMS W/STEADY BURNING LIGHTS SPACED @ 50' C-C STA. 3193+25 TO STA. 3204+00

PAVEMENT MARKING TAPE, TYPE III, LETTERS AND SYMBOLS, TYP.

PAVEMENT MARKING TAPE, TYPE III, 24" WHITE STOP BAR

PAVEMENT MARKING TAPE, TYPE III, 6" WHITE LINE STA. 3200+70 TO STA. 3201+80

PAVEMENT MARKING TAPE, TYPE III, 4" WHITE EDGE LINE STA. 3193+25 TO STA. 3204+00

TEMPORARY PAVEMENT MARKING, 6" WHITE DOTTED LINE, (6' SKIP-2" DASH), TYP.

PAVEMENT MARKING TAPE, TYPE III, 12" YELLOW DIAGONALS @ 30' C-C

+25 1' LT

+50 1' LT

+59 11' RT

+68 7' RT

+91 7' LT

+94 12' RT

+56

+170

+08

+99 12' RT

+00 9' RT

+00 11' RT

+00

+00

+00

+00

+00

+00

+00

+00

+00

+00

+00

+00

+00

+00

+00

+00

+00

+00

+00

+00

+00

LEGEND

- CONSTRUCTION WORK ZONE
- TEMPORARY PAVEMENT PLACED IN THIS STAGE
- DIRECTION OF TRAFFIC
- TYPE II BARRICADES OR DRUMS
- CHANNELIZATION DRUM
- VERTICAL PANEL WITH STEADY BURNING LIGHT
- SIGN LOCATION
- TYPE III BARRICADE LOCATION
- FLASHING YELLOW LIGHT
- TEMPORARY RAISED REFLECTIVE PAVEMENT MARKER

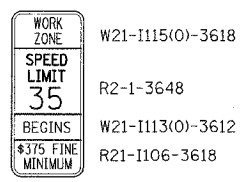

ADVANCE SIGNING FOR NORTHBOUND ILLINOIS 59 (SEE NOTES 2 & 4)

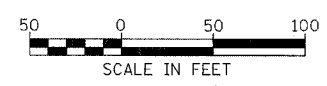

NOTES

1. PAVEMENT MARKING, VERTICAL PANELS, TYPE II BARRICADES OR DRUMS, AND SIGNAGE NOT INDICATED REMAIN FROM PREVIOUS STAGE.
2. ADVANCE SIGN LOCATIONS SHALL BE COORDINATED WITH ADJACENT CONTRACT. "ROAD CONSTRUCTION AHEAD" SIGN SHALL BE PLACED WHEN WARRANTED BY WORK ZONE CONDITIONS OR AS DIRECTED BY THE ENGINEER.
3. PERMANENT PAVEMENT MARKING ON MALL ENTRANCE
4. SEE MAINTENANCE OF TRAFFIC GENERAL NOTES 35 & 36.

ILLINOIS DEPARTMENT OF TRANSPORTATION
 DISTRICT NO. 1 SCHAUMBURG
 STAGING PLANS
 ILLINOIS ROUTE 59
 STAGE 1A

SCALE AS SHOWN
 DATE MARCH 18, 2008
 DRAWN BY REW
 CHECKED BY JCM