

FAP R/O	SECTION	COUNTY	TOTAL SHEETS	SHEET NO.
338	(113 & 114) R-5	WILL	525	126
STA. 3316+00	TO STA. 3328+00			
FED. ROAD DIST. NO.	ILLINOIS	FAP 338 (IL RTE. 59)		

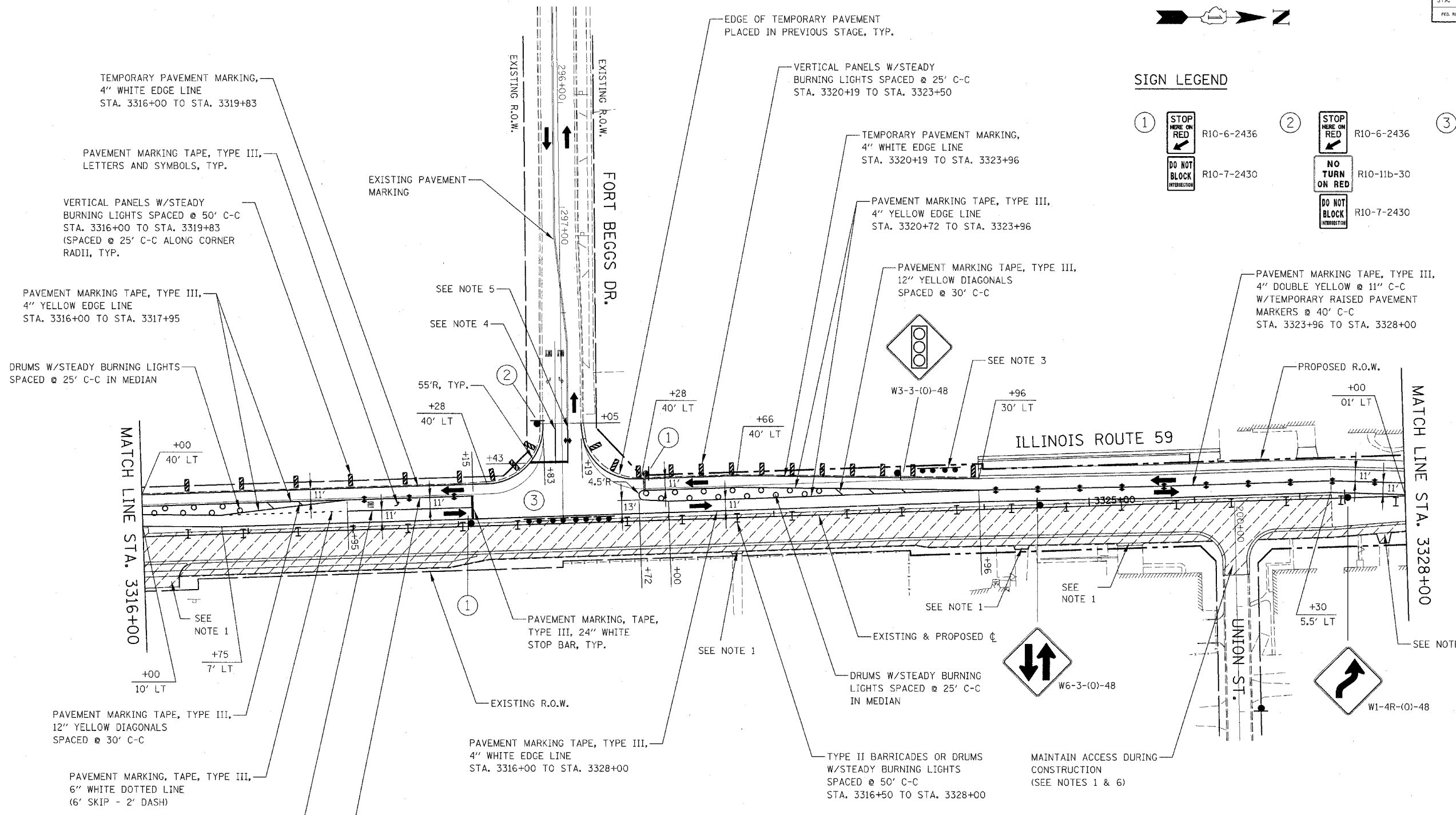

**SIGN LEGEND**

- ① R10-6-2436  
 R10-7-2430
- ② R10-6-2436  
 R10-11b-30  
 R10-7-2430
- ③ W1-7 (0) 3618 ABOVE TYPE III BARRICADE



**NOTES**

1. SEE MAINTENANCE OF TRAFFIC GENERAL NOTE 26.
2. PAVEMENT MARKING, VERTICAL PANELS, TYPE II BARRICADES OR DRUMS, AND SIGNAGE NOT INDICATED REMAIN FROM PREVIOUS STAGE.
3. DRIVEWAY CLOSED AT THE RIGHT-OF-WAY IN PREVIOUS STAGE, TO REMAIN CLOSED IN THIS STAGE.
4. PAVEMENT MARKING TAPE, TYPE III, 6" WHITE LINE, STA. 299+05 TO STA. 299+43.
5. PAVEMENT MARKING TAPE, TYPE III, 4" DOUBLE YELLOW @ 11" C-C, W/TEMPORARY RAISED PAVEMENT MARKERS, STA. 299+05 TO STA. 299+43.
6. SEE MAINTENANCE OF TRAFFIC GENERAL NOTES 31, 32 & 33.
7. SEE MAINTENANCE OF TRAFFIC GENERAL NOTES 35 & 36.

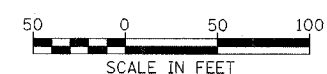

Rev. 05-01-08 JCM

ILLINOIS DEPARTMENT OF TRANSPORTATION  
DISTRICT NO. 1 SCHAUMBURG

**STAGING PLANS  
ILLINOIS ROUTE 59  
STAGE 2**

SCALE AS SHOWN DATE MARCH 18, 2008 DRAWN BY REW CHECKED BY JCM