

FAP NO.	SECTION	COUNTY	TOTAL SHEETS	SHEET NO.
338	(113 & 114) R-5	WILL	525	145
STA. 3288+00		TO STA. 3302+00		
FED. ROAD DIST. NO.		ILLINOIS	FAP 338 (IL RTE. 59)	

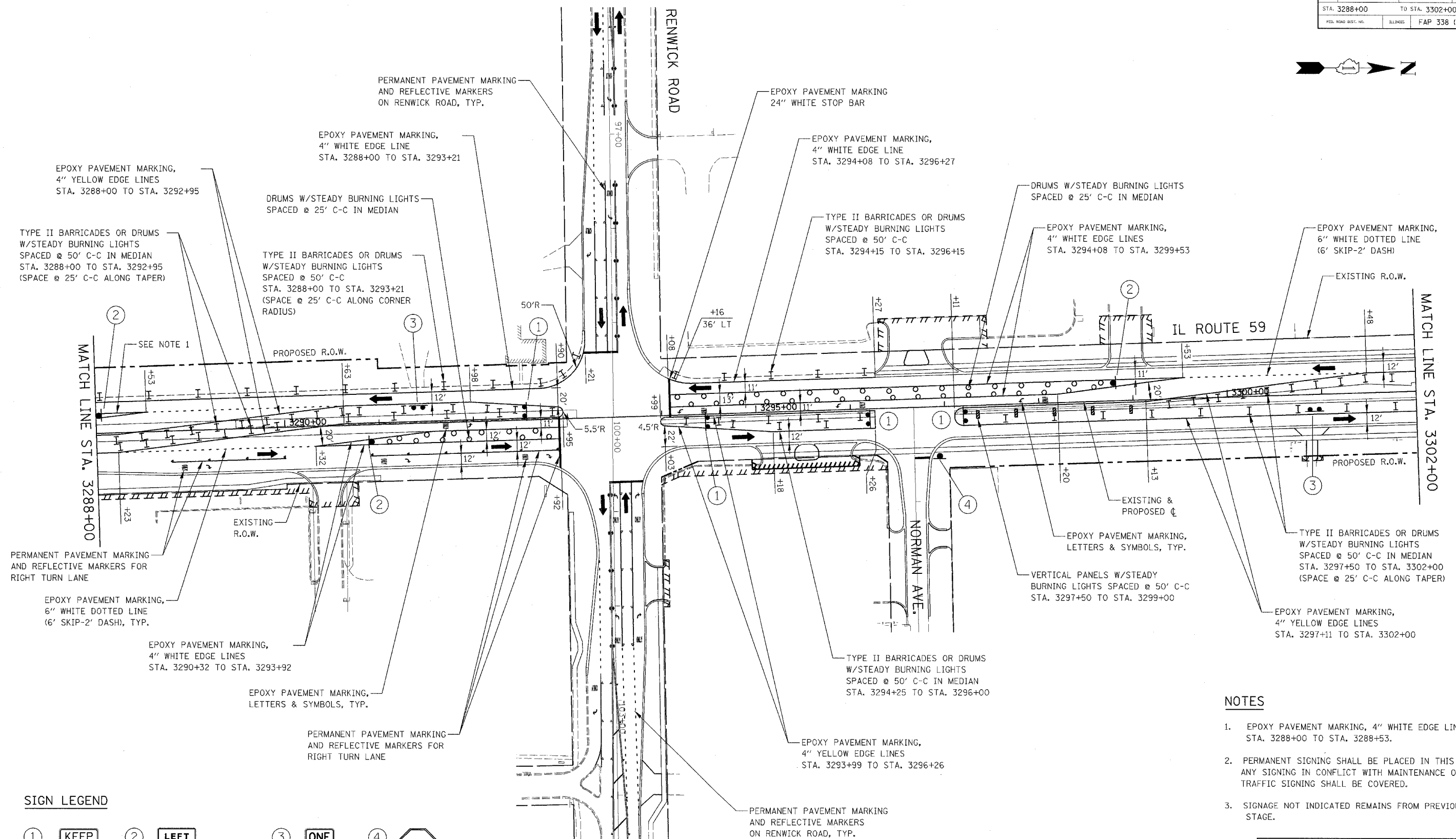
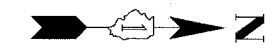

SIGN LEGEND

- ① R4-7b-3648 ON TYPE III BARRICADE
- ② R3-I100-2424 M6-2L-2115
- ③ R6-2R-2430 ON TYPE III BARRICADE
- ④ R1-1-36 R3-2-24

NOTES

1. EPOXY PAVEMENT MARKING, 4" WHITE EDGE LINES, STA. 3288+00 TO STA. 3288+53.
2. PERMANENT SIGNING SHALL BE PLACED IN THIS STAGE. ANY SIGNING IN CONFLICT WITH MAINTENANCE OF TRAFFIC SIGNING SHALL BE COVERED.
3. SIGNAGE NOT INDICATED REMAINS FROM PREVIOUS STAGE.

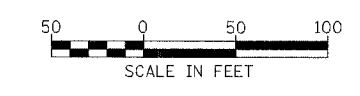

ILLINOIS DEPARTMENT OF TRANSPORTATION
 DISTRICT NO. 1 SCHAUMBURG
STAGING PLANS
 ILLINOIS ROUTE 59
 WINTER SHUTDOWN

SCALE AS SHOWN DATE MARCH 18, 2008
 DRAWN BY REW CHECKED BY JCM