

CONTRACT NO. 62417

FAP NO.	SECTION	COUNTY	TOTAL SHEETS	SHEET NO.
338	(113 & 114) R-5	WILL	525	148
STA. 3328+00		TO STA. 3337+00		
FED. ROAD DIST. NO.		ILLINOIS	FAP 338 (IL RTE. 59)	

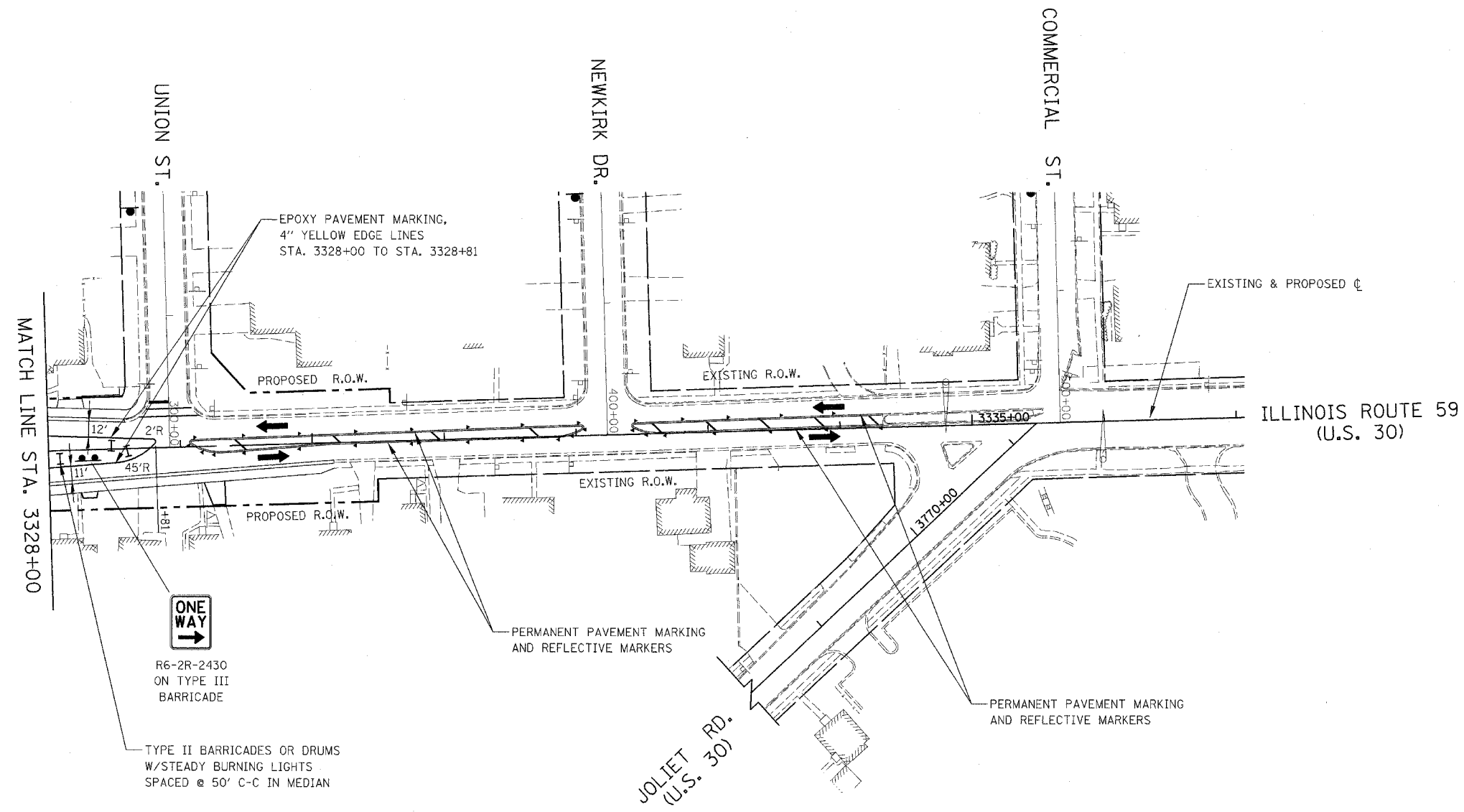

**NOTES**

1. PERMANENT SIGNING SHALL BE PLACED IN THIS STAGE. ANY SIGNING IN CONFLICT WITH MAINTENANCE OF TRAFFIC SIGNING SHALL BE COVERED.
2. SIGNAGE NOT INDICATED REMAINS FROM PREVIOUS STAGE.

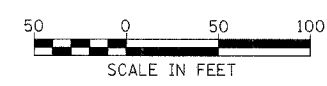

ILLINOIS DEPARTMENT OF TRANSPORTATION  
DISTRICT NO. 1 SCHAUMBURG  
STAGING PLANS  
ILLINOIS ROUTE 59  
WINTER SHUTDOWN

SCALE AS SHOWN  
DATE MARCH 18, 2008

DRAWN BY REW  
CHECKED BY JCM