

CONTRACT NO. 62417

FAP NO.	SECTION	COUNTY	TOTAL SHEETS	SHEET NO.
338	(113 & 114) R-5	WILL	525	159
STA.	3246+00	TO STA.	3260+00	
FED. ROAD DIST. NO.	ILLINOIS	FAP 338 (ILL. RTE. 59)		

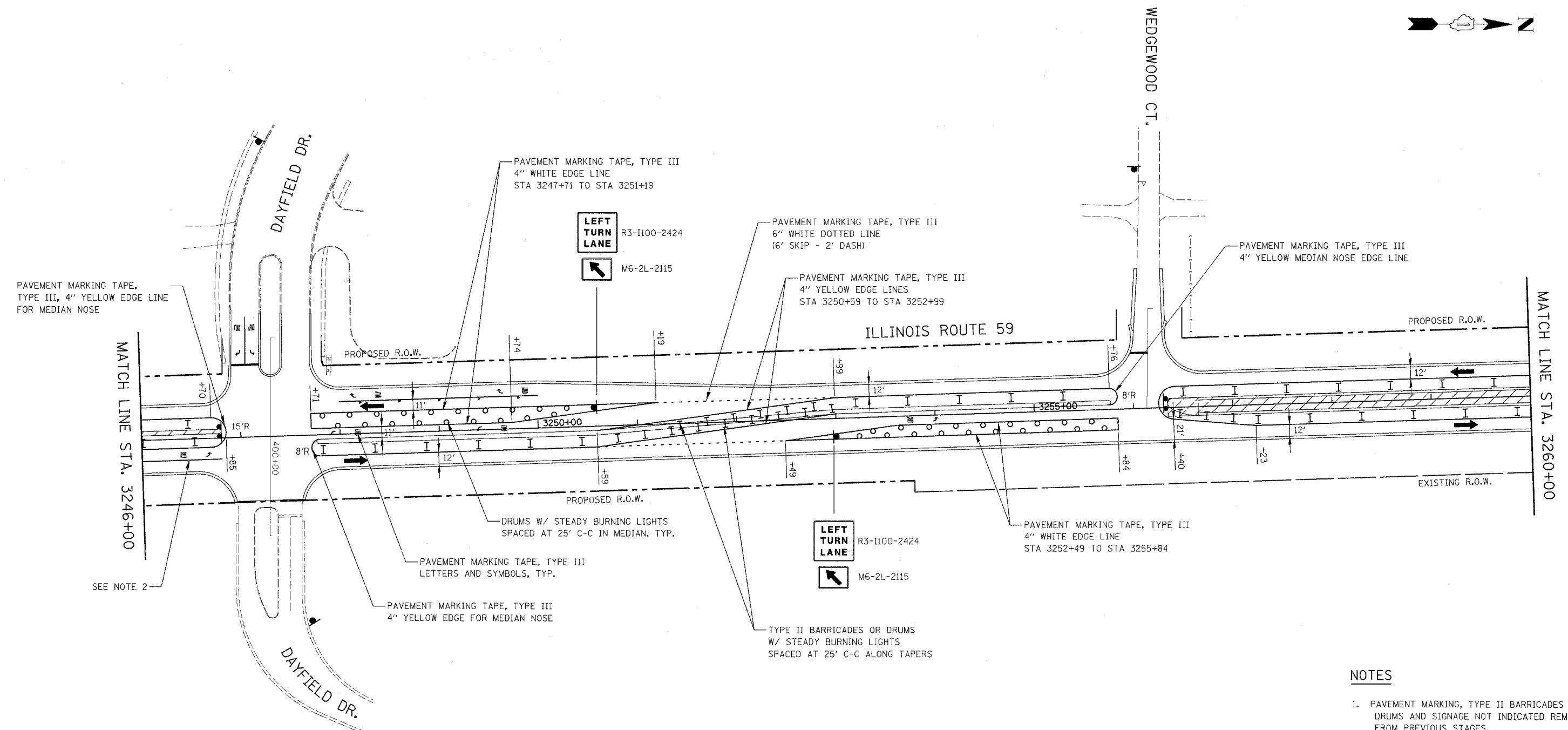

NOTES

1. PAVEMENT MARKING, TYPE II BARRICADES OR DRUMS AND SIGNAGE NOT INDICATED REMAIN FROM PREVIOUS STAGES.
2. PAVEMENT MARKING, TAPE, TYPE III, 4" WHITE EDGE LINE AND LETTERS & SYMBOLS, STA. 3246+00 TO STA. 3246+85, PROVIDE DRUMS W/STEADY BURNING LIGHTS SPACED @ 25' C-C IN MEDIAN.

ILLINOIS DEPARTMENT OF TRANSPORTATION
 DISTRICT NO. 1 SCHAUMBURG
 STAGING PLANS
 ILLINOIS ROUTE 59
 STAGE 3A

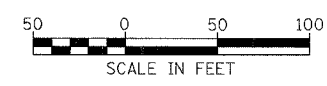

SCALE AS SHOWN
 DATE MARCH 18, 2008
 DRAWN BY REW
 CHECKED BY JCM