

FAP NO.	SECTION	COUNTY	TOTAL SHEETS	SHEET NO.
338	(113 & 114) R-5	WILL	525	189
STA. 3274+00		TO STA. 3288+00		
FED. ROAD DIST. NO.	ILLINOIS	FAP 338 (IL RTE. 59)		

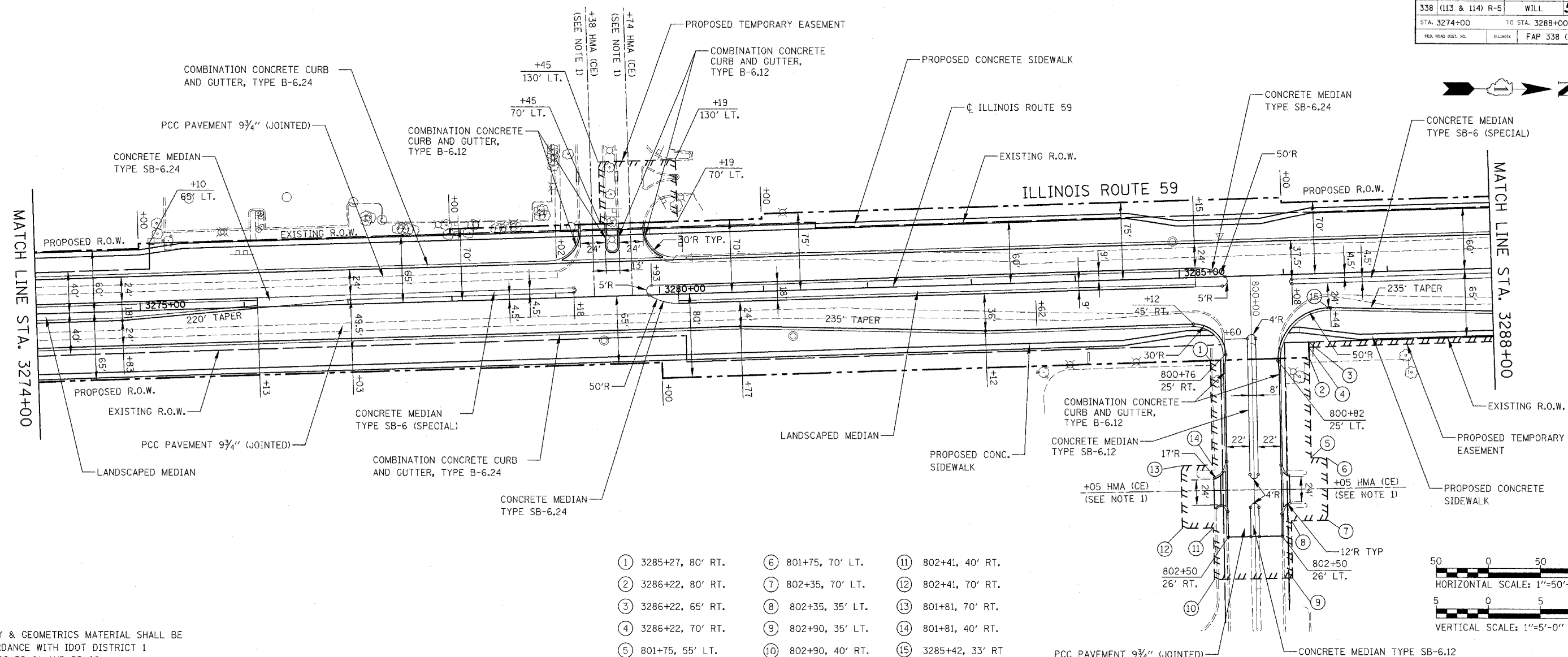

- ① 3285+27, 80' RT.
- ② 3286+22, 80' RT.
- ③ 3286+22, 65' RT.
- ④ 3286+22, 70' RT.
- ⑤ 801+75, 55' LT.
- ⑥ 801+75, 70' LT.
- ⑦ 802+35, 70' LT.
- ⑧ 802+35, 35' LT.
- ⑨ 802+90, 35' LT.
- ⑩ 802+90, 40' RT.
- ⑪ 802+41, 40' RT.
- ⑫ 802+41, 70' RT.
- ⑬ 801+81, 70' RT.
- ⑭ 801+81, 40' RT.
- ⑮ 3285+42, 33' RT.

NOTES:
 1. DRIVEWAY & GEOMETRICS MATERIAL SHALL BE IN ACCORDANCE WITH IDOT DISTRICT 1 STANDARDS BD-01 AND BD-02.

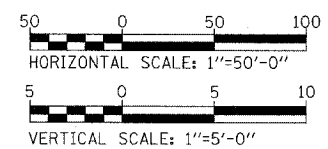

DATE	BY
DATE	BY
DATE	BY

DATE	BY
DATE	BY
DATE	BY

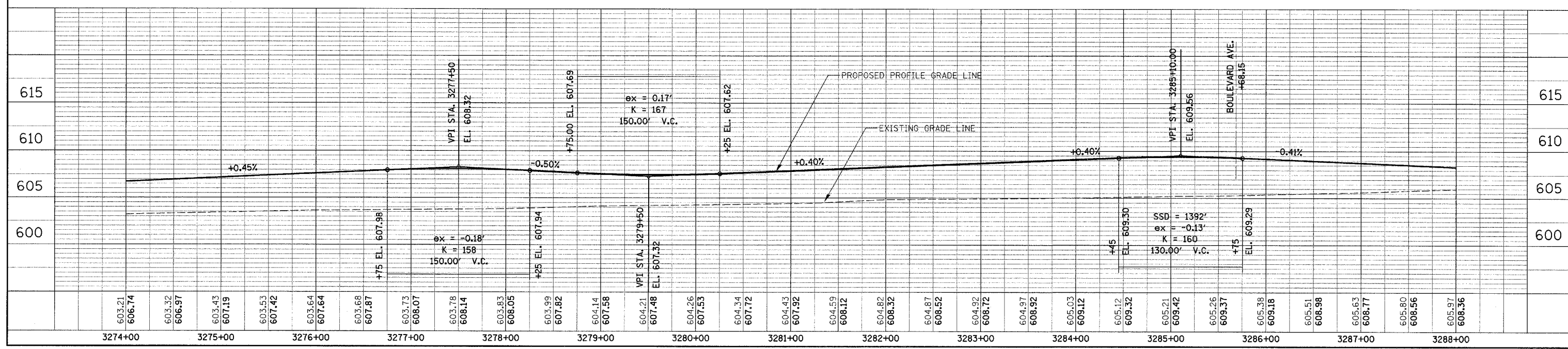

PLAN /PROFILE - ILLINOIS ROUTE 59