

SECTION	COUNTY	TOTAL SHEETS	SHEET NO.
338 (113 & 114) R-5	WILL	525	191
STA. 3302+00 TO STA. 3316+00		FAP 338 (IL RTE. 59)	

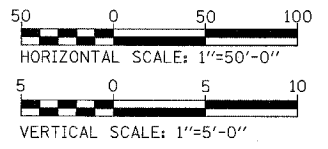
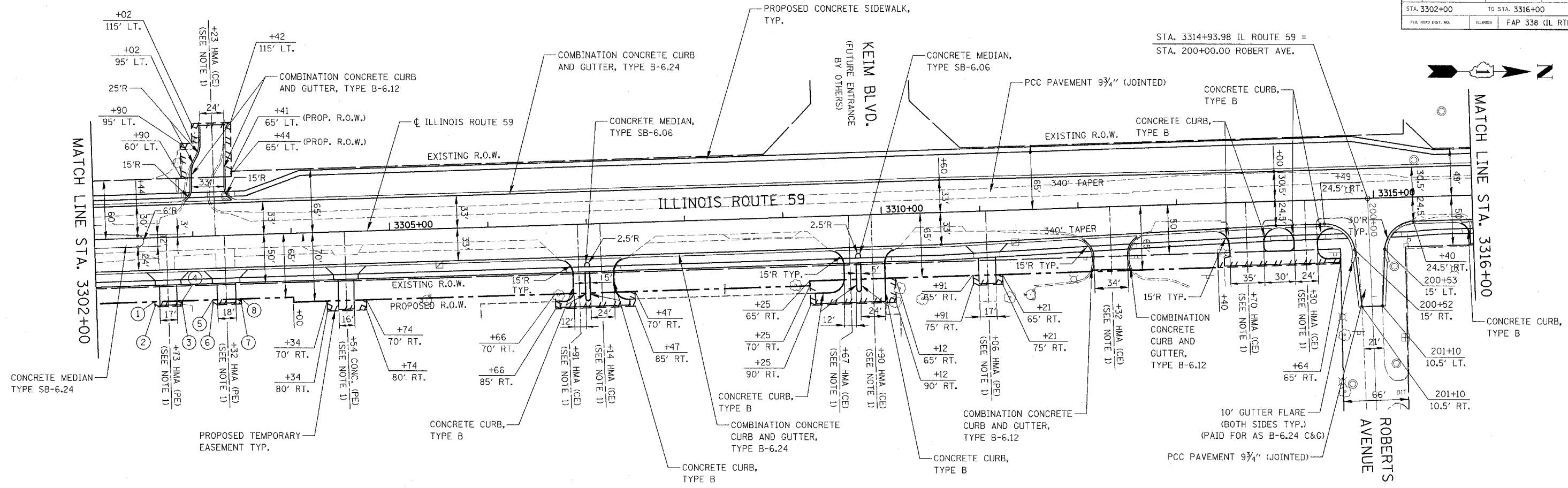

- ① 3302+59, 65' RT.
- ② 3302+59, 70' RT.
- ③ 3302+87, 70' RT.
- ④ 3302+87, 65' RT.
- ⑤ 3303+18, 65' RT.
- ⑥ 3303+18, 70' RT.
- ⑦ 3303+47, 70' RT.
- ⑧ 3303+47, 65' RT.

NOTES:

1. DRIVEWAY & GEOMETRICS MATERIAL SHALL BE IN ACCORDANCE WITH IDOT DISTRICT 1 STANDARDS BD-01 AND BD-02.

