

FAP NO.	SECTION	COUNTY	TOTAL SHEETS	SHEET NO.
338	(113 & 114) R-5	WILL	525	249
STA.	TO STA.			
	FAP 338 (IL RTE. 59)			

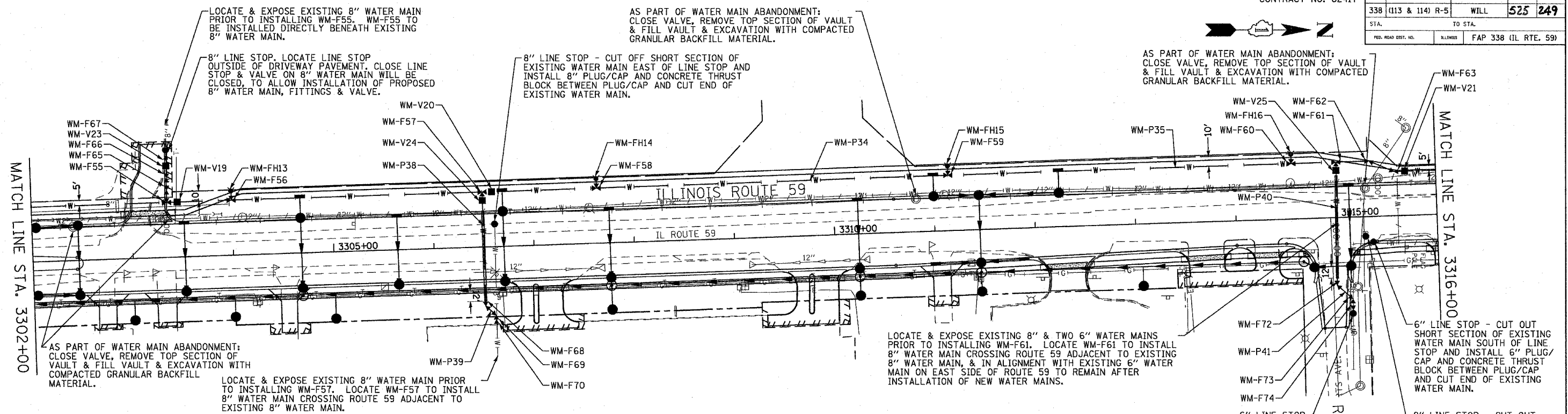

- WM-P33 NOT USED
- WM-P34 1,300 L.F. OF 20" WATER MAIN
NOTE: 1,300 L.F. CONSISTS OF 1,250 L.F. INSTALLED IN OPEN CUT TRENCH & FIVE (5) 10 L.F. LENGTHS INSTALLED INSIDE 36" CASING PIPE IN OPEN CUT TRENCH UNDER FIVE PROPOSED CATCH BASINS. PROVIDE 20" RJT PIPE INSIDE CASING PIPES IF JOINT(S) WILL BE LOCATED WITHIN CASING PIPE.
- WM-P35 105 L.F. OF 20" WATER MAIN (RJT)
- WM-P36 NOT USED
- WM-P37 20 L.F. OF 8" WATER MAIN (RJT)
- WM-P38 90 L.F. OF 8" WATER MAIN (RJT) INSIDE 24" CASING PIPE
A MINIMUM OF 50 L.F. OF CASING TO BE INSTALLED BY BORING OR RAMMING, REMAINDER OF CASING CAN BE INSTALLED IN OPEN-CUT TRENCH.

- WM-P39 40 L.F. OF 8" WATER MAIN (RJT) PROVIDE A MINIMUM OF 10 L.F. OF 8" RJT PIPE BETWEEN WM-F69 & WM-F70.
- WM-P40 105 L.F. OF 8" WATER MAIN (RJT) INSIDE 24" CASING PIPE
A MINIMUM OF 70 L.F. OF CASING TO BE INSTALLED BY BORING OR RAMMING, REMAINDER OF CASING CAN BE INSTALLED IN OPEN-CUT TRENCH.
- WM-P41 30 L.F. OF 8" WATER MAIN (RJT) PROVIDE A MINIMUM OF 10 L.F. OF 8" RJT PIPE BETWEEN WM-F73 & WM-F74.
- WM-P42 NOT USED

WATER MAIN FITTINGS (RJT)

- WM-F54 NOT USED
- WM-F55 20" x 8" TEE WITH TEMPORARY 8" PLUG
- WM-F56 20" x 6" TANGENTIAL WELDED-ON OUTLET TEE
- WM-F57 20" x 8" TEE
- WM-F58 20" x 6" TANGENTIAL WELDED-ON OUTLET TEE
- WM-F59 20" x 6" TANGENTIAL WELDED-ON OUTLET TEE
- WM-F60 20" x 6" TANGENTIAL WELDED-ON OUTLET TEE
- WM-F61 20" x 8" TEE
- WM-F62 20" - 22 1/2° BEND

WATER MAIN VALVES

- WM-F63 20" - 22 1/2° BEND
- WM-F64 NOT USED
- WM-F65 8" - 45° BEND ROLLED UP
- WM-F66 8" - 45° BEND ROLLED DOWN
- WM-F67 8" CUTTING-IN SLEEVE
- WM-F68 8" - 45° BEND ROLLED UP
- WM-F69 8" - 45° BEND ROLLED DOWN
- WM-F70 8" CUTTING-IN SLEEVE
- WM-F71 NOT USED

WATER MAIN VALVES

- WM-V19 20" BUTTERFLY VALVE IN 6 FOOT DIAMETER VALVE VAULT WITH ECCENTRIC CONE. LOCATE ECCENTRIC CONE WITH OPENING CENTERED OVER VALVE OPERATING NUT.
- WM-V20 20" BUTTERFLY VALVE IN 6 FOOT DIAMETER VALVE VAULT WITH ECCENTRIC CONE. LOCATE ECCENTRIC CONE WITH OPENING CENTERED OVER VALVE OPERATING NUT.
- WM-V21 20" BUTTERFLY VALVE IN 6 FOOT DIAMETER VALVE VAULT WITH ECCENTRIC CONE. LOCATE ECCENTRIC CONE WITH OPENING CENTERED OVER VALVE OPERATING NUT.
- WM-V22 NOT USED
- WM-V23 8" GATE VALVE IN 4 FOOT DIAMETER VALVE VAULT
- WM-V24 8" GATE VALVE IN 4 FOOT DIAMETER VALVE VAULT
- WM-V25 8" GATE VALVE IN 4 FOOT DIAMETER VALVE VAULT
- WM-V26 NOT USED

FIRE HYDRANTS

- WM-FH13 FIRE HYDRANT WITH 8 L.F. OF 6" D.I. LEADER PIPE
- WM-FH14 FIRE HYDRANT WITH 8 L.F. OF 6" D.I. LEADER PIPE
- WM-FH15 FIRE HYDRANT WITH 8 L.F. OF 6" D.I. LEADER PIPE
- WM-FH16 FIRE HYDRANT WITH 8 L.F. OF 6" D.I. LEADER PIPE

NOTE: INSTALL FIRE HYDRANTS 2 FEET WEST OF WEST RIGHT-OF-WAY LINE.

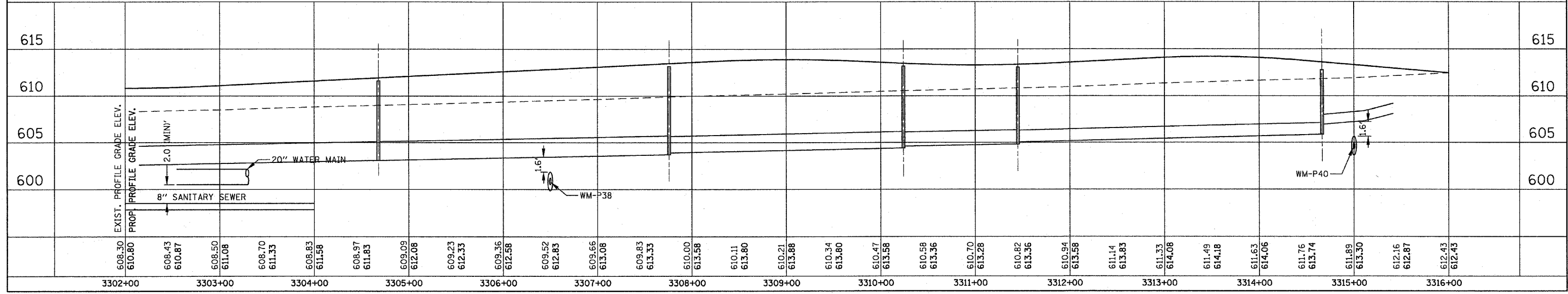
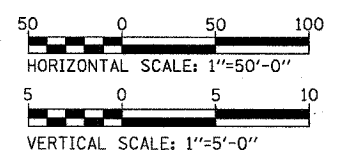
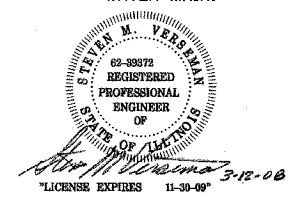

WATER MAIN AND SANITARY SEWER REPLACEMENT PLAN /PROFILE - ILLINOIS ROUTE 59