

| FAP NO. | SECTION | COUNTY | TOTAL SHEETS | SHEET NO. |
|---------------------|-----------------|-----------------|----------------------|-----------|
| 338 | (113 & 114) R-5 | WILL | 525 | 319 |
| STA. 3316+00 | | TO STA. 3330+00 | | |
| FID. ROAD DIST. NO. | | ILLINOIS | FAP 338 (IL RTE. 59) | |

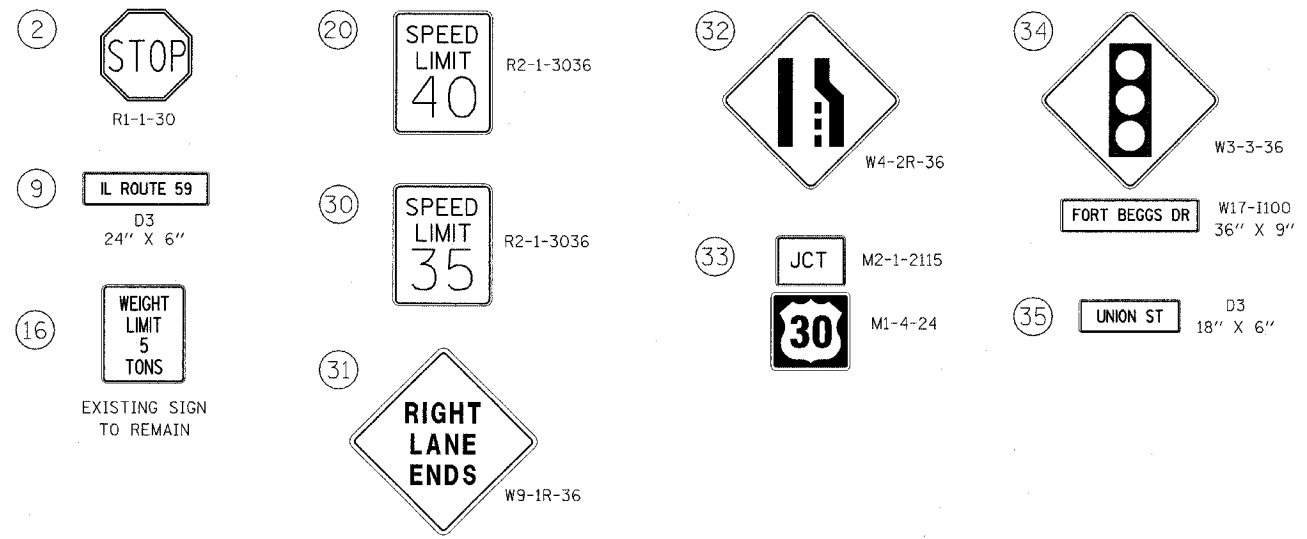

- NOTES:**
- PAVEMENT MARKINGS AND RAISED REFLECTIVE PAVEMENT MARKINGS SHALL BE PLACED IN ACCORDANCE WITH IDOT DISTRICT 1 DETAILS TC-11 AND TC-13.
 - SIGN LOCATIONS MAY VARY BASED ON FIELD CONDITIONS.
 - EXISTING SIGN TO BE REMOVED AND RE-ERECTED.
 - SIGN SHALL BE MOUNTED ON A TELESCOPING STEEL SIGN SUPPORT IN ACCORDANCE WITH HIGHWAY STANDARDS 720001 AND 728001.

ILLINOIS DEPARTMENT OF TRANSPORTATION
DISTRICT NO. 1 SCHAUMBURG
**PAVEMENT MARKING
AND SIGNING PLANS**

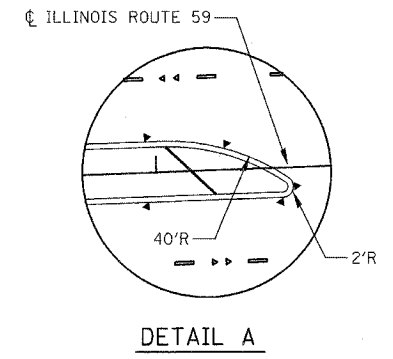
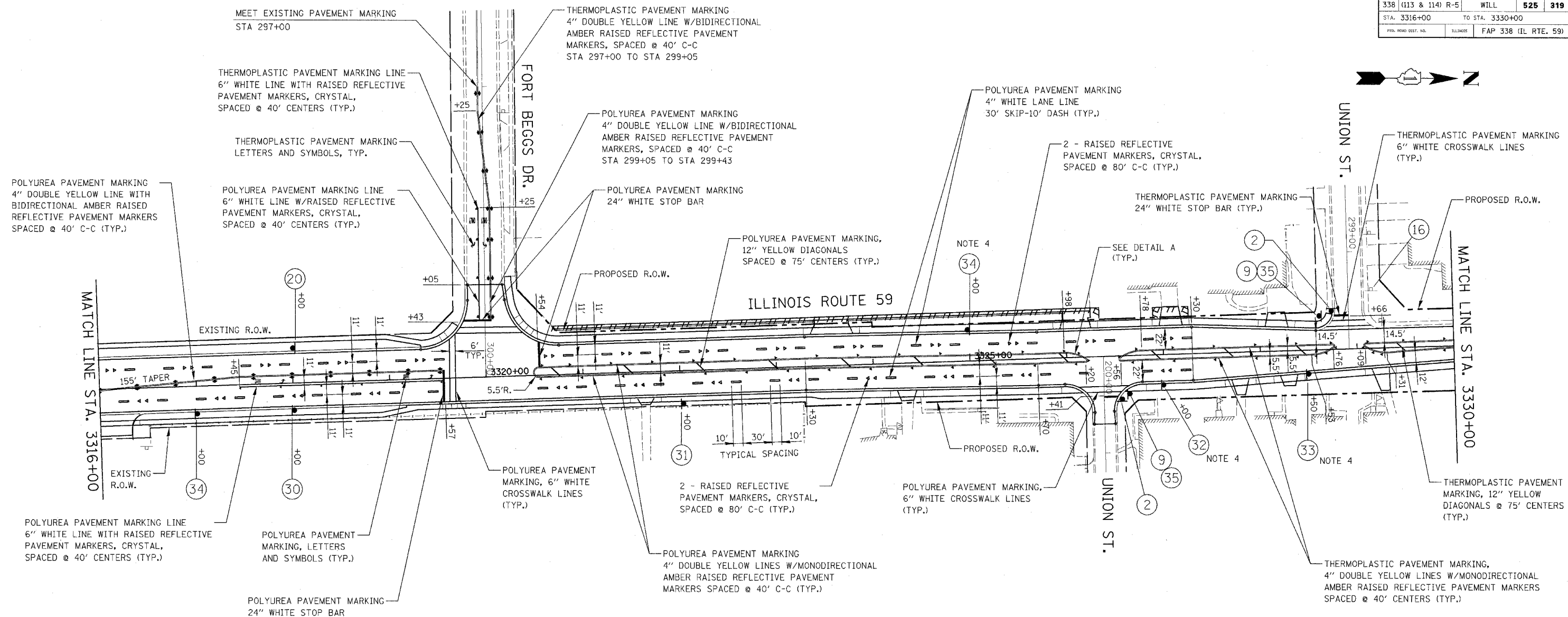