

FAP NO.	SECTION	COUNTY	TOTAL SHEETS	SHEET NO.
338	(113 & 114) R-5	WILL	525	324
STA. 3232+00		TO STA. 3246+00		
FED. ROAD DIST. NO.		ILLINOIS	FAP 338 (IL RTE. 59)	

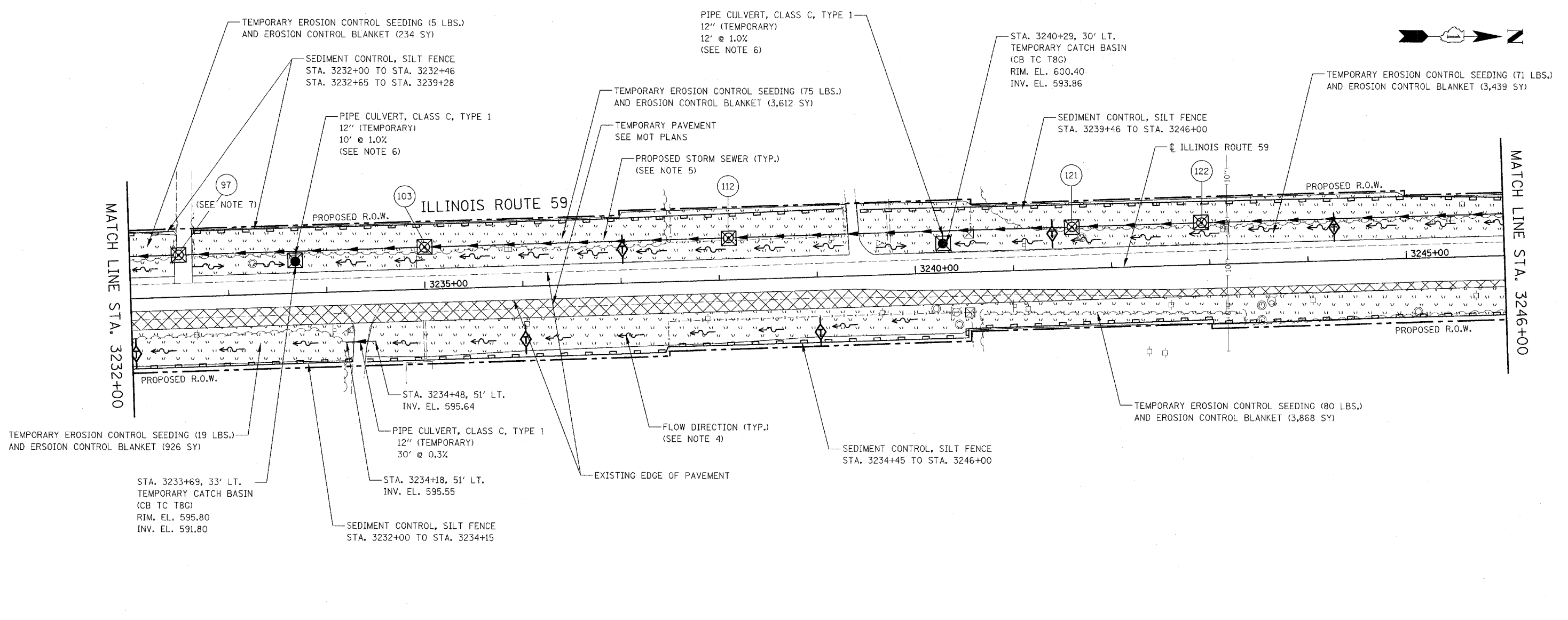

EROSION CONTROL LEGEND

- TEMPORARY EROSION CONTROL SEEDING AND EROSION CONTROL BLANKET
- TEMPORARY PAVEMENT
- SEDIMENT CONTROL, SILT FENCE (SEE NOTE 2)
- INLET FILTER
- DRAINAGE STRUCTURE TO BE CLEANED
- TEMPORARY DITCH CHECK
- FLOW DIRECTION (SEE NOTE 4)
- PERMANENT DRAINAGE STRUCTURE NUMBER (SEE NOTE 5)
- PROPOSED STORM SEWER (SEE NOTE 5)
- TEMPORARY PIPE CULVERT

NOTES

1. THE CONSTRUCTION LIMITS WILL BE STAKED BY THE ENGINEER PRIOR TO COMMENCING CONSTRUCTION. THE CONSTRUCTION LIMITS MAY BE ADJUSTED BY THE ENGINEER TO PRESERVE TREES AND NO ADDITIONAL COMPENSATION WILL BE PAID TO THE CONTRACTOR FOR CHANGED CONSTRUCTION LIMITS.
2. SEDIMENT CONTROL, SILT FENCE SHALL BE ERECTED ADJACENT TO R.O.W., EASEMENT, AND CONSTRUCTION LIMITS AND AS DIRECTED BY THE ENGINEER.
3. SEE LANDSCAPING PLANS FOR LANDSCAPING REQUIREMENTS.
4. SEE PRE-STAGE 1 CROSS SECTIONS FOR GRADING INFORMATION.
5. SEE PROPOSED DRAINAGE PLANS FOR STORM SEWER INFORMATION.
6. TEMPORARY PIPE CULVERT SHALL BE TEMPORARILY CONNECTED TO PROPOSED MANHOLE OR SEWER. COST OF TEMPORARY CONNECTION SHALL BE CONSIDERED INCLUDED IN THE UNIT PRICE OF "PIPE CULVERT, CLASS C, TYPE 1, 12". (TEMPORARY)".
7. PROPOSED STRUCTURE SHALL BE BURIED AND TEMPORARILY COVERED WITH STEEL PLATE OF 0.25 INCH MINIMUM THICKNESS OR OF THICKNESS SPECIFIED AND APPROVED BY THE ENGINEER. PAYMENT FOR THE INSTALLATION AND REMOVAL OF THE STEEL PLATE INCLUDING ANY REQUIRED EXCAVATION SHALL BE CONSIDERED INCLUDED IN THE COST OF THE PROPOSED STRUCTURE.

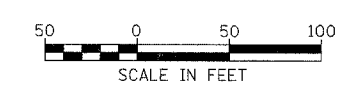

ILLINOIS DEPARTMENT OF TRANSPORTATION
 DISTRICT NO. 1 SCHAUMBURG
 EROSION CONTROL PLAN
 PRE-STAGE 1, 1A AND 1B
 ILLINOIS ROUTE 59

SCALE AS SHOWN
 DATE MARCH 18, 2008

DRAWN BY BSB
 CHECKED BY HME