

FAP DIST.	SECTION	COUNTY	TOTAL SHEETS	SHEET NO.
338	(113 & 114) R-5	WILL	525	325
STA. 3246+00		TO STA. 3260+00		
FED. ROAD DIST. NO.		ILLINOIS	FAP 338 (IL RTE. 59)	

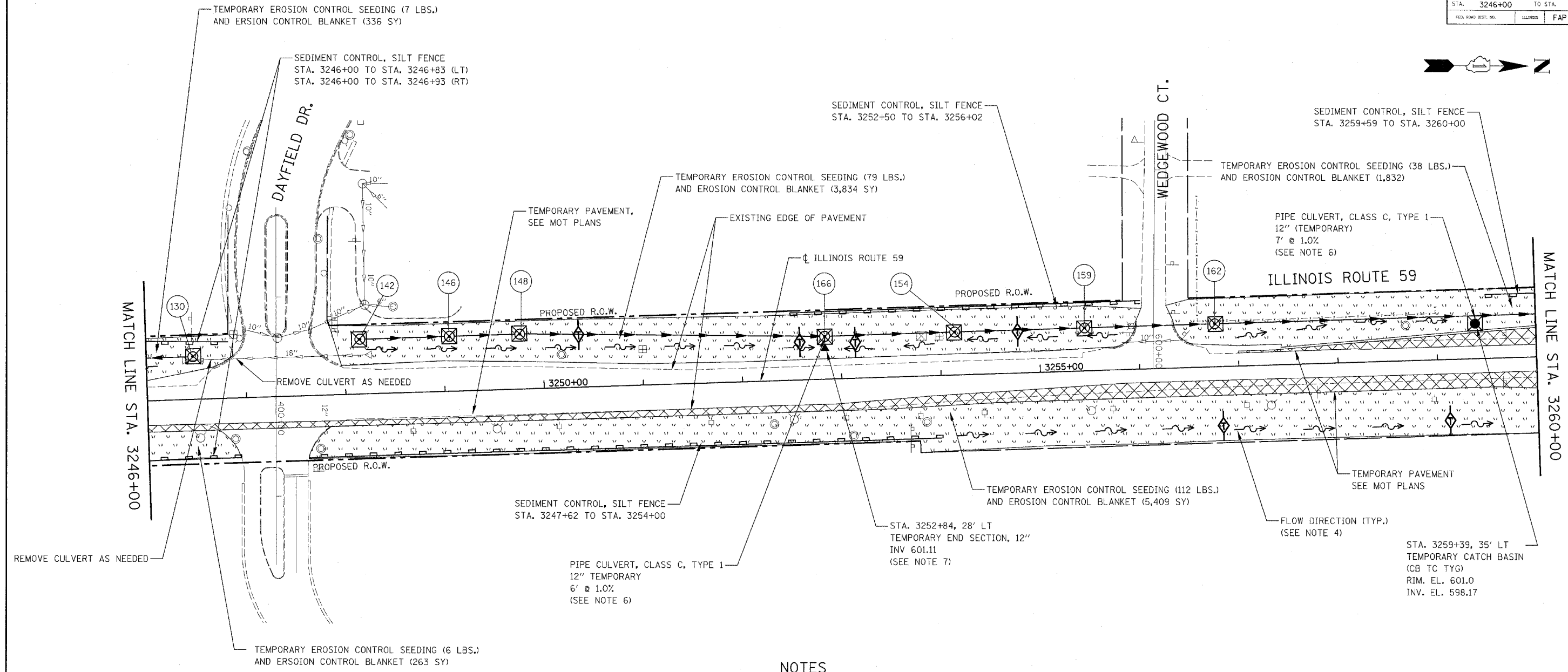

EROSION CONTROL LEGEND

- | | | | |
|--|---|--|--|
| | TEMPORARY EROSION CONTROL SEEDING AND EROSION CONTROL BLANKET | | TEMPORARY DITCH CHECK |
| | TEMPORARY PAVEMENT | | FLOW DIRECTION (SEE NOTE 4) |
| | SEDIMENT CONTROL, SILT FENCE (SEE NOTE 2) | | PERMANENT DRAINAGE STRUCTURE NUMBER (SEE NOTE 5) |
| | INLET FILTER | | PROPOSED STORM SEWER (SEE NOTE 5) |
| | DRAINAGE STRUCTURE TO BE CLEANED | | TEMPORARY PIPE CULVERT |

NOTES

1. THE CONSTRUCTION LIMITS WILL BE STAKED BY THE ENGINEER PRIOR TO COMMENCING CONSTRUCTION. THE CONSTRUCTION LIMITS MAY BE ADJUSTED BY THE ENGINEER TO PRESERVE TREES AND NO ADDITIONAL COMPENSATION WILL BE PAID TO THE CONTRACTOR FOR CHANGED CONSTRUCTION LIMITS.
2. SEDIMENT CONTROL, SILT FENCE SHALL BE ERECTED ADJACENT TO R.O.W., EASEMENT, AND CONSTRUCTION LIMITS AND AS DIRECTED BY THE ENGINEER.
3. SEE LANDSCAPING PLANS FOR LANDSCAPING REQUIREMENTS.
4. SEE PRE-STAGE 1 CROSS SECTIONS FOR GRADING INFORMATION.
5. SEE PROPOSED DRAINAGE PLANS FOR STORM SEWER INFORMATION.
6. TEMPORARY PIPE CULVERT SHALL BE TEMPORARILY CONNECTED TO PROPOSED MANHOLE OR SEWER. COST OF TEMPORARY CONNECTION SHALL BE CONSIDERED INCLUDED IN THE UNIT PRICE OF "PIPE CULVERT, CLASS C, TYPE 1, 12". (TEMPORARY)".
7. TYPE OF TEMPORARY END SECTION REQUIRED AS END TREATMENT WILL BE SUBJECT FOR APPROVAL BY THE ENGINEER. PAYMENT FOR THIS TEMPORARY END SECTION (12") SHALL BE CONSIDERED INCLUDED IN THE UNIT PRICE OF "PIPE CULVERT, CLASS C, TYPE 1, 12" (TEMPORARY)".

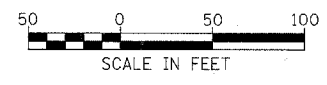

ILLINOIS DEPARTMENT OF TRANSPORTATION
 DISTRICT NO. 1 SCHAUMBURG
 EROSION CONTROL PLAN
 PRE-STAGE 1, 1A AND 1B
 ILLINOIS ROUTE 59

SCALE AS SHOWN
 DATE MARCH 18, 2008

DRAWN BY BSB
 CHECKED BY HME