

FAP NO.	SECTION	COUNTY	TOTAL SHEETS	SHEET NO.
338	(113 & 114) R-5	WILL	525	331
STA. 3190+00		TO STA. 3204+00		
FED. ROAD DIST. NO.	ILLINOIS	FAP 338 (IL RTE. 59)		

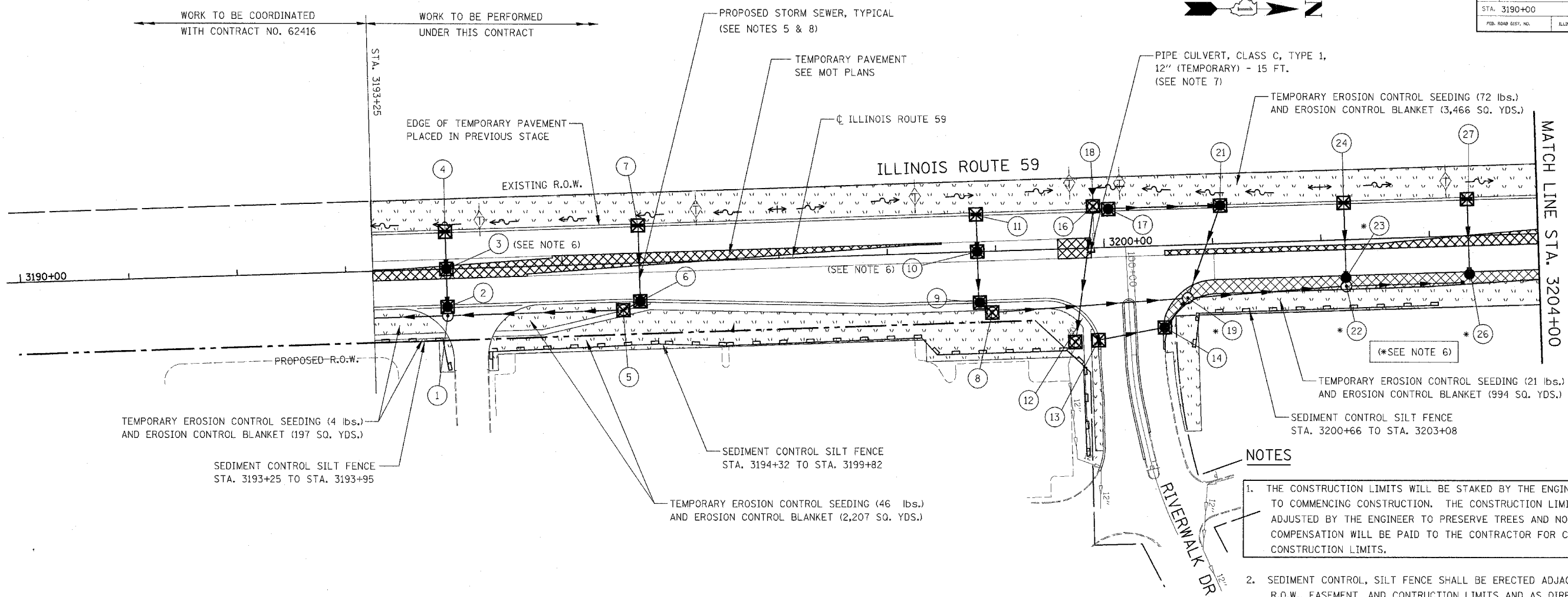

NOTES

1. THE CONSTRUCTION LIMITS WILL BE STAKED BY THE ENGINEER PRIOR TO COMMENCING CONSTRUCTION. THE CONSTRUCTION LIMITS MAY BE ADJUSTED BY THE ENGINEER TO PRESERVE TREES AND NO ADDITIONAL COMPENSATION WILL BE PAID TO THE CONTRACTOR FOR CHANGED CONSTRUCTION LIMITS.
2. SEDIMENT CONTROL, SILT FENCE SHALL BE ERECTED ADJACENT TO R.O.W., EASEMENT, AND CONSTRUCTION LIMITS AND AS DIRECTED BY THE ENGINEER.
3. SEE LANDSCAPING PLANS FOR LANDSCAPING REQUIREMENTS.
4. SEE STAGE 1 CROSS SECTIONS FOR GRADING INFORMATION.
5. SEE PROPOSED DRAINAGE PLANS FOR STORM SEWER INFORMATION.
6. PROPOSED STRUCTURE SHALL BE BURIED AND TEMPORARILY COVERED WITH STEEL PLATE OF 0.25 INCH MINIMUM THICKNESS OR OF THICKNESS SPECIFIED AND APPROVED BY THE ENGINEER. PAYMENT FOR THE INSTALLATION AND REMOVAL OF THE STEEL PLATE INCLUDING ANY REQUIRED EXCAVATION SHALL BE CONSIDERED INCLUDED IN THE COST OF THE PROPOSED STRUCTURE.
7. TEMPORARY PIPE CULVERT SHALL BE TEMPORARILY CONNECTED TO THE EXISTING 30" STORM SEWER AND TO THE INSTALLED PROPOSED 24" STORM SEWER. PAYMENT FOR THESE TEMPORARY CONNECTIONS SHALL BE CONSIDERED INCLUDED IN THE UNIT PRICE OF "PIPE CULVERT, CLASS C, TYPE 1, 12" (TEMPORARY)".
8. PROPOSED LATERAL STORM SEWERS SHALL BE INSTALLED IN STAGE 1 AND STAGE 1A, RESPECTIVELY. SEE MOT STAGES 1 AND 1A FOR WORKZONE LIMIT INFORMATION.

EROSION CONTROL LEGEND

	TEMPORARY EROSION CONTROL SEEDING AND EROSION CONTROL BLANKET		TEMPORARY DITCH CHECK
	TEMPORARY EROSION CONTROL SEEDING AND EROSION CONTROL BLANKET INSTALLED IN PREVIOUS STAGE		TEMPORARY DITCH CHECK INSTALLED IN PREVIOUS STAGE
	PERMANENT LANDSCAPING (SEE NOTE 3)		FLOW DIRECTION (SEE NOTE 4)
	TEMPORARY PAVEMENT		PERMANENT DRAINAGE STRUCTURE NUMBER (SEE NOTE 5)
	DRAINAGE STRUCTURE TO BE CLEANED		PROPOSED STORM SEWER (SEE NOTE 5)
	SEDIMENT CONTROL, SILT FENCE (SEE NOTE 2)		PROPOSED STORM SEWER INSTALLED IN PREVIOUS STAGE
	SEDIMENT CONTROL SILT FENCE INSTALLED IN PREVIOUS STAGE		TEMPORARY PIPE CULVERT
	INLET FILTER		TEMPORARY PIPE CULVERT INSTALLED IN PREVIOUS STAGE
	INLET FILTER INSTALLED IN PREVIOUS STAGE		

GENERAL EROSION CONTROL NOTES:

TREE TRUNK PROTECTION, TREE ROOT PRUNING, AND TREE PRUNING WILL BE REQUIRED FOR THIS PROJECT. A REPRESENTATIVE FROM IDOT'S ROADSIDE DEVELOPMENT UNIT WILL DETERMINE LOCATIONS ON SITE AT THE START OF CONSTRUCTION. PAY ITEMS HAVE BEEN INCLUDED IN THE SUMMARY OF QUANTITIES.

THE CONTRACTOR WILL BE REQUIRED TO SUBMIT CERTIFICATION STATEMENT (NPDES ATTACHMENT 6). FULL COMPLIANCE WITH ALL TERMS OF THE NPDES PERMIT MUST BE STRICTLY ADHERED TO.

DRAINAGE STRUCTURE INLET FILTERS ARE TO BE PROVIDED AND MAINTAINED FOR ALL EXISTING AND PROPOSED DRAINAGE STRUCTURE WITHIN THE PROJECT LIMITS AND ALL STRUCTURES NOTED FOR INLET AND PIPE PROTECTION AS DIRECTED BY THE ENGINEER. PAY ITEMS, DETAILS AND SPECIAL PROVISIONS HAVE BEEN INCLUDED IN THE SUMMARY OF QUANTITIES, SPECIAL PROVISIONS, AND PLAN DETAILS FOR THIS WORK.



ILLINOIS DEPARTMENT OF TRANSPORTATION
DISTRICT NO. 1 SCHAUMBURG
EROSION CONTROL PLAN
STAGE 1, 1A, 1B AND 1C
ILLINOIS ROUTE 59

SCALE AS SHOWN
DATE MARCH 18, 2008
DRAWN BY BSB
CHECKED BY HME