

FAP NO.	SECTION	COUNTY	TOTAL SHEETS	SHEET NO.
338	(113 & 114) R-5	WILL	525	340
STA. 3316+00		TO STA. 3330+00		
FAP 338 (IL RTE. 59)				

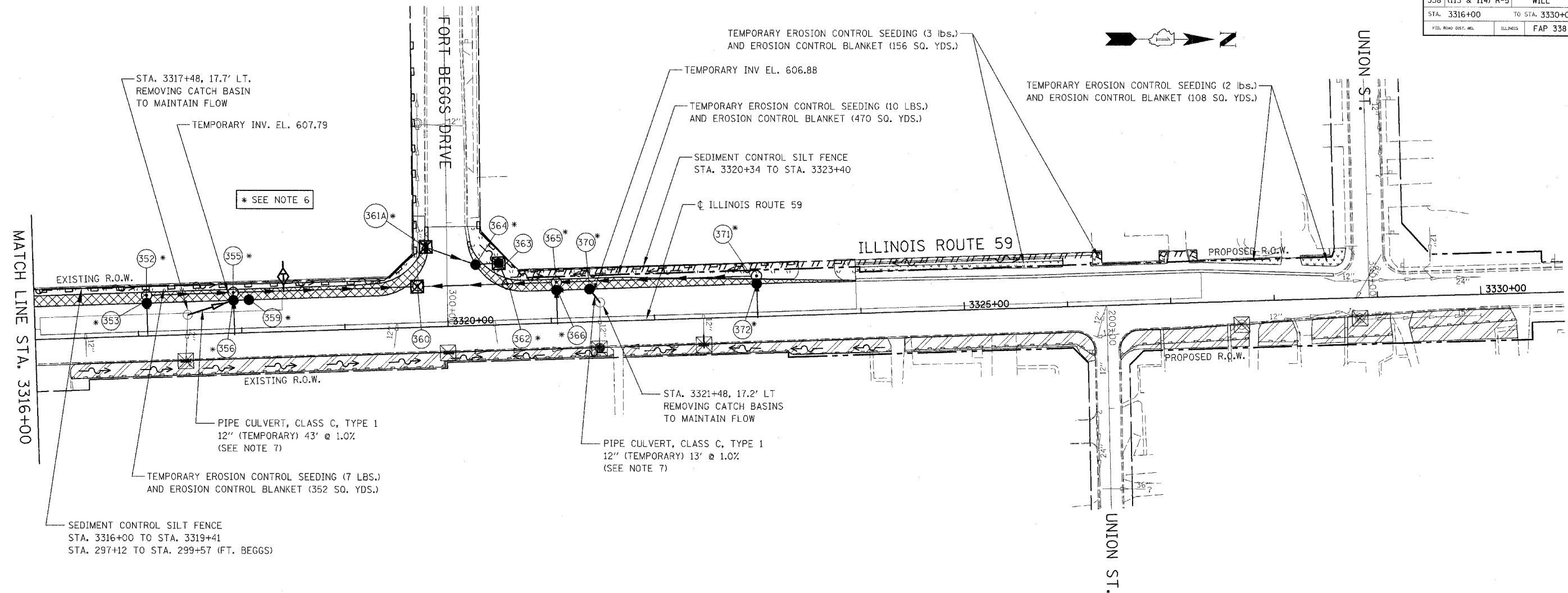

EROSION CONTROL LEGEND

- | | | | |
|--|---|--|--|
| | TEMPORARY EROSION CONTROL SEEDING AND EROSION CONTROL BLANKET | | TEMPORARY DITCH CHECK |
| | TEMPORARY EROSION CONTROL SEEDING AND EROSION CONTROL BLANKET INSTALLED IN PREVIOUS STAGE | | TEMPORARY DITCH CHECK INSTALLED IN PREVIOUS STAGE |
| | PERMANENT LANDSCAPING (SEE NOTE 3) | | FLOW DIRECTION (SEE NOTE 4) |
| | TEMPORARY PAVEMENT | | PERMANENT DRAINAGE STRUCTURE NUMBER (SEE NOTE 5) |
| | DRAINAGE STRUCTURE TO BE CLEANED | | PROPOSED STORM SEWER (SEE NOTE 5) |
| | SEDIMENT CONTROL, SILT FENCE (SEE NOTE 2) | | PROPOSED STORM SEWER INSTALLED IN PREVIOUS STAGE |
| | SEDIMENT CONTROL SILT FENCE INSTALLED IN PREVIOUS STAGE | | TEMPORARY PIPE CULVERT |
| | INLET FILTER | | TEMPORARY PIPE CULVERT INSTALLED IN PREVIOUS STAGE |
| | INLET FILTER INSTALLED IN PREVIOUS STAGE | | |

NOTES

- THE CONSTRUCTION LIMITS WILL BE STAKED BY THE ENGINEER PRIOR TO COMMENCING CONSTRUCTION. THE CONSTRUCTION LIMITS MAY BE ADJUSTED BY THE ENGINEER TO PRESERVE TREES AND NO ADDITIONAL COMPENSATION WILL BE PAID TO THE CONTRACTOR FOR CHANGED CONSTRUCTION LIMITS.
- SEDIMENT CONTROL, SILT FENCE SHALL BE ERECTED ADJACENT TO R.O.W., EASEMENT, AND CONSTRUCTION LIMITS AND AS DIRECTED BY THE ENGINEER.
- SEE LANDSCAPING PLANS FOR LANDSCAPING REQUIREMENTS.
- SEE STAGE 1 CROSS SECTIONS FOR GRADING INFORMATION.
- SEE PROPOSED DRAINAGE PLANS FOR STORM SEWER INFORMATION.
- PROPOSED STRUCTURE SHALL BE BURIED AND TEMPORARILY COVERED WITH STEEL PLATE OF 0.25 INCH MINIMUM THICKNESS OR OF THICKNESS SPECIFIED AND APPROVED BY THE ENGINEER. PAYMENT FOR THE INSTALLATION AND REMOVAL OF THE STEEL PLATE INCLUDING ANY REQUIRED EXCAVATION SHALL BE CONSIDERED INCLUDED IN THE COST OF THE PROPOSED STRUCTURE.
- TEMPORARY PIPE CULVERT SHALL BE TEMPORARILY CONNECTED TO THE EXISTING STORM SEWER AND TO THE PROPOSED MANHOLE. PAYMENT FOR TEMPORARY CONNECTIONS SHALL BE CONSIDERED INCLUDED IN THE UNIT PRICE OF "PIPE CULVERT, CLASS C, TYPE 1, 12" (TEMPORARY)".

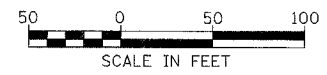

ILLINOIS DEPARTMENT OF TRANSPORTATION
 DISTRICT NO. 1 SCHAUMBURG
EROSION CONTROL PLAN
 STAGE 1, 1A, 1B AND 1C
 ILLINOIS ROUTE 59

SCALE AS SHOWN
 DATE MARCH 18, 2008

DRAWN BY BSB
 CHECKED BY HME