

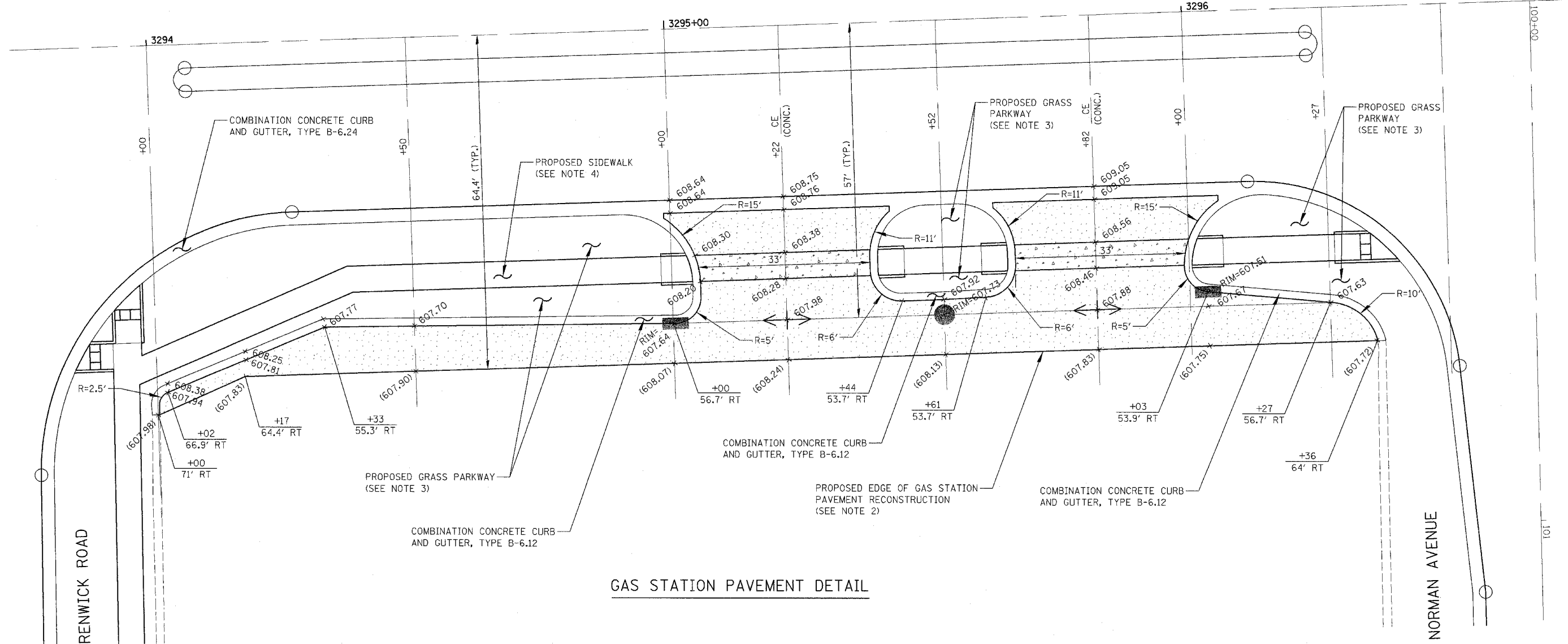

FAP NO.	SECTION	COUNTY	TOTAL SHEETS	SHEET NO.
338	(113 & 114) R-5	WILL	525	391
STA.		TO STA.		
FED. ROAD DIST. NO.		ILLINOIS FAP 338 (IL RTE. 59)		

ILLINOIS 59

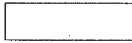
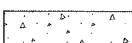
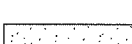

GAS STATION PAVEMENT DETAIL

LEGEND

-  PCC SIDEWALK, 5"
-  PCC SIDEWALK, 8"
-  PCC DRIVEWAY PAVEMENT, 8"
-  PROPOSED CATCH BASIN (SEE NOTE 5)
-  PROPOSED INLET (SEE NOTE 5)

NOTES:

1. (607.98) EXISTING ELEVATIONS
607.94 PROPOSED ELEVATIONS
2. GAS STATION ENTRANCE AND PAVEMENT RECONSTRUCTION SHALL CONSIST OF 8" THICK PORTLAND CEMENT CONCRETE
3. SEE LANDSCAPING PLANS FOR LANDSCAPING REQUIREMENTS
4. SEE SIDEWALK PLANS FOR PROPOSED SIDEWALK DETAILS.
5. SEE DRAINAGE PLANS FOR DRAINAGE STRUCTURE INFORMATION.



ILLINOIS DEPARTMENT OF TRANSPORTATION
DISTRICT NO. 1 SCHAUMBURG
IL59/RENWICK RD. GAS STATION
PAVEMENT RECONSTRUCTION
DETAIL

SCALE AS SHOWN
DATE MARCH 18, 2008

DRAWN BY RTA
CHECKED BY PJO