

FAP 338 (113 & 114)	SECTION R-5	COUNTY WILL	TOTAL SHEETS 525	SHEET NO. 417
STA. 3260+00		TO STA. 3274+00		
FID. ROAD DIST. NO.		ILLINOIS FAP 338 (ILL. RTE. 59)		

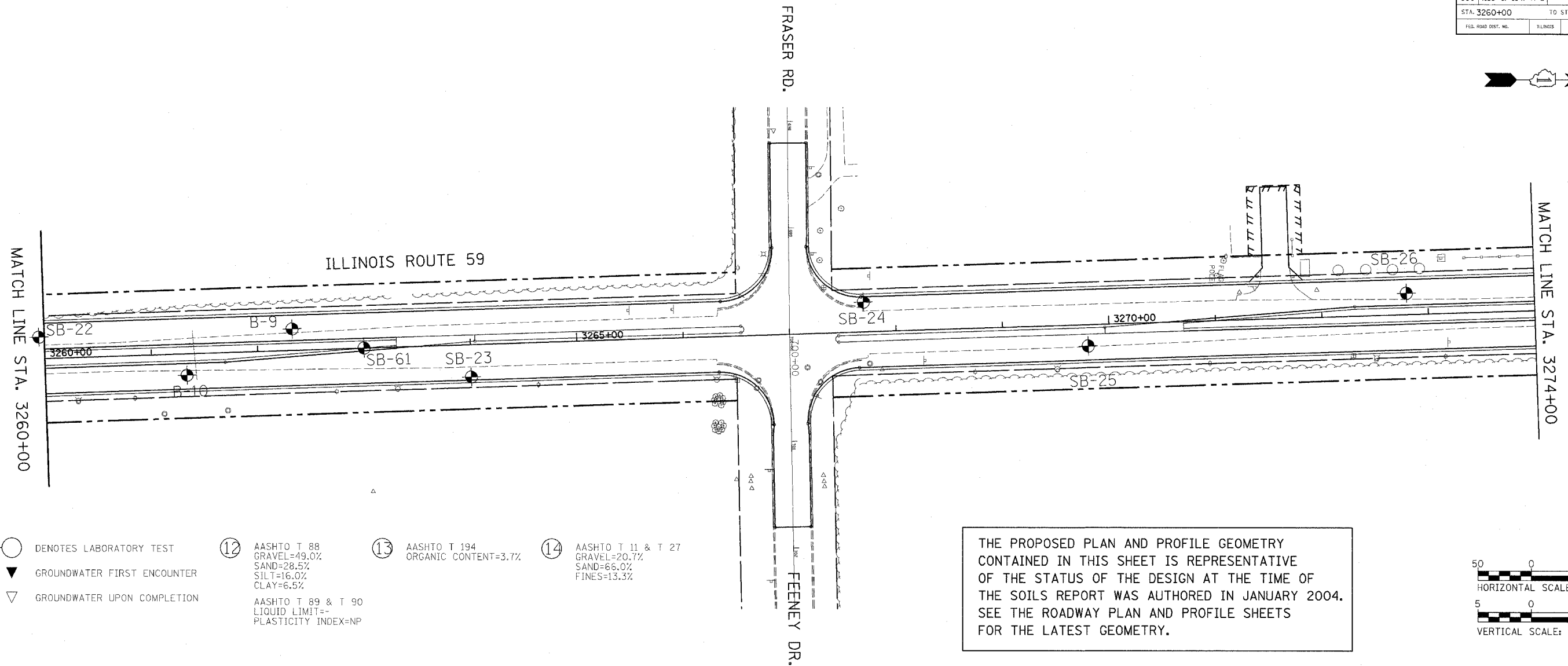

- DENOTES LABORATORY TEST
- ▼ GROUNDWATER FIRST ENCOUNTER
- ▽ GROUNDWATER UPON COMPLETION
- ⑫ AASHTO T 88
GRAVEL=49.0%
SAND=28.5%
SILT=16.0%
CLAY=6.5%
AASHTO T 89 & T 90
LIQUID LIMIT=-
PLASTICITY INDEX=NP
- ⑬ AASHTO T 194
ORGANIC CONTENT=3.7%
- ⑭ AASHTO T 11 & T 27
GRAVEL=20.7%
SAND=66.0%
FINES=13.3%

THE PROPOSED PLAN AND PROFILE GEOMETRY CONTAINED IN THIS SHEET IS REPRESENTATIVE OF THE STATUS OF THE DESIGN AT THE TIME OF THE SOILS REPORT WAS AUTHORED IN JANUARY 2004. SEE THE ROADWAY PLAN AND PROFILE SHEETS FOR THE LATEST GEOMETRY.

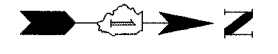
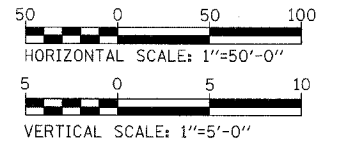

DATE	
BY	
CHECKED	
APPROVED	
DATE	
BY	
CHECKED	
APPROVED	
DATE	
BY	
CHECKED	
APPROVED	
DATE	
BY	
CHECKED	
APPROVED	

DATE	
BY	
CHECKED	
APPROVED	
DATE	
BY	
CHECKED	
APPROVED	
DATE	
BY	
CHECKED	
APPROVED	
DATE	
BY	
CHECKED	
APPROVED	

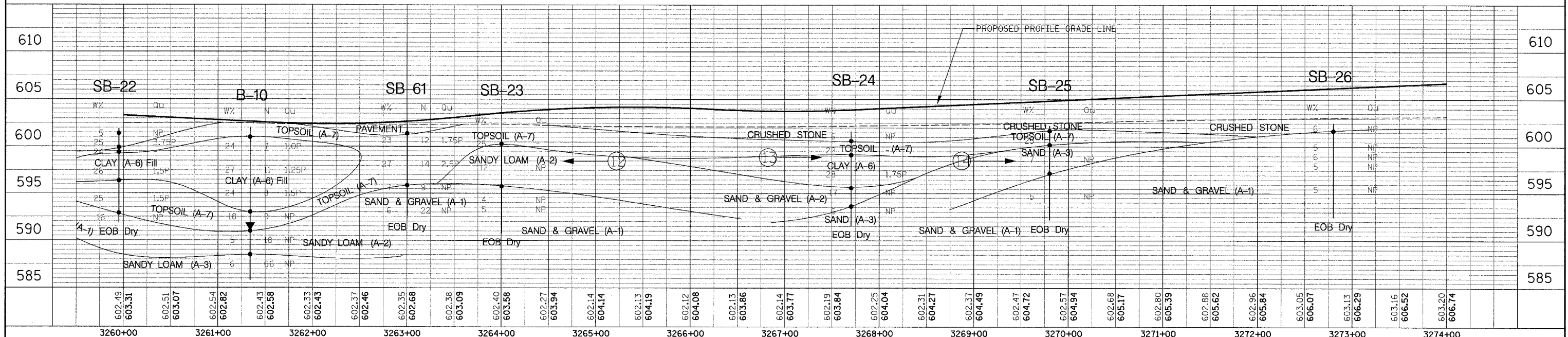

SOILS PLAN /PROFILE - ILLINOIS ROUTE 59