

FAP REF.	SECTION	COUNTY	TOTAL SHEETS	SHEET NO.
338	(113 & 114) R-5	WILL	525	421
STA. 3316+00		TO STA. 3330+00		
FED. ROAD DIST. NO.	ILLINOIS	FAP 338 (IL RTE. 59)		

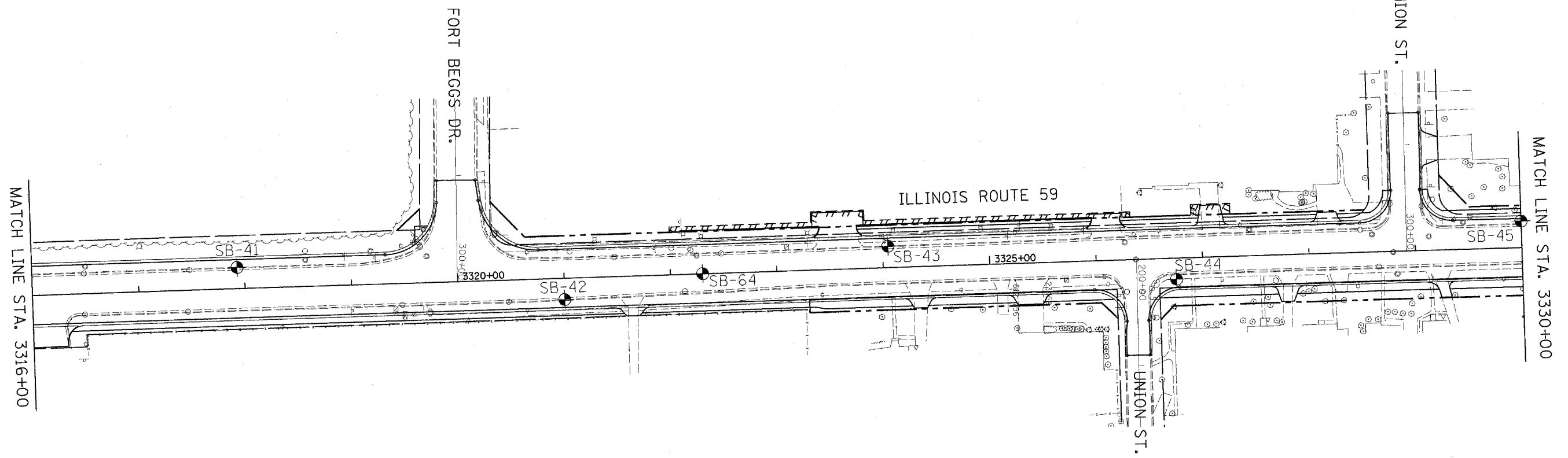

- DENOTES LABORATORY TEST
- ▼ GROUNDWATER FIRST ENCOUNTER
- ▽ GROUNDWATER UPON COMPLETION
- ② AASHTO T 88 GRAVEL=1.0% SAND=46.5% SILT=31.5% CLAY=21.0%  
AASHTO T 89 & T 90 LIQUID LIMIT=28 PLASTICITY INDEX=26
- ③ AASHTO T 88 GRAVEL=0.5% SAND=4.5% SILT=76.0% CLAY=19.0%  
AASHTO T 89 & T 90 LIQUID LIMIT=30 PLASTICITY INDEX=6
- ④ AASHTO T 88 GRAVEL=3.0% SAND=20.0% SILT=38.0% CLAY=39.0%  
AASHTO T 89 & T 90 LIQUID LIMIT=40 PLASTICITY INDEX=21
- ⑤ AASHTO T 194 ORGANIC CONTENT=3.4%

THE PROPOSED PLAN AND PROFILE GEOMETRY CONTAINED IN THIS SHEET IS REPRESENTATIVE OF THE STATUS OF THE DESIGN AT THE TIME OF THE SOILS REPORT WAS AUTHORED IN JANUARY 2004. SEE THE ROADWAY PLAN AND PROFILE SHEETS FOR THE LATEST GEOMETRY.

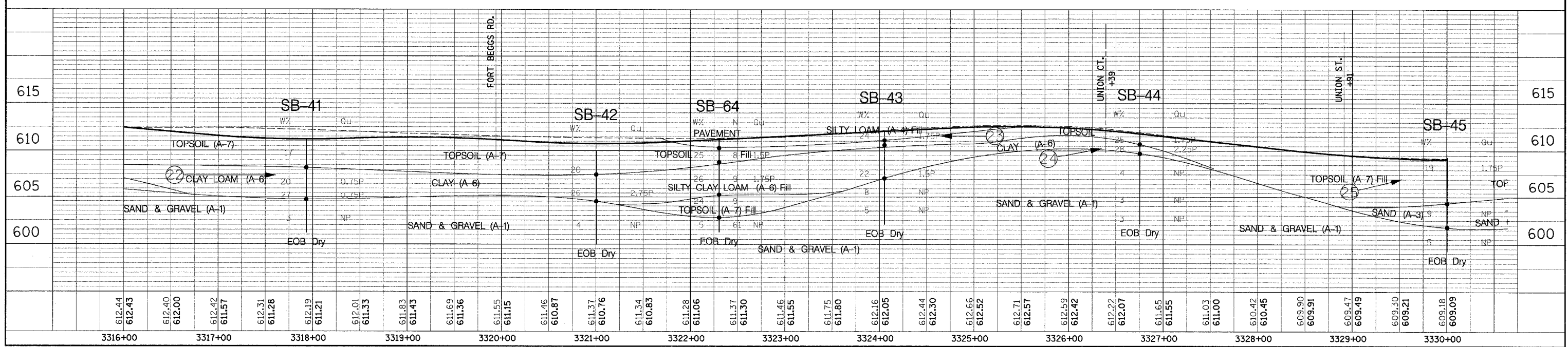
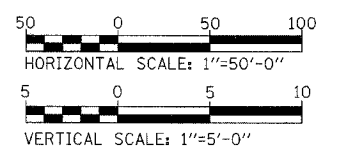

SOILS PLAN /PROFILE - ILLINOIS ROUTE 59

PLAN	REVISIONS	DATE
NO.	BY	
NO.	DATE	
NO.	DATE	
NO.	DATE	

PROFILE	REVISIONS	DATE
NO.	BY	
NO.	DATE	
NO.	DATE	
NO.	DATE	