

CROSS SECTION  
SECTION NO. \_\_\_\_\_  
DATE \_\_\_\_\_  
BY \_\_\_\_\_  
SURVEYED \_\_\_\_\_  
GRADES CHECKED \_\_\_\_\_  
SMA. NOTED \_\_\_\_\_  
SUSURURE NOTATYUS CHKD \_\_\_\_\_

CROSS SECTION  
SECTION NO. \_\_\_\_\_  
DATE \_\_\_\_\_  
BY \_\_\_\_\_  
SURVEYED \_\_\_\_\_  
ALIGNMENT CHECKED \_\_\_\_\_  
RT. OF WAY CHECKED \_\_\_\_\_  
CADD FILE NAME \_\_\_\_\_

ILLINOIS ROUTE 59  
PRE-STAGE 1, 1A & 1B

SECTION	COUNTY	TOTAL SHEET NO.
(113 & 114) R-5	WILL	525 446
STA. 3295+00	TO STA. 3296+41	
FED. ROAD DIST. NO.	BLDG. NO.	FAP 338 (IL RTE. 59)
CONTRACT NO. 62417		

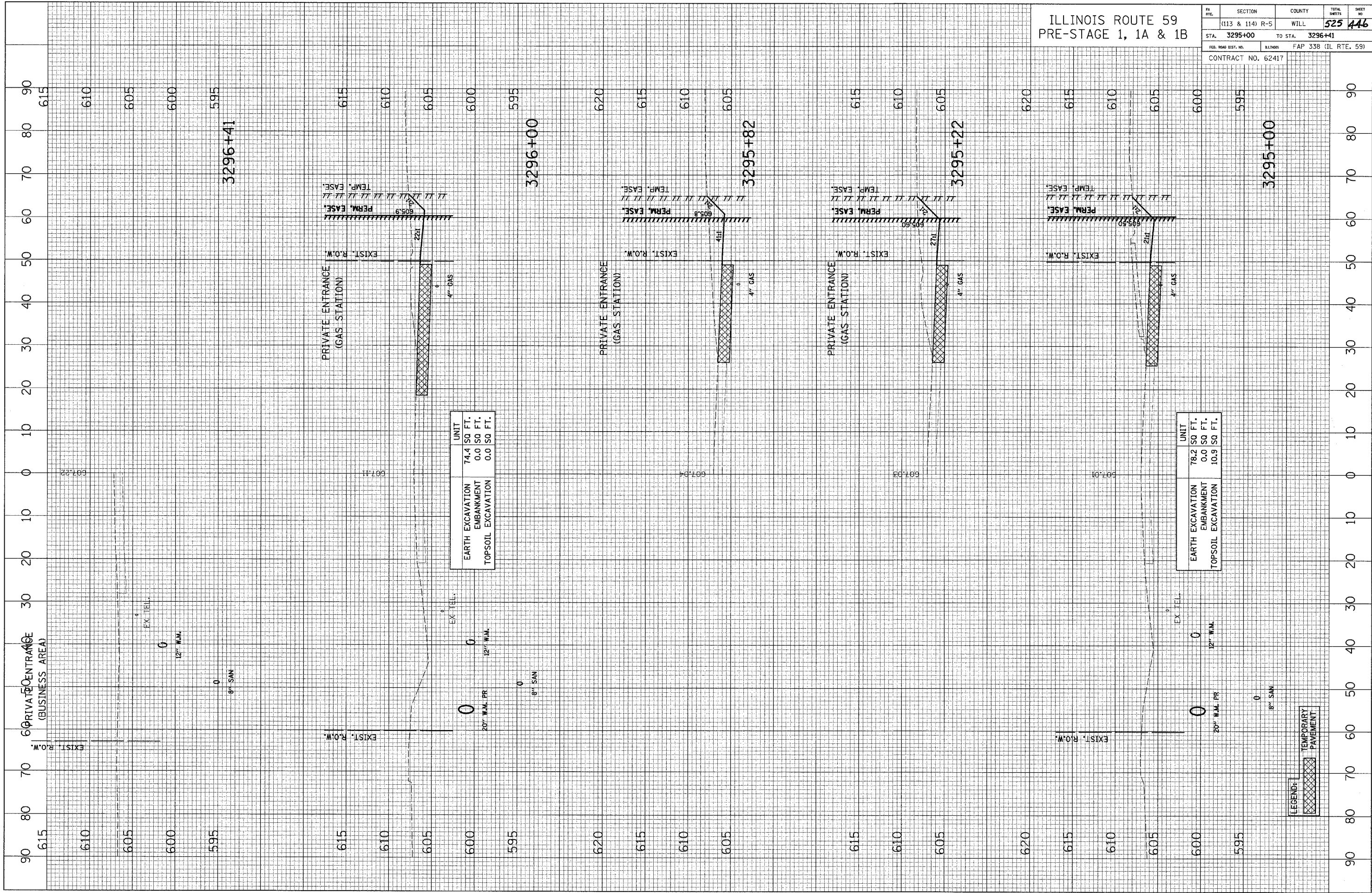

UNIT	74.4 SQ FT.
EARTH EXCAVATION	
EMBANKMENT	0.0 SQ FT.
TOPSOIL EXCAVATION	0.0 SQ FT.

UNIT	78.2 SQ FT.
EARTH EXCAVATION	
EMBANKMENT	0.0 SQ FT.
TOPSOIL EXCAVATION	10.9 SQ FT.

LEGEND:  
TEMPORARY PAVEMENT