

FILE NO.	SECTION	COUNTY	TOTAL SHEETS	SHEET NO.
2734	1821 RS-2	COOK	27	12
STA.	TO STA.			
FED. ROAD DIST NO. 1	ILLINOIS	FED. AID PROJECT		

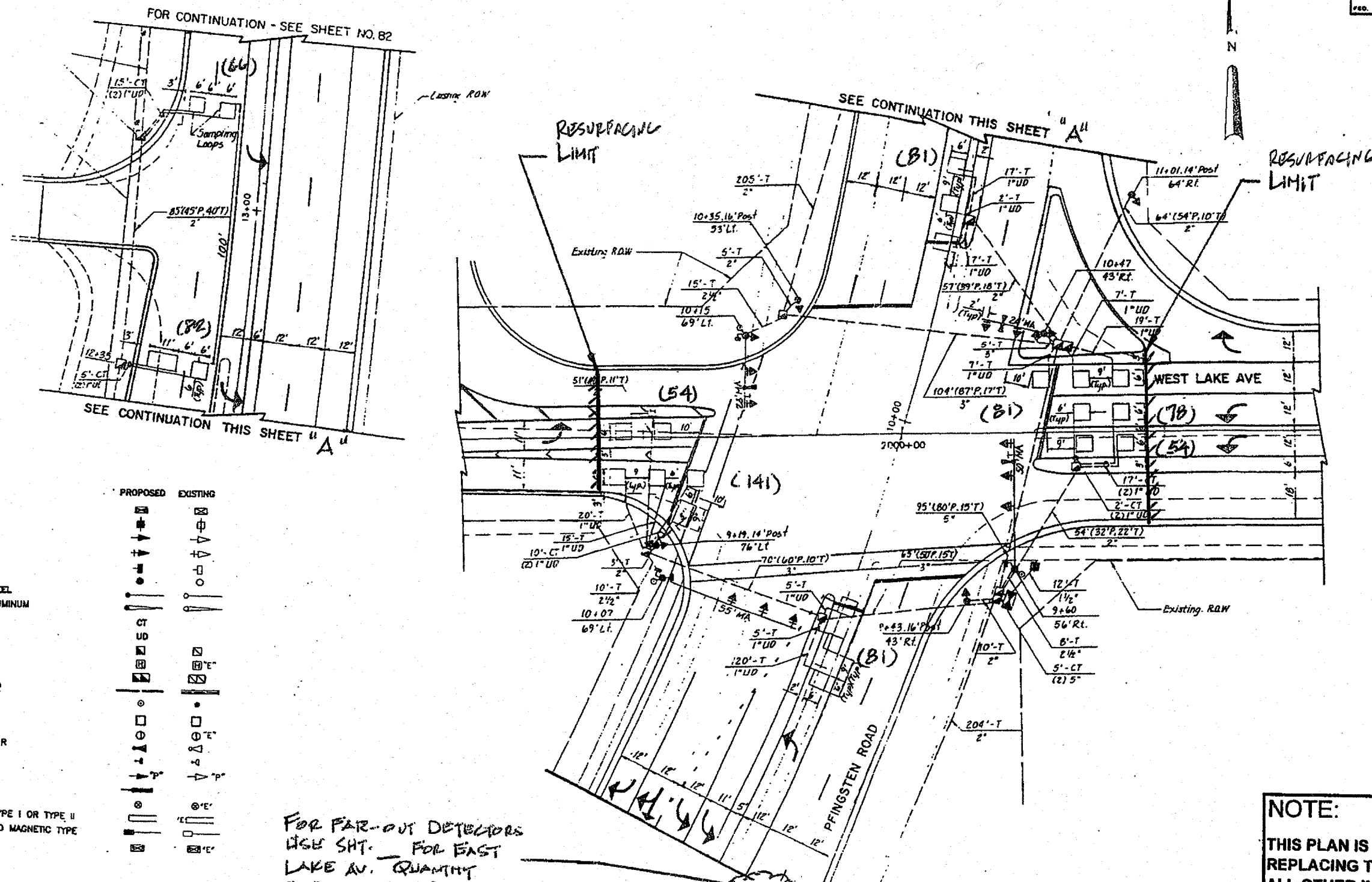

- CONTROLLER
- SERVICE INSTALLATION
- SIGNAL HEAD
- SIGNAL HEAD WITH BACKPLATE
- SIGNAL HEAD, PEDESTRIAN
- SIGNAL POST
- MAST ARM ASSEMBLY AND POLE, STEEL
- MAST ARM ASSEMBLY AND POLE, ALUMINUM
- COMMON TRENCH
- UNIT DUCT
- HANDHOLE
- HEAVY DUTY HANDHOLE
- DOUBLE HANDHOLE
- G.S. CONDUIT IN TRENCH OR PUSHED
- PEDESTRIAN PUSHBUTTON DETECTOR
- DETECTOR LOOP
- CAST IRON JUNCTION BOX
- EMERGENCY VEHICLE SYSTEM DETECTOR
- CONFIRMATION BEACON
- SIGNAL HEAD OPTICALLY PROGRAMMED
- CONDUIT SPLICE
- WOOD POLE
- RACEWAY FOR MAGNETIC DETECTOR, TYPE I OR TYPE II
- VEHICLE DETECTOR, NON COMPENSATED MAGNETIC TYPE
- RAILROAD CONTROL CABINET

PROPOSED	EXISTING

FOR FAR-OUT DETECTORS  
USE SHT. FOR EAST  
LAKE AV. QUANTITY  
INCLUDED THIS PLAN.

**NOTE:**  
THIS PLAN IS FOR THE PURPOSE OF  
REPLACING THE DETECTOR LOOPS ONLY.  
ALL OTHER INFORMATION SHOWN IS NOT  
RELATED AND WILL BE DISREGARDED.

**REPLACE ALL DETECTOR LOOPS AS SHOWN**  
(WITHIN THE RESURFACING LIMITS)

CODE NO.	QUANTITY	UNIT	ITEM
84700600	718	Foot	Detector Loop Replacement

REVISIONS	
NAME	DATE

ILLINOIS DEPARTMENT OF TRANSPORTATION  
**DETECTOR LOOP REPLACEMENT**  
PFINGSTEN RD. @ WEST LAKE AVE.  
SCALE: 1" = 20'  
DATE: MAR. 04  
DRAWN BY: \_\_\_\_\_  
DESIGNED BY: \_\_\_\_\_  
CHECKED BY: \_\_\_\_\_