

*REF-1top04
*REF-1pp04

F.A.P. RTE.	SECTION	COUNTY	TOTAL SHEETS	SHEET NO.
345	BR-1-N-1	COOK	196	21
STA. 19+79		TO STA. 30+00		
FED. ROAD DIST. NO. 1		ILLINOIS FED. AID PROJECT		

CONTRACT NO. 62617

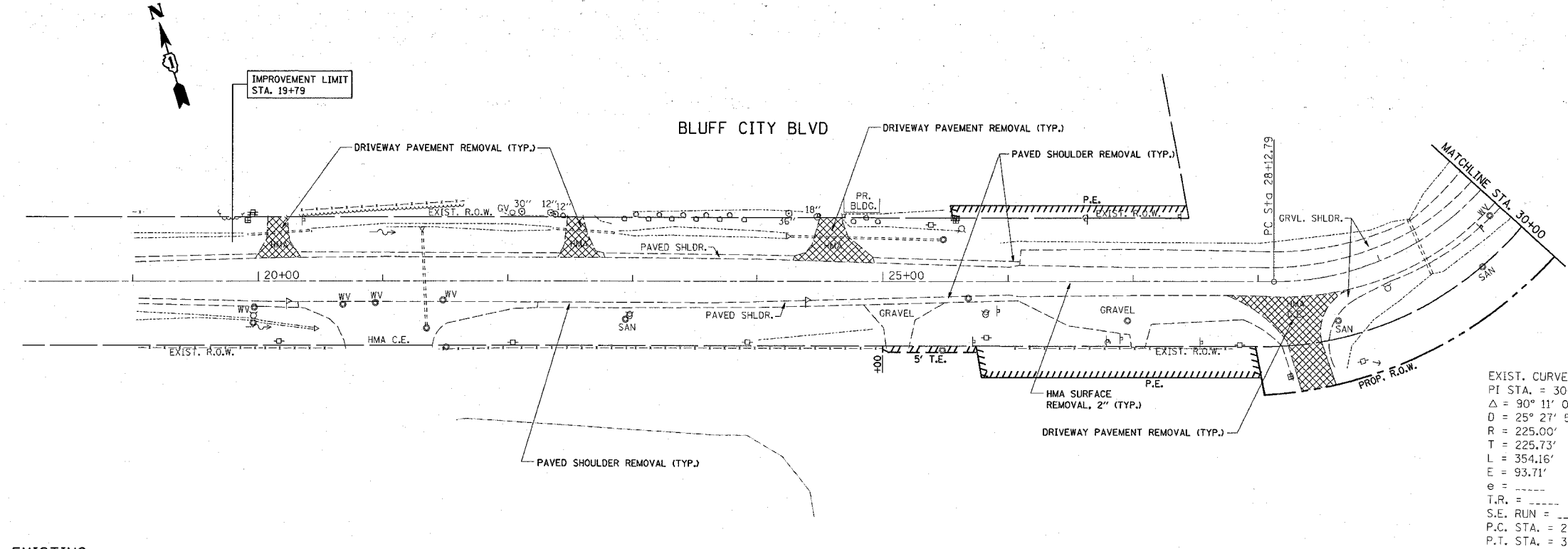

EXIST. CURVE E. BLUFF-1
 PI STA. = 30+38.52
 Δ = 90° 11' 08" (LT)
 D = 25° 27' 53"
 R = 225.00'
 T = 225.73'
 L = 354.16'
 E = 93.71'
 e = -----
 T.R. = -----
 S.E. RUN = -----
 P.C. STA. = 28+12.79
 P.T. STA. = 31+66.95

EXISTING

PROPOSED

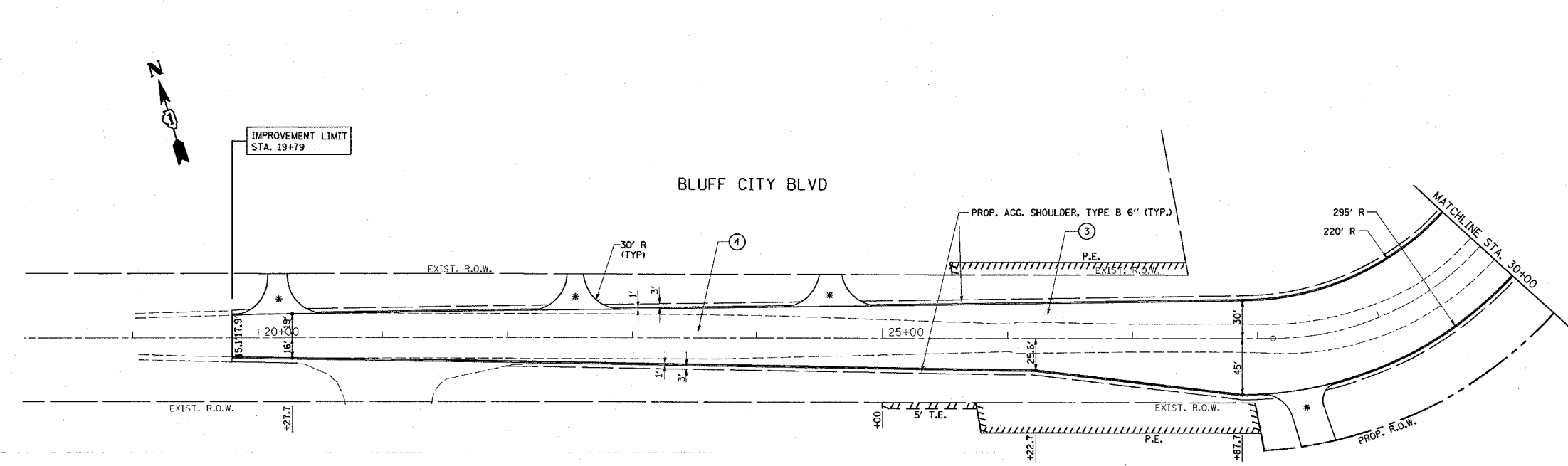

- ① U.S. ROUTE 20 (WIDENING)
 PROP. AGGREGATE SUBGRADE, 12"
 PROP. POLY. HOT-MIX ASPHALT SURFACE COURSE, MIX "F", N90, 2"
 PROP. HOT-MIX ASPHALT BASE COURSE WIDENING, 12"
- ② SHALES PKWY. (WIDENING)
 PROP. AGGREGATE SUBGRADE, 12"
 PROP. POLY. HOT-MIX ASPHALT SURFACE COURSE, MIX "F", N90, 2"
 PROP. HOT-MIX ASPHALT BASE COURSE WIDENING, 7 1/4"
- ③ BLUFF CITY BLVD. (WIDENING)
 PROP. AGGREGATE SUBGRADE, 12"
 PROP. POLY. HOT-MIX ASPHALT SURFACE COURSE, MIX "F", N90, 2"
 PROP. HOT-MIX ASPHALT BASE COURSE WIDENING, 10 3/4"
- ④ RESURFACING FOR EXISTING PAVEMENT
 PROP. POLY. HOT-MIX ASPHALT SURFACE COURSE, MIX "F", N90, 2"

LEGEND (SEE DRIVEWAY DETAILS)
 * HMA DRIVEWAY - RESIDENTIAL ENTRANCE
 ** HMA DRIVEWAY - COMMERCIAL ENTRANCE

REVISIONS	
NAME	DATE

ILLINOIS DEPARTMENT OF TRANSPORTATION
 EXISTING AND PROPOSED
 ROADWAY PLAN
 U.S. 20 AT
 BLUFF CITY/ SHALES PKWY.

SCALE: VERT. 1" = 50'
 HORIZ.
 DATE: 12/12/2007
 DRAWN BY
 CHECKED BY

10:37:45 12/12/2007