

\*REF-top05  
 \*REF-p05  
 \*REF-top06  
 \*REF-p06

F.A.P. RTE.	SECTION	COUNTY	TOTAL SHEETS	SHEET NO.
345	BR-1-N-1	COOK	196	22
STA. 30+00		TO STA. 37+00		
FED. ROAD DIST. NO. 1 ILLINOIS FED. AID PROJECT				

CONTRACT NO. 62617

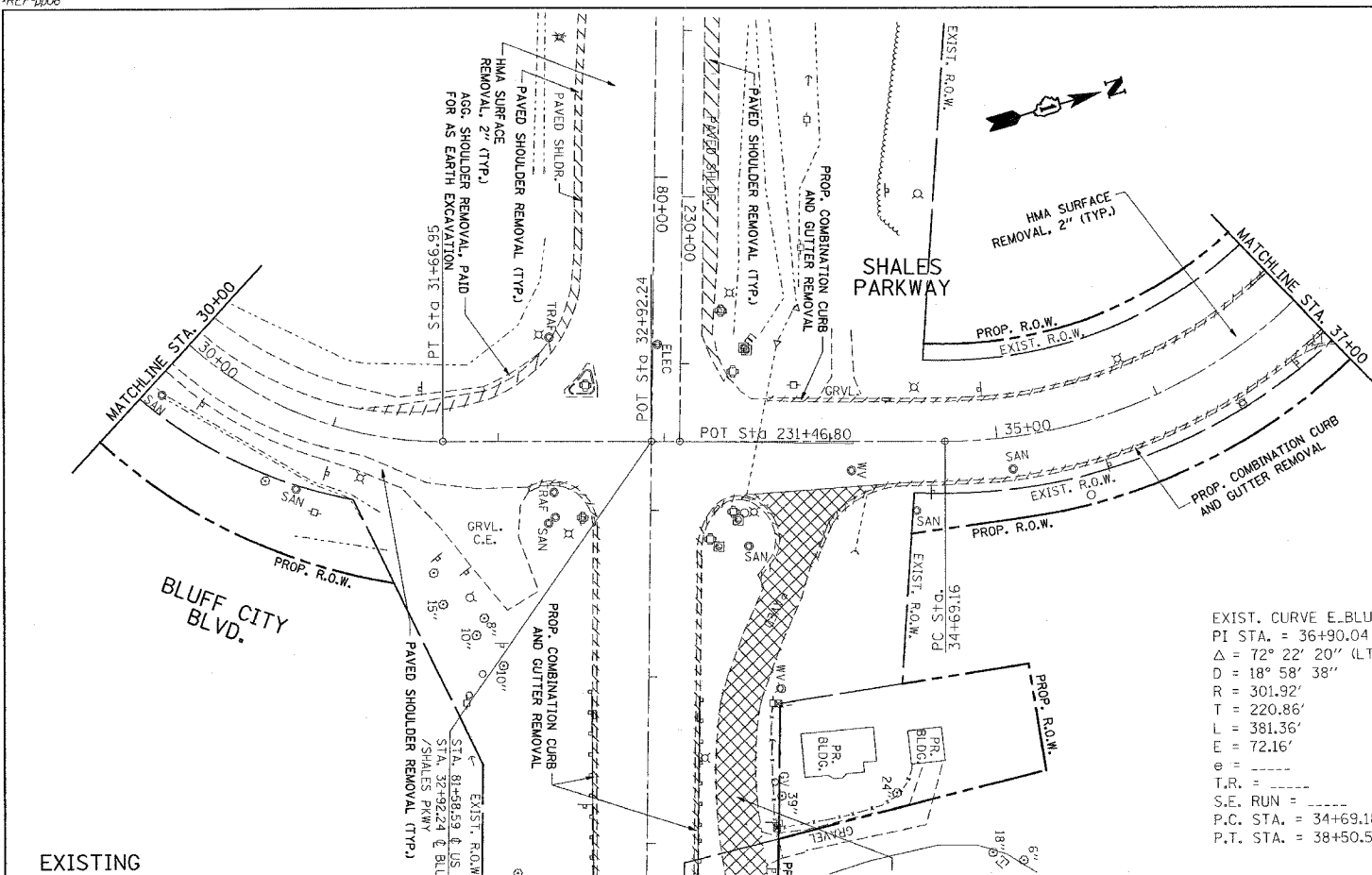

EXIST. CURVE E. BLUFF-2  
 PI STA. = 36+90.04  
 $\Delta = 72^\circ 22' 20''$  (L.T.)  
 $D = 18^\circ 58' 38''$   
 $R = 301.92'$   
 $T = 220.86'$   
 $L = 381.36'$   
 $E = 72.16'$   
 $\theta =$   
 T.R. =  
 S.E. RUN =  
 P.C. STA. = 34+69.18  
 P.T. STA. = 38+50.54

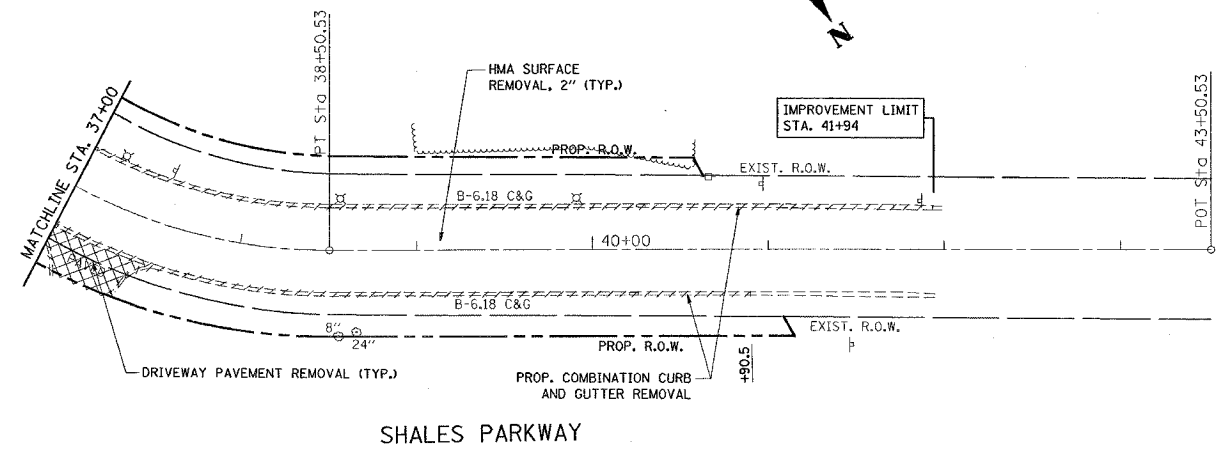

EXISTING

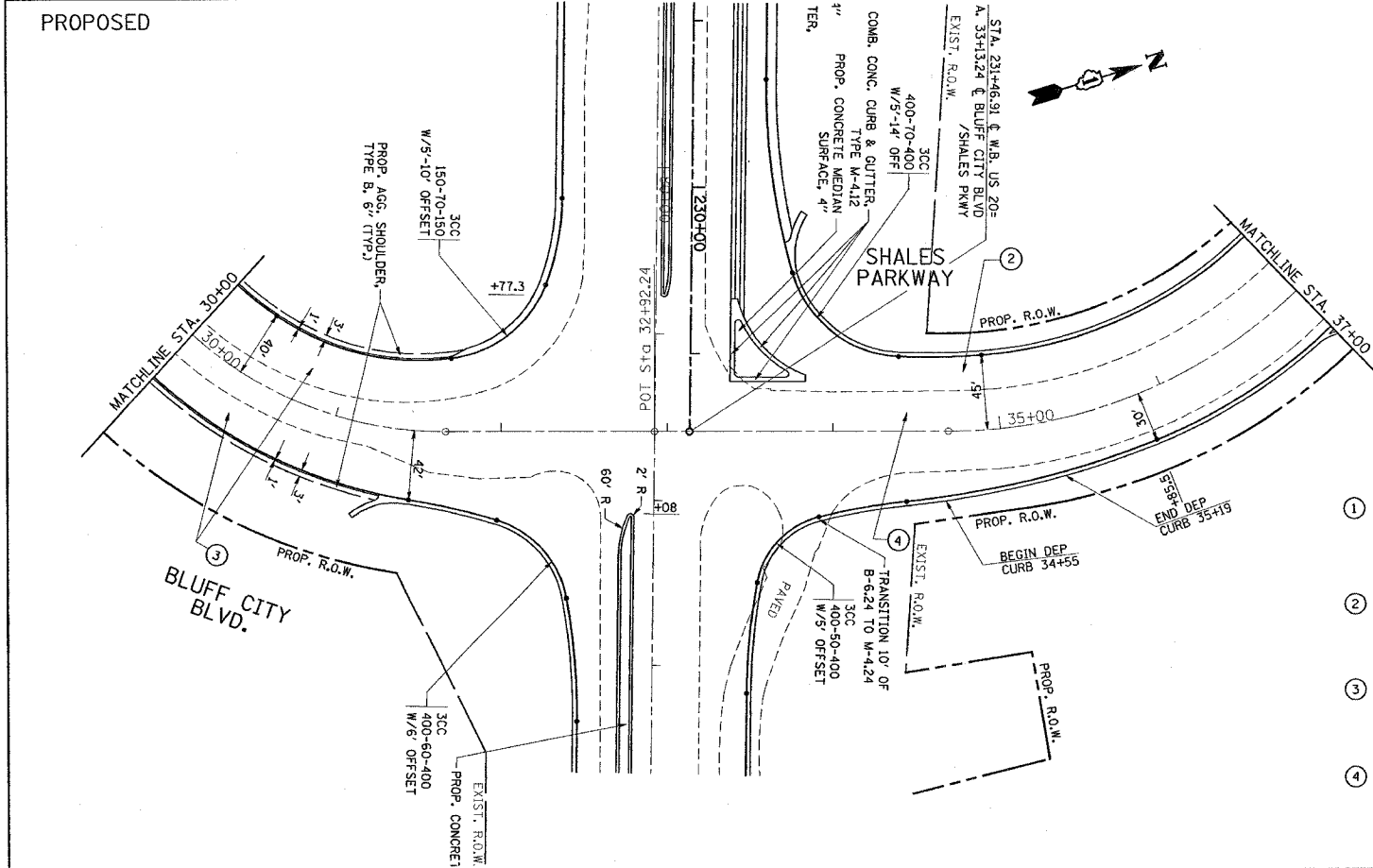

PROPOSED

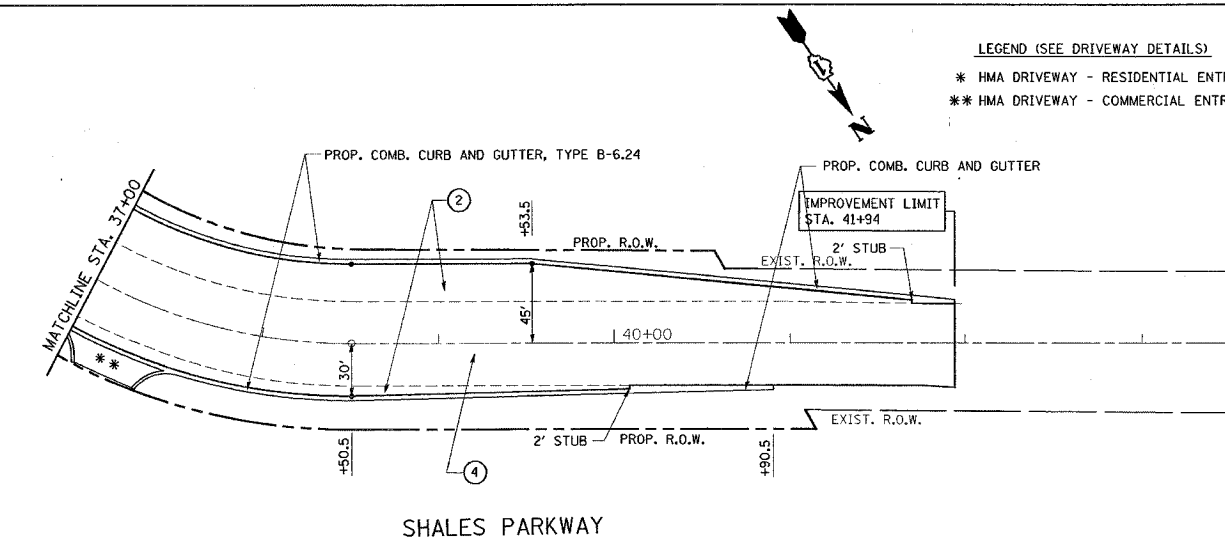

LEGEND (SEE DRIVEWAY DETAILS)  
 \* HMA DRIVEWAY - RESIDENTIAL ENTRANCE  
 \*\* HMA DRIVEWAY - COMMERCIAL ENTRANCE

- ① U.S. ROUTE 20 (WIDENING)  
 PROP. AGGREGATE SUBGRADE, 12"  
 PROP. POLY. HOT-MIX ASPHALT SURFACE COURSE, MIX "F", N90, 2"  
 PROP. HOT-MIX ASPHALT BASE COURSE WIDENING, 12"
- ② SHALES PKWY. (WIDENING)  
 PROP. AGGREGATE SUBGRADE, 12"  
 PROP. POLY. HOT-MIX ASPHALT SURFACE COURSE, MIX "F", N90, 2"  
 PROP. HOT-MIX ASPHALT BASE COURSE WIDENING, 1 3/4"
- ③ BLUFF CITY BLVD. (WIDENING)  
 PROP. AGGREGATE SUBGRADE, 12"  
 PROP. POLY. HOT-MIX ASPHALT SURFACE COURSE, MIX "F", N90, 2"  
 PROP. HOT-MIX ASPHALT BASE COURSE WIDENING, 10 3/4"
- ④ RESURFACING FOR EXISTING PAVEMENT  
 PROP. POLY. HOT-MIX ASPHALT SURFACE COURSE, MIX "F", N90, 2"

REVISIONS	
NAME	DATE

ILLINOIS DEPARTMENT OF TRANSPORTATION  
 EXISTING AND PROPOSED  
 ROADWAY PLAN  
 U.S. 20 AT  
 BLUFF CITY/ SHALES PKWY.

SCALE: VERT. 1" = 50'  
 HORIZ.  
 DATE 11/15/2007  
 DRAWN BY  
 CHECKED BY