

CONTRACT NO.				
F.A. RTE.	SECTION	COUNTY	TOTAL SHEETS	SHEET NO.
345	BR-1-N-1	Cook	196	30
STA.		TO STA.		
FED. ROAD DIST. NO.	ILLINOIS	FED. AID PROJECT		

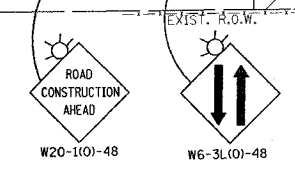
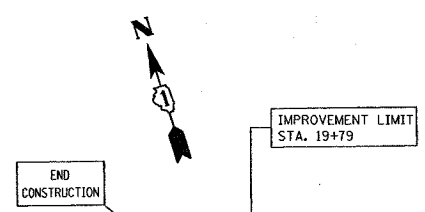
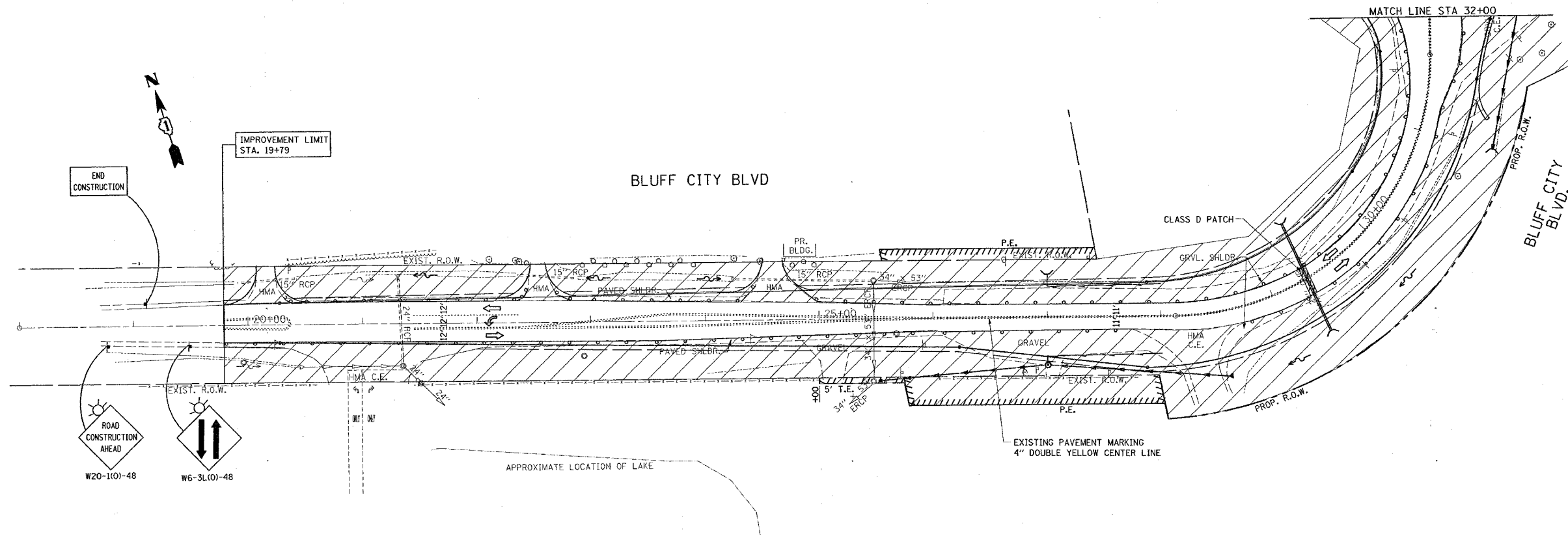

LEGEND

- SIGN
- DRUMS WITH STEADY BURN MONODIRECTIONAL LIGHT
- 50' C-C TANGENTS
- 25' C-C LANE SHIFTS & TAPERS
- 10' C-C RADII (TYP)
- WORK AREA

REVISIONS	
NAME	DATE

ILLINOIS DEPARTMENT OF TRANSPORTATION

STAGE I CONSTRUCTION
U.S. RTE. 20 @
SHALES PARKWAY AND BLUFF CITY BLVD.

SCALE: VERT. 1"=50'
 HORIZ. DATE 2/14/2008

DRAWN BY
 CHECKED BY MEA/MJ

PLOT DATE = 2/14/2008
 FILE NAME = d:\13783\sh.stage.dgn
 PLOT SCALE = 50,000% / IN.
 USER NAME = drvsklsgn