

F.A.P. RTE.	SECTION	COUNTY	TOTAL SHEETS	SHEET NO.
345	BR-1-N-1	COOK	196	66
STA.		TO STA.		
FED. ROAD DIST. NO.		ILLINOIS FED. AID PROJECT		

- NOTE:
1. TREES SHALL BE INSTALLED ON THE BACK SLOPE, NOT IN THE SWALE.
 2. THE SEEDING DATES FOR BARE EARTH SEEDING OF MIXTURE CLASS 4A SHALL BE FROM NOVEMBER 15 TO MARCH 31. ALL SEEDING NOT SHOWN ACCORDING TO THE SPECIFIED SEASONAL DATE SHALL REQUIRE PRIOR WRITTEN APPROVAL FROM THE ENGINEER. FAILURE TO SECURE SUCH APPROVAL SHALL RESULT IN THE REJECTION OF THE SEEDING AND REPLACEMENT BY THE CONTRACTOR AT HIS/HER EXPENSE.

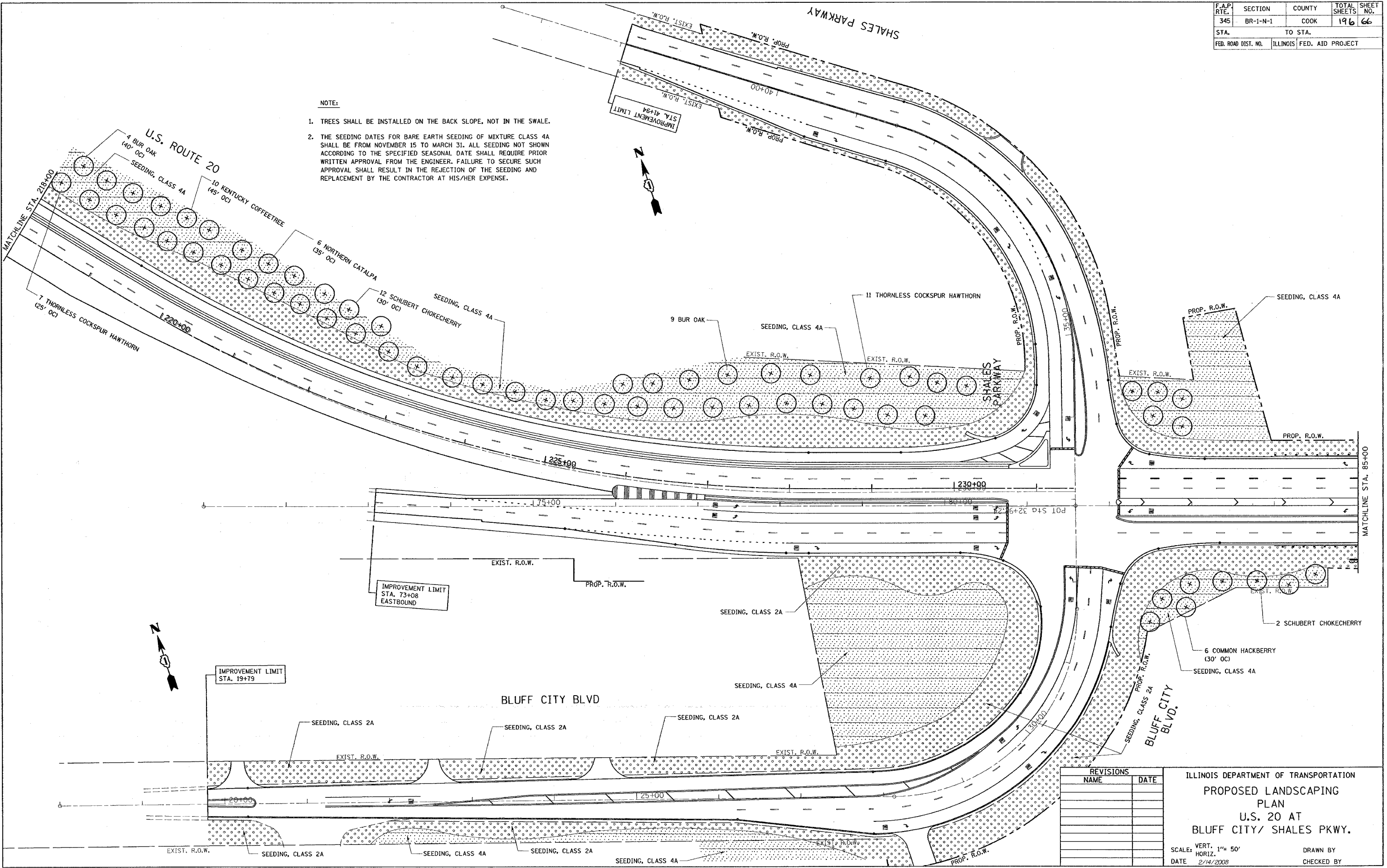

PLOT DATE = 2/14/2008
 FILE NAME = C:\Users\jdl37833\OneDrive\design
 PLOT SCALE = 5/8"=1'-0" / IN.
 USER NAME = drvakosgn

REVISIONS	
NAME	DATE

ILLINOIS DEPARTMENT OF TRANSPORTATION
 PROPOSED LANDSCAPING
 PLAN
 U.S. 20 AT
 BLUFF CITY/ SHALES PKWY.
 SCALE: VERT. 1"= 50'
 HORIZ. DATE 2/14/2008
 DRAWN BY
 CHECKED BY