

F.A.P. RTE.	SECTION	COUNTY	TOTAL SHEETS	SHEET NO.
345	BR-1-N-1	COOK	196	145
STA. 79+00=228+91.7		TO STA. 92+35		
FED. ROAD DIST. NO. 1 ILLINOIS		FED. AID PROJECT		
CONTRACT NO. 62617				

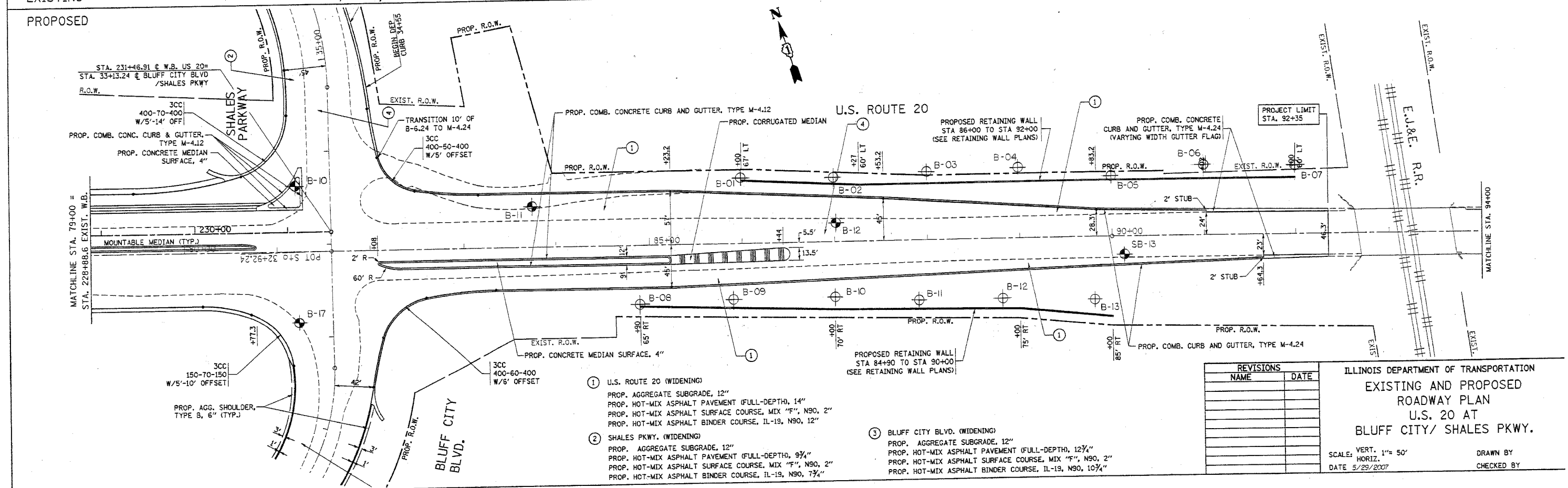
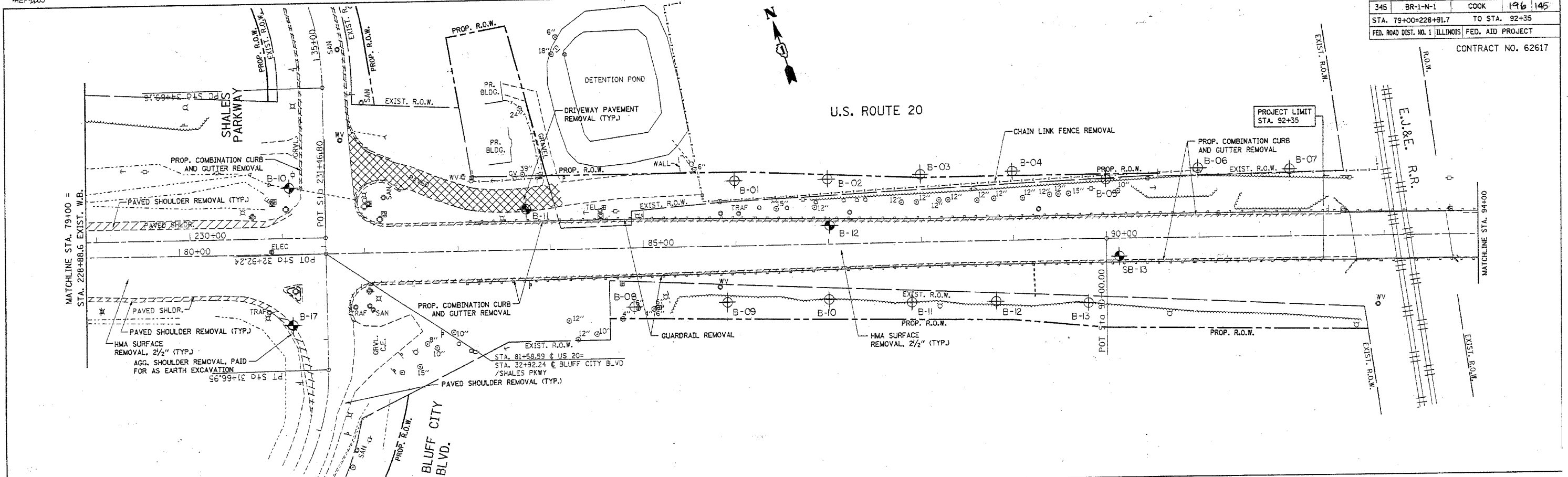

REVISIONS	
NAME	DATE

ILLINOIS DEPARTMENT OF TRANSPORTATION
EXISTING AND PROPOSED
ROADWAY PLAN
U.S. 20 AT
BLUFF CITY/ SHALES PKWY.

SCALE: VERT. 1" = 50'
HORIZ. 1" = 50'
DATE 5/29/2007

DRAWN BY
CHECKED BY