

F.A.U. RTE.	SECTION	COUNTY	TOTAL SHEETS	SHEET NO.
1321	(31&72S)RS-8	DUPAGE	37	1
			+3	
			*40	

STATE OF ILLINOIS
DEPARTMENT OF TRANSPORTATION
DIVISION OF HIGHWAYS

**PROPOSED
HIGHWAY PLANS**

**FAU ROUTE 1321: IL RTE. 19 (IRVING PARK RD.)
W/O MITCHELL BLVD. TO BAKER DR.
SECTION (31 & 72S) RS-8
RESURFACING (MAINTENANCE)
PROJECT NO.: ACM-1321(017)
DUPAGE COUNTY
C-91-085-04**

D-91-085-04

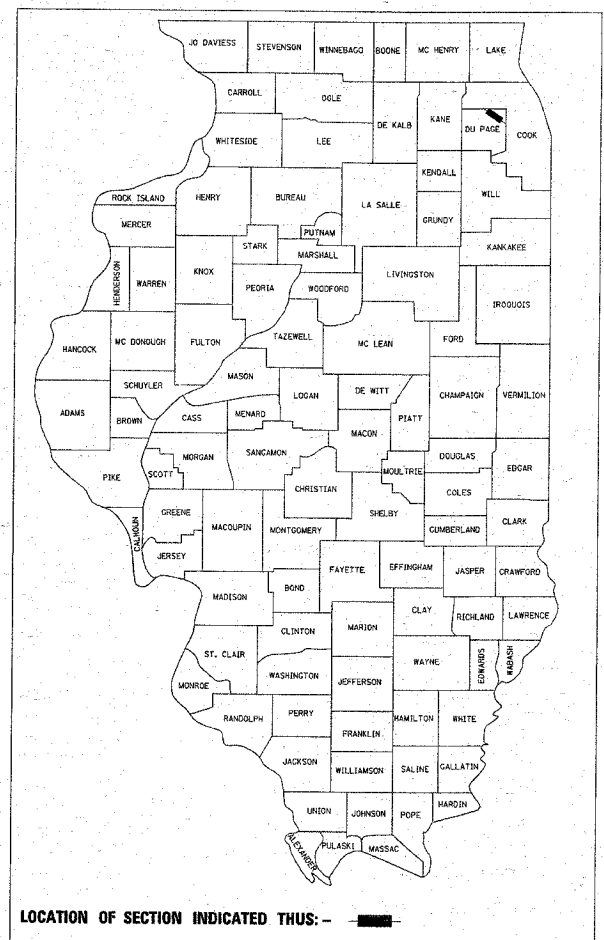

FOR INDEX OF SHEETS, SEE SHEET NO. 2

THE IMPROVEMENT IS LOCATED
IN THE VILLAGE OF ROSELLE

AVERAGE DAILY TRAFFIC = 17,700
POSTED SPEED LIMIT = 30-40 MPH

DISTRICT ONE - DESIGN AND PLAN PREPARATION ENGINEER: K. ENG / J.P. CHANG (847) 705 - 4432

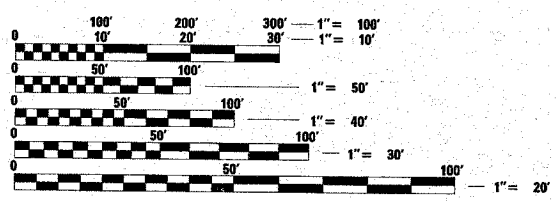

FULL SIZE PLANS HAVE BEEN PREPARED USING STANDARD ENGINEERING SCALES. REDUCED SIZED PLANS WILL NOT CONFORM TO STANDARD SCALES. IN MAKING MEASUREMENTS ON REDUCED PLANS, THE ABOVE SCALES MAY BE USED.

J.U.L.I.E.
JOINT UTILITY LOCATION INFORMATION FOR EXCAVATION
1-800-892-0123 OR 811

CONTRACT NO. 62703

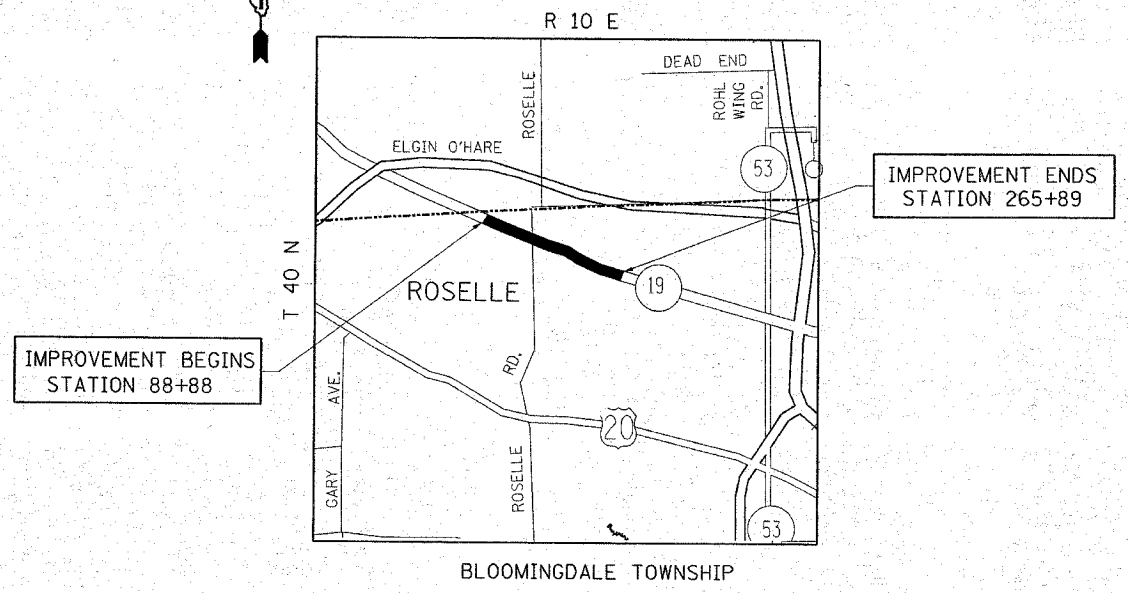

GROSS AND NET LENGTH OF IMPROVEMENT = 17,701 LINEAL FEET = 3.35 MILES

STATE OF ILLINOIS
DEPARTMENT OF TRANSPORTATION
DIVISION OF HIGHWAYS

SUBMITTED March 25 20 08

Dina Oll
DEPUTY DIRECTOR OF HIGHWAYS, REGION ENGINEER

May 9, 20 08
Eric E. Haran
ENGINEER OF DESIGN AND ENVIRONMENT

May 9, 20 08
Christine M. Reed
DIRECTOR OF HIGHWAYS, CHIEF ENGINEER

**PRINTED BY THE AUTHORITY
OF THE STATE OF ILLINOIS**