

FAH RTE.	SECTION	COUNTY	TOTAL SHEETS	SHEET NO.
1321	(31&725)RS-8	DUPAGE	37	25
FED. ROAD DIST. NO.		ILLINOIS FED. AID PROJECT		

CONTRACT NO. 62703

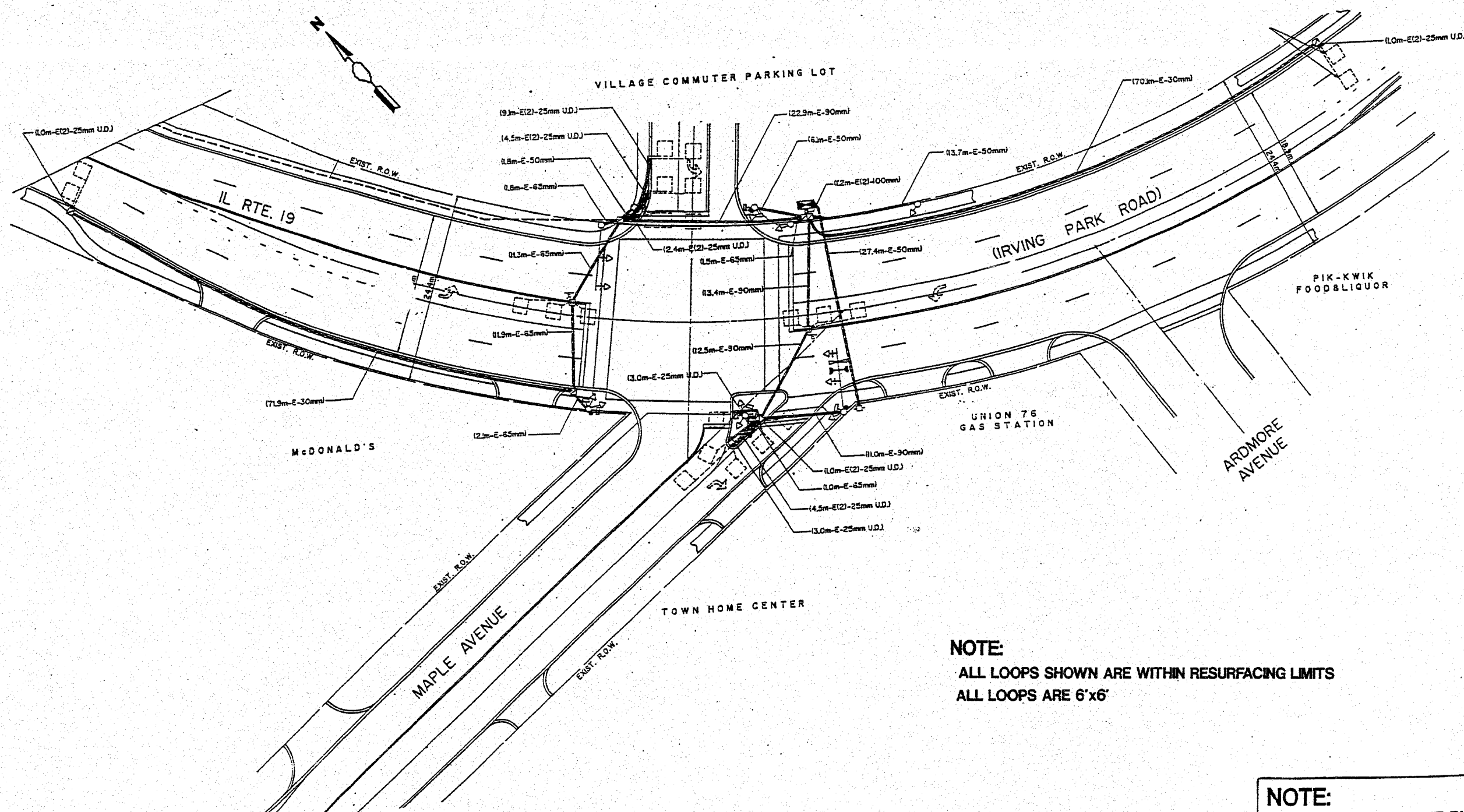

NOTE:
ALL LOOPS SHOWN ARE WITHIN RESURFACING LIMITS
ALL LOOPS ARE 6'x6'

NOTE:
THIS PLAN IS FOR THE PURPOSE OF
REPLACING THE DETECTOR LOOPS.
ALL OTHER INFORMATION SHOWN IS
NOT RELATED AND WILL BE
DISREGARDED.



ILLINOIS DEPARTMENT OF TRANSPORTATION
DETECTOR LOOPS AT:
IL RT 19 (IRVING PARK RD)
& MAPLE AVENUE

PLACE ALL DETECTOR LOOPS AS SHOWN
(WITHIN THE RESURFACING LIMITS)

CODE NO.	QUANTITY	UNIT	ITEM
38600600	761	FOOT	DETECTOR LOOP REPLACEMENT

SCALE: 1"=
DATE
DESIGNED BY:
DRAWN BY:
CHECKED BY: