

TRAFFIC SIGNAL LEGEND

	PROPOSED	EXISTING		PROPOSED	EXISTING
CONTROLLER CABINET			ALUMINUM MAST ARM ASSEMBLY AND POLE		
RAILROAD CONTROL CABINET			STEEL COMBINATION MAST ARM ASSEMBLY AND POLE WITH LUMINAIRE		
SERVICE INSTALLATION, (P) POLE OR (G) GROUND MOUNT			JUNCTION BOX		
TELEPHONE CONNECTION			HANDHOLE		
SIGNAL HEAD			HEAVY DUTY HANDHOLE		
SIGNAL HEAD WITH BACKPLATE			DOUBLE HANDHOLE		
SIGNAL HEAD OPTICALLY PROGRAMMED			G.S. CONDUIT IN TRENCH OR PUSHED		
SIGNAL HEAD PEDESTRIAN			COMMON TRENCH		
ILLUMINATED SIGN "NO LEFT TURN"			UNIT DUCT		
ILLUMINATED SIGN "NO RIGHT TURN"			PEDESTRIAN PUSHBUTTON DETECTOR		
SIGNAL POST			DETECTOR LOOP, TYPE I		
WOOD POLE			PREFORMED DETECTOR LOOP		
STEEL MAST ARM ASSEMBLY AND POLE			EMERGENCY VEHICLE SYSTEM DETECTOR		
UN-INTERRUPTIBLE POWER SUPPLY (UPS)			CONFIRMATION BEACON		

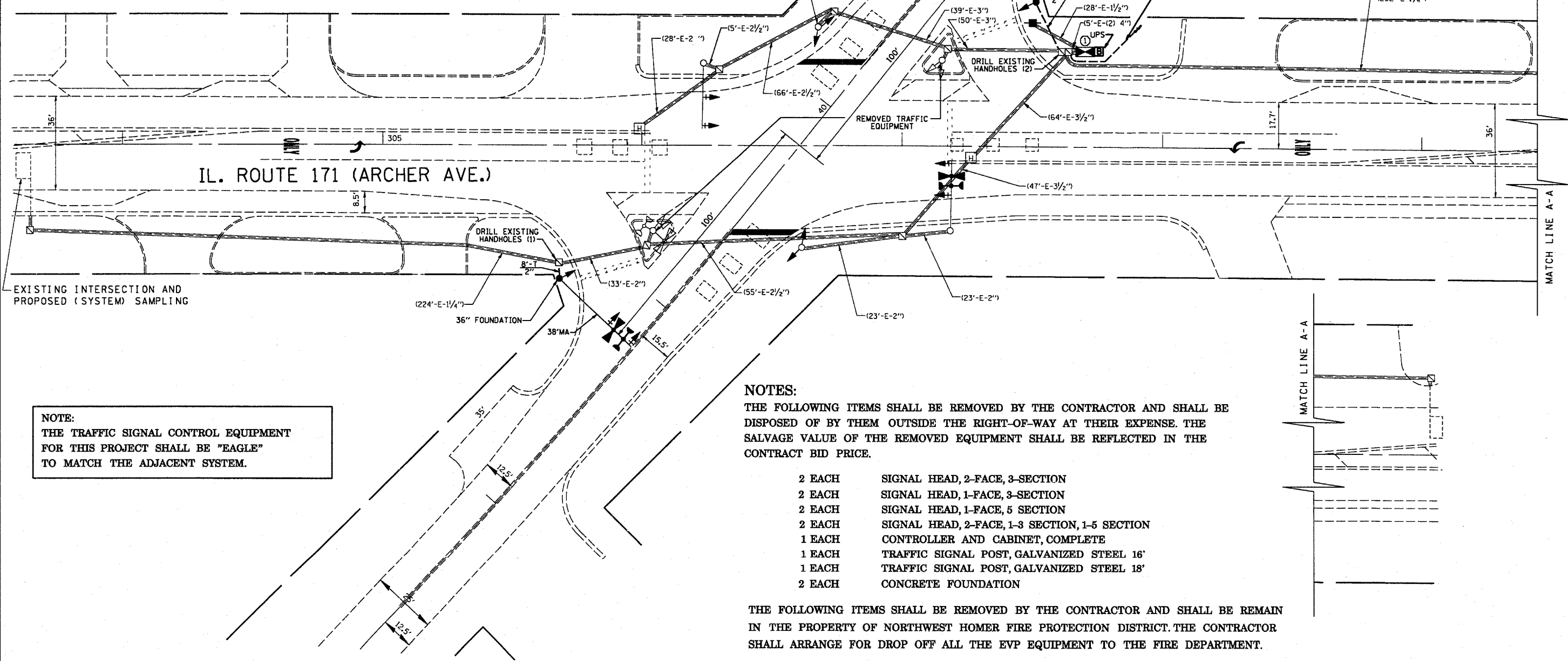

NOTE:
THE TRAFFIC SIGNAL CONTROL EQUIPMENT FOR THIS PROJECT SHALL BE "EAGLE" TO MATCH THE ADJACENT SYSTEM.

NOTES:
THE FOLLOWING ITEMS SHALL BE REMOVED BY THE CONTRACTOR AND SHALL BE DISPOSED OF BY THEM OUTSIDE THE RIGHT-OF-WAY AT THEIR EXPENSE. THE SALVAGE VALUE OF THE REMOVED EQUIPMENT SHALL BE REFLECTED IN THE CONTRACT BID PRICE.

- 2 EACH SIGNAL HEAD, 2-FACE, 3-SECTION
- 2 EACH SIGNAL HEAD, 1-FACE, 3-SECTION
- 2 EACH SIGNAL HEAD, 1-FACE, 5 SECTION
- 2 EACH SIGNAL HEAD, 2-FACE, 1-3 SECTION, 1-5 SECTION
- 1 EACH CONTROLLER AND CABINET, COMPLETE
- 1 EACH TRAFFIC SIGNAL POST, GALVANIZED STEEL 16'
- 1 EACH TRAFFIC SIGNAL POST, GALVANIZED STEEL 18'
- 2 EACH CONCRETE FOUNDATION

THE FOLLOWING ITEMS SHALL BE REMOVED BY THE CONTRACTOR AND SHALL BE REMAIN IN THE PROPERTY OF NORTHWEST HOMER FIRE PROTECTION DISTRICT. THE CONTRACTOR SHALL ARRANGE FOR DROP OFF ALL THE EVP EQUIPMENT TO THE FIRE DEPARTMENT.

- 1 EACH LIGHT DETECTOR AMPLIFIER
- 2 EACH LIGHT DETECTOR