

INTERCONNECT PLAN LEGEND

PROPOSED	EXISTING	
		CONTROLLER
		HANDHOLE
		DOUBLE HANDHOLE
		HEAVY DUTY HANDHOLE
		G.S. CONDUIT IN TRENCH (T) OR PUSHED (P)
		DETECTOR LOOP
		UNIT DUCT
		SYSTEM
		INTERSECTION

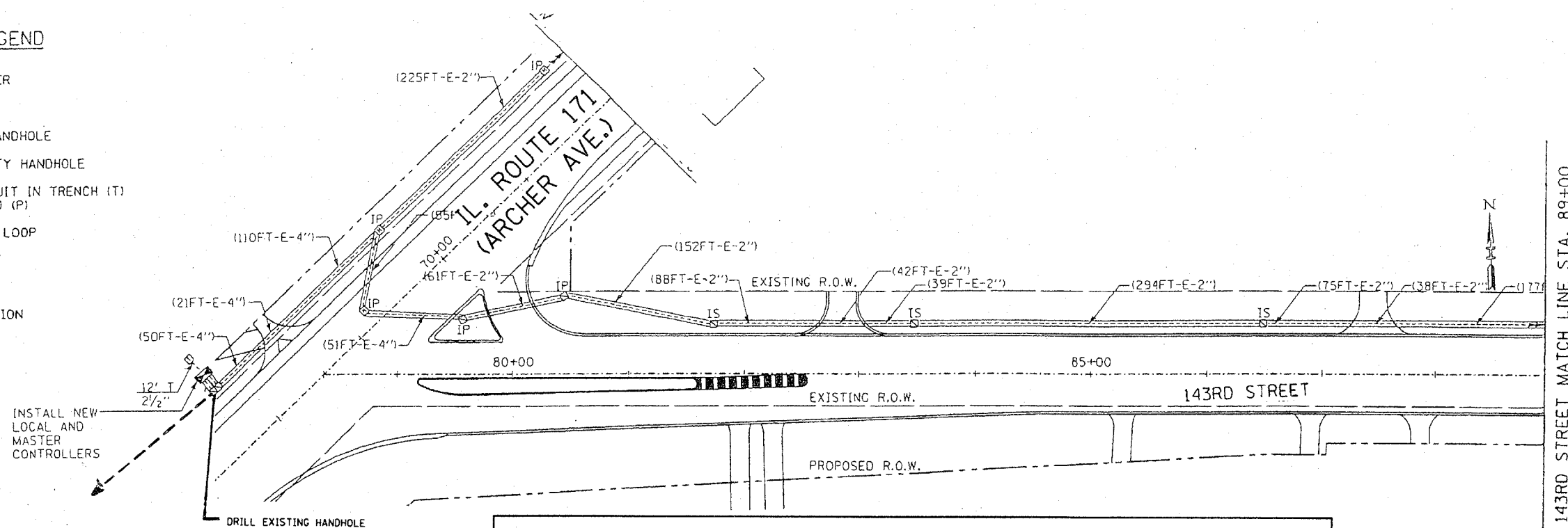

INFORMATION ONLY
 THIS SHEET IS USED TO SHOW THE PROPOSED
 AND EXISTING TRAFFIC SIGNAL INTERCONNECT SYSTEM

143RD STREET MATCH LINE STA. 89+00

143RD STREET MATCH LINE STA. 89+00

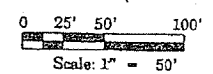
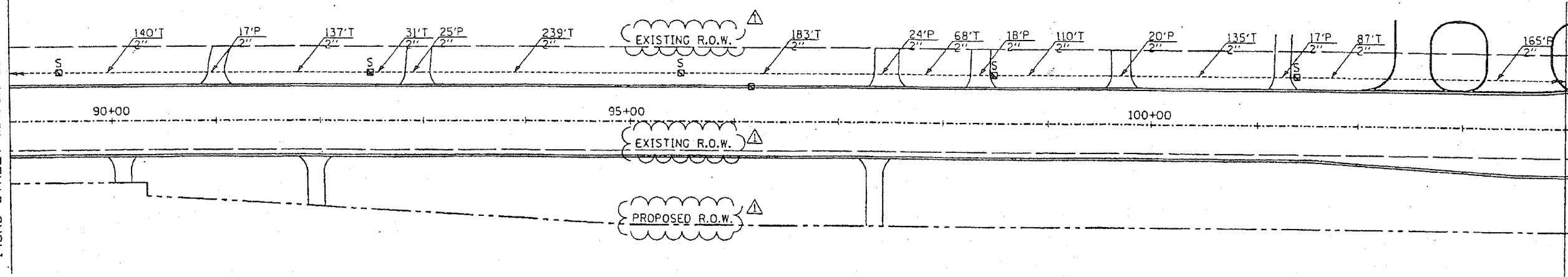

DRAWN: PZ CHECKED: RS	DATE: JULY, 2006 SCALE: 1"=50'	TYLIN INTERNATIONAL	THE ILLINOIS STATE TOLL HIGHWAY AUTHORITY 2700 OGDEN AVENUE DOWNERS GROVE, ILLINOIS 60515	<table border="1"> <thead> <tr> <th colspan="3">REVISIONS</th> </tr> <tr> <th>NO.</th> <th>DATE</th> <th>DESCRIPTION</th> </tr> </thead> <tbody> <tr> <td>1</td> <td>08/18/06</td> <td>ADDENDUM NO. 1 REVISIONS</td> </tr> </tbody> </table>	REVISIONS			NO.	DATE	DESCRIPTION	1	08/18/06	ADDENDUM NO. 1 REVISIONS	CONTRACT NO. I-05-7710 TRAFFIC SIGNAL INTERCONNECTS 143RD ST. STA. 79+00 TO 104+00	DRAWING NO.
REVISIONS															
NO.	DATE	DESCRIPTION													
1	08/18/06	ADDENDUM NO. 1 REVISIONS													

FILE NAME: c:\projects\1000404\100404.dgn USER NAME: nguyensm DESIGNED: SN DRAWN: SN CHECKED: DAD PLOT DATE: 3/27/2008	REVISIONS: REVISED: - REVISED: - REVISED: - REVISED: -	STATE OF ILLINOIS DEPARTMENT OF TRANSPORTATION	INTERCONNECT PLAN IL. 171 (ARCHER AVE.) FROM 143RD STREET TO SMITH ROAD SCALE: SHEET NO. OF SHEETS STA. TO STA.	F.A.P. RTE. 577 SECTION 2004-019 TS COUNTY WILL TOTAL SHEETS 13 SHEET NO. 12 CONTRACT NO. 62738 FED. ROAD DIST. NO. 1 ILLINOIS FED. AID PROJECT
---	--	---	---	---