

LEGEND:

- | | |
|--|--|
| 1 THERMOPLASTIC PAVEMENT MARKING - LINE 4" (YELLOW SOLID LINE) | 6 THERMOPLASTIC PAVEMENT MARKING - LINE 6" (WHITE SOLID LINE) |
| 2 THERMOPLASTIC PAVEMENT MARKING - LINE 4" (YELLOW SKIP DASH - 10' DASH, 30' SKIP) | 7 THERMOPLASTIC PAVEMENT MARKING - LINE 12" (YELLOW DIAGONAL LINE) |
| 3 THERMOPLASTIC PAVEMENT MARKING - LINE 4" (DOUBLE YELLOW SOLID LINE 11" C-C) | 8 THERMOPLASTIC PAVEMENT MARKING - LINE 24" (WHITE STOP LINE) |
| 4 THERMOPLASTIC PAVEMENT MARKING - LINE 6" (WHITE LANE LINE - 2' DASH, 6' SKIP) | 9 THERMOPLASTIC PAVEMENT MARKING - LETTERS & SYMBOLS (TYP.) |
| 5 THERMOPLASTIC PAVEMENT MARKING - LINE 4" (WHITE LANE LINE - 10' DASH, 30' SKIP) WITH RAISED REFLECTIVE PAVEMENT MARKERS (2 ONE-WAY CRYSTAL MARKER) | 10 THERMOPLASTIC PAVEMENT MARKING - LINE 4" (WHITE SOLID LINE) |
| | 11 RAISED REFLECTIVE PAVEMENT MARKERS (TWO-WAY AMBER MARKER) (80' C-C) |

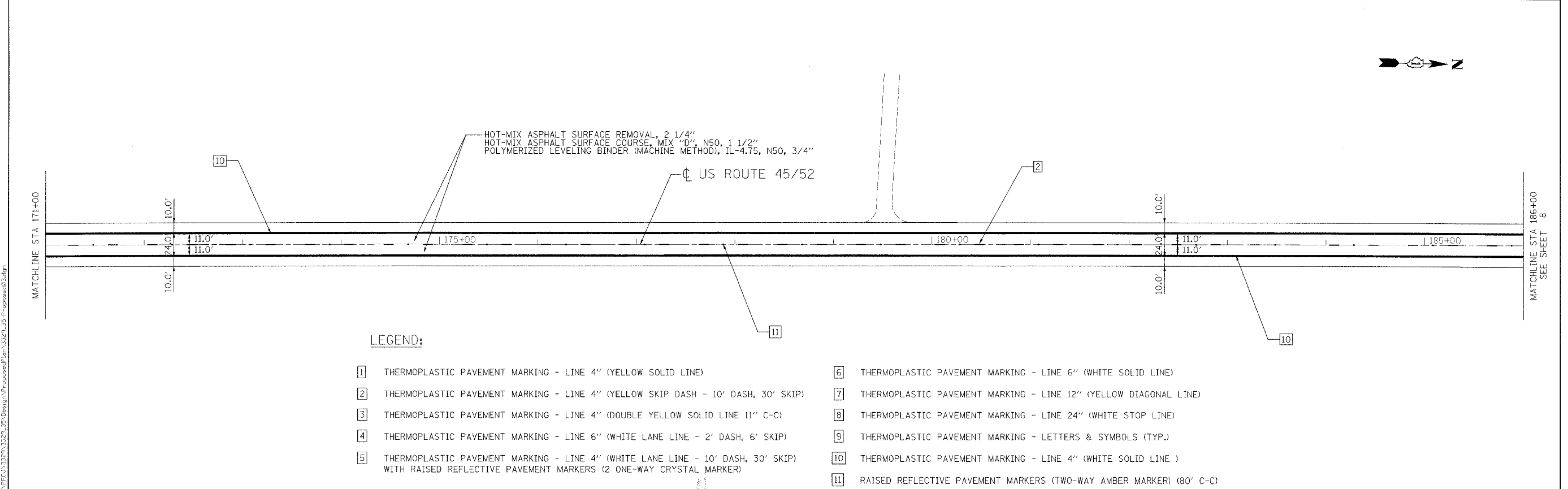

LEGEND:

- | | |
|--|--|
| 1 THERMOPLASTIC PAVEMENT MARKING - LINE 4" (YELLOW SOLID LINE) | 6 THERMOPLASTIC PAVEMENT MARKING - LINE 6" (WHITE SOLID LINE) |
| 2 THERMOPLASTIC PAVEMENT MARKING - LINE 4" (YELLOW SKIP DASH - 10' DASH, 30' SKIP) | 7 THERMOPLASTIC PAVEMENT MARKING - LINE 12" (YELLOW DIAGONAL LINE) |
| 3 THERMOPLASTIC PAVEMENT MARKING - LINE 4" (DOUBLE YELLOW SOLID LINE 11" C-C) | 8 THERMOPLASTIC PAVEMENT MARKING - LINE 24" (WHITE STOP LINE) |
| 4 THERMOPLASTIC PAVEMENT MARKING - LINE 6" (WHITE LANE LINE - 2' DASH, 6' SKIP) | 9 THERMOPLASTIC PAVEMENT MARKING - LETTERS & SYMBOLS (TYP.) |
| 5 THERMOPLASTIC PAVEMENT MARKING - LINE 4" (WHITE LANE LINE - 10' DASH, 30' SKIP) WITH RAISED REFLECTIVE PAVEMENT MARKERS (2 ONE-WAY CRYSTAL MARKER) | 10 THERMOPLASTIC PAVEMENT MARKING - LINE 4" (WHITE SOLID LINE) |
| | 11 RAISED REFLECTIVE PAVEMENT MARKERS (TWO-WAY AMBER MARKER) (80' C-C) |

FILE NAME = N:\PROJECTS\3279\3279_35\Design\ProposedPlan\3279L35_Proposed03.dwg

Ciorba Group, Inc.
 CONSULTING ENGINEERS
 5507 North Cumberland Avenue, Suite 402
 Chicago, Illinois 60656
 Tel. 773.775.4009 Fax 773.775.4014

USER NAME = mbalog	DESIGNED - NT	REVISED -
PLOT SCALE = 50.0000' / IN.	DRAWN - NT	REVISED -
PLOT DATE = 4/8/2008	CHECKED - WBL	REVISED -
	DATE - 4/7/2008	REVISED -

**STATE OF ILLINOIS
 DEPARTMENT OF TRANSPORTATION**

**US ROUTE 45/52
 STUENKEL ROAD TO KANKAKEE COUNTY LINE
 PROPOSED ROADWAY AND PAVEMENT MARKING PLAN**

SCALE: SHEET NO. OF SHEETS STA. TO STA.

F.A.P. RTE. 330	SECTION 17 RS-3	COUNTY WILL	TOTAL SHEETS NO. 32	SHEET NO. 7
FED. ROAD DIST. NO. - ILLINOIS			FED. AID PROJECT CONTRACT NO. 62749	