

F.A.I.	SECTION	COUNTY	TOTAL SHEETS	SHEET NO.
94/90	*	COOK	37	13
STA.		TO STA.		
62992		• (2323.6-2P&2324.6-1P)		
FED. ROAD DIST. NO.	ILLINOIS	FED. AID PROJECT		

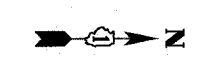
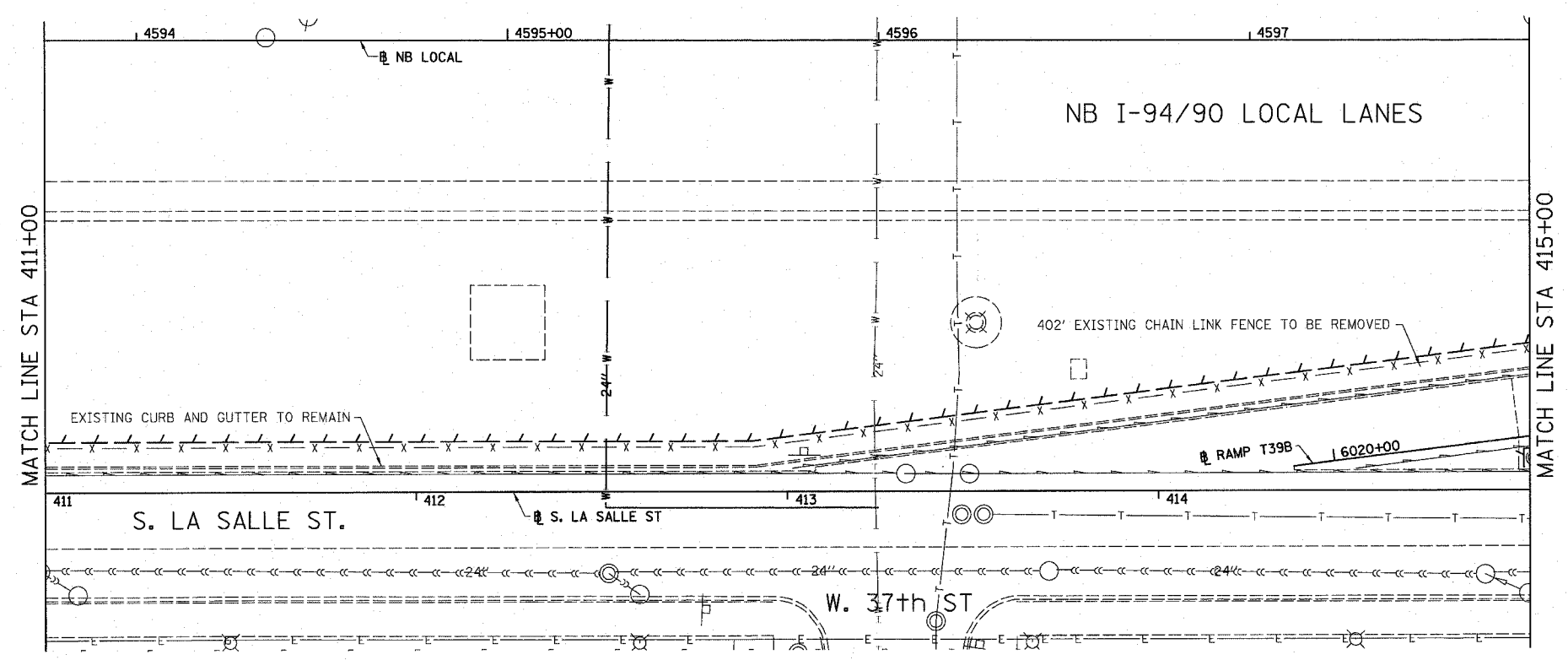

LEGEND:

LINEAR REMOVALS

EXISTING CONDITIONS AND REMOVAL  
PROPOSED IMPROVEMENTS

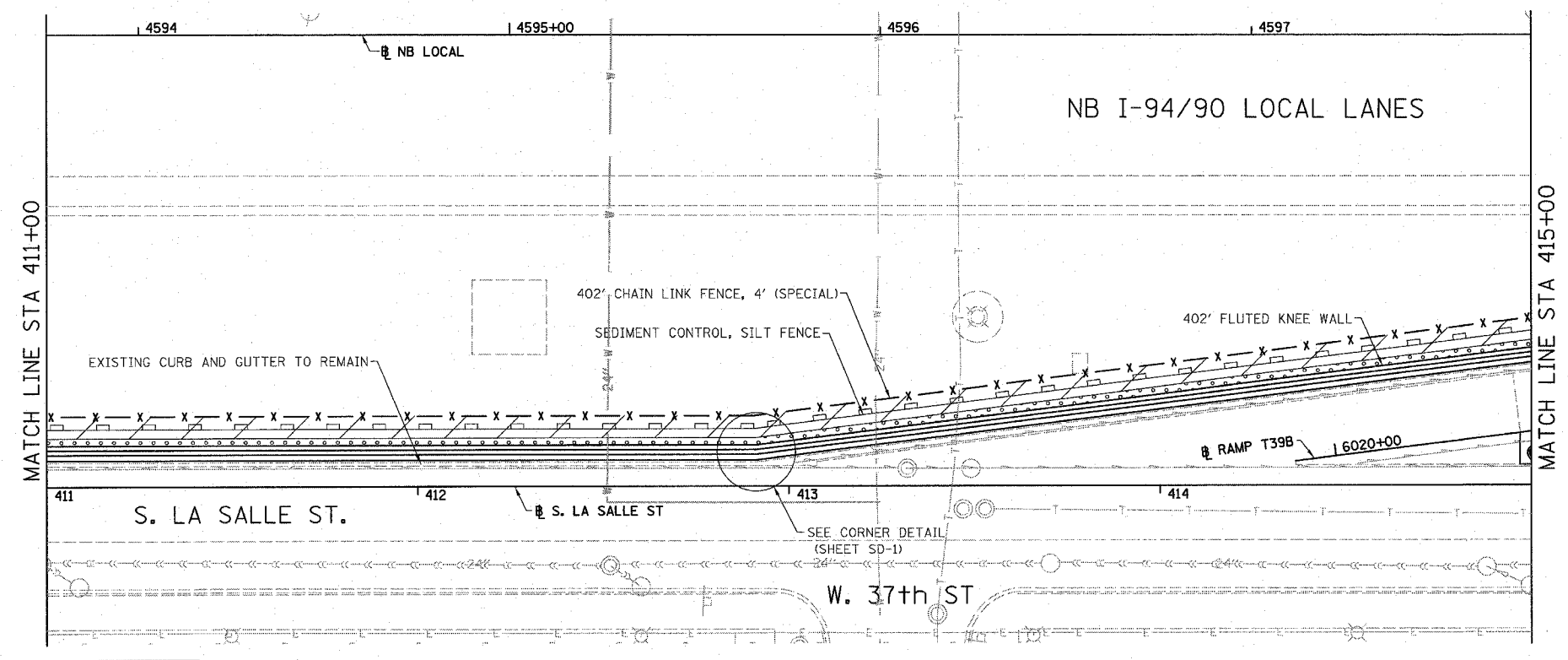
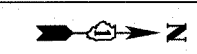

LEGEND:

SEEDING, CLASS 2A EROSION CONTROL BLANKET	
SEEDING, CLASS 4 (MODIFIED) SEEDING CLASS 5A (MODIFIED) EROSION CONTROL BLANKET	
TOPSOIL FURNISH AND PLACE, 4" SEEDING, CLASS 2A EROSION CONTROL BLANKET	
TOPSOIL FURNISH AND PLACE, 12" SEEDING, CLASS 2A EROSION CONTROL BLANKET	
TOPSOIL FURNISH AND PLACE, 12" SEEDING CLASS 4 (MODIFIED) SEEDING, CLASS 5A (MODIFIED) EROSION CONTROL BLANKET	

- NOTES:
- SEE STRUCTURAL DETAIL FOR FLUTED KNEE WALL DETAILS.
  - ALL POINT CALLOUTS ARE TAKEN AT THE EDGE OF THE KNEE WALL BASE.

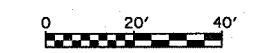

REVISIONS	
NAME	DATE
REVISED	3-6-08
REVISED	5-30-08

ILLINOIS DEPARTMENT OF TRANSPORTATION  
F.A.I. 94/90 (DAN RYAN EXPRESSWAY)  
NORTHBOUND KNEE WALLS (PERSHING RD TO 35TH ST)

EXISTING AND PROPOSED  
KNEE WALL PLANS

SCALE: 1"=20'  
DATE: 03/06/08

DRAWN BY: JDC  
CHECKED BY: DDM

PL-4  
44/28 5/25/2008

BOWMAN, BARRETT & ASSOCIATES INC.  
CONSULTING ENGINEERS  
Chicago, Illinois  
312.228.0100  
www.bbainc.com