

F.A.I.	SECTION	COUNTY	TOTAL SHEETS	SHEET NO.
94/90		COOK	29	3
STA.	TO STA.			
FED. ROAD DIST. NO.	ILLINOIS	FED. AID PROJECT		

62993

SUMMARY OF QUANTITIES

CODE NO.	ITEM	UNIT	URBAN	
			QUANTITY	100% STATE JOOO
20200100	EARTH EXCAVATION	CU YD	280	280
21101615	TOPSOIL FURNISH AND PLACE, 4"	SQ YD	59	59
21101645	TOPSOIL FURNISH AND PLACE, 12"	SQ YD	209	209
25000210	SEEDING, CLASS 2A	ACRE	0.16	0.16
25000400	NITROGEN FERTILIZER NUTRIENT	POUND	14	14
25000500	PHOSPHORUS FERTILIZER NUTRIENT	POUND	14	14
25000600	POTASSIUM FERTILIZER NUTRIENT	POUND	14	14
25000800	GROUND PREPARATION FOR SEEDING	ACRE	0.16	0.16
25100630	EROSION CONTROL BLANKET	SQ YD	484	484
42001300	PROTECTIVE COAT	SQ YD	58	58
44002020	CONCRETE MEDIAN SURFACE REMOVAL	SQ FT	345	345
44004250	PAVED SHOULDER REMOVAL	SQ YD	162	162
50300225	CONCRETE STRUCTURES	CU YD	2.3	2.3
50300255	CONCRETE SUPERSTRUCTURE	CU YD	10.9	10.9
50300300	PROTECTIVE COAT	SQ YD	25	25
50300510	RUSTICATION FINISH	SQ FT	36	36
50800205	REINFORCEMENT BARS, EPOXY COATED	POUND	650	650
60618324	CONCRETE MEDIAN SURFACE, 6" (SPECIAL)	SQ FT	509	509
66400550	CHAIN LINK FENCE, 4" (SPECIAL)	FOOT	1,138	1,138
67100100	MOBILIZATION	L SUM	1	1
70101800	TRAFFIC CONTROL AND PROTECTION, (SPECIAL)	L SUM	1	1
X0322256	TEMPORARY INFORMATION SIGNING	SQ FT	26	26
X0323973	SEDIMENT CONTROL, SILT FENCE	FOOT	1,230	1,230
X0323974	SEDIMENT CONTROL, SILT FENCE MAINTENANCE	FOOT	308	308
X0324640	FLUTED KNEE WALL	FOOT	1,177	1,177
X0350810	BOLLARD REMOVAL	EACH	3	3
X6065740	CONCRETE MEDIAN SURFACE, 5" (MODIFIED)	SQ FT	12	12
70106800	CHANGEABLE MESSAGE SIGN	CAL MO	6	6
Z0013798	CONSTRUCTION LAYOUT	L SUM	1	1
Z0029999	IMPACT ATTENUATOR REMOVAL	EACH	1	1
X0325091	IMPACT ATTENUATORS (FULLY REDIRECTIVE, ^{RESETTABLE}), TEST LEVEL 2	EACH	1	1
Z0076600	TRAINING	HOURL		
44008300	CURB REMOVAL (PARTIAL)	FOOT	92	92
63700155	CONCRETE BARRIER, SINGLE FACE, 32 INCH HEIGHT	FOOT	8	8
X0324112	BARRIER BASE	FOOT	8	8

INDEX OF SHEETS

SHEET	DESCRIPTION
1	COVER SHEET
2	GENERAL NOTES AND PROJECT COMMITMENTS
3	SUMMARY OF QUANTITIES / INDEX / HIGHWAY STANDARDS
4	EXISTING AND PROPOSED TYPICAL SECTIONS
5-9	ALIGNMENT PLANS, SURVEY TIES AND CONTROL POINTS
10-13	EXISTING AND PROPOSED KNEE WALL PLANS
14-17A	STRUCTURAL DETAILS
18	BD-51 DISTRICT 1, BENCHING DETAIL FOR EMBANKMENT WIDENING
19	TC-10 DISTRICT 1, TRAFFIC CONTROL AND PROTECTION FOR SIDE ROADS, INTERSECTIONS & DRIVEWAYS
20	TC-17 DISTRICT 1, TRAFFIC CONTROL DETAILS FOR FREEWAY SHOULDER CLOSURES PARTIAL RAMP CLOSURES
21	TC-18 DISTRICT 1, SIGNING FOR FLAGGING OPERATIONS AT WORK ZONE OPENINGS
22	TC-22 DISTRICT 1, ARTERIAL ROAD INFORMATION SIGN
23-29	CROSS SECTIONS

IDOT HIGHWAY STANDARDS

SHEET	DESCRIPTION
000001-05	STANDARD SYMBOLS, ABBREVIATIONS, AND PATTERNS
001001-01	AREAS OF REINFORCEMENT BARS
001006	DECIMAL OF AN INCH AND OF A FOOT
664001-01	CHAIN LINK FENCE
701601-05	URBAN LANE CLOSURE, MULTILANE, 1W OR 2W WITH NONTRAVERSABLE MEDIAN
701701-05	URBAN LANE CLOSURE, MULTILANE INTERSECTION
701801-05	LANE CLOSURE, MULTILANE, 1W OR 2W, CROSSWALK OR SIDEWALK CLOSURE, for speeds < 45 mph
701901	TRAFFIC CONTROL DEVICES
720001	SIGN PANEL MOUNTING DETAILS
720006-01	SIGN PANEL ERECTION DETAILS
728001	TELESCOPING STEEL SIGN SUPPORT
731001	BASE FOR TELESCOPING STEEL SIGN SUPPORT

BOWMAN, BARRETT & ASSOCIATES INC.
CONSULTING ENGINEERS
Chicago, Illinois
312.228.0100
www.bbainc.com

ILLINOIS DEPARTMENT OF TRANSPORTATION
F.A.I. 94/90 (DAN RYAN EXPRESSWAY)
NORTHBOUND KNEE WALLS (35TH ST TO 33RD ST)
SUMMARY OF QUANTITIES
INDEX OF SHEETS
HIGHWAY STANDARDS

SCALE: NONE
DATE: 02/08/08

DRAWN BY: JDC
CHECKED BY: DDM

Rev. 4-3-08

S00-1
3.05.02 PM
2/12/2008

F.A.I.	SECTION	COUNTY	TOTAL SHEETS	SHEET NO.
94/90	*	COOK	29	4
STA.	TO STA.			
FED. ROAD DIST. NO.	ILLINOIS	FED. AID PROJECT		
62993		2324.6-1P-1-1		

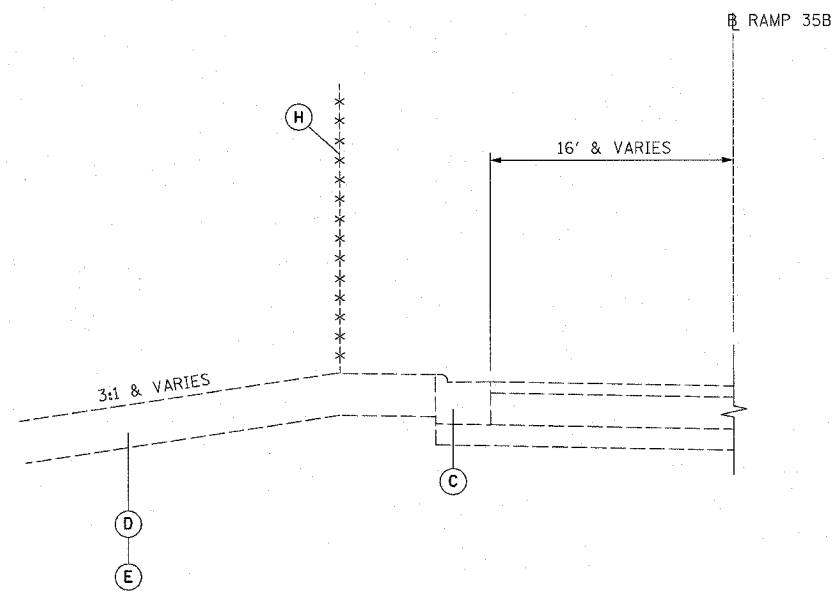

STA. 427+52 to 6001+02

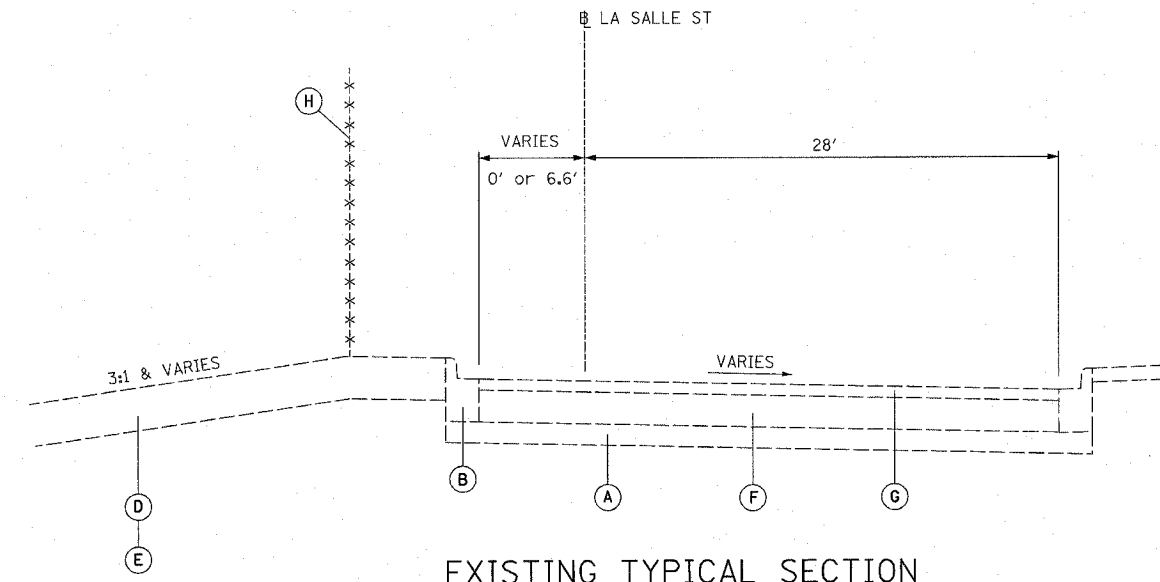

EXISTING TYPICAL SECTION

STA. 427+14 to 427+52
STA. 430+24 to 439+52

EXISTING LEGEND

- (A) GRANULAR MATERIAL, 6"
- (B) COMBINATION CONCRETE CURB AND GUTTER, TYPE B-6.12
- (C) COMBINATION CONCRETE CURB AND GUTTER, TYPE M-4.24
- (D) TOPSOIL, 4"
- (E) TOPSOIL, 12"
- (F) PORTLAND CEMENT CONCRETE PAVEMENT, 9"
- (G) BITUMINOUS CONCRETE, 3"
- (H) CHAIN LINK FENCE, 4'

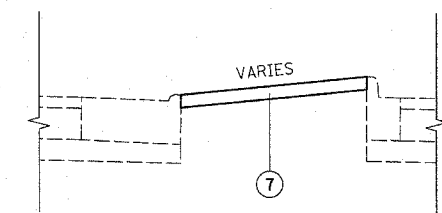

TYPICAL MEDIAN TREATMENT

STA. 429+84.73 to 430+71

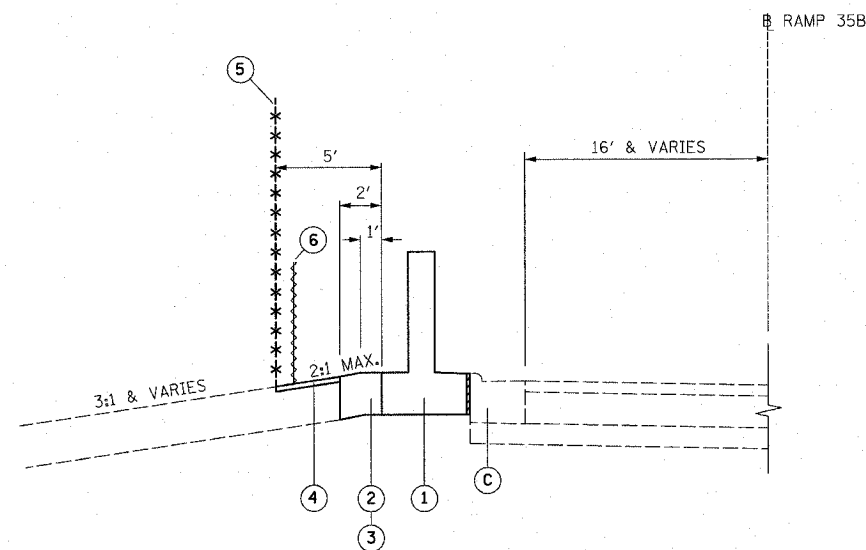

STA. 427+52 to 6001+02

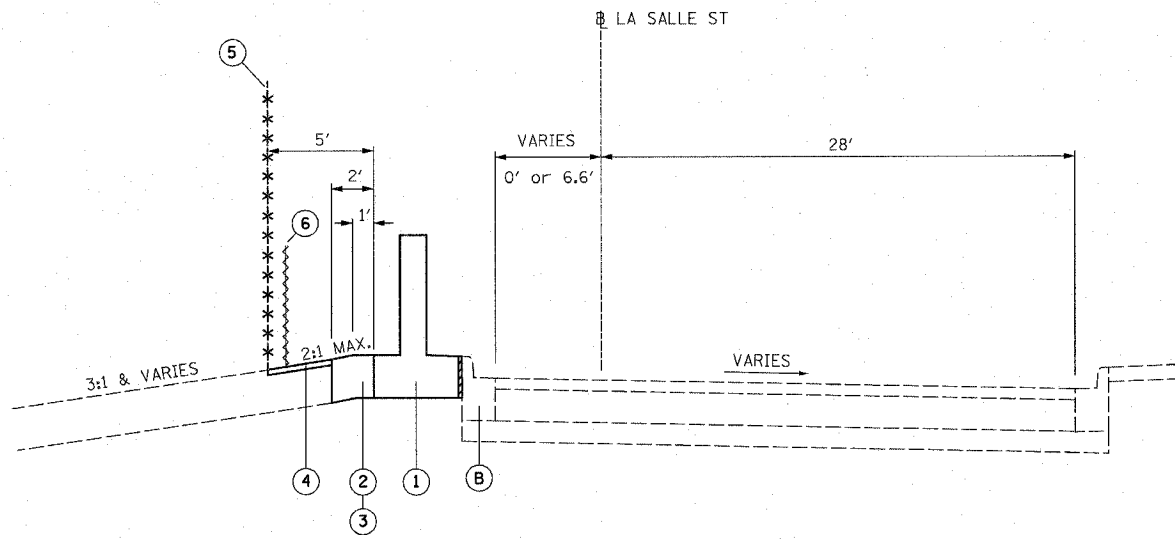

PROPOSED TYPICAL SECTION

STA. 427+14 to 427+52
STA. 430+24 to 439+52

PROPOSED LEGEND

- (1) FLUTED KNEE WALL
- (2) SEEDING CLASS 2A / TOPSOIL FURNISH AND PLACE, 4" / EROSION CONTROL BLANKET
- (3) SEEDING, CLASS 2A / TOPSOIL FURNISH AND PLACE, 12" / EROSION CONTROL BLANKET
- (4) SEEDING, CLASS 2A / EROSION CONTROL BLANKET
- (5) CHAIN LINK FENCE, 4' (SPECIAL)
- (6) SEDIMENT CONTROL, SILT FENCE (TO BE REMOVED AT PROJECT COMPLETION)
- (7) CONCRETE MEDIAN SURFACE, 6" (SPECIAL)

TYP-1

NOTES:

1. THICKNESS OF EXISTING PAVEMENT AND GRANULAR MATERIAL ARE TAKEN FROM RECORD DRAWING PLANS.
2. TYPICAL SECTIONS NEED TO BE VERIFIED WITH THE PLANS AS THEY ARE A REPRESENTATION OF THE PLANS. THEY DO NOT SHOW ALL CONFIGURATIONS, JUST THE MOST PREDOMINANT.

REVISIONS	
NAME	DATE
REVIS	3-6-08
REVIS	5-30-08

ILLINOIS DEPARTMENT OF TRANSPORTATION
F.A.I. 94/90 (DAN RYAN EXPRESSWAY)
NORTHBOUND KNEE WALLS (35TH ST TO 33RD ST)

TYPICAL SECTIONS

SCALE: NTS
DATE: 03/06/08
DRAWN BY: JDC
CHECKED BY: RS

BOWMAN, BARRETT & ASSOCIATES INC.
CONSULTING ENGINEERS
Chicago, Illinois
312.228.0100
www.bbandainc.com

I:\660\road\cwin\31P\SHEETS\660_31P_C1_000.dwg 5/29/2008 4:50:11 PM

F.A.I.	SECTION	COUNTY	TOTAL SHEETS	SHEET NO.
94/90		COOK	29	10
STA.		TO STA.		
62993		ILLINOIS FED. AID PROJECT		
		• 2324.6-1P-1-1		

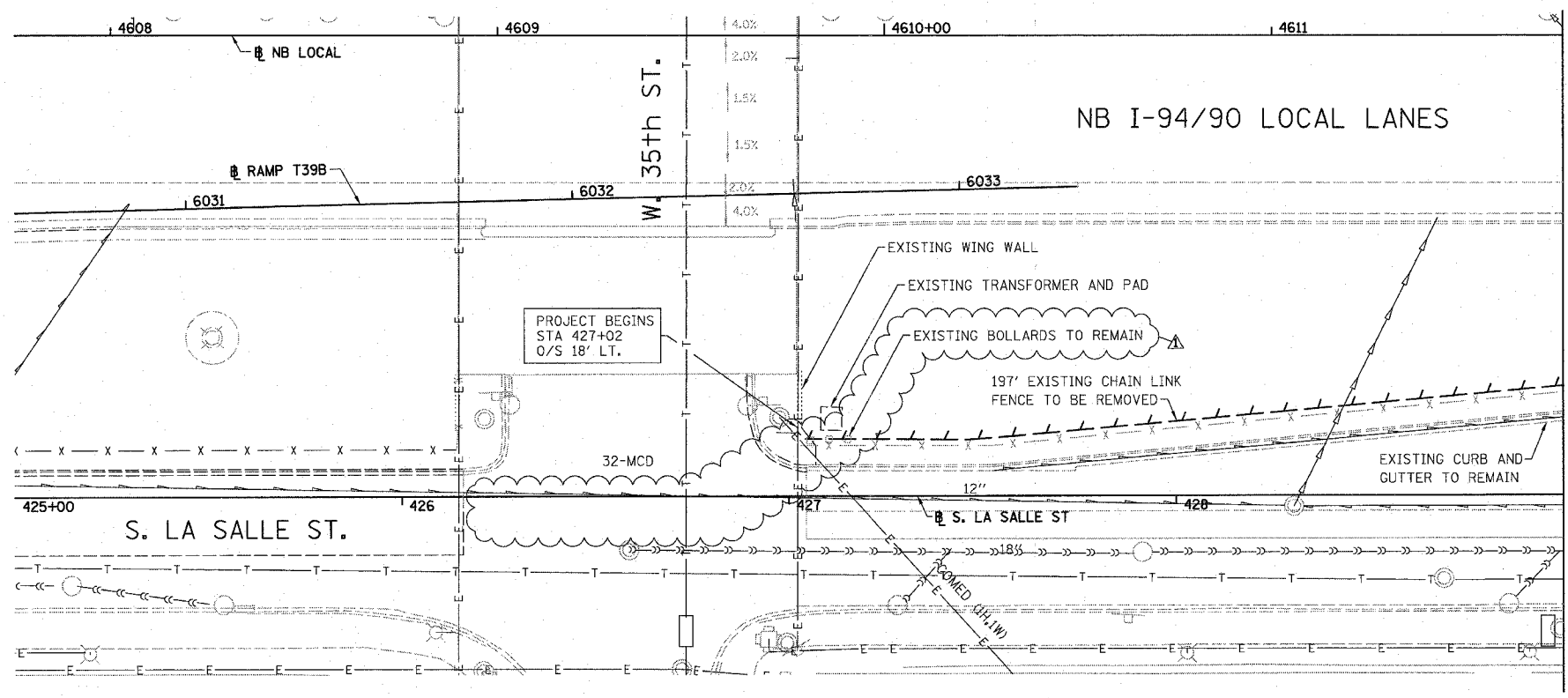

LEGEND:

- PAVED SHOULDER REMOVAL
- LINEAR REMOVALS

NOTE:

COST OF REMOVE BOLLARDS INCLUDED WITH EARTH EXCAVATION.

EXISTING CONDITIONS AND REMOVAL
PROPOSED IMPROVEMENTS

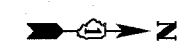
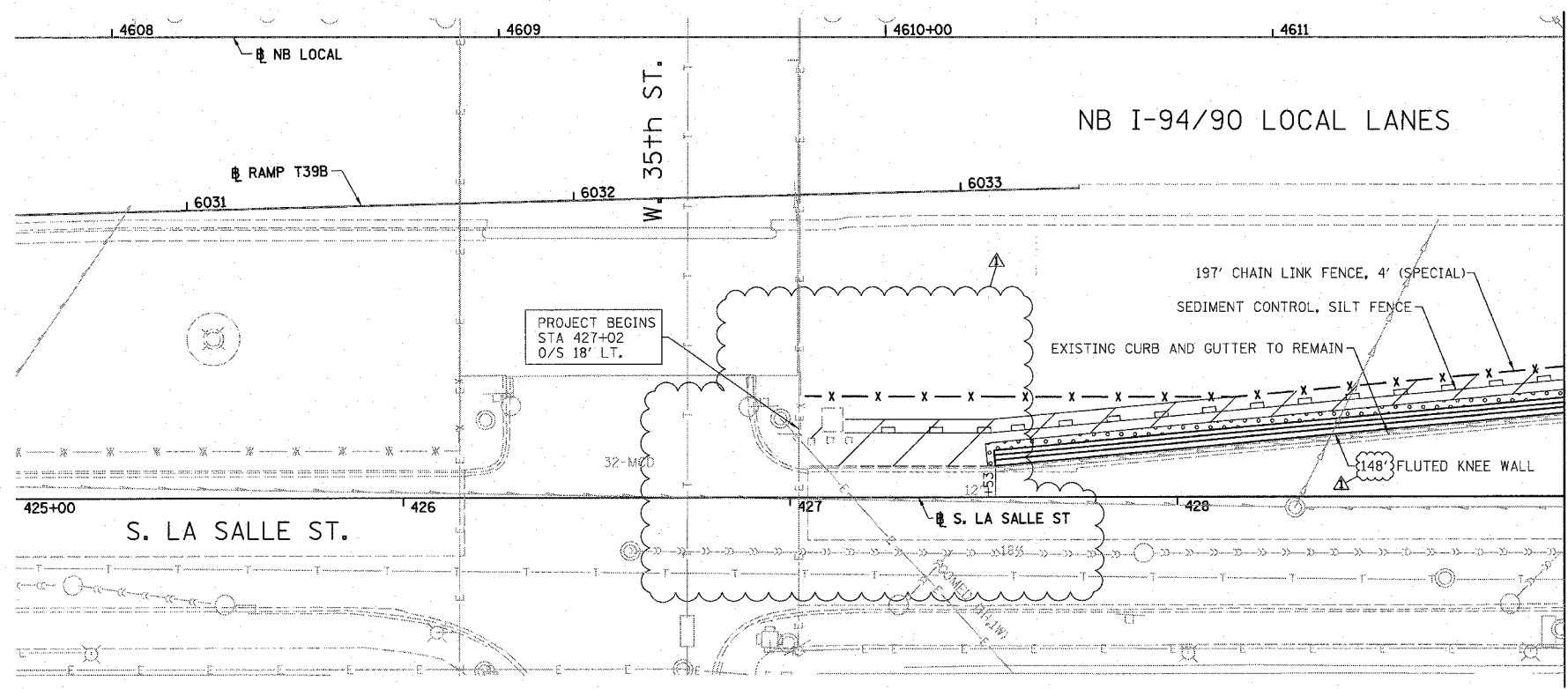

LEGEND:

- SEEDING, CLASS 2A
EROSION CONTROL BLANKET
- TOPSOIL FURNISH AND PLACE, 4"
SEEDING, CLASS 2A
EROSION CONTROL BLANKET
- TOPSOIL FURNISH AND PLACE, 12"
SEEDING, CLASS 2A
EROSION CONTROL BLANKET

NOTES:

1. SEE STRUCTURAL DETAIL FOR FLUTED KNEE WALL DETAILS.
2. ALL POINT CALLOUTS ARE TAKEN AT THE EDGE OF THE KNEE WALL BASE.

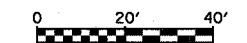

PL-1

REVISIONS	DATE
NAME	DATE
REVISED	3-6-08
REVISED	5-30-08

ILLINOIS DEPARTMENT OF TRANSPORTATION
F.A.I. 94/90 (DAN RYAN EXPRESSWAY)
NORTHBOUND KNEE WALLS (35TH ST TO 33RD ST)

EXISTING AND PROPOSED
KNEE WALL PLANS

SCALE: 1"=20'
DATE: 03/06/08

DRAWN BY: JDC
CHECKED BY: DDM

BOWMAN, BARRETT & ASSOCIATES INC.
CONSULTING ENGINEERS
Chicago, Illinois
312.228.0100
www.bbandainc.com

4:50:45 PM 5/29/2008

F.A.I.	SECTION	COUNTY	TOTAL SHEETS	SHEET NO.
94/90	*	COOK	29	11
STA.	TO STA.			
FED. ROAD DIST. NO.	ILLINOIS	FED. AID PROJECT		
62993	• 2324.6-1P-1-1			

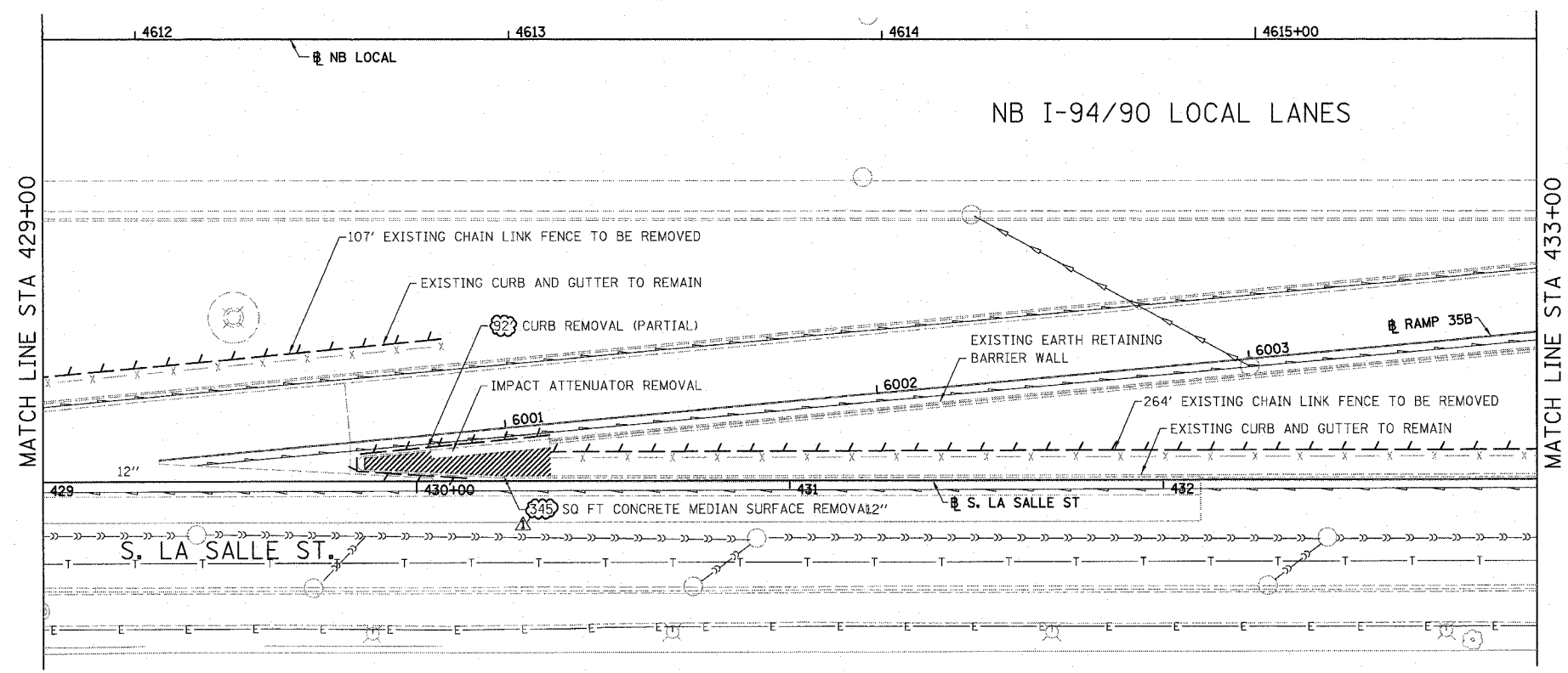

- LEGEND:
- PAVED SHOULDER REMOVAL
 - LINEAR REMOVALS

EXISTING CONDITIONS AND REMOVAL
PROPOSED IMPROVEMENTS

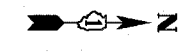
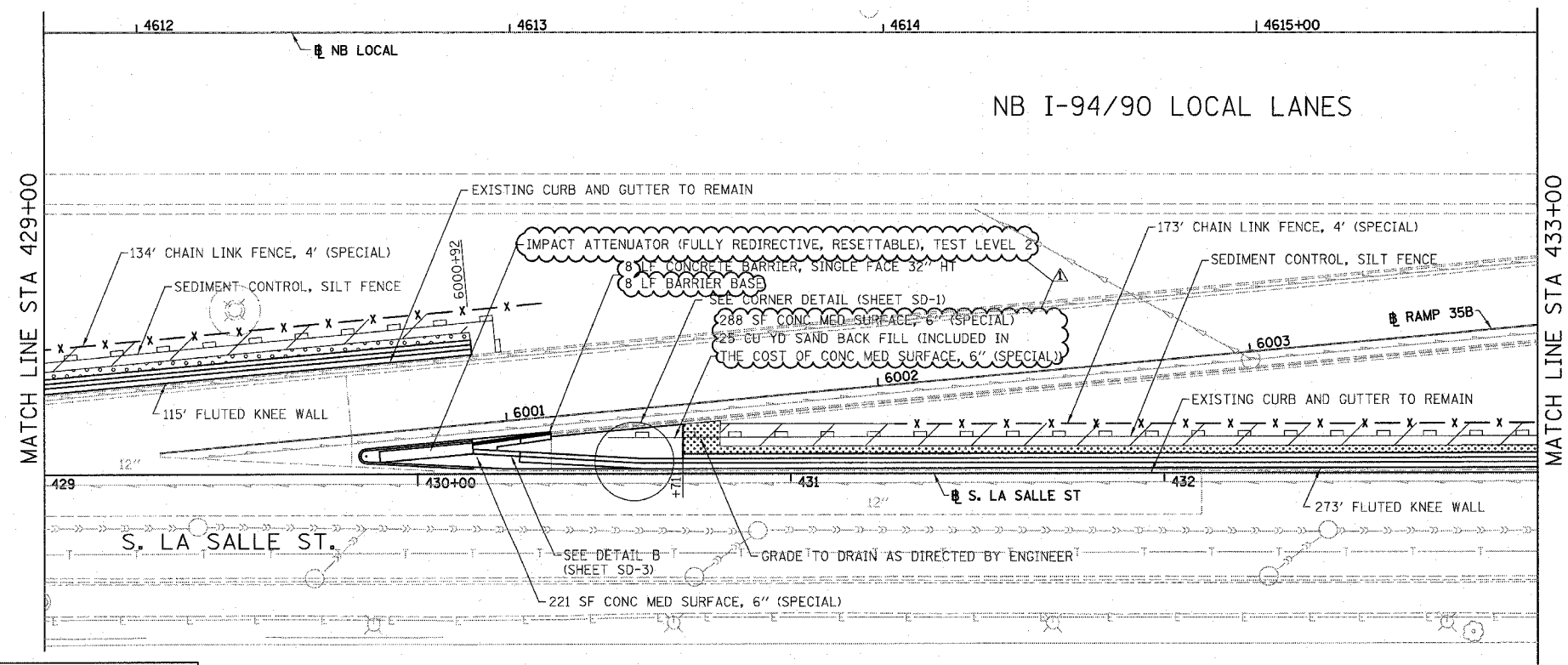

- LEGEND:
- SEEDING, CLASS 2A
EROSION CONTROL BLANKET
 - TOPSOIL FURNISH AND PLACE, 4"
SEEDING, CLASS 2A
EROSION CONTROL BLANKET
 - TOPSOIL FURNISH AND PLACE, 12"
SEEDING, CLASS 2A
EROSION CONTROL BLANKET

- NOTES:
1. SEE STRUCTURAL DETAIL FOR FLUTED KNEE WALL DETAILS.
 2. ALL POINT CALLOUTS ARE TAKEN AT THE EDGE OF THE KNEE WALL BASE.

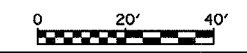

PL-2

REVISIONS	
NAME	DATE
REVISED	3-6-08
REVISED	5-30-08

ILLINOIS DEPARTMENT OF TRANSPORTATION
F.A.I. 94/90 (DAN RYAN EXPRESSWAY)
NORTHBOUND KNEE WALLS (35TH ST TO 33RD ST)

EXISTING AND PROPOSED
KNEE WALL PLANS

SCALE: 1"=20'
DATE: 03/06/08

DRAWN BY: JDC
CHECKED BY: DDM

BOWMAN, BARRETT & ASSOCIATES INC.
CONSULTING ENGINEERS
Chicago, Illinois
312.228.0100
www.bbainc.com

5/29/2008 4:50:15 PM

F.A.I.	SECTION	COUNTY	TOTAL SHEETS	SHEET NO.
94/90	*	COOK	29	12
STA.		TO STA.		
FED. ROAD DIST. NO.	ILLINOIS	FED. AID PROJECT		
62993		2324.6-IP-1-1		

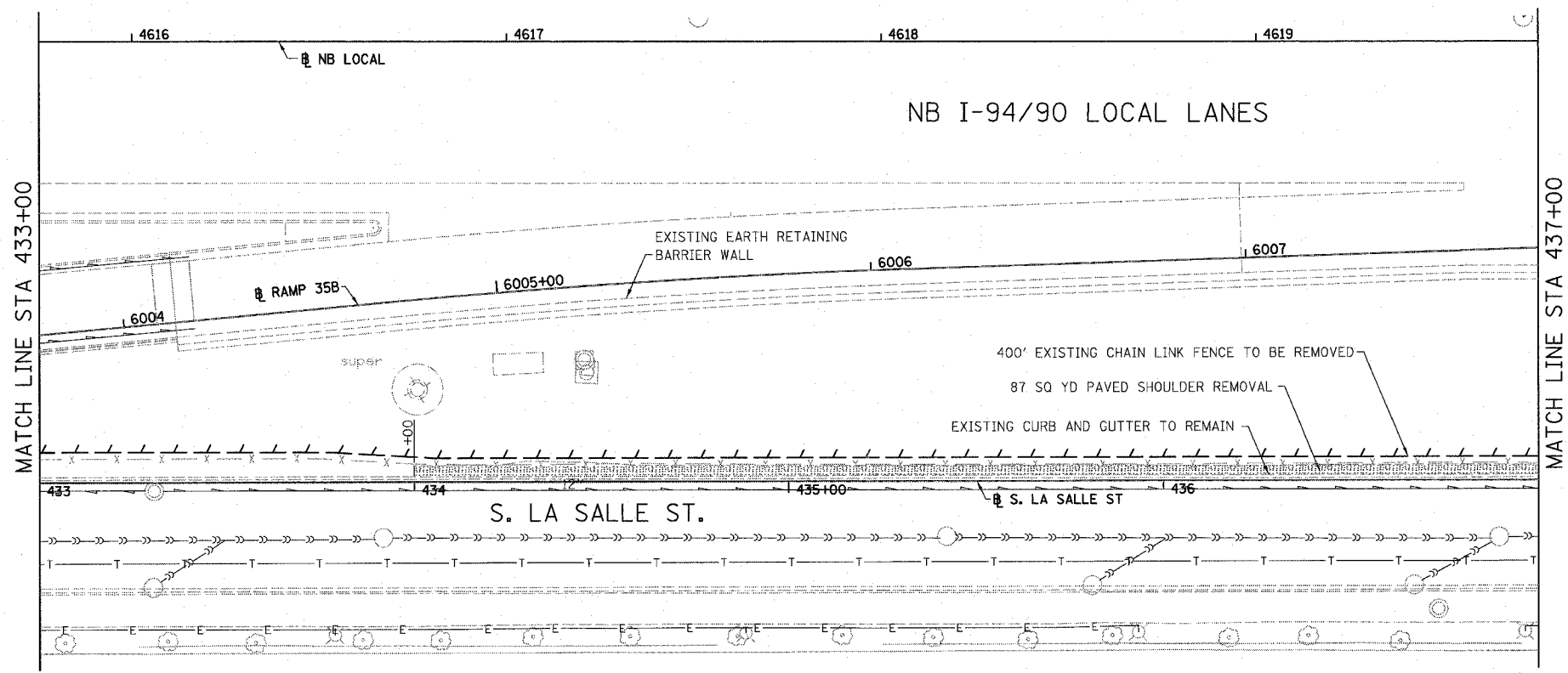

LEGEND:

PAVED SHOULDER REMOVAL

LINEAR REMOVALS

EXISTING CONDITIONS AND REMOVAL
PROPOSED IMPROVEMENTS

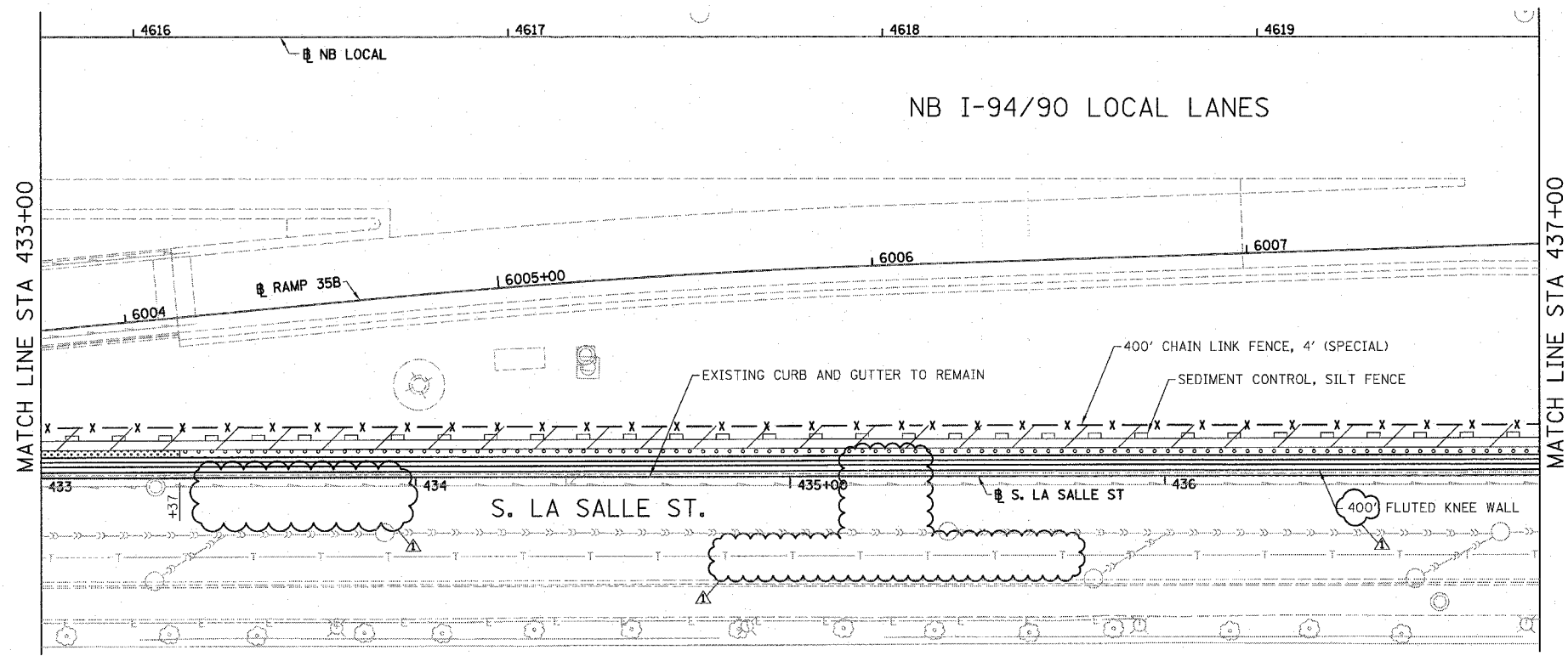

LEGEND:

SEEDING, CLASS 2A
EROSION CONTROL BLANKET

TOPSOIL FURNISH AND PLACE, 4"
SEEDING, CLASS 2A
EROSION CONTROL BLANKET

TOPSOIL FURNISH AND PLACE, 12"
SEEDING, CLASS 2A
EROSION CONTROL BLANKET

- NOTES:
- SEE STRUCTURAL DETAIL FOR FLUTED KNEE WALL DETAILS.
 - ALL POINT CALLOUTS ARE TAKEN AT THE EDGE OF THE KNEE WALL BASE.

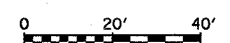

PL-3

REVISIONS	
NAME	DATE
REVISOR	3-6-08
REVISOR	5-30-08

ILLINOIS DEPARTMENT OF TRANSPORTATION
F.A.I. 94/90 (DAN RYAN EXPRESSWAY)
NORTHBOUND KNEE WALLS (35TH ST TO 33RD ST)

EXISTING AND PROPOSED
KNEE WALL PLANS

SCALE: 1"=20'
DATE: 03/06/08

DRAWN BY: JDC
CHECKED BY: DDM

BOWMAN, BARRETT & ASSOCIATES INC.
CONSULTING ENGINEERS
Chicago, Illinois
312.228.0100
www.bbda-inc.com

45045 PM 5/29/2008

F.A.I.	SECTION	COUNTY	TOTAL SHEETS	SHEET NO.
94/90	*	COOK	29	13
STA.		TO STA.		
FED. ROAD DIST. NO.	ILLINOIS	FED. AID PROJECT		
62993		• 2324.6-1P-1-1		

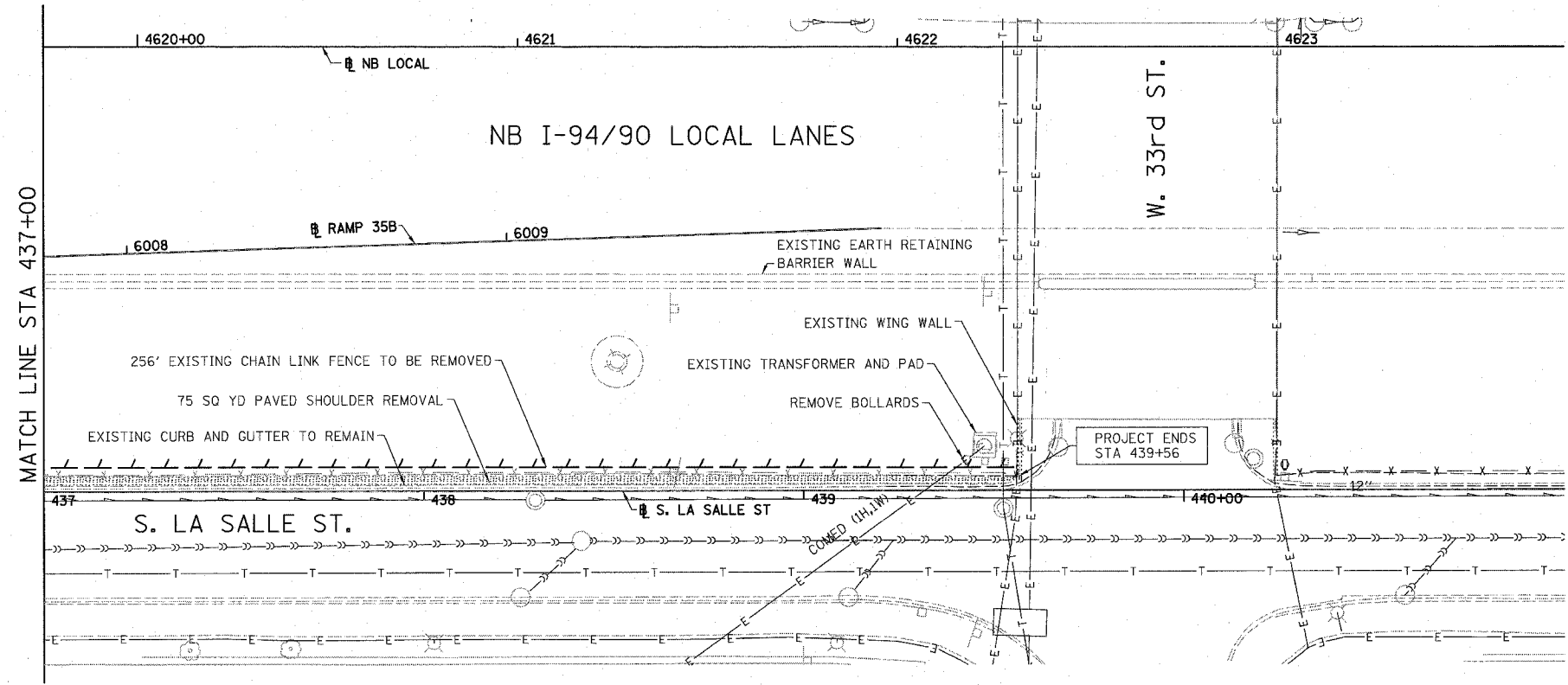

- LEGEND:**
- PAVED SHOULDER REMOVAL
 - LINEAR REMOVALS

NOTE:
COST OF REMOVE BOLLARDS INCLUDED WITH EARTH EXCAVATION.

**EXISTING CONDITIONS AND REMOVAL
PROPOSED IMPROVEMENTS**

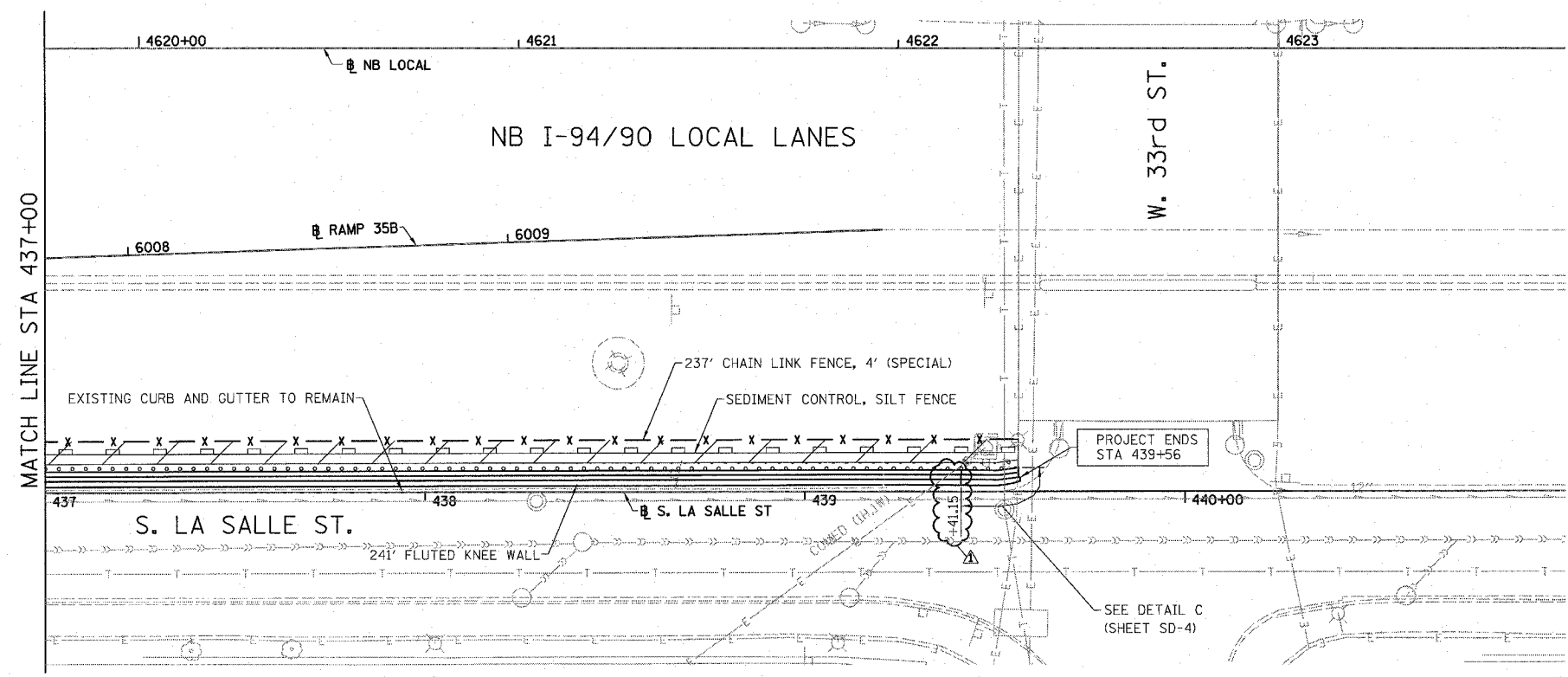

- LEGEND:**
- SEEDING, CLASS 2A
EROSION CONTROL BLANKET
 - TOPSOIL FURNISH AND PLACE, 4"
SEEDING, CLASS 2A
EROSION CONTROL BLANKET
 - TOPSOIL FURNISH AND PLACE, 12"
SEEDING, CLASS 2A
EROSION CONTROL BLANKET

- NOTES:**
- SEE STRUCTURAL DETAIL FOR FLUTED KNEE WALL DETAILS.
 - ALL POINT CALLOUTS ARE TAKEN AT THE EDGE OF THE KNEE WALL BASE.

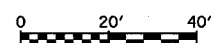

REVISIONS	
NAME	DATE
REVISED	3-6-08
REVISED	5-30-08

ILLINOIS DEPARTMENT OF TRANSPORTATION
F.A.I. 94/90 (DAN RYAN EXPRESSWAY)
NORTHBOUND KNEE WALLS (35TH ST TO 33RD ST)

**EXISTING AND PROPOSED
KNEE WALL PLANS**

SCALE: 1"=20'
DATE: 03/06/08

DRAWN BY: JDC
CHECKED BY: DDM

BOWMAN, BARRETT & ASSOCIATES INC.
CONSULTING ENGINEERS
Chicago, Illinois
312.228.0100
www.bbainc.com

4/20/06 PM 5/29/2008

F.A.I.	SECTION	COUNTY	TOTAL SHEETS	SHEET NO.
94/90	*	COOK	29	15
STA.		TO STA.		
FED. ROAD DIST. NO.	ILLINOIS	FED. AID PROJECT		
62993		• 2324.6-1P-I-1		

THIS SHEET INTENTIONALLY
LEFT BLANK

SHEET SD-2

REVISIONS	
NAME	DATE
REVISED	3-6-08
ADDENDUM 1	5-30-08

ILLINOIS DEPARTMENT OF TRANSPORTATION
F.A.I. 94/90 (DAN RYAN EXPRESSWAY)
NORTHBOUND KNEE WALLS (35TH ST TO 33RD ST)

DETAIL A

SCALE: N.T.S.
DATE: 03/06/08

DRAWN BY: PAH
CHECKED BY: BLU

BOWMAN, BARRETT & ASSOCIATES INC.
CONSULTING ENGINEERS
Chicago, Illinois
312.228.0100
www.bbainc.com



45053 PM 5/29/2008

F.A.I.	SECTION	COUNTY	TOTAL SHEETS	SHEET NO.
94/90	*	COOK	29	17
STA.	TO STA.			
FED. ROAD DIST. NO.	ILLINOIS	FED. AID PROJECT		
62993		2324.6-1P-1-1		

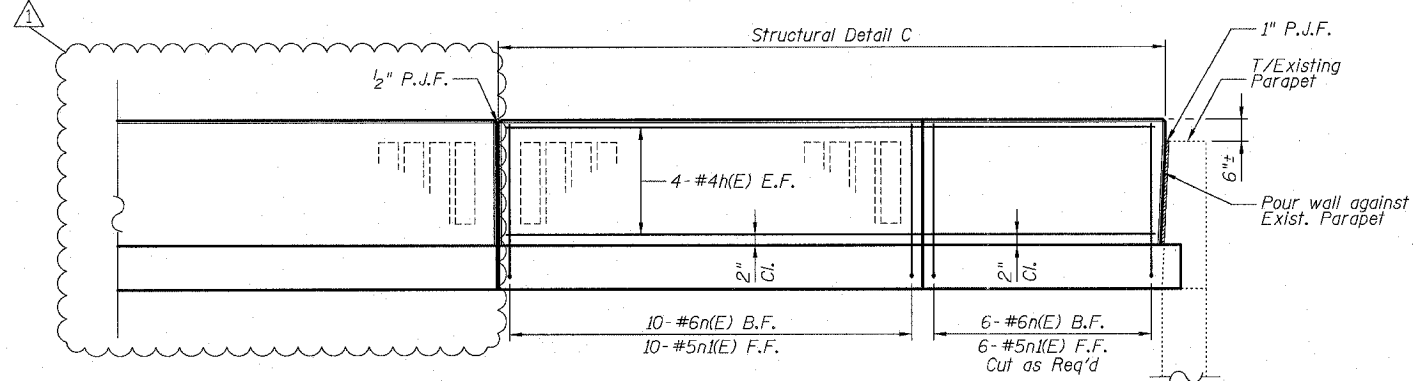

ELEVATION

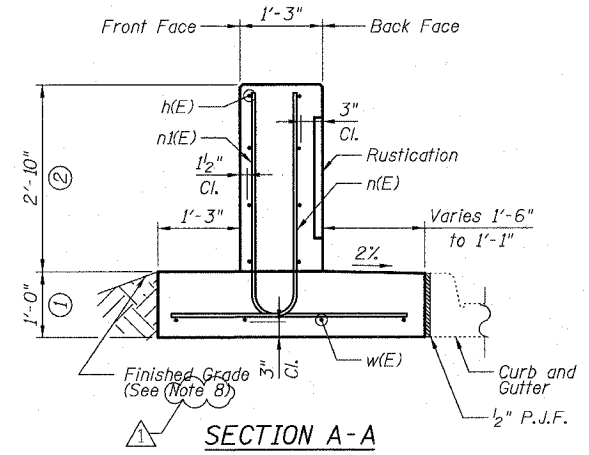

SECTION A-A

DETAIL C REINFORCEMENT SCHEDULE AND BILL OF MATERIAL

Bar	No.	Size	Length	Shape
h(E)	8	#4	14'-8"	—
n(E)	16	#6	5'-6"	L
n(E)	16	#5	5'-10"	L
w(E)	4	#4	14'-8"	—
Item		Unit	Qty.	
①	Concrete Structures	Cu. Yd.	2.3	
②	Concrete Superstructure	Cu. Yd.	2.0	
	Reinforcement Bars, Epoxy Coated	Pound	350	
	Rustication Finish	Sq. Ft.	16	
	Protective Coat	Sq. Yd.	10	

- NOTES:
- All stations and offsets measured from S. La Salle St. @.
 - Concrete: f'c = 3500 psi
 - Provide California Finish on top of foundation between stem and Frontage Road. See Roadway Details.
 - At locations where Fluted Knee Wall abuts a rigid Structure, a 1" thick Preformed Expansion Joint Filler conforming to the shape of the Structure shall be installed between the Wall and the Structure.
 - Apply Protective Coat to top and back face of stem and top of Frontage Road side of foundation.
 - For Fluted Knee Wall standard details, see Sheet SD-1
 - B.F. = Back Face (Frontage Road Side)
F.F. = Front Face (Expressway Side)
E.F. = Each Face
 - Shape finished grade as required to match existing conditions.
 - P.J.F. included in cost of concrete structures.

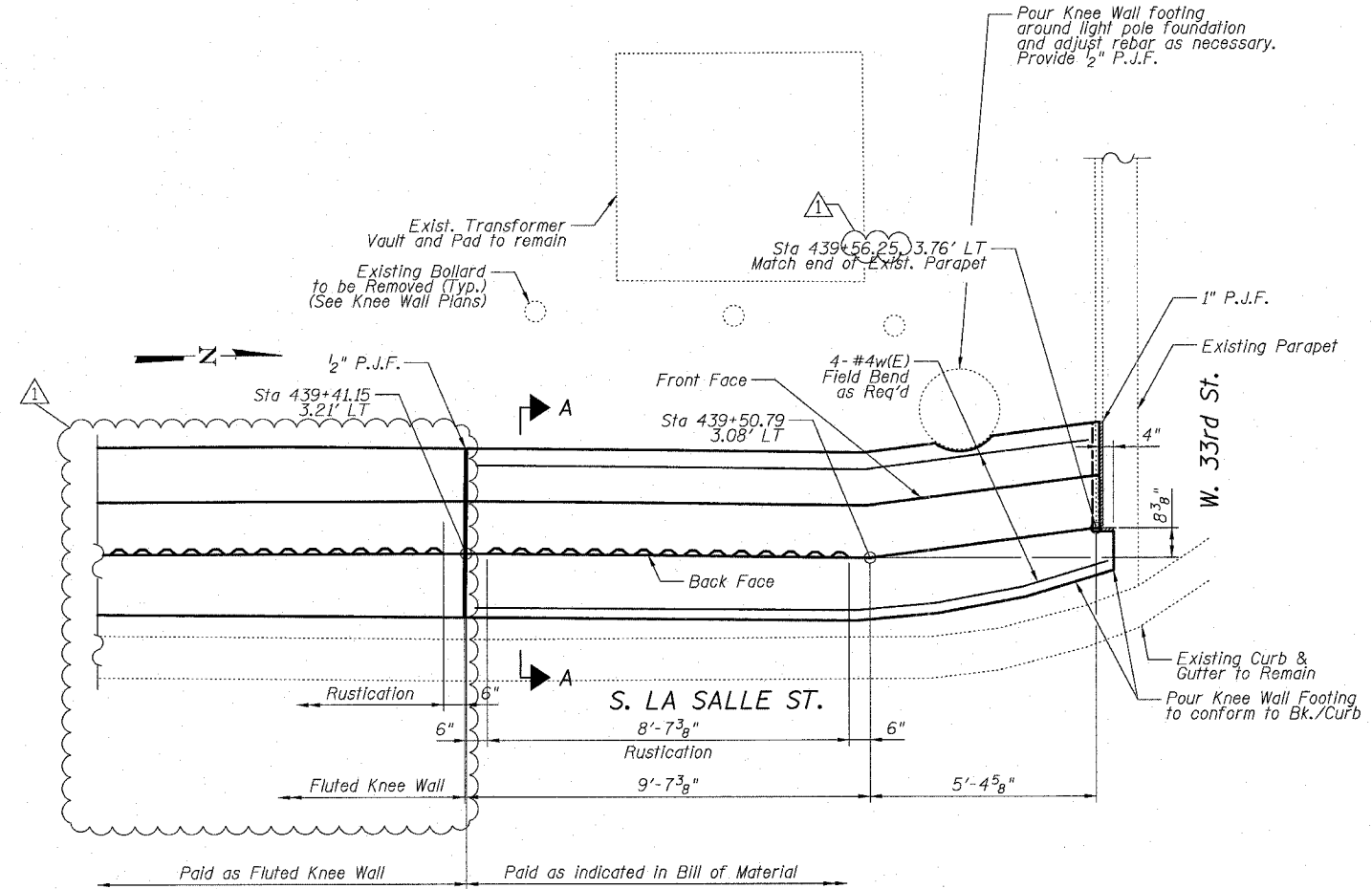

PLAN

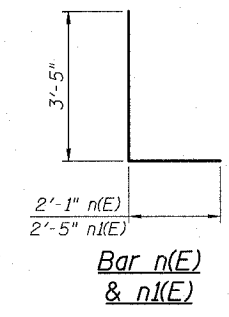

Bar n(E) & n(E)

BOWMAN, BARRETT & ASSOCIATES INC.
CONSULTING ENGINEERS
Chicago, Illinois
312.228.0100
www.bbainc.com

REVISIONS
NAME DATE
REVISED 3-6-08
ADDENDUM 1 5-30-08

SHEET SD-4
ILLINOIS DEPARTMENT OF TRANSPORTATION
F.A.I. 94/90 (DAN RYAN EXPRESSWAY)
NORTHBOUND KNEE WALLS (35TH ST TO 33RD ST)
DETAIL C
SCALE: N.T.S. DRAWN BY: LAM
DATE: 03/06/08 CHECKED BY: BLU

450233 PM 5/29/2008