

F.A. RTE.	SECTION	COUNTY	TOTAL SHEETS	SHEET NO.
08-00146-00-TL		COOK	273	213
STA.	TO STA.			
FED. ROAD DIST. NO.	ILLINOIS	FED. AID PROJECT	M-8003 (867)	
CONTRACT NO. 63033				

- NOTES:**
- THIS PLAN IS FOR THE PURPOSE OF INSTALLING EMERGENCY VEHICLE PREEMPTION EQUIPMENT AS SHOWN PER PLAN INDICATED IN THE SCHEDULE OF QUANTITIES. ALL OTHER EQUIPMENT SHOWN IS EXISTING EQUIPMENT TO REMAIN.
  - THIS SIGNAL PLAN WAS DEVELOPED FROM EXISTING SIGNAL PLANS PROVIDED BY THE ILLINOIS DEPARTMENT OF TRANSPORTATION AND NOT TOPOGRAPHIC SURVEY. ACCURACY OF EQUIPMENT LOCATION OR EXISTING GEOMETRY MUST BE VERIFIED IN THE FIELD.

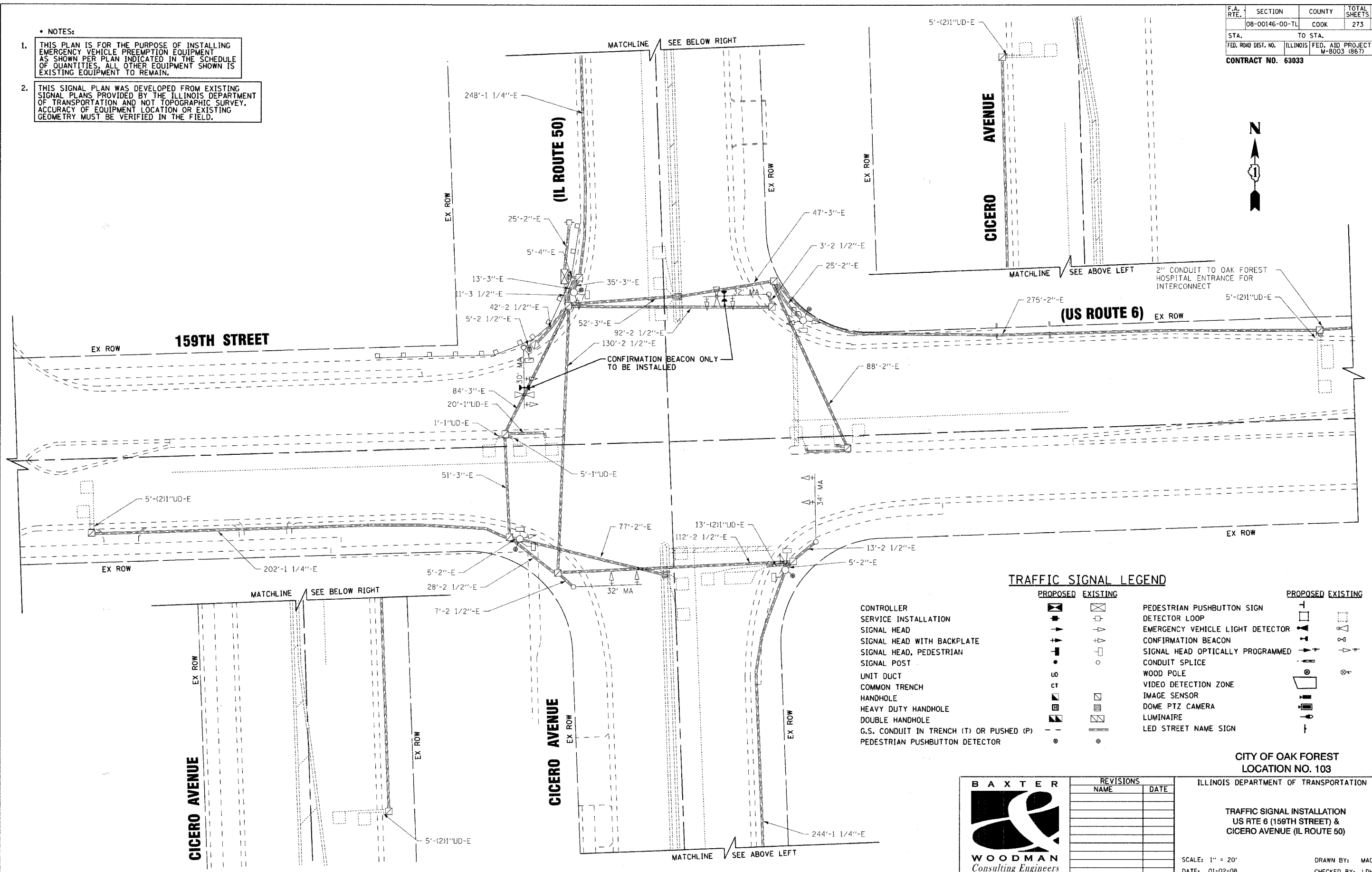

**TRAFFIC SIGNAL LEGEND**

	PROPOSED	EXISTING		PROPOSED	EXISTING
CONTROLLER	[Symbol]	[Symbol]	PEDESTRIAN PUSHBUTTON SIGN	[Symbol]	[Symbol]
SERVICE INSTALLATION	[Symbol]	[Symbol]	DETECTOR LOOP	[Symbol]	[Symbol]
SIGNAL HEAD	[Symbol]	[Symbol]	EMERGENCY VEHICLE LIGHT DETECTOR	[Symbol]	[Symbol]
SIGNAL HEAD WITH BACKPLATE	[Symbol]	[Symbol]	CONFIRMATION BEACON	[Symbol]	[Symbol]
SIGNAL HEAD, PEDESTRIAN	[Symbol]	[Symbol]	SIGNAL HEAD OPTICALLY PROGRAMMED	[Symbol]	[Symbol]
SIGNAL POST	[Symbol]	[Symbol]	CONDUIT SPLICE	[Symbol]	[Symbol]
UNIT DUCT	[Symbol]	[Symbol]	WOOD POLE	[Symbol]	[Symbol]
COMMON TRENCH	[Symbol]	[Symbol]	VIDEO DETECTION ZONE	[Symbol]	[Symbol]
HANDHOLE	[Symbol]	[Symbol]	IMAGE SENSOR	[Symbol]	[Symbol]
HEAVY DUTY HANDHOLE	[Symbol]	[Symbol]	DOME PTZ CAMERA	[Symbol]	[Symbol]
DOUBLE HANDHOLE	[Symbol]	[Symbol]	LUMINAIRE	[Symbol]	[Symbol]
G.S. CONDUIT IN TRENCH (T) OR PUSHED (P)	[Symbol]	[Symbol]	LED STREET NAME SIGN	[Symbol]	[Symbol]
PEDESTRIAN PUSHBUTTON DETECTOR	[Symbol]	[Symbol]			

CITY OF OAK FOREST  
LOCATION NO. 103

ILLINOIS DEPARTMENT OF TRANSPORTATION  
  
TRAFFIC SIGNAL INSTALLATION  
US RTE 6 (159TH STREET) &  
CICERO AVENUE (IL ROUTE 50)

SCALE: 1" = 20'  
DATE: 01-02-08  
DRAWN BY: MAC  
CHECKED BY: LDH

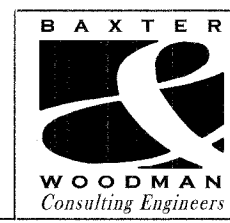

REVISIONS	
NAME	DATE

COPYRIGHT © 2007 BY BAXTER & WOODMAN, INC.  
 STATE OF ILLINOIS - PROFESSIONAL DESIGN FIRM  
 LICENSE NO. 084-00021 - EXPIRES 4/30/2009  
 2/22/2007 10:45:42 AM  
 C:\Users\ldh\Documents\Projects\010208\159th\159th\159th.dwg