

| | | | | |
|---------------------|----------------|------------------|--------------|-----------|
| F. A. DIST. | SECTION | COUNTY | TOTAL SHEETS | SHEET NO. |
| | 08-00148-00-TL | COOK | 273 | 268 |
| STA. | TO STA. | | | |
| FED. ROAD DIST. NO. | ILLINOIS | FED. AID PROJECT | | |

CONTRACT NO. 63003

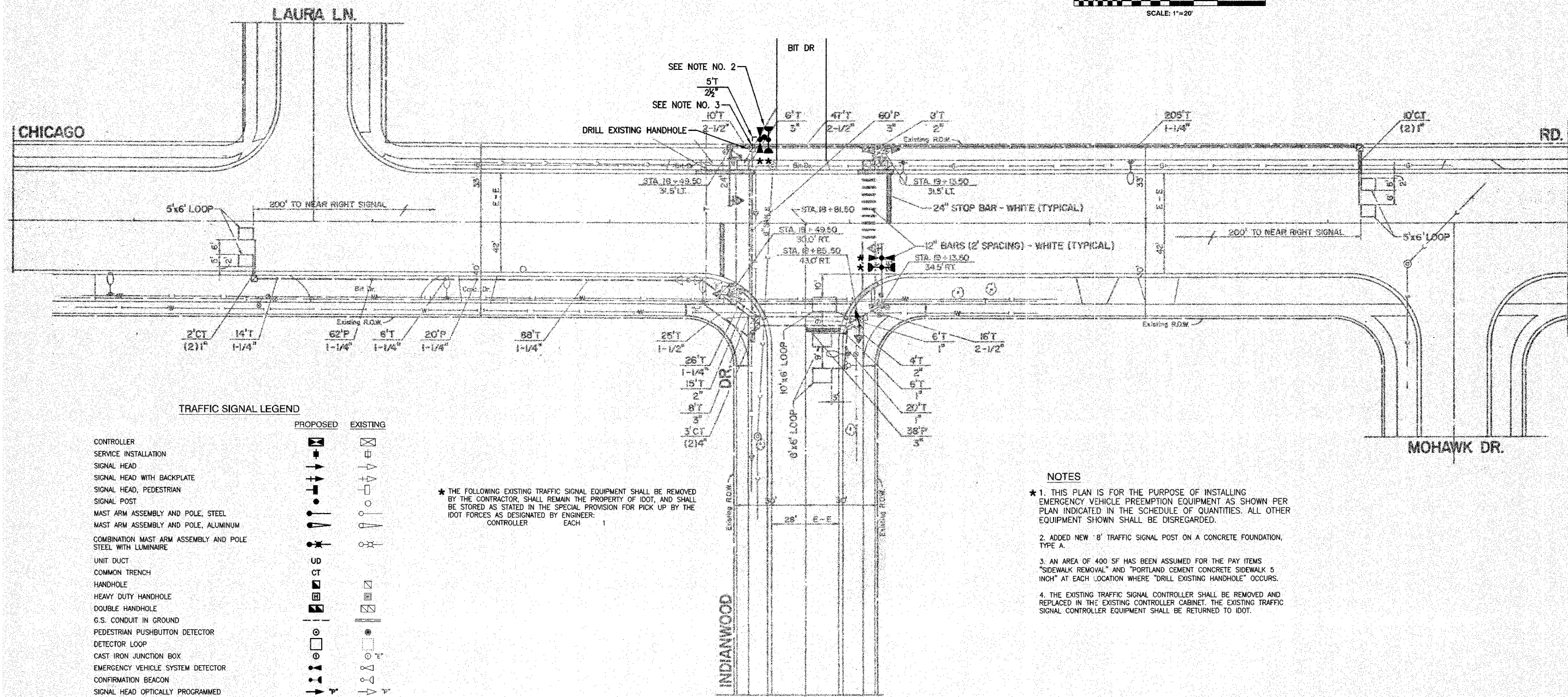
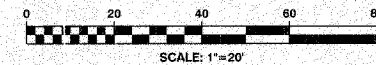

TRAFFIC SIGNAL LEGEND

| | PROPOSED | EXISTING |
|---|----------|----------|
| CONTROLLER | | |
| SERVICE INSTALLATION | | |
| SIGNAL HEAD | | |
| SIGNAL HEAD WITH BACKPLATE | | |
| SIGNAL HEAD, PEDESTRIAN | | |
| SIGNAL POST | | |
| MAST ARM ASSEMBLY AND POLE, STEEL | | |
| MAST ARM ASSEMBLY AND POLE, ALUMINUM | | |
| COMBINATION MAST ARM ASSEMBLY AND POLE STEEL WITH LUMINAIRE | | |
| UNIT DUCT | | |
| COMMON TRENCH | | |
| HANDHOLE | | |
| HEAVY DUTY HANDHOLE | | |
| DOUBLE HANDHOLE | | |
| G.S. CONDUIT IN GROUND | | |
| PEDESTRIAN PUSHBUTTON DETECTOR | | |
| DETECTOR LOOP | | |
| CAST IRON JUNCTION BOX | | |
| EMERGENCY VEHICLE SYSTEM DETECTOR | | |
| CONFIRMATION BEACON | | |
| SIGNAL HEAD OPTICALLY PROGRAMMED | | |
| CONDUIT SPLICE | | |
| WOOD POLE | | |
| RACEWAY FOR MAGNETIC DETECTOR, TYPE I OR TYPE II | | |
| VEHICLE DETECTOR, NON COMPENSATED MAGNETIC TYPE | | |
| RAILROAD CONTROL CABINET | | |
| TELEPHONE CONNECTION | | |
| ILLUMINATED SIGN, FIBER OPTIC "NO LEFT TURN" | | |
| ILLUMINATED SIGN, FIBER OPTIC "NO RIGHT TURN" | | |

* THE FOLLOWING EXISTING TRAFFIC SIGNAL EQUIPMENT SHALL BE REMOVED BY THE CONTRACTOR. SHALL REMAIN THE PROPERTY OF IDOT, AND SHALL BE STORED AS STATED IN THE SPECIAL PROVISION FOR PICK UP BY THE IDOT FORCES AS DESIGNATED BY ENGINEER:
CONTROLLER EACH 1

NOTES

1. THIS PLAN IS FOR THE PURPOSE OF INSTALLING EMERGENCY VEHICLE PREEMPTION EQUIPMENT AS SHOWN PER PLAN INDICATED IN THE SCHEDULE OF QUANTITIES. ALL OTHER EQUIPMENT SHOWN SHALL BE DISREGARDED.
2. ADDED NEW '8' TRAFFIC SIGNAL POST ON A CONCRETE FOUNDATION, TYPE A.
3. AN AREA OF 400 SF HAS BEEN ASSUMED FOR THE PAY ITEMS "SIDEWALK REMOVAL" AND "PORTLAND CEMENT CONCRETE SIDEWALK 5 INCH" AT EACH LOCATION WHERE "DRILL EXISTING HANDHOLE" OCCURS.
4. THE EXISTING TRAFFIC SIGNAL CONTROLLER SHALL BE REMOVED AND REPLACED IN THE EXISTING CONTROLLER CABINET. THE EXISTING TRAFFIC SIGNAL CONTROLLER EQUIPMENT SHALL BE RETURNED TO IDOT.

VILLAGE OF THORNTON
LOCATION NO. 128

* PLANS MODIFIED BY
ROBINSON ENGINEERING, LTD

| REVISIONS | |
|-----------------------|----------|
| NAME | DATE |
| * ADDED EV PREEMPTION | 01/02/08 |
| ADDED NEW 18' POST | |
| ADDED NEW CONTROLLER | |
| | |
| | |
| | |

ILLINOIS DEPARTMENT OF TRANSPORTATION
**PROPOSED EMERGENCY VEHICLE PREEMPTION
CHICAGO ROAD & INDIANWOOD DRIVE**

SCALE: VERT. _____
HORIZ. _____
DATE _____ DRAWN BY _____
CHECKED BY _____