

DATE: \_\_\_\_\_ BY: \_\_\_\_\_  
 SURVEYED: \_\_\_\_\_ CHECKED: \_\_\_\_\_  
 PLOTTED: \_\_\_\_\_ RT. OF WAY CHECKED: \_\_\_\_\_  
 NOTE BOOK NO. \_\_\_\_\_  
 CAD FILE NAME: \_\_\_\_\_

DATE: \_\_\_\_\_ BY: \_\_\_\_\_  
 SURVEYED: \_\_\_\_\_ CHECKED: \_\_\_\_\_  
 PLOTTED: \_\_\_\_\_ RT. OF WAY CHECKED: \_\_\_\_\_  
 NOTE BOOK NO. \_\_\_\_\_  
 CAD FILE NAME: \_\_\_\_\_

**CHRISTOPHER B. BURKE ENGINEERING LTD.**  
 9575 West Higgins Road, Suite 600  
 Rosemont, Illinois 60018  
 (847) 823-0500

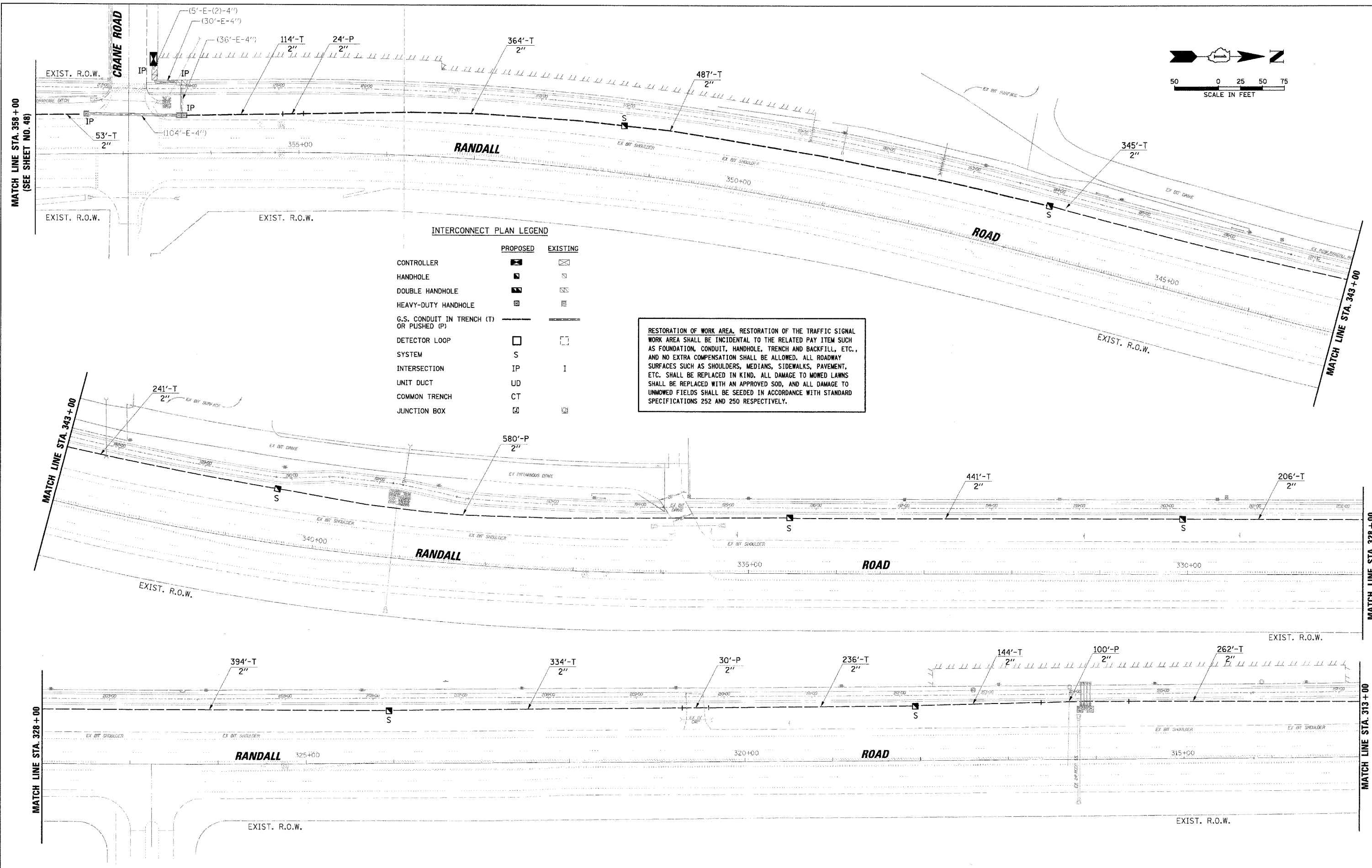
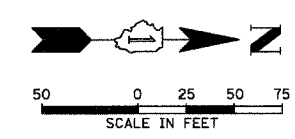

**INTERCONNECT PLAN LEGEND**

	PROPOSED	EXISTING
CONTROLLER	☒	☒
HANDHOLE	◻	◻
DOUBLE HANDHOLE	◻	◻
HEAVY-DUTY HANDHOLE	◻	◻
G.S. CONDUIT IN TRENCH (T) OR PUSHED (P)	—	—
DETECTOR LOOP	◻	◻
SYSTEM	S	S
INTERSECTION	IP	I
UNIT DUCT	UD	UD
COMMON TRENCH	CT	CT
JUNCTION BOX	◻	◻

RESTORATION OF WORK AREA. RESTORATION OF THE TRAFFIC SIGNAL WORK AREA SHALL BE INCIDENTAL TO THE RELATED PAY ITEM SUCH AS FOUNDATION, CONDUIT, HANDHOLE, TRENCH AND BACKFILL, ETC., AND NO EXTRA COMPENSATION SHALL BE ALLOWED. ALL ROADWAY SURFACES SUCH AS SHOULDERS, MEDIANS, SIDEWALKS, PAVEMENT, ETC. SHALL BE REPLACED IN KIND. ALL DAMAGE TO MOWED LAWNS SHALL BE REPLACED WITH AN APPROVED SOD, AND ALL DAMAGE TO UNMOWED FIELDS SHALL BE SEEDING IN ACCORDANCE WITH STANDARD SPECIFICATIONS 252 AND 250 RESPECTIVELY.