

PROFILE SURVEYED BY DATE
 CHECKED BY DATE
 B.M. NOTED STRUCTURE NOTATIONS CHK'D
 NOTE BOOK NO.
 PLAN SURVEYED BY DATE
 CHECKED BY DATE
 NOTE BOOK NO.
 CAD FILE NAME

CHRISTOPHER B. BURKE ENGINEERING LTD.
 9575 West Higgins Road, Suite 600
 Rosemont, Illinois 60018
 (847) 823-0500

**MATCHLINE D-D
(SEE SHEET NO. 54)**

MATCHLINE E-E

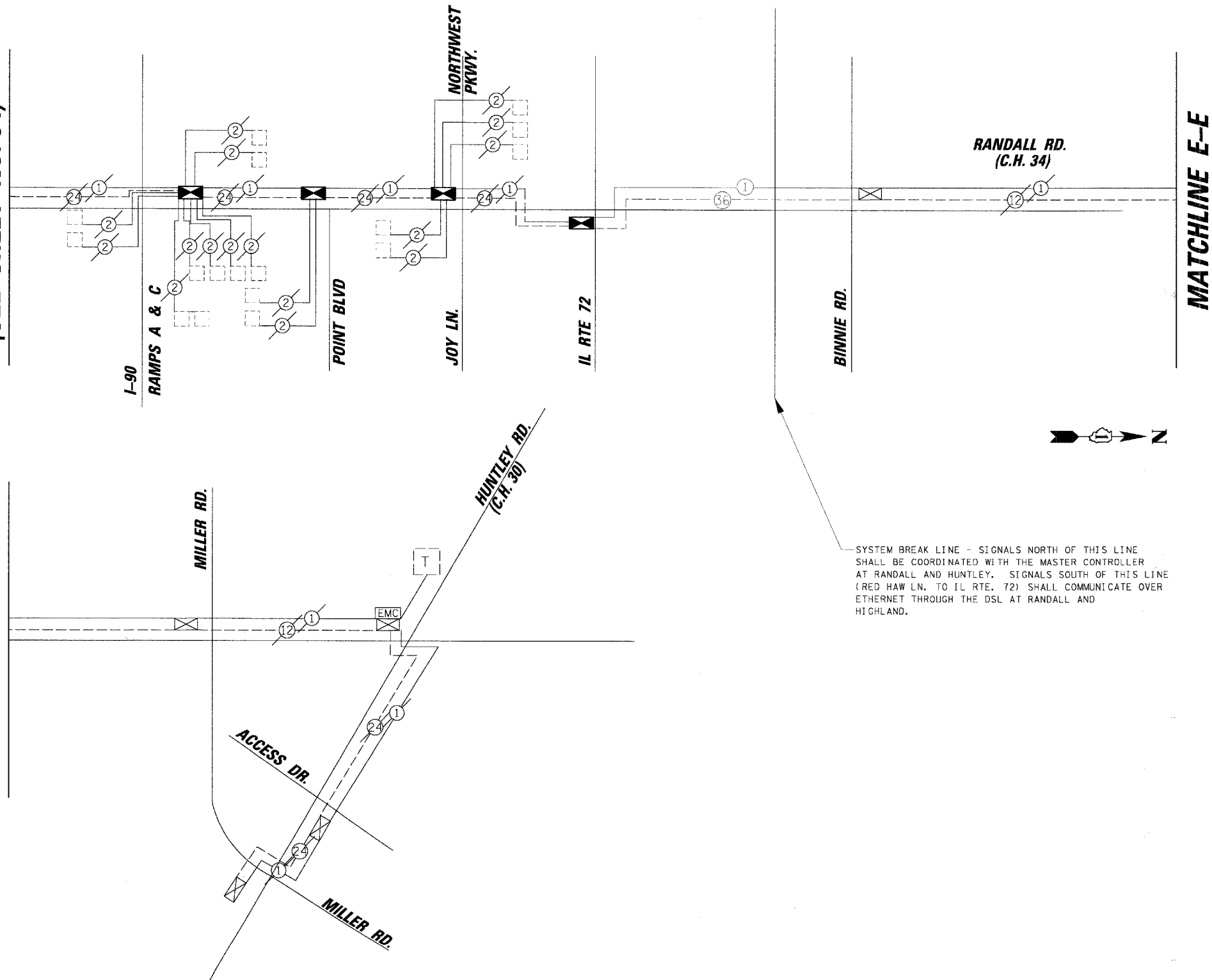

SYSTEM BREAK LINE - SIGNALS NORTH OF THIS LINE SHALL BE COORDINATED WITH THE MASTER CONTROLLER AT RANDALL AND HUNTLEY. SIGNALS SOUTH OF THIS LINE (RED HAW LN. TO IL RTE. 72) SHALL COMMUNICATE OVER ETHERNET THROUGH THE DSL AT RANDALL AND HIGHLAND.

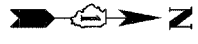

INTERCONNECT SCHEMATIC LEGEND

- EXISTING INTERSECTION CONTROLLER ☒
- PROPOSED INTERSECTION CONTROLLER ☒

- EXISTING MASTER CONTROLLER EMC
- PROPOSED MASTER CONTROLLER MC
- MASTER MASTER CONTROLLER MMC

- EXISTING INTERSECTION & SAMPLING (SYSTEM) DETECTORS ☐
- PROPOSED INTERSECTION & SAMPLING (SYSTEM) DETECTORS ☐
- EXISTING INTERSECTION LOOP DETECTORS P
- PROPOSED SAMPLING (SYSTEM) DETECTORS PS

- EXISTING SAMPLING (SYSTEM) DETECTORS ES
- PROPOSED SAMPLING (SYSTEM) DETECTORS PS

- EXISTING SAMPLING (SYSTEM) DETECTORS, PROPOSED INTERSECTION AND SAMPLING (SYSTEM) DETECTORS. ESP
- EXISTING SAMPLING (SYSTEM) DETECTORS, PROPOSED SAMPLING (SYSTEM) DETECTORS. ESPS
- EXISTING PREFORMED INTERSECTION & SAMPLING (SYSTEM) DETECTORS PD
- PROPOSED PREFORMED INTERSECTION & SAMPLING (SYSTEM) DETECTORS PD

- EXISTING SAMPLING (SYSTEM) PREFORMED DETECTORS ESP
- PROPOSED SAMPLING (SYSTEM) PREFORMED DETECTORS PSPD

- EXISTING FIBER OPTIC CABLE IN CONDUIT, NO. 62.5/125, MM12F SM24F 36
- PROPOSED FIBER OPTIC CABLE IN CONDUIT, NO. 62.5/125, MM12F SM24F 36
- EXISTING FIBER OPTIC CABLE IN CONDUIT, NO. 62.5/125, MM12F SM12F 24
- PROPOSED FIBER OPTIC CABLE IN CONDUIT, NO. 62.5/125, MM12F SM12F 24
- EXISTING INTERCONNECT CABLE - NO. 62.5/125 12F FIBER OPTIC CABLE 12
- PROPOSED INTERCONNECT CABLE - NO. 62.5/125 12F FIBER OPTIC CABLE 12
- EXISTING INTERCONNECT CABLE - NO. 18 3 PAIR TWISTED, SHIELDED 6
- PROPOSED INTERCONNECT CABLE - NO. 18 3 PAIR TWISTED, SHIELDED 6
- EXISTING LOOP DETECTOR CABLE 2/C TWISTED, SHIELDED 2
- PROPOSED LOOP DETECTOR CABLE 2/C TWISTED, SHIELDED 2
- EXISTING ELECTRIC CABLE, 1/C (AS SPECIFIED) 1
- PROPOSED ELECTRIC CABLE, 1/C (AS SPECIFIED) 1

- EXISTING TELEPHONE CONNECTION T
- PROPOSED TELEPHONE CONNECTION T