

STATE OF ILLINOIS  
DEPARTMENT OF TRANSPORTATION  
DIVISION OF HIGHWAYS  
**PLANS FOR PROPOSED  
FEDERAL AID HIGHWAY**

**FAU RTE.1524 (65th STREET)  
HOT-MIX ASPHALT RESURFACING  
AUSTIN AVE TO CICERO AVE  
SECTION NO. 08-00027-00-RS  
PROJECT NO: M-8003(916)  
JOB NO: C-91-136-08  
VILLAGE OF BEDFORD PARK, COOK COUNTY**

FAU RTE.	SECTION	COUNTY	TOTAL SHEETS	SHEET NO.
1524	08-00027-00-RS	COOK	15	1
STA. 10+00		TO STA. 88+81.23		
FED. ROAD DIST. NO.		ILLINOIS	FED. AID PROJECT	
CONTRACT NO. 63017				



**INDEX TO SHEETS:**

SHEET NO.	DESCRIPTION
1.	COVER SHEET
2.	GENERAL NOTES - SUMMARY OF QUANTITIES
3.	TYPICAL SECTIONS
4-10.	PLAN SHEETS
11.	DISTRICT 1 DETAIL-TC10-TRAFFIC CONTROL AND PROTECTION FOR SIDE ROADS
12.	DISTRICT 1 DETAIL-TC13-TYPICAL PAVEMENT MARKINGS
13.	DISTRICT 1 DETAIL-BD22-PAVEMENT PATCHING FOR BITUMINOUS SURFACED PAVEMENTS
14.	DISTRICT 1 DETAIL-BD24-CURB OR CURB AND GUTTER R&R
15.	DISTRICT 1 DETAIL-BD32-BUTT JOINT AND HMA TAPER DETAIL

**LIST OF STATE STANDARDS:**

STANDARD NO.	DESCRIPTION
000001-05:	STANDARD SYMBOLS, ABBREVIATIONS AND PATTERNS
442101-07:	CLASS B PATCHES
604001-02:	FRAMES & LIDS, TYPE 1
606001-03:	CONCRETE CURB TYPE B AND COMBINATION CONCRETE CURB AND GUTTER
701601-05:	URBAN LANE CLOSURE, MULTILANE 1W OR 2W WITH NON TRAVERSABLE MEDIAN
701901:	TRAFFIC CONTROL DEVICES
886006:	TYPICAL LAYOUTS FOR DETECTION LOOPS

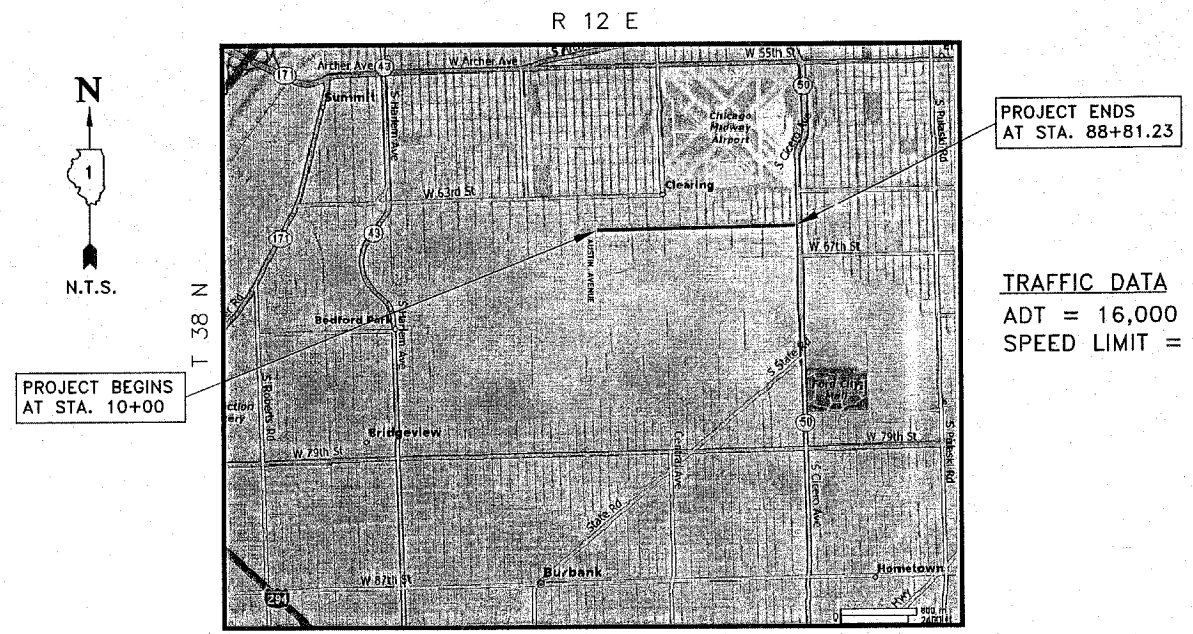

**TRAFFIC DATA**  
ADT = 16,000 (2007)  
SPEED LIMIT = 30

STATE OF ILLINOIS  
DEPARTMENT OF TRANSPORTATION  
DIVISION OF HIGHWAYS

APPROVED 2/20/08  
*[Signature]*  
VILLAGE OF BEDFORD PARK, PRESIDENTS

PASSED FEBRUARY 25, 2008  
*[Signature]*  
DISTRICT ENGINEER OF LOCAL ROADS & STREETS

RELEASING FOR BID  
BASED ON LIMITED  
REVIEW FEBRUARY 25, 2008  
*[Signature]*  
DEPUTY DIRECTOR OF HIGHWAYS/REGION 1 ENGINEER



J.U.L.I.E.  
JOINT UTILITY LOCATION FOR EXCAVATION  
1-800-892-0123

**hbe Hoeffler-Butler Engineering, Inc.**  
Consulting Civil Engineers • Land Surveyors  
PROFESSIONAL DESIGN FIRM LICENSE NO. 104-000819  
6714 S. ROBERTS ROAD HICKORY HILLS, ILLINOIS 60457  
(708) 599-8990 FAX (708) 599-8790

DESIGN DESIGNATION - 1800(28) ARTERIAL

GROSS LENGTH OF PROJECT 7,881 FEET (1.49 MILES)  
NET LENGTH OF PROJECT 7,881 FEET (1.49 MILES)

**CONTRACT NO. 63017**

EXPIRES 11-30-09  
(PRINTED BY AUTHORITY OF THE STATE OF ILLINOIS)

STEPHEN A. LEIDER  
38352  
REGISTERED PROFESSIONAL ENGINEER  
OF ILLINOIS  
*[Signature]*  
SIGNATURE  
2/20/08  
DATE

MFT FIELD ENGINEER: MELCHOR MANGOBA 1-847-705-4408  
CONSULTANT: HOFFERLE BUTLER ENGINEERING, INC. 1-708-599-8980

# GENERAL NOTES

**CONSTRUCTION WILL BE PERFORMED IN ACCORDANCE WITH ILLINOIS DEPARTMENT OF TRANSPORTATION STANDARD SPECIFICATIONS FOR ROAD AND BRIDGE CONSTRUCTION, ADOPTED JANUARY 1, 2007, ETC.**

**UTILITIES**

THE CONTRACTOR SHALL BE RESPONSIBLE FOR CONTACTING THE OWNER OF ALL EXISTING FACILITIES SO THAT THE UTILITIES AND THEIR APPURTENANCES MAY BE LOCATED AND ADJUSTED OR MOVED, IF NECESSARY, PRIOR TO THE START OF CONSTRUCTION OPERATIONS. THE CONTRACTORS SHALL COOPERATE WITH ALL UTILITY OWNERS AS PROVIDED FOR IN THE STANDARD SPECIFICATIONS.

THE LOCATIONS OF EXISTING DRAINAGE STRUCTURES, STORM AND SANITARY SEWERS, WATER SERVICE LINES AND OTHER UTILITY LINES ARE APPROXIMATE, AND THE VILLAGE DOES NOT GUARANTEE THEIR ACCURACY, THEIR EXACT HORIZONTAL AND VERTICAL LOCATIONS ARE TO BE DETERMINED IN THE FIELD BY THE CONTRACTOR AT HIS OWN EXPENSE.

THE CONTRACTOR SHALL BE RESPONSIBLE FOR THE PROTECTION OF ALL UNDERGROUND OR SURFACE UTILITIES EVEN THOUGH THEY MAY NOT BE SHOWN ON THE PLANS. ANY UTILITY THAT IS DAMAGED DURING CONSTRUCTION SHALL BE REPAIRED OR REPLACED TO THE SATISFACTION OF THE ENGINEER OR THE VILLAGE. THIS WORK SHALL BE AT THE CONTRACTORS EXPENSE.

COORDINATION OF ALL UTILITY WORK INVOLVED IN THE CONSTRUCTION AREA WILL BE DISCUSSED AT THE PRECONSTRUCTION CONFERENCE.

BEFORE STARTING ANY EXCAVATION, THE CONTRACTOR SHALL CALL "JULIE" AT 800-892-0123 FOR FIELD LOCATIONS OF BURIED ELECTRIC, TELEPHONE, GAS AND CABLE TELEVISION FACILITIES. (48 HOURS NOTIFICATION IS REQUIRED.)

**STORM SEWER**

WHENEVER, DURING CONSTRUCTION OPERATIONS, ANY LOOSE MATERIAL IS DEPOSITED IN THE FLOW LINE OF DRAINAGE STRUCTURES SUCH THAT THE NATURAL FLOW OF WATER IS OBSTRUCTED, IT SHALL BE REMOVED AT THE CLOSE OF EACH WORKING DAY. AT THE CONCLUSION OF CONSTRUCTION OPERATIONS, ALL UTILITY STRUCTURES SHALL BE FREE FROM DIRT AND DEBRIS. THE WORK SPECIFIED ABOVE WILL NOT BE PAID FOR SEPARATELY BUT SHALL BE INCLUDED IN THE COST FOR CATCH BASINS TO BE ADJUSTED.

ANY EXISTING OR PROPOSED STORM SEWER DAMAGED BY THE CONTRACTOR DURING CONSTRUCTION SHALL BE REPLACED BY THE CONTRACTOR AT NO COST TO THE VILLAGE.

**RESTORATION**

CONTRACTOR IS TO RESTORE ALL UNPAVED AREAS DAMAGED DURING CONSTRUCTION OPERATIONS TO THEIR ORIGINAL CONDITION INCLUDING THE FINE GRADING AND SODDING OF AREAS WITHIN EASEMENTS AND RIGHTS-OF-WAY.

**TRAFFIC SIGNALS**

THE ENGINEER SHALL BE NOTIFIED 24 HOURS IN ADVANCE WHEN LOOP DETECTORS ARE CUT TO ALLOW FOR TIMING ADJUSTMENT OF TRAFFIC SIGNALS.

**STAGING**

NO FORMAL STAGING OF TRAFFIC FLOW WILL BE REQUIRED AS LONG AS TWO-WAY TRAFFIC IS MAINTAINED THROUGHOUT LENGTH OF PROJECT AT ALL TIMES.

**MISCELLANEOUS**

ACCESS: THE CONTRACTOR SHALL PROVIDE ACCESS TO ABUTTING PROPERTY AT ALL TIMES DURING THE CONSTRUCTION OF THIS PROJECT, EXCEPT FOR PERIODS OF SHORT DURATION, THE COST TO PROVIDE ACCESS SHALL BE PAID FOR AS AGGREGATE SURFACE COURSE, TYPE B.

DIMENSIONS: IT SHALL BE THE CONTRACTOR'S RESPONSIBILITY TO VERIFY ALL DIMENSIONS AND CONDITIONS EXISTING IN THE FIELD PRIOR TO ORDERING MATERIALS AND BEGINNING CONSTRUCTION.

ALL SAWCUTTING SHALL BE INCLUDED IN THE UNIT OF COST OF REMOVAL ITEMS AND SHALL BE PERFORMED PRIOR TO BEGINNING REMOVAL. ANY ITEMS OF WORK REMOVED PRIOR TO SAWCUTTING WILL NOT BE MEASURED FOR PAYMENT.

BARRICADES: THE CONTRACTOR SHALL PROVIDE AND INSTALL TWO (2) WEIGHTED SAND BAGS ON EACH TYPE I OR TYPE II BARRICADE USED. (ONE (1) WEIGHTED SAND BAG ACROSS EACH BOTTOM RAIL.) TYPE III BARRICADES SHALL HAVE A MINIMUM OF FOUR SANDBAGS PER BARRICADE.

ANY EXISTING PAVEMENT DAMAGED BY THE CONTRACTOR DURING THE CONSTRUCTION SHALL BE REPLACED/REPAIRED BY THE CONTRACTOR AT HIS/HERS OWN EXPENSE TO THE SATISFACTION OF THE ENGINEER WITH NO ADDITIONAL COMPENSATION TO THE CONTRACTOR.

**STAKING**

THE CONTRACTOR SHALL TAKE CARE TO PROTECT AND PRESERVE ALL STAKING AND MARKING DURING CONSTRUCTION. CONTINUOUS DESTRUCTION OF STAKES AS A RESULT OF CARELESSNESS MAY RESULT IN DAMAGES.

PAY ITEMS IN THE SUMMARY OF QUANTITIES HAVE BEEN ESTIMATED, IF, IN THE ENGINEER'S OPINION, THE WORK IS NOT REQUIRED, THE ITEM WILL BE DEDUCTED FROM THE CONTRACT AND NO ADDITIONAL COMPENSATION WILL BE ALLOWED.

THE BITUMINOUS MATERIAL PRIME COAT QUANTITIES HAVE BEEN DETERMINED USING A RATE OF 0.10 GAL/S.Y.

HOEFFERLE-BUTLER ENGINEERING SHALL BE NOTIFIED AT LEAST TWO (2) WORKING DAYS PRIOR TO THE COMMENCEMENT OF WORK. THEY SHALL BE NOTIFIED AT LEAST 72 HOURS IN ADVANCE IF CONSTRUCTION STAKING IS REQUIRED.

FAU RTE.	SECTION	COUNTY	TOTAL SHEETS	SHEET NO.
1524	08-00027-00-RS	COOK	15	2
STA. 10+00		TO STA. 88+81.23		
FED. ROAD DIST. NO.		ILLINOIS	FED. AID PROJECT	
CONTRACT NO. 63017				

## SUMMARY OF QUANTITIES

ITEM #	ITEMS	UNITS	QUANTITY	CONSTRUCTION CODE I-000
35800200	AGGREGATE BASE REPAIR	TON	540	540
40600100	BITUMINOUS MATERIALS (PRIME COAT)	GAL.	3215	3215
40600300	AGGREGATE (PRIME COAT)	TON	65	65
40600400	MIXTURE FOR CRACKS, JOINTS, AND FLANGEWAYS	TON	4	4
40600635	LEVELING BINDER (MACHINE METHOD), N70	TON	1040	1040
40600982	HOT-MIX ASPHALT SURFACE REMOVAL-BUTT JOINT	SQ. YD.	512	512
40603340	HOT MIX ASPHALT SURFACE COURSE, MIX "D", N70	TON	4159	4159
42400200	PORTLAND CEMENT CONCRETE SIDEWALK, 5"	SQ. FT.	400	400
42400800	DETECTABLE WARNINGS	SQ. FT.	160	160
44000158	HOT MIX ASPHALT SURFACE REMOVAL, 2-1/4"	SQ. YD.	32145	32145
44000600	SIDEWALK REMOVAL	SQ. FT.	400	400
44001700	COMBINATION CONCRETE CURB AND GUTTER REMOVAL AND REPLACEMENT	FT.	200	200
44002010	CONCRETE MEDIAN REMOVAL	SQ. FT.	2210	2210
44002212	HOT MIX ASPHALT SURFACE REMOVAL OVER PATCHES, 3"	SQ. YD.	300	300
44003800	MEDIAN SURFACE REMOVAL	SQ. FT.	21842	21842
44200982	CLASS B PATCHES, TYPE II, 11 INCH	SQ. YD.	392	392
44300100	AREA REFLECTIVE CRACK CONTROL TREATMENT	SQ. YD.	32145	32145
60300310	FRAMES AND LIDS TO BE ADJUSTED (SPECIAL)	EA.	111	111
60406000	FRAMES AND LIDS, TYPE 1, OPEN LID	EA.	10	10
60406100	FRAMES AND LIDS, TYPE 1, CLOSED LID	EA.	10	10
60618200	BITUMINOUS MEDIAN SURFACE	S.F.	21842	21842
60624600	CORRUGATED MEDIAN	S.F.	2210	2210
67100100	MOBILIZATION	L.S.	1	1
70101800	TRAFFIC CONTROL AND PROTECTION (SPECIAL)	L.S.	1	1
70300100	SHORT TERM PAVEMENT MARKING	FT.	1733	1733
78000100	THERMOPLASTIC PAVEMENT MARKING - LETTERS AND SYMBOLS	SQ. FT.	296	296
* 78000200	THERMOPLASTIC PAVEMENT MARKING-LINE 4"	FT.	13164	13164
* 78000400	THERMOPLASTIC PAVEMENT MARKING-LINE 6"	FT.	1438	1438
* 78000600	THERMOPLASTIC PAVEMENT MARKING-LINE 12"	FT.	447	447
* 78000650	THERMOPLASTIC PAVEMENT MARKING-LINE 24"	FT.	163	163
* 78005110	EPOXY PAVEMENT MARKING-LINE 4"	FT.	3899	3899
* 88600600	DETECTOR LOOP REPLACEMENT	FT.	565	565

\* DENOTES SPECIALTY ITEM

REVISIONS		DATE
NAME	DATE	
S. LEIBER	02/15/08	

ILLINOIS DEPARTMENT OF TRANSPORTATION  
VILLAGE OF BEDFORD PARK  
65TH STREET RESURFACING  
AUSTIN AVE. TO CICERO AVE.  
**GENERAL NOTES AND SUMMARY OF QUANTITIES**

SCALE: N.T.S.  
HORIZ: N.T.S.  
DATE: 10/17/07

DRAWN BY: ECC  
CHECKED BY: SAL

**hbe** Hoefler-Butler Engineering, Inc.  
Consulting Civil Engineers - Land Surveyors  
PROFESSIONAL DESIGN FIRM LICENSE NO. 04-000829  
874 S. ROBERTS ROAD HICKORY HILLS, ILLINOIS 60457  
CHgo 599-8980 FAX CHgo 599-9799

FAU RTE.	SECTION	COUNTY	TOTAL SHEETS	SHEET NO.
1524	08-00027-00-RS	COOK	15	3
STA. 10+00		TO STA. 88+81.23		
FED. ROAD DIST. NO.		ILLINOIS	FED. AID PROJECT	
CONTRACT NO. 63017				

ITEM	AC TYPE	VOIDS
HOT-MIX ASPHALT SURFACE CSE. MIX D, N70 (IL-9.5mm)	PG 64-22	4% AT 70 GYR
LEVELING BINDER (MACHINE METHOD), N70	PG 64-22	4% AT 70 GYR
HOT-MIX ASPHALT MEDIAN SURFACE CSE, MIX C, N50	PG 64-22	4% AT 30 GYR
HMA PLACEMENT OVER PATCHES (HMA BINDER IL-19mm)	PG 64-22**	4% AT 30 GYR

1.) THE UNIT WEIGHT TO CALCULATE ALL HMA SURFACE MIXTURE QUANTITIES IS 112 LBS/SQ YD/IN  
 \*\* WHEN RAP EXCEEDS 20%, THE NEW ASPHALT BINDER IN THE MIX SHALL BE PG. 58-22

- |   |   |
|---|---|
| ① EX. P.C.C. BASE CSE, 9"                             | ⑨ CLASS "B" PATCHES (WHERE DIRECTED)                |
| ② EX. ASPHALT SURFACE, 2 1/2"-3 1/2"                  | ⑩ EX. SUB-BASE GRANULAR, 4"                         |
| ③ EX. AGGREGATE BASE, 9"                              | ⑪ EX. CORRUGATED MEDIAN, 11 1/2"                    |
| ④ HOT-MIX ASPHALT SURF. REMOVAL, 2 1/4"               | ⑫ CONCRETE MEDIAN REMOVAL (WHERE DIRECTED)          |
| ⑤ EX. CURB AND GUTTER                                 | ⑬ EX. TIE BARS                                      |
| ⑥ MEDIAN SURFACE REMOVAL                              | ⑭ PROP. TIE BARS @ 2.5' CTRS (INCIDENTAL TO MEDIAN) |
| ⑦ EX. P.C.C. PAVEMENT, ±9"                            | ⑮ PROP. MEDIAN SURFACE, 2"                          |
| ⑧ PROP. HOT-MIX ASPHALT SURF. CSE, MIX D, N70, 2 1/4" | ⑯ AREA REFLECTIVE CRACK CONTROL TREATMENT           |
|   | ⑰ PROP. CORRUGATED MEDIAN (STD. 606306-2)           |

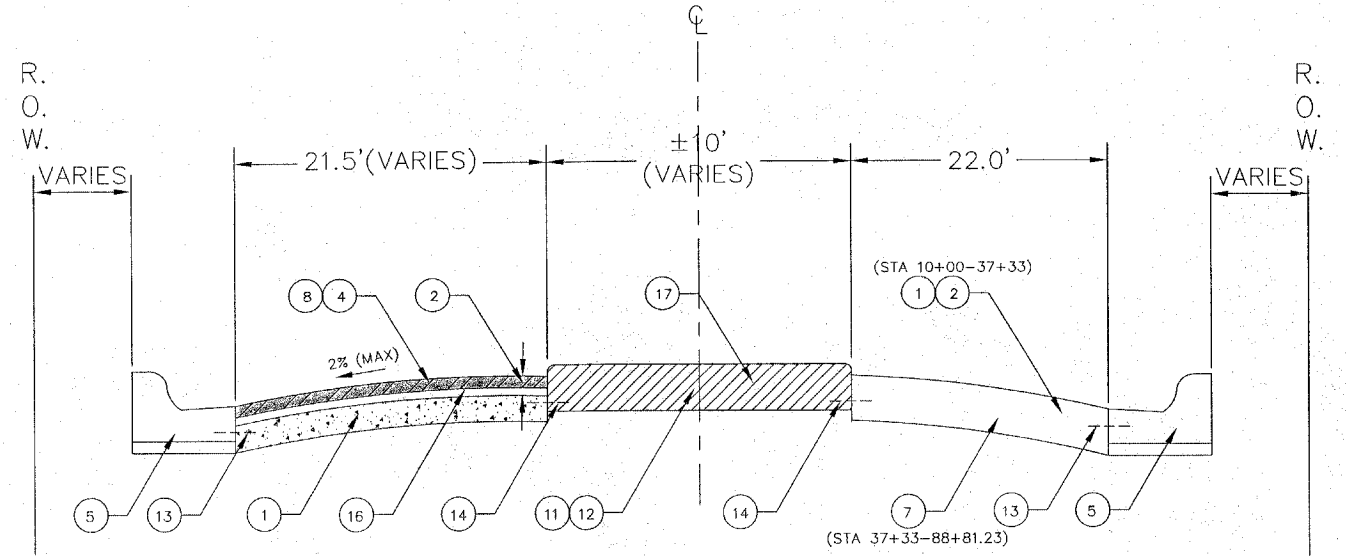

TYPICAL CROSS SECTION W/CONCRETE MEDIAN  
 65TH STREET (STA 10+00 - 88+81.23)

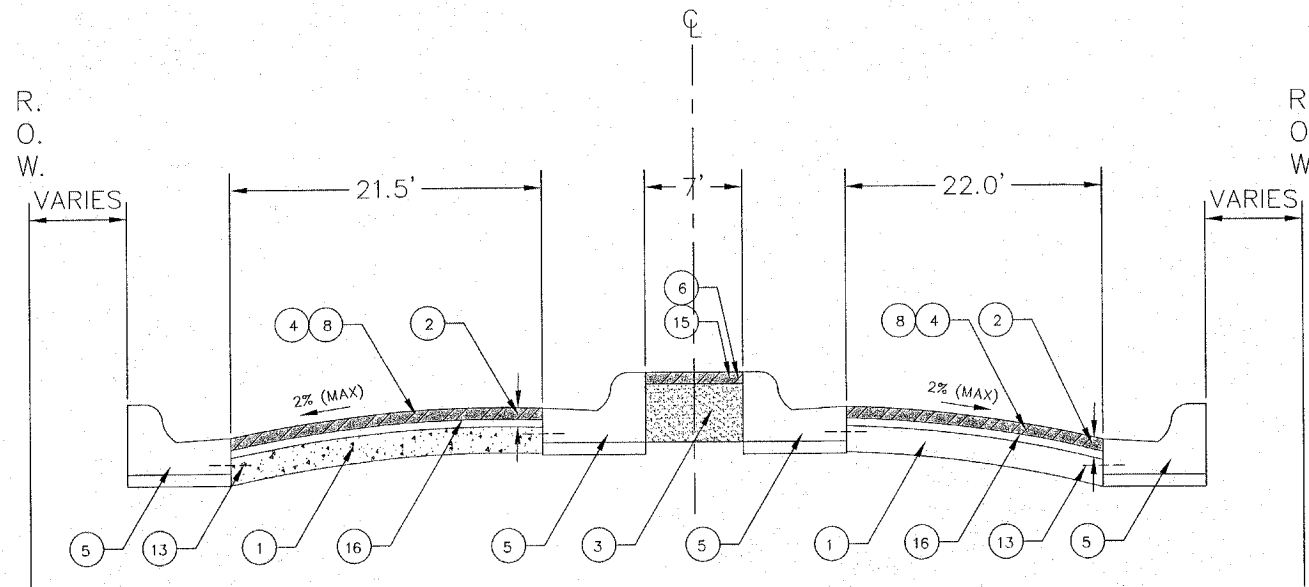

TYPICAL CROSS SECTION W/RAISED ASPHALT MEDIAN  
 65TH STREET (STA 10+00 - 37+33)

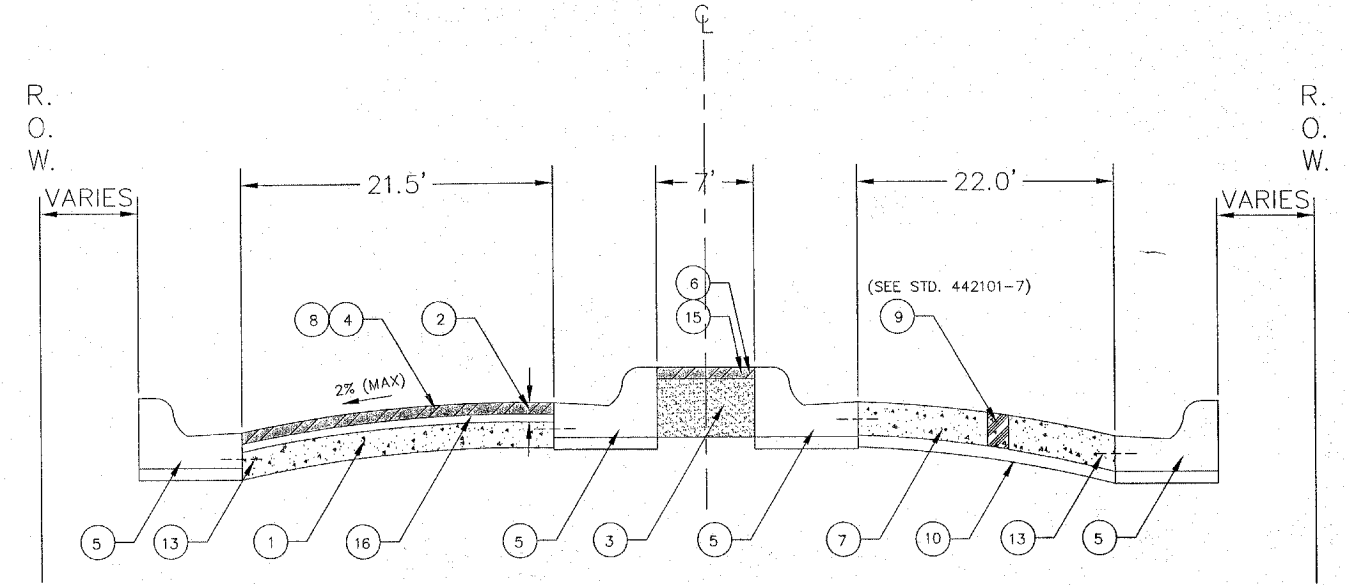

TYPICAL CROSS SECTION W/RAISED ASPHALT MEDIAN  
 65TH STREET (STA 37+33 - 88+81.23)

**hbe Hoeflerle-Butler Engineering, Inc.**  
 Consulting Civil Engineers • Land Surveyors  
 PROFESSIONAL DESIGN FIRM LICENSE NO. 184-008619  
 8714 S. ROBERTS ROAD HICKORY HILLS, ILLINOIS 60427  
 (708) 599-8980 (708) 599-8980 FAX (708) 599-8790

REVISIONS	
NAME	DATE
S. LEIBER	02/15/08

ILLINOIS DEPARTMENT OF TRANSPORTATION  
 VILLAGE OF BEDFORD PARK  
 65TH STREET RESURFACING  
 AUSTIN AVE. TO CICERO AVE.  
 TYPICAL CROSS SECTIONS  
 STA. 10+00 - STA. 88+81.23  
 SCALE: HORIZ. N.T.S.  
 DATE: 10/17/07  
 DRAWN BY: ECC  
 CHECKED BY: SAL

FAU RTE.	SECTION	COUNTY	TOTAL SHEETS	SHEET NO.
1524	08-00027-00-RS	COOK	15	4
STA. 10+00		TO STA. 88+81.23		
FED. ROAD DIST. NO.		ILLINOIS	FED. AID PROJECT	
CONTRACT NO. 63017				

NOTE:  
ALL SANITARY/STORM  
MANHOLES, CATCH BASINS AND  
INLETS SHALL BE ADJUSTED  
WITH RUBBER ADJUSTING RINGS  
AS DIRECTED BY THE ENGINEER.

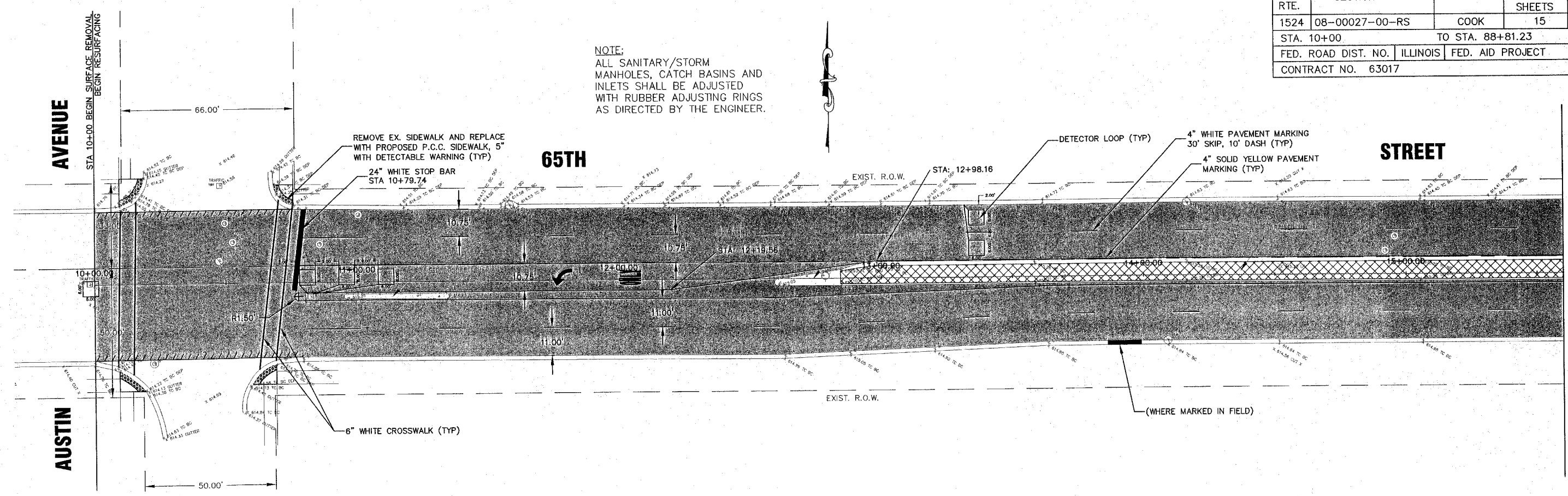

MATCH LINE 15+60

**hbe**  
**Hoeffler-Butler Engineering, Inc.**  
Consulting Civil Engineers - Land Surveyors  
PROFESSIONAL DESIGN FIRM LICENSE NO. 084-000819  
8714 S. ROBERTS ROAD - ROCKFORD, ILLINOIS 61157  
C/O: 595-9980 FAX: 595-9790

- LEGEND**
- PROPOSED CURB AND GUTTER REMOVAL AND REPLACEMENT
  - PROPOSED HOT MIX ASPHALT SURFACE REMOVAL AND HOT MIX ASPHALT SURFACE COURSE, 2 1/4"
  - LIMITS OF SURFACE REMOVAL - BUTT JOINT
  - MEDIAN SURFACE REMOVAL AND HOT-MIX ASPHALT MEDIAN SURFACE REPLACEMENT, 2"

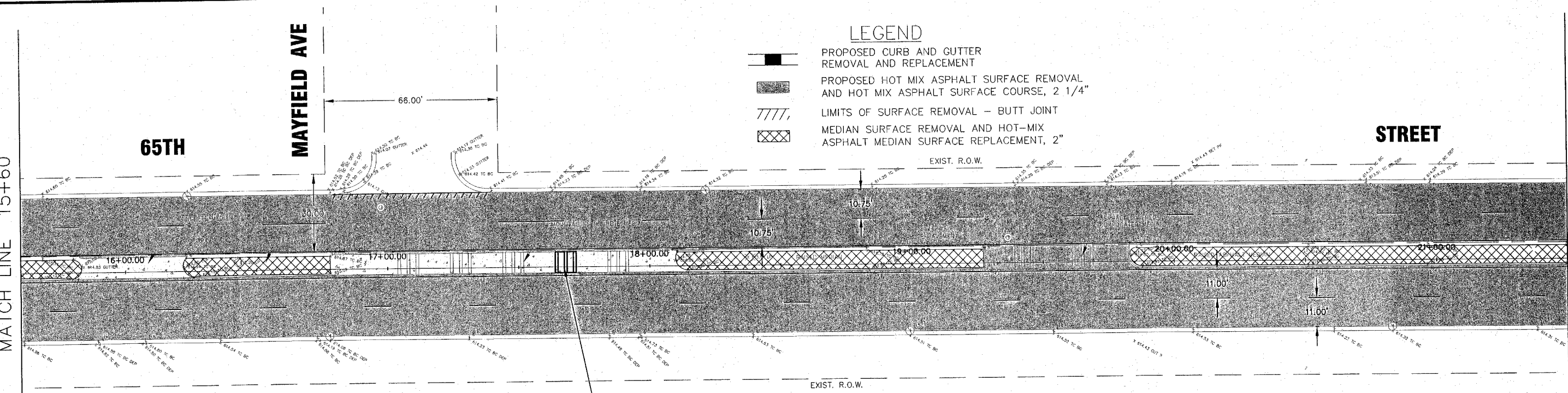

MATCH LINE 15+60

MATCH LINE 21+50



REVISIONS		ILLINOIS DEPARTMENT OF TRANSPORTATION VILLAGE OF BEDFORD PARK 65TH STREET RESURFACING AUSTIN AVE. TO CICERO AVE. PLAN VIEW STA. 10+00 - STA. 21+50
NAME	DATE	
S. LEIBER	02/15/08	SCALE: HORIZ. 1"=20' DATE: 10/17/07 DRAWN BY: ECC CHECKED BY: SAL

FAU RTE.	SECTION	COUNTY	TOTAL SHEETS	SHEET NO.
1524	08-00027-00-RS	COOK	15	5
STA. 10+00		TO STA. 88+81.23		
FED. ROAD DIST. NO.		ILLINOIS	FED. AID PROJECT	
CONTRACT NO. 63017				

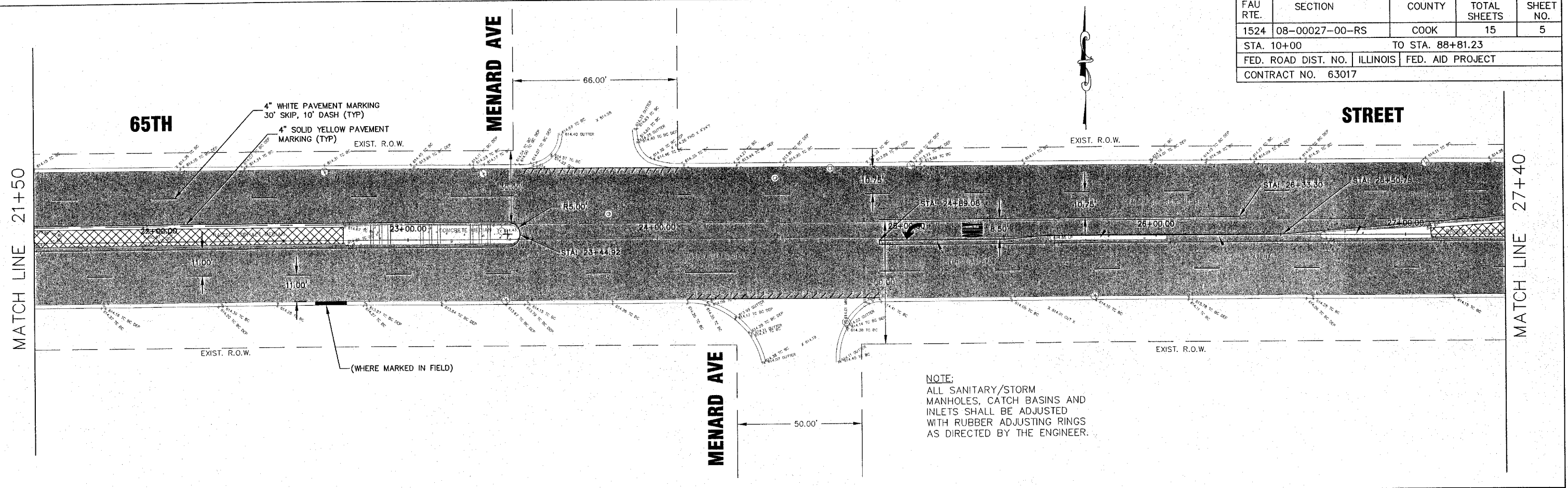

**NOTE:**  
ALL SANITARY/STORM MANHOLES, CATCH BASINS AND INLETS SHALL BE ADJUSTED WITH RUBBER ADJUSTING RINGS AS DIRECTED BY THE ENGINEER.

**Hoefferle-Butler Engineering, Inc.**  
Consulting Civil Engineers - Land Surveyors  
PROFESSIONAL DESIGN FIRM LICENSE NO. 194-008019  
8714 S. ROBERTS ROAD WICKIPY HILLS, ILLINOIS 60457  
708 599-9980 FAX 708 599-8778

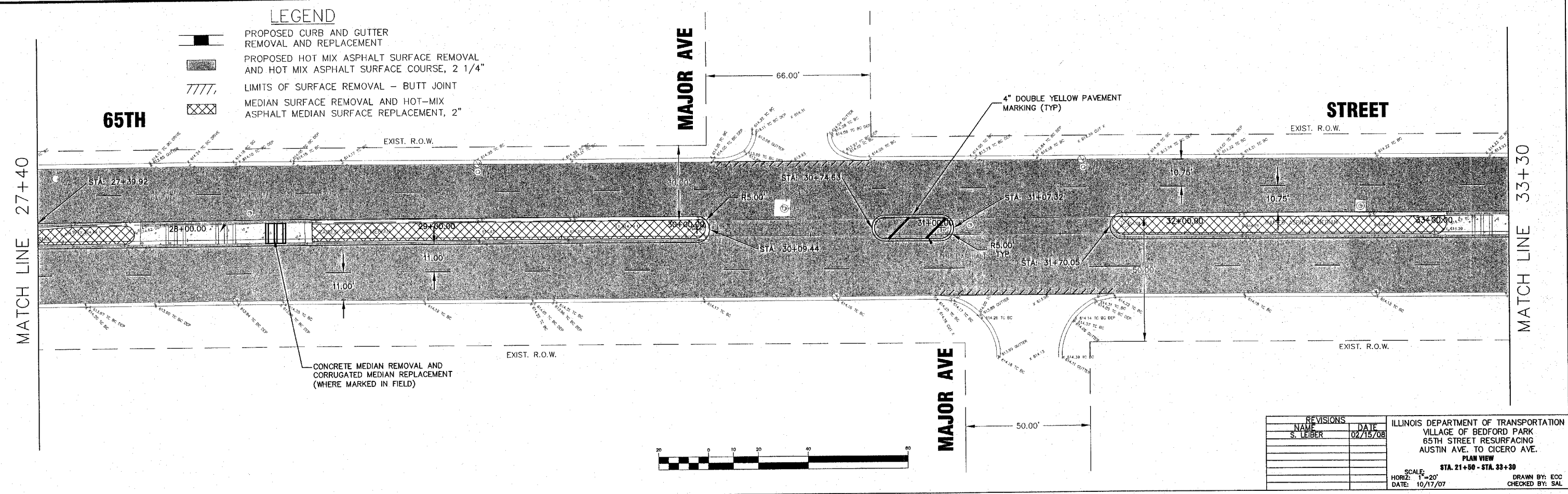

**LEGEND**

	PROPOSED CURB AND GUTTER REMOVAL AND REPLACEMENT
	PROPOSED HOT MIX ASPHALT SURFACE REMOVAL AND HOT MIX ASPHALT SURFACE COURSE, 2 1/4"
	LIMITS OF SURFACE REMOVAL - BUTT JOINT
	MEDIAN SURFACE REMOVAL AND HOT-MIX ASPHALT MEDIAN SURFACE REPLACEMENT, 2"



REVISIONS	
NAME	DATE
S. LEIBER	02/15/08

ILLINOIS DEPARTMENT OF TRANSPORTATION  
VILLAGE OF BEDFORD PARK  
65TH STREET RESURFACING  
AUSTIN AVE. TO CICERO AVE.  
PLAN VIEW  
STA. 21+50 - STA. 33+30  
SCALE: HORIZ: 1"=20'  
DATE: 10/17/07  
DRAWN BY: ECC  
CHECKED BY: SAL

FAU RTE.	SECTION	COUNTY	TOTAL SHEETS	SHEET NO.
1524	08-00027-00-RS	COOK	15	6
STA. 10+00 TO STA. 88+81.23				
FED. ROAD DIST. NO. ILLINOIS		FED. AID PROJECT		
CONTRACT NO. 63017				

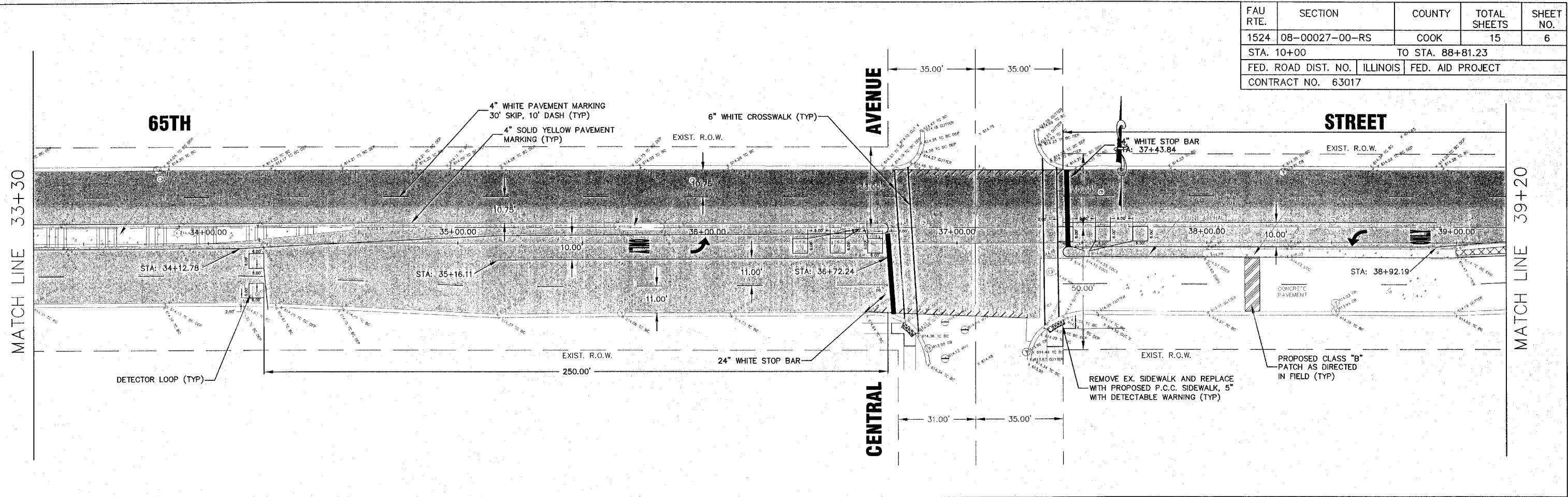

**Hoefferle-Butler Engineering, Inc.**  
 Consulting Civil Engineers • Land Surveyors  
 PROFESSIONAL DESIGN FIRM LICENSE NO. 084-000819  
 8714 S. ROBERTS ROAD HICKORY HILLS, ILLINOIS 60457  
 (708) 599-9900 FAX (708) 599-0790

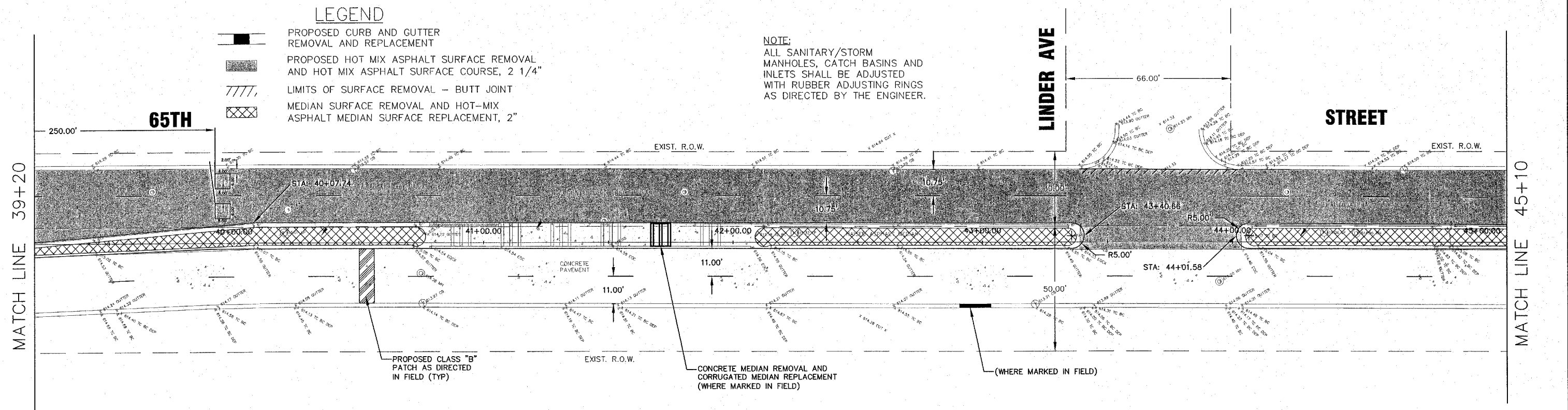

REVISIONS	
NAME	DATE
S. LEIBER	02/15/08

ILLINOIS DEPARTMENT OF TRANSPORTATION  
 VILLAGE OF BEDFORD PARK  
 65TH STREET RESURFACING  
 AUSTIN AVE. TO CICERO AVE.  
 PLAN VIEW  
 STA. 33+30 - STA. 45+10  
 SCALE:  
 HORIZ: 1"=20'  
 DATE: 10/17/07  
 DRAWN BY: ECC  
 CHECKED BY: SAL

FAU RTE.	SECTION	COUNTY	TOTAL SHEETS	SHEET NO.
1524	08-00027-00-RS	COOK	15	7
STA. 10+00		TO STA. 88+81.23		
FED. ROAD DIST. NO.	ILLINOIS	FED. AID PROJECT		
CONTRACT NO. 63017				

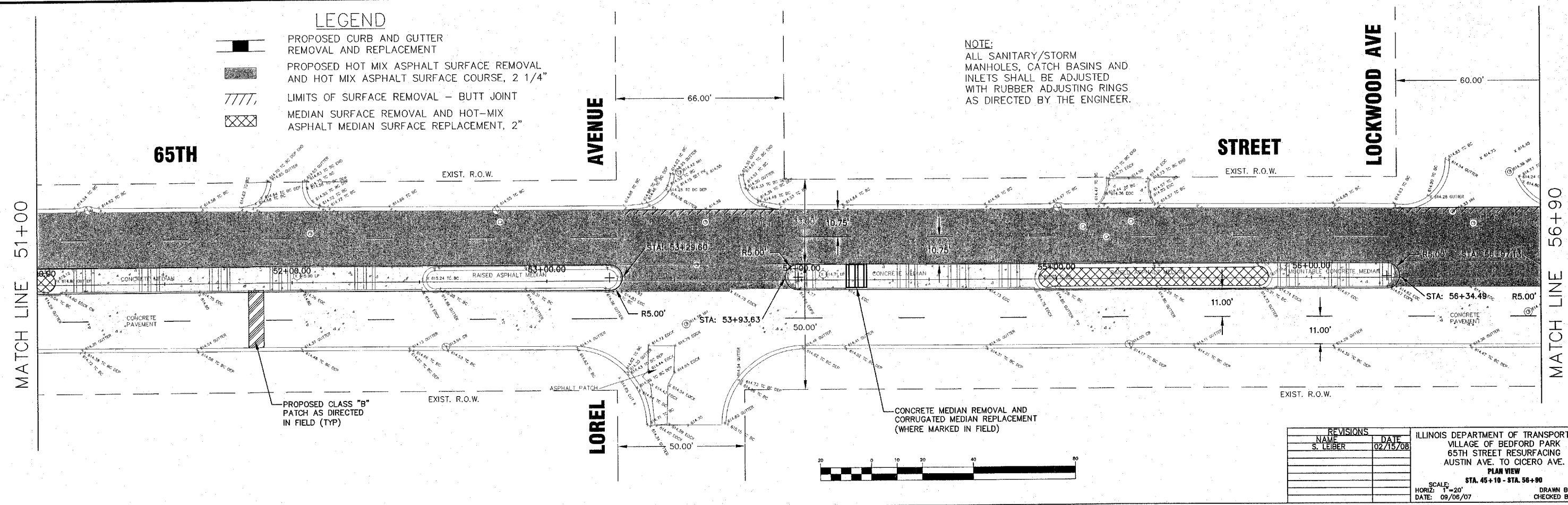
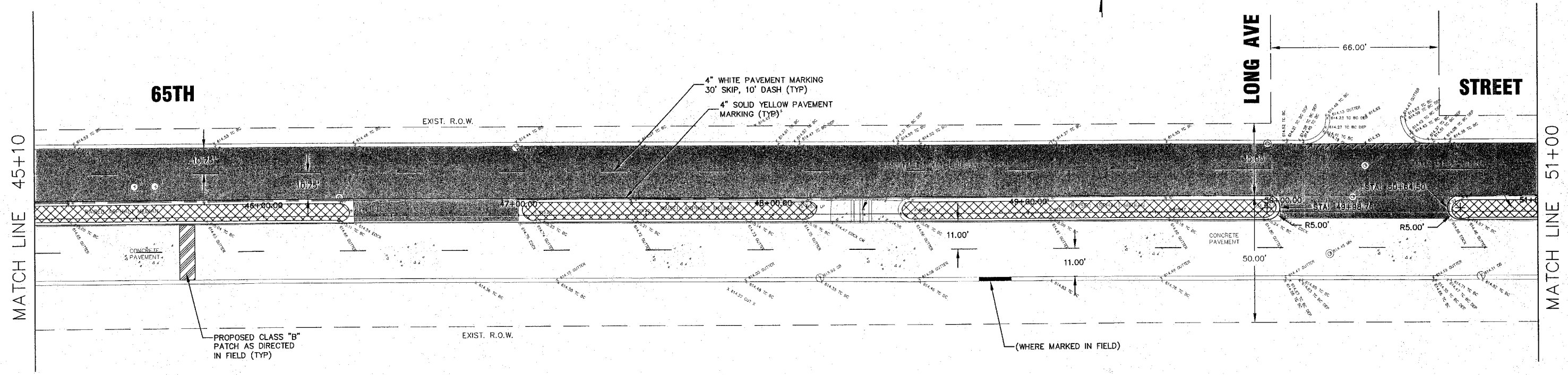

- LEGEND**
- PROPOSED CURB AND GUTTER REMOVAL AND REPLACEMENT
  - PROPOSED HOT MIX ASPHALT SURFACE REMOVAL AND HOT MIX ASPHALT SURFACE COURSE, 2 1/4"
  - LIMITS OF SURFACE REMOVAL - BUTT JOINT
  - MEDIAN SURFACE REMOVAL AND HOT-MIX ASPHALT MEDIAN SURFACE REPLACEMENT, 2"



REVISIONS	
NAME	DATE
S. LEIBER	02/15/08

ILLINOIS DEPARTMENT OF TRANSPORTATION  
 VILLAGE OF BEDFORD PARK  
 65TH STREET RESURFACING  
 AUSTIN AVE. TO CICERO AVE.  
 PLAN VIEW  
 STA. 45+10 - STA. 56+90  
 SCALE: HORIZ: 1"=20'  
 DATE: 09/06/07  
 DRAWN BY: ECC  
 CHECKED BY: SAL

**hbe** Hoeffler-Butler Engineering, Inc.  
 Consulting Civil Engineers • Land Surveyors  
 PROFESSIONAL DESIGN FIRM LICENSE NO. 084-000809  
 8714 S. ROBERTS ROAD, HICKORY HILLS, ILLINOIS 60457  
 (708) 599-9980 FAX (708) 599-9798

FAU RTE.	SECTION	COUNTY	TOTAL SHEETS	SHEET NO.
1524	08-00027-00-RS	COOK	15	8
STA. 10+00		TO STA. 88+81.23		
FED. ROAD DIST. NO.		ILLINOIS	FED. AID PROJECT	
CONTRACT NO. 63017				

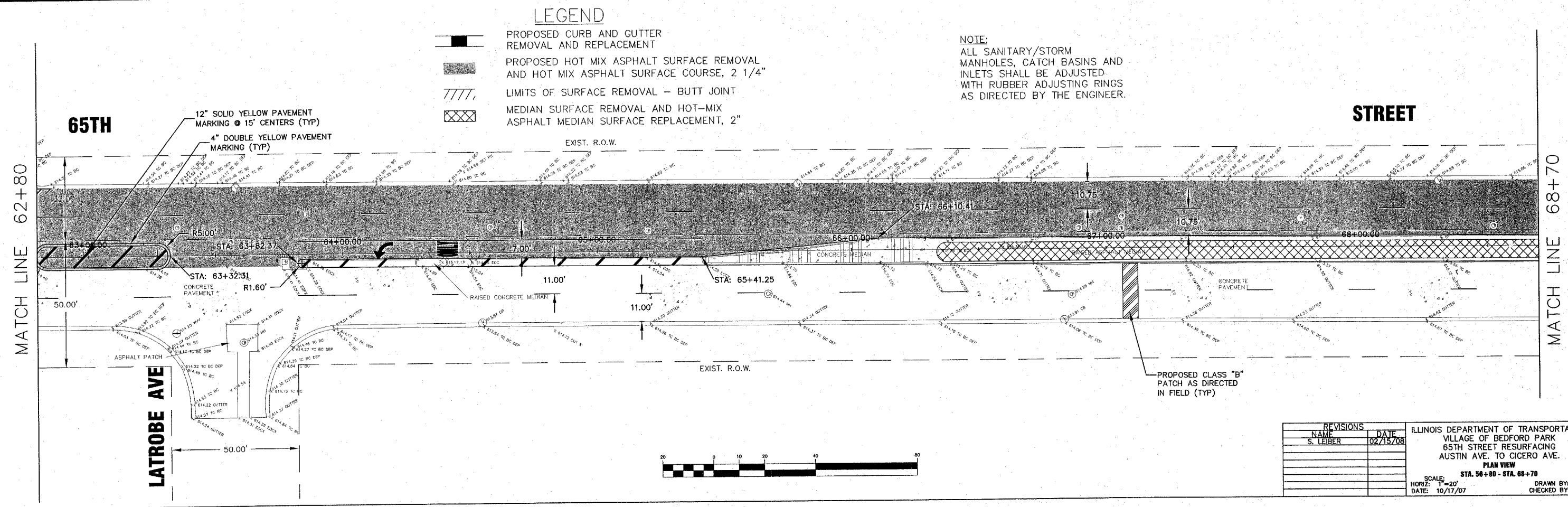
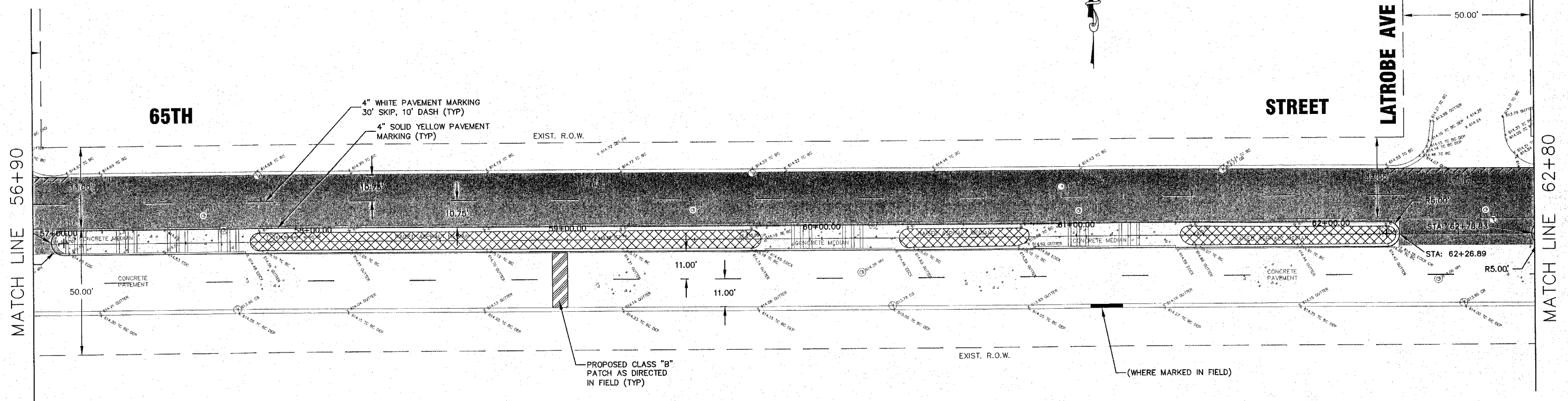

- LEGEND**
- PROPOSED CURB AND GUTTER REMOVAL AND REPLACEMENT
  - PROPOSED HOT MIX ASPHALT SURFACE REMOVAL AND HOT MIX ASPHALT SURFACE COURSE, 2 1/4"
  - LIMITS OF SURFACE REMOVAL - BUTT JOINT
  - MEDIAN SURFACE REMOVAL AND HOT-MIX ASPHALT MEDIAN SURFACE REPLACEMENT, 2"

**NOTE:**  
ALL SANITARY/STORM MANHOLES, CATCH BASINS AND INLETS SHALL BE ADJUSTED WITH RUBBER ADJUSTING RINGS AS DIRECTED BY THE ENGINEER.

**nbe**  
Hoeflerle-Butler Engineering, Inc.  
Consulting Civil Engineers - Land Surveyors  
PROFESSIONAL DESIGN FIRM LICENSE NO. 084-000679  
874 S. ROBERTS ROAD HICKORY HILLS, ILLINOIS 60457  
(708) 599-6980 FAX (708) 599-9790



REVISIONS		DATE
NAME		
S. LEIBER		02/15/08

ILLINOIS DEPARTMENT OF TRANSPORTATION  
VILLAGE OF BEDFORD PARK  
65TH STREET RESURFACING  
AUSTIN AVE. TO CICERO AVE.  
PLAN VIEW  
STA. 56+90 - STA. 68+70  
SCALE: 1"=20'  
DATE: 10/17/07  
DRAWN BY: ECC  
CHECKED BY: SAL



FAU RTE.	SECTION	COUNTY	TOTAL SHEETS	SHEET NO.
1524	08-00027-00-RS	COOK	15	9
STA. 10+00		TO STA. 88+81.23		
FED. ROAD DIST. NO.	ILLINOIS	FED. AID PROJECT		
CONTRACT NO. 63017				

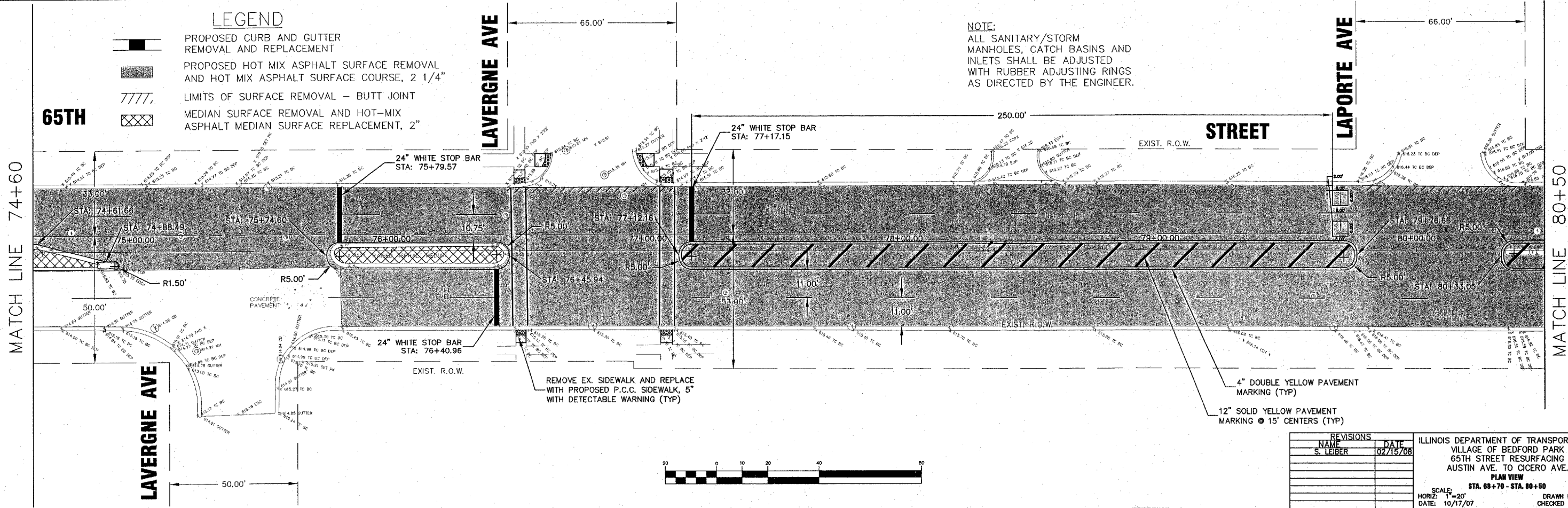
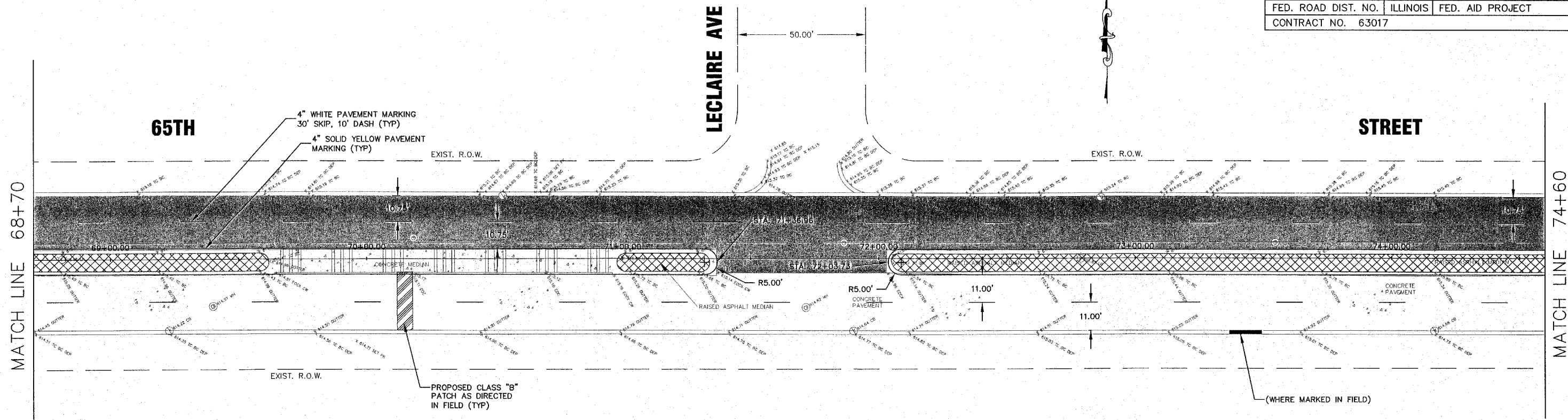

**LEGEND**

	PROPOSED CURB AND GUTTER REMOVAL AND REPLACEMENT
	PROPOSED HOT MIX ASPHALT SURFACE REMOVAL AND HOT MIX ASPHALT SURFACE COURSE, 2 1/4"
	LIMITS OF SURFACE REMOVAL - BUTT JOINT
	MEDIAN SURFACE REMOVAL AND HOT-MIX ASPHALT MEDIAN SURFACE REPLACEMENT, 2"

**NOTE:**  
ALL SANITARY/STORM MANHOLES, CATCH BASINS AND INLETS SHALL BE ADJUSTED WITH RUBBER ADJUSTING RINGS AS DIRECTED BY THE ENGINEER.



REVISIONS		ILLINOIS DEPARTMENT OF TRANSPORTATION VILLAGE OF BEDFORD PARK 65TH STREET RESURFACING AUSTIN AVE. TO CICERO AVE. PLAN VIEW STA. 68+70 - STA. 80+50
NAME	DATE	
S. LEIBER	02/15/08	SCALE: HORIZ: 1"=20' DATE: 10/17/07

DRAWN BY: ECC  
CHECKED BY: SAL

**hbe** Hoefler-Butler Engineering, Inc.  
Consulting Civil Engineers - Land Surveyors  
PROFESSIONAL DESIGN FIRM LICENSE NO. 084-00085  
8714 S. ROBERTS ROAD HICKORY HILLS, ILLINOIS 60457  
(708) 599-8980 FAX (708) 599-8750

FAU RTE.	SECTION	COUNTY	TOTAL SHEETS	SHEET NO.
1524	08-00027-00-RS	COOK	15	10
STA. 10+00		TO STA. 88+81.23		
FED. ROAD DIST. NO.		ILLINOIS	FED. AID PROJECT	
CONTRACT NO. 63017				

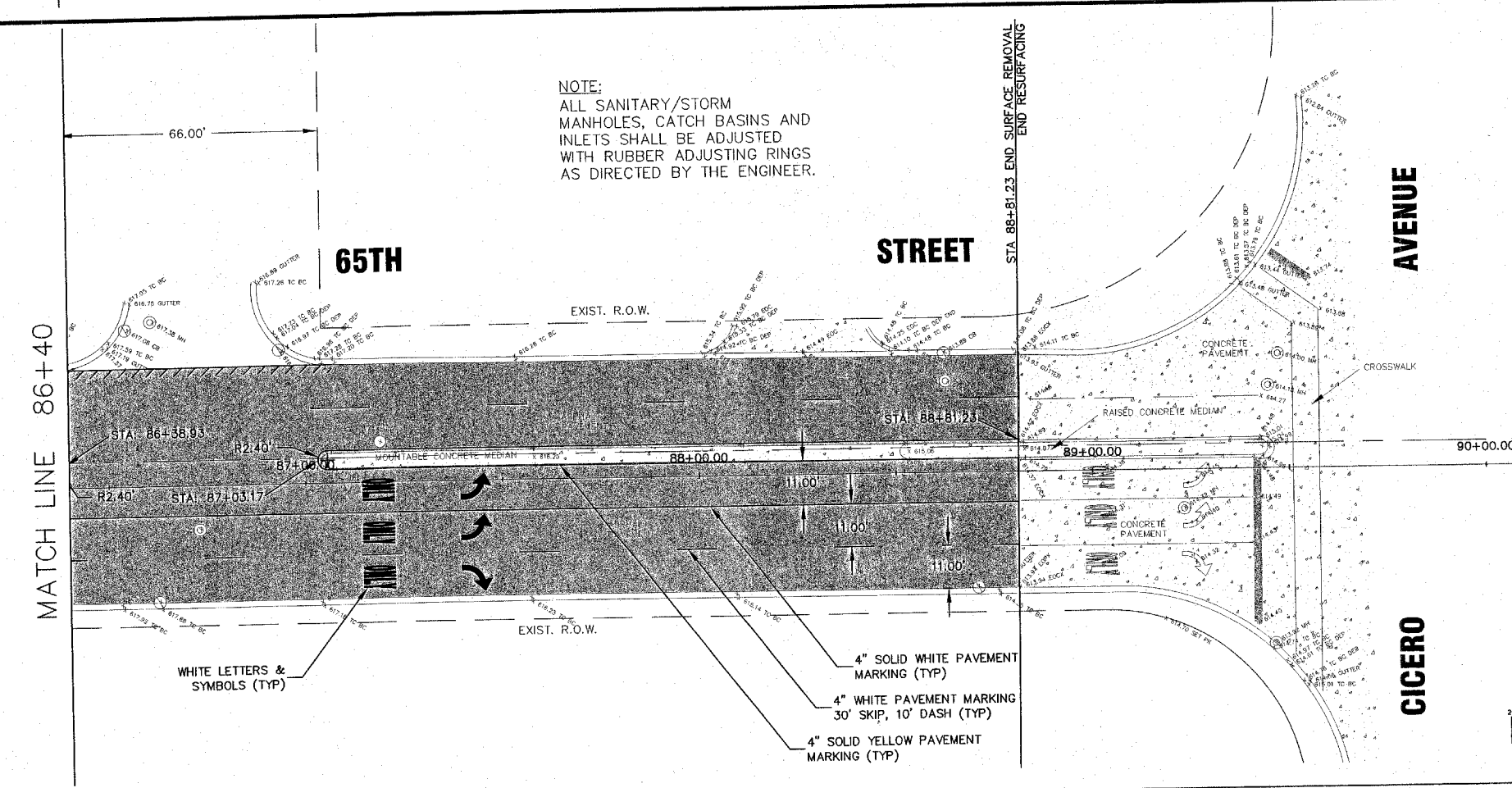
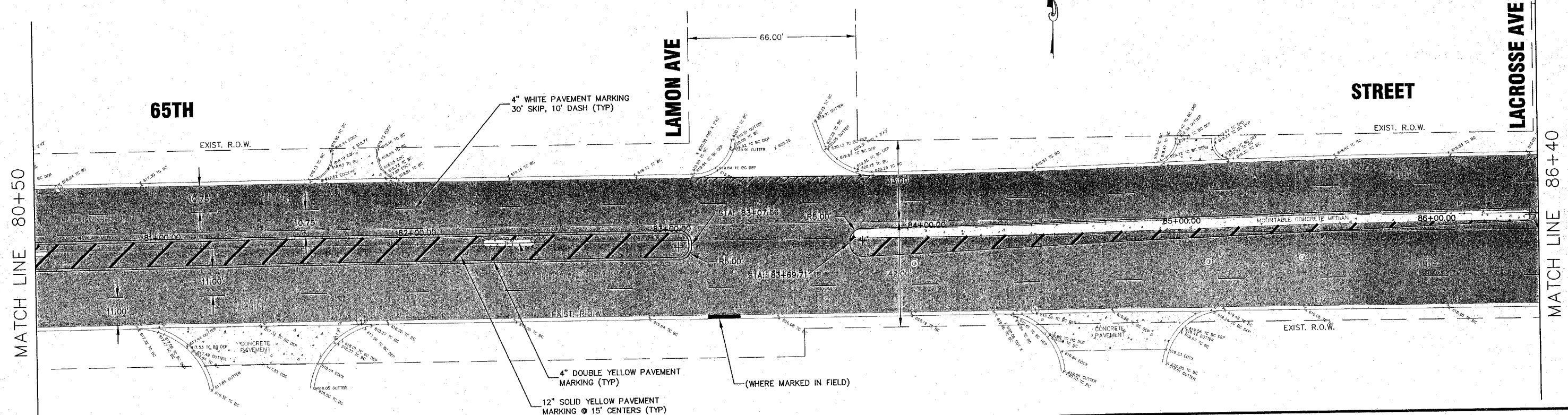

NOTE:  
ALL SANITARY/STORM  
MANHOLES, CATCH BASINS AND  
INLETS SHALL BE ADJUSTED  
WITH RUBBER ADJUSTING RINGS  
AS DIRECTED BY THE ENGINEER.

**LEGEND**

- PROPOSED CURB AND GUTTER REMOVAL AND REPLACEMENT
- PROPOSED HOT MIX ASPHALT SURFACE REMOVAL AND HOT MIX ASPHALT SURFACE COURSE, 2 1/4"
- LIMITS OF SURFACE REMOVAL - BUTT JOINT
- MEDIAN SURFACE REMOVAL AND HOT-MIX ASPHALT MEDIAN SURFACE REPLACEMENT, 2"

**PAVEMENT MARKING NOTES:**  
1) THERMOPLASTIC PAVEMENT MARKING SHALL BE INSTALLED ON BITUMINOUS PAVEMENT ONLY  
2) EPOXY PAVEMENT MARKING SHALL BE INSTALLED ON CONCRETE PAVEMENT ONLY

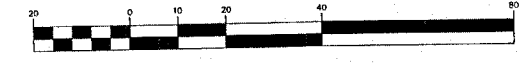

REVISIONS		DATE	ILLINOIS DEPARTMENT OF TRANSPORTATION VILLAGE OF BEDFORD PARK 65TH STREET RESURFACING AUSTIN AVE. TO CICERO AVE. PLAN VIEW STA. 80+50 - STA. 88+81.23
NAME	DATE		
S. LEIBER	02/15/08		

SCALE: 1"=20'  
HORIZ: 1"=20'  
DATE: 10/17/07

DRAWN BY: ECC  
CHECKED BY: SAL

**hbe** Hoeffler-Butler Engineering, Inc.  
Consulting Civil Engineers • Land Surveyors  
PROFESSIONAL DESIGN FIRM LICENSE NO. 084-008879  
8714 S. ROBERTS ROAD HICKORY HILLS, ILLINOIS 60457  
CHS 599-8988 FAX (708) 599-8790

FAU RTE.	SECTION	COUNTY	TOTAL SHEETS	SHEET NO.
1524	08-00027-00-RS	COOK	15	11
STA. 10+00		TO STA. 88+81.23		
FED. ROAD DIST. NO.	ILLINOIS	FED. AID PROJECT		
CONTRACT NO. 63017				

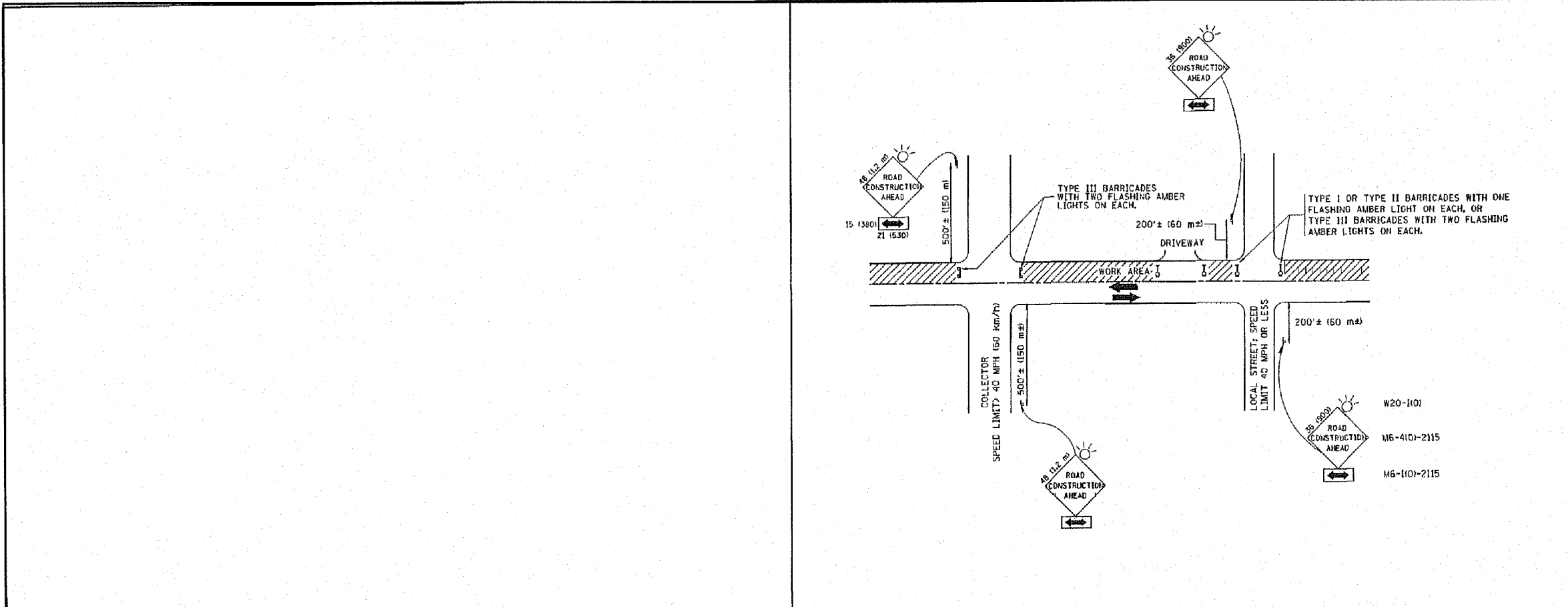

TRAFFIC CONTROL AND PROTECTION FOR SIDE ROADS, INTERSECTIONS, AND DRIVEWAYS

NOTES:

- A. FOR NO LANE RESTRICTION ON THE SIDE ROAD OR DRIVEWAYS
    - 1. SIDE ROAD WITH A SPEED LIMIT OF 40 MPH (64 km/h) OR LESS AS SHOWN ON THE DRAWING AND AS DIRECTED BY THE ENGINEER.
      - a) ONE ROAD CONSTRUCTION AHEAD SIGN 38 x 38 (900x900) WITH A FLASHER AND FLAD MOUNTED ON IT APPROXIMATELY 200' (60 m) IN ADVANCE OF THE MAIN ROUTE.
      - b) THE CLOSED PORTION OF THE MAIN ROUTE SHALL BE PROTECTED BY BLOCKING WITH TYPE I, TYPE II OR TYPE III BARRICADES, 1/3 OF THE CROSS SECTION OF THE CLOSED PORTION.
    - 2. SIDE ROAD WITH A SPEED LIMIT GREATER THAN 40 MPH (64 km/h) AS SHOWN ON THE DRAWING AND AS DIRECTED BY THE ENGINEER.
      - a) ONE ROAD CONSTRUCTION AHEAD SIGN 48 x 48 (12.2 m x 12 m) WITH A FLASHER MOUNTED ON IT APPROXIMATELY 500' (150 m) IN ADVANCE OF THE MAIN ROUTE.
      - b) THE CLOSED PORTION OF THE MAIN ROUTE SHALL BE PROTECTED BY BLOCKING WITH TYPE III BARRICADES, 1/2 OF THE CROSS SECTION OF THE CLOSED PORTION.
  - 3. WHEN THE SIDE ROAD LIES BETWEEN THE BEGINNING OF THE MAINLINE SIGNING AND THE WORK ZONE, A SINGLE HEADED ARROW (M6-11) SHALL BE USED IN LIEU OF THE DOUBLE HEADED ARROW (M6-4).
- B. FOR A LANE CLOSURE ON A SIDE ROAD OR DRIVEWAY:
    - USE APPLICABLE PORTIONS OF THE TYPICAL APPLICATION OF TRAFFIC CONTROL DEVICES (STD. 70150), STD. 701606 OR THE APPROPRIATE STANDARD. THE SPACING OF SIGNS AND BARRICADES SHALL BE ADJUSTED FOR FIELD CONDITIONS AS DIRECTED BY THE ENGINEER. THE DIRECTIONAL ARROW SHALL BE COVERED OR REMOVED WHEN NO LONGER CONSISTENT WITH THE SIDE ROAD LANE CLOSURE.
  - C. ADVANCE WARNING SIGNS ARE TO BE OMITTED ON DRIVEWAY UNLESS OTHERWISE NOTED.
  - D. THE TRAFFIC CONTROL AND PROTECTION FOR SIDE ROADS, INTERSECTIONS, AND DRIVEWAYS SHALL BE INCIDENTAL TO THE COST OF SPECIFIED TRAFFIC CONTROL STANDARDS OR ITEMS.

All dimensions are in millimeters (inches) unless otherwise shown.

**tbce** **Hoefferle-Butler Engineering, Inc.**  
 Consulting Civil Engineers • Land Surveyors  
 PROFESSIONAL DESIGN FIRM LICENSE NO. 194-90869  
 8714 S. ROBERTS ROAD • HICKORY HILLS, ILLINOIS 60437  
 (708) 599-8900 FAX (708) 599-8790

FILE NAME =	USER NAME = gajlarcbt	DESIGNED - LHA	REVISED - J. OBERLE 10-18-95
W:\dist\d1\22+34\1\tbl\tdgn		DRAWN -	REVISED - A. HOUSEH 03-06-96
		CHECKED -	REVISED - A. HOUSEH 10-15-96
		DATE - 06-89	REVISED - T. RAMWACHER 01-06-00

STATE OF ILLINOIS  
DEPARTMENT OF TRANSPORTATION

TRAFFIC CONTROL AND PROTECTION FOR SIDE ROADS, INTERSECTIONS, AND DRIVEWAYS	
SCALE: NONE	SHEET NO. 1 OF 1 SHEETS
STA. TO STA.	

FAU RTE.	SECTION	COUNTY	TOTAL SHEETS	SHEET NO.
	TC-10			
FED. ROAD DIST. NO. 1 ILLINOIS FED. AID PROJECT				

FAU RTE.	SECTION	COUNTY	TOTAL SHEETS	SHEET NO.
1524	08-00027-00-RS	COOK	15	12
STA. 10+00		TO STA. 88+81.23		
FED. ROAD DIST. NO.	ILLINOIS	FED. AID PROJECT		
CONTRACT NO. 63017				

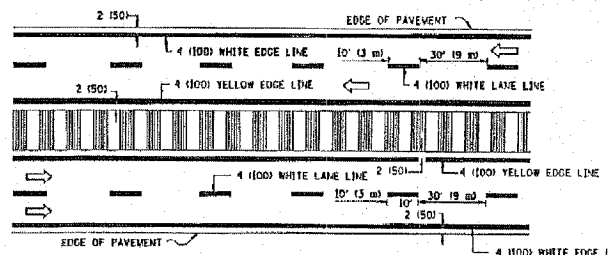
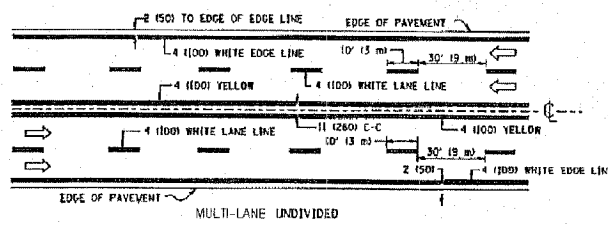
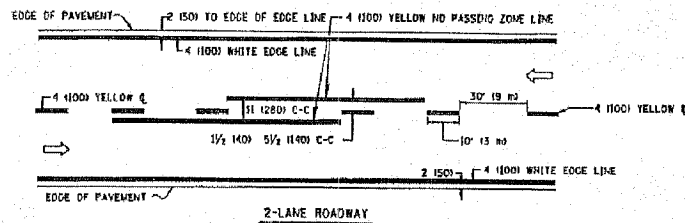

TYPICAL LANE AND EDGE LINE MARKING

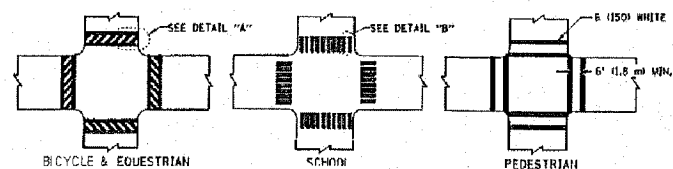

TYPICAL CROSSWALK MARKING

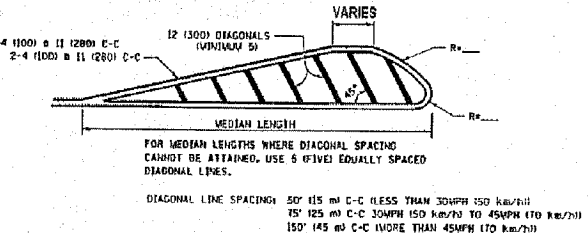
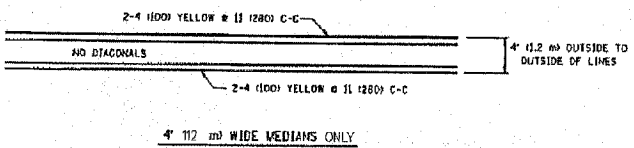

TYPICAL PAINTED MEDIAN MARKING

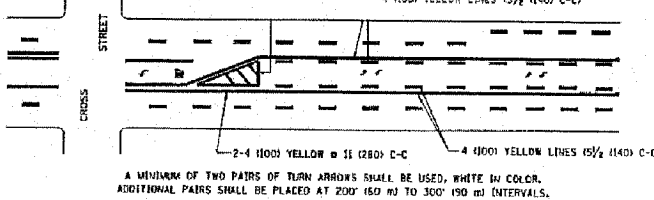

TYPICAL TURN LANE MARKING

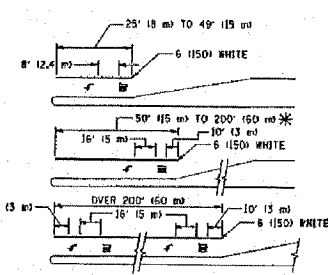

TYPICAL LEFT (OR RIGHT) TURN LANE

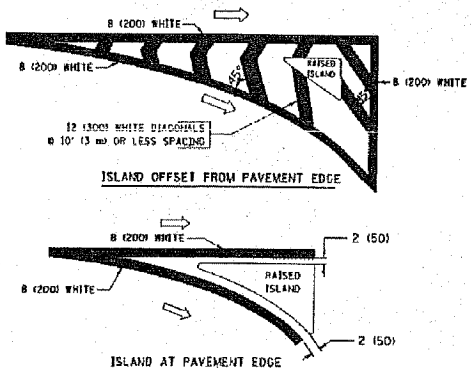

TYPICAL ISLAND MARKING

TYPE OF MARKING	WIDTH OF LINE	PATTERN	COLOR	SPACING / REMARKS
CENTERLINE ON 2 LANE PAVEMENT	4 1100	SKIP-DASH	YELLOW	10' 13 m LANE WITH 30' 19 m SPACE
CENTERLINE ON MULTI-LANE UNDIVIDED PAVEMENT	2 @ 4 1100	SOLID	YELLOW	11 1200 C-C
NO PASSING ZONE LINES FOR ONE DIRECTION	4 1100	SOLID	YELLOW	5 1/2 1400 C-C FROM SKIP-DASH CENTERLINE
LANE LINES	4 1100	SKIP-DASH	WHITE	10' 13 m LANE WITH 30' 19 m SPACE
DOTTED LINES (EXTENSIONS OF CENTER, LANE OR TURN LANE MARKINGS)	5 1/2 @ 4 1100	SKIP-DASH	WHITE	2' 1600 LINE WITH 6' 118 m SPACE
EDGE LINES	4 1100	SOLID	YELLOW-LEFT WHITE-RIGHT	OUTLINE MOUNTABLE MEDIANS IN YELLOW. EDGE LINES ARE NOT USED NEXT TO BARRIER CURB
TURN LANE MARKINGS	6 1150 LINE, FULL SIZE LETTERS & SYMBOLS 12' 12.4m	SOLID	WHITE	SEE TYPICAL TURN LANE MARKING DETAIL
TWO WAY LEFT TURN MARKING	2 @ 4 1100 EACH DIRECTION	SKIP-DASH AND SOLID	YELLOW	10' 13 m LANE WITH 30' 19 m SPACE FOR SKIP-DASH 5 1/2 1400 C-C BETWEEN SOLID LINE AND SKIP-DASH LINE
CROSSWALK LINES (PEDESTRIAN & DIAGONALS 18" & EQUESTRIAN & LONGITUDINAL BARS (SCHWIN))	2 @ 6 1150; 12 1300 @ 45°; 12 1300 @ 90°	SOLID	WHITE	NOT LESS THAN 6' 11.8 m APART; 2' 1600 APART; SEE TYPICAL CROSSWALK MARKING DETAILS.
STOP LINES	24 1600	SOLID	WHITE	PLACE 4' 11.2 m IN ADVANCE OF AND PARALLEL TO CROSSWALK, IF PRESENT. OTHERWISE, PLACE AT DESIRED STOPPING POINT, PARALLEL TO CROSSWALK CENTERLINE, WHERE POSSIBLE
PAINTED MEDIANS	2 @ 4 1100 WITH 12 1300 DIAGONALS @ 45°	SOLID	YELLOW; TWO WAY TRAFFIC WHITE; ONE WAY TRAFFIC	11 1200 C-C FOR THE DOUBLE LINE; SEE TYPICAL PAINTED MEDIAN MARKING.
CORE MARKING AND CHANNELIZING LINES	8 1200 WITH 12 1300 DIAGONALS @ 45°	SOLID	WHITE	DIAGONALS: 15' 14.5 m C-C (LESS THAN 30MPH (50 km/h)); 20' 16 m C-C (30MPH (50 km/h) TO 45MPH (70 km/h)); 30' 19 m C-C (OVER 45MPH (70 km/h))
RAILROAD CROSSING	24 1600 TRANSVERSE LINES; "RR" 15 6' (4.6 m) LETTERS; 16 1400 LINE FOR "X"	SOLID	WHITE	SEE STATE STANDARD 76000; AREA OF "RR" 3.3 SQ. FT. (0.33 m²) EACH; "X" 54.0 SQ. FT. (5.0 m²)
SHOULDER DIAGONALS	12 1300 @ 45°	SOLID	WHITE - RIGHT YELLOW - LEFT	50' 15 m C-C (LESS THAN 30MPH (50 km/h)); 75' 25 m C-C (30MPH (50 km/h) TO 45MPH (70 km/h)); 150' 145 m C-C (OVER 45MPH (70 km/h))

FOR FURTHER DETAILS ON PAVEMENT MARKING REFER TO STANDARD SPECIFICATIONS FOR ROAD AND BRIDGE CONSTRUCTION AND STATE STANDARD 180000.

All dimensions are in inches (millimeters) unless otherwise shown.

**hbe** Hoeffler-Butler Engineering, Inc.  
 Consulting Civil Engineers - Land Surveyors  
 PROFESSIONAL DESIGN FIRM LICENSE NO. 04-00079  
 874 S. ROBERTS ROAD - ROCKFORD HILLS, ILLINOIS 60457  
 (708) 599-6980 FAX (708) 599-6798

FILE NAME =	USER NAME =	DESIGNED -	REVISIONS
W:\data\10122\22\31\1013.dgn	gaglione	EVERS	-T. RAMMACHER 10-27-94
		DRAWN -	REVISIONS
		HOUSEH	-A. HOUSEH 10-09-96
		CHECKED -	REVISIONS
		HOUSEH	-A. HOUSEH 10-17-96
		DATE	REVISIONS
		03-19-90	-T. RAMMACHER 01-06-00

STATE OF ILLINOIS  
 DEPARTMENT OF TRANSPORTATION

DISTRICT ONE		F.A. RTE.	SECTION	COUNTY	TOTAL SHEETS	SHEET NO.
TYPICAL PAVEMENT MARKINGS						
SCALE: NONE	SHEET NO. 1 OF 1 SHEETS	STA.	TO STA.	TC-13 CONTRACT NO.		
		FED. ROAD DIST. NO. 1 ILLINOIS FED. AID PROJECT				

FAU RTE.	SECTION	COUNTY	TOTAL SHEETS	SHEET NO.
1524	08-00027-00-RS	COOK	15	13
STA. 10+00		TO STA. 88+81.23		
FED. ROAD DIST. NO.		ILLINOIS	FED. AID PROJECT	
CONTRACT NO. 63017				

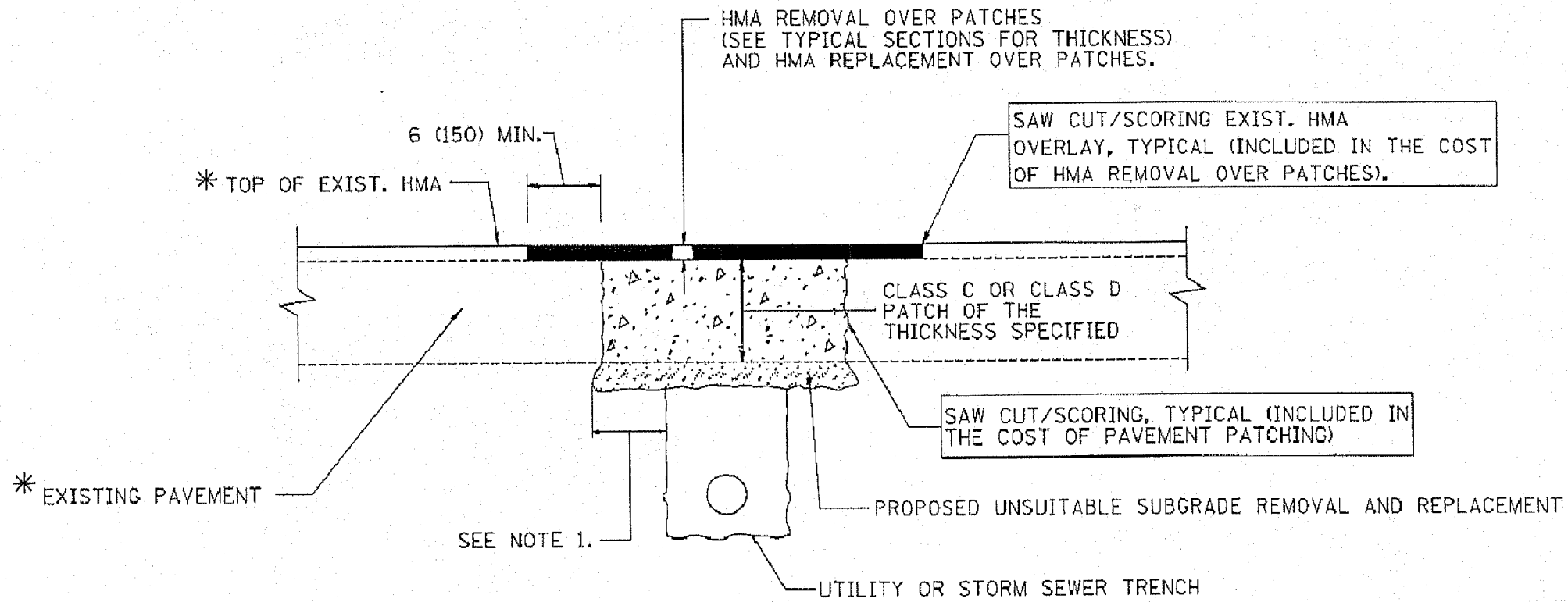

\* SEE TYPICAL SECTIONS FOR THICKNESS AND MATERIALS

**NOTES:**

1. THE WIDTH OF THE FULL DEPTH PATCH OVER A TRENCH SHALL BE 12 (300) WIDER ON EACH SIDE OF THE TRENCH.
2. FOR METHOD OF MEASUREMENT AND BASIS OF PAYMENT, SEE RECURRING SPECIAL PROVISION "PATCHING WITH HOT-MIX ASPHALT OVERLAY REMOVAL".

**SEQUENCE OF CONSTRUCTION**

1. REMOVE THE EXISTING HMA MATERIAL OVER THE AREA TO BE PATCHED.
2. REMOVE AND REPLACE FULL DEPTH PATCHES
3. REPLACE HMA MATERIAL OVER THE AREA TO BE PATCHED.

ALL DIMENSIONS ARE IN INCHES (MILLIMETERS) UNLESS OTHERWISE SHOWN.

FILE NAME =	USER NAME = gopliam01	DESIGNED - R. SHAW	REVISED - A. ABRAGI 01-20-08	<b>STATE OF ILLINOIS DEPARTMENT OF TRANSPORTATION</b>	<b>PAVEMENT PATCHING FOR HMA SURFACED PAVEMENT</b>			SECTION	COUNTY	TOTAL SHEETS	SHEET NO.
W:\Users\gopliam01\22-34\1002.dgn		DRAWN -	REVISED - A. ASBAG 04-27-08		SCALE: NONE	SHEET NO. 1 OF 1 SHEETS	STA.	TO STA.	08000-04 (00-22)	CONTRACT NO.	
		PLOT SCALE = 5/8" = 1' IN	CHECKED - R. BORD 01-01-07						FED. ROAD DIST. NO. 1	ILLINOIS	FED. AID PROJECT
		PLOT DATE = 11/22/08	DATE = 10-25-04		REVISED - R. BORD 03-04-07						

**hbe**  
**Hoefler-Butler Engineering, Inc.**  
 Consulting Civil Engineers - Land Surveyors  
 PROFESSIONAL DESIGN FIRM LICENSE NO. 084-000819  
 8714 S. ROBERTS ROAD HICKORY HILLS, ILLINOIS 60437  
 (708) 599-8580 FAX (708) 599-8770

FAU RTE.	SECTION	COUNTY	TOTAL SHEETS	SHEET NO.
1524	08-00027-00-RS	COOK	15	14
STA. 10+00		TO STA. 88+81.23		
FED. ROAD DIST. NO.		ILLINOIS	FED. AID PROJECT	
CONTRACT NO. 63017				

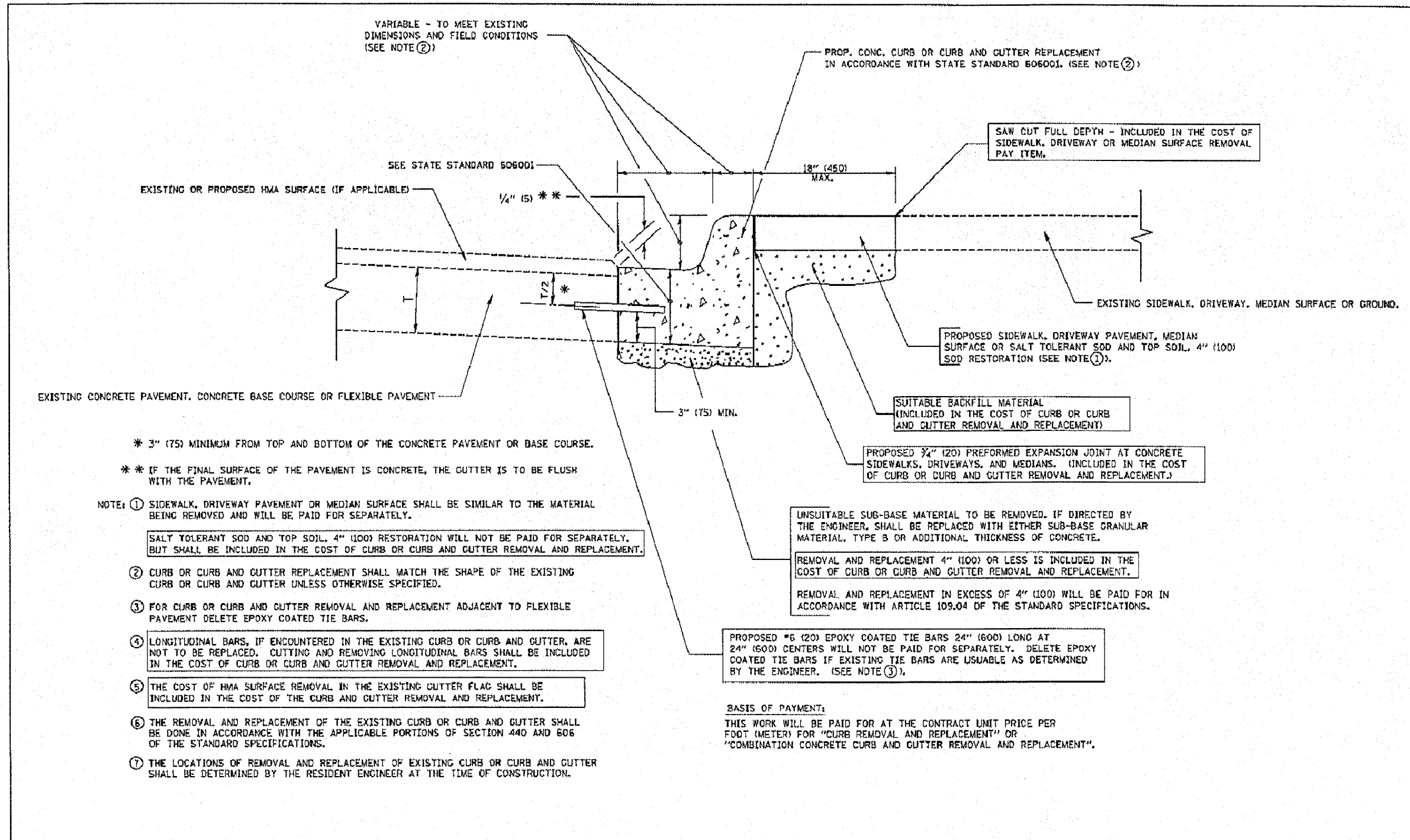

- \* 3" (75) MINIMUM FROM TOP AND BOTTOM OF THE CONCRETE PAVEMENT OR BASE COURSE.
  - \*\* IF THE FINAL SURFACE OF THE PAVEMENT IS CONCRETE, THE GUTTER IS TO BE FLUSH WITH THE PAVEMENT.
- NOTE: ① SIDEWALK, DRIVEWAY PAVEMENT OR MEDIAN SURFACE SHALL BE SIMILAR TO THE MATERIAL BEING REMOVED AND WILL BE PAID FOR SEPARATELY.
- SALT TOLERANT SOD AND TOP SOIL, 4" (100) RESTORATION WILL NOT BE PAID FOR SEPARATELY, BUT SHALL BE INCLUDED IN THE COST OF CURB OR CURB AND GUTTER REMOVAL AND REPLACEMENT.
- ② CURB OR CURB AND GUTTER REPLACEMENT SHALL MATCH THE SHAPE OF THE EXISTING CURB OR CURB AND GUTTER UNLESS OTHERWISE SPECIFIED.
  - ③ FOR CURB OR CURB AND GUTTER REMOVAL AND REPLACEMENT ADJACENT TO FLEXIBLE PAVEMENT DELETE EPOXY COATED TIE BARS.
  - ④ LONGITUDINAL BARS, IF ENCOUNTERED IN THE EXISTING CURB OR CURB AND GUTTER, ARE NOT TO BE REPLACED. CUTTING AND REMOVING LONGITUDINAL BARS SHALL BE INCLUDED IN THE COST OF CURB OR CURB AND GUTTER REMOVAL AND REPLACEMENT.
  - ⑤ THE COST OF HMA SURFACE REMOVAL IN THE EXISTING GUTTER FLAG SHALL BE INCLUDED IN THE COST OF THE CURB AND GUTTER REMOVAL AND REPLACEMENT.
  - ⑥ THE REMOVAL AND REPLACEMENT OF THE EXISTING CURB OR CURB AND GUTTER SHALL BE DONE IN ACCORDANCE WITH THE APPLICABLE PORTIONS OF SECTION 440 AND 606 OF THE STANDARD SPECIFICATIONS.
  - ⑦ THE LOCATIONS OF REMOVAL AND REPLACEMENT OF EXISTING CURB OR CURB AND GUTTER SHALL BE DETERMINED BY THE RESIDENT ENGINEER AT THE TIME OF CONSTRUCTION.

**BASIS OF PAYMENT:**  
 THIS WORK WILL BE PAID FOR AT THE CONTRACT UNIT PRICE PER FOOT (METER) FOR "CURB REMOVAL AND REPLACEMENT" OR "COMBINATION CONCRETE CURB AND GUTTER REMOVAL AND REPLACEMENT".

## CURB OR CURB AND GUTTER REMOVAL AND REPLACEMENT

ALL DIMENSIONS ARE IN INCHES (MILLIMETERS) UNLESS OTHERWISE SHOWN.

FILE NAME <small>h:\data\08-00027-00-RS\08-00027-00-RS.dwg</small>	USER NAME <small>goglarob</small>	DESIGNED - A. HOUGH DRAWN -	REVISED - R. SHAH 10-03-96 REVISED - A. ANDAS 03-21-97 CHECKED - M. GOMEZ 01-22-01 DATE - 03-11-94 REVISED - R. DORO 01-01-07	<b>STATE OF ILLINOIS</b> <b>DEPARTMENT OF TRANSPORTATION</b>	<b>CURB OR CURB AND GUTTER</b> <b>REMOVAL AND REPLACEMENT</b>	SCALE: NONE SHEET NO. 1 OF 1 SHEETS STA. TO STA.	F.A. RTE. SECTION COUNTY TOTAL SHEETS SHEET NO. CONTRACT NO.
						RD000-08 (RD-24) FED. ROAD DIST. NO. 1 ILLINOIS FED. AID PROJECT	

**Hoefferle-Butler Engineering, Inc.**  
 Consulting Civil Engineers - Land Surveyors  
 PROFESSIONAL DESIGN FIRM LICENSE NO. 084-00089  
 8714 S. ROBERTS ROAD - HICKORY HILLS, ILLINOIS 60457  
 (708) 599-8980 FAX (708) 599-8799

HBE-006407-303

FAU RTE.	SECTION	COUNTY	TOTAL SHEETS	SHEET NO.
1524	08-00027-00-RS	COOK	15	15
STA. 10+00		TO STA. 88+81.23		
FED. ROAD DIST. NO.	ILLINOIS	FED. AID PROJECT		
CONTRACT NO. 63017				

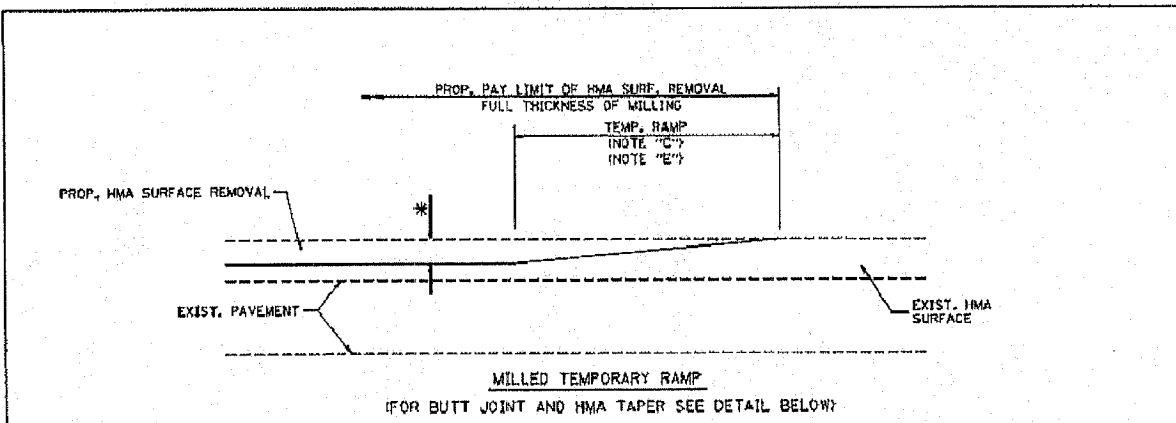

OPTION 1

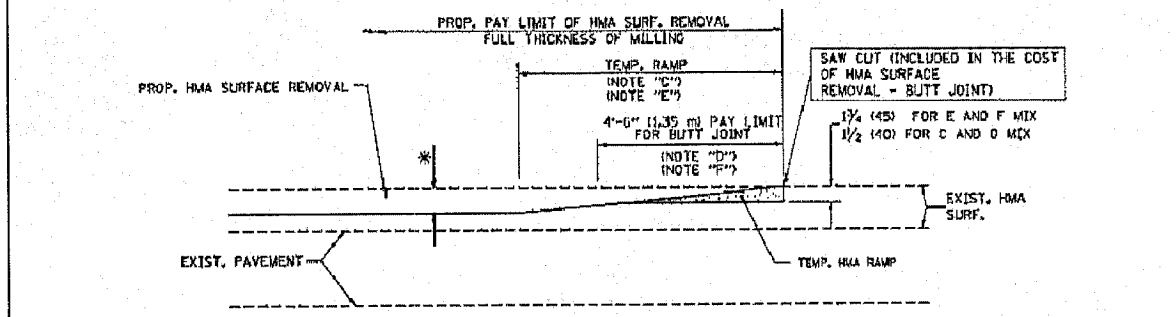

OPTION 2

TYPICAL TEMPORARY RAMP

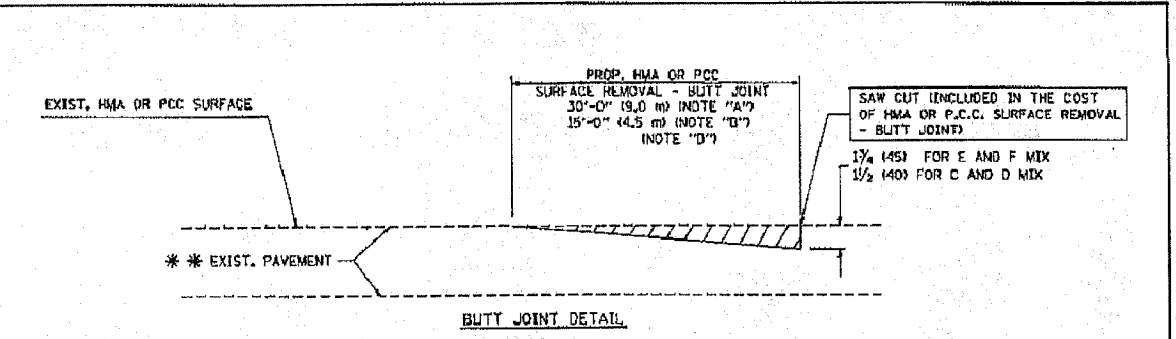

BUTT JOINT DETAIL

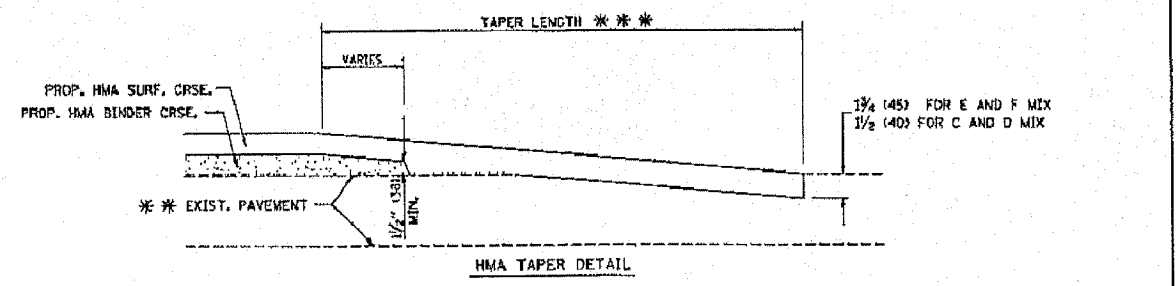

HMA TAPER DETAIL

TYPICAL BUTT JOINT AND HMA TAPER FOR RESURFACING ONLY

\*\* PC CONCRETE, HMA OR HMA RESURFACED PAVEMENT.

NOTES

- A: MAINLINE ROADWAYS AND MAJOR SIDE ROADS.
- B: MINOR SIDE ROADS.
- C: THE TEMP. RAMP SHALL BE CONSTRUCTED IMMEDIATELY UPON REMOVAL OF THE EXISTING HMA SURFACE.
- D: THE BUTT JOINT SHALL BE CONSTRUCTED IMMEDIATELY PRIOR TO PLACING THE PROPOSED HMA COURSES.
- E: TAPER THE TEMP. RAMP AT A RATE OF 3'-0" (900 mm) PER 1 INCH (25 mm) OF MILLING THICKNESS.
- F: INSTALLATION AND REMOVAL OF THE 4'-6" (1.35 m) TEMP. RAMP IS INCLUDED IN COST OF HMA SURFACE REMOVAL - BUTT JOINT.
- G: SEE ARTICLE 406.08 AND 406.14 OF THE STANDARD SPECIFICATIONS FOR "HMA AND/OR PCC SURFACE REMOVAL - BUTT JOINT".
- \* SEE TYPICAL SECTIONS FOR MILLING THICKNESS.
- \*\* 20'-0" (6.1 m) PER 1 (25) RESURFACING (NOTE "A")
- \*\*\* 10'-0" (3.0 m) PER 1 (25) RESURFACING (NOTE "B")

BASIS OF PAYMENT:

THE BUTT JOINT WILL BE PAID FOR AT THE CONTRACT UNIT PRICE PER SQUARE YARD (SQUARE METER) FOR "HOT-MIX ASPHALT SURFACE REMOVAL - BUTT JOINT" OR FOR "PORTLAND CEMENT CONCRETE SURFACE REMOVAL - BUTT JOINT".

ALL DIMENSIONS ARE IN INCHES (MILLIMETERS) UNLESS OTHERWISE SHOWN.

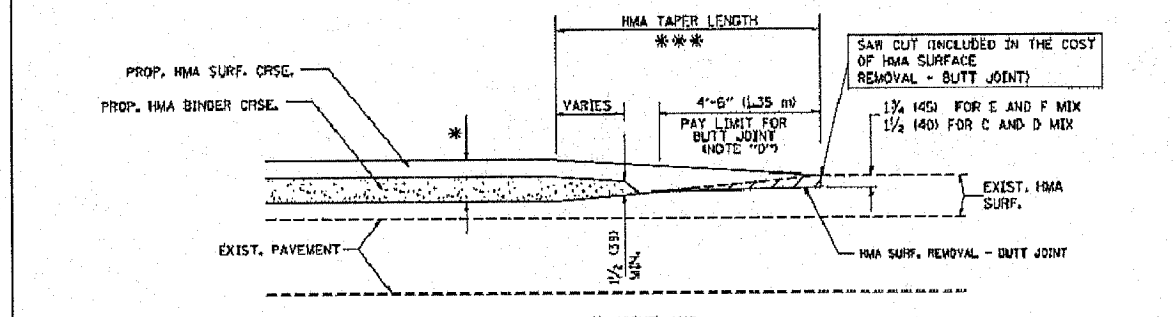

BUTT JOINT AND HMA TAPER

TYPICAL BUTT JOINT AND HMA TAPER FOR MILLING AND RESURFACING

FILE NAME	USER NAME	DESIGNED	REVISION
W:\11111111\11111111.dwg	gnglscrobt	U. DE VONG	R. SHAH 10-25-94
		DRAWN	REVISION
			A. ARIAS 03-21-07
		CHECKED	REVISION
			M. DOMEZ 04-05-01
		DATE	REVISION
		06-13-90	R. EGRO 01-01-07

STATE OF ILLINOIS  
DEPARTMENT OF TRANSPORTATION

BUTT JOINT AND HMA TAPER DETAILS		SECTION	COUNTY	TOTAL SHEETS	SHEET NO.
SCALE: NONE		08-00027-00-RS	COOK	15	15
SHEET NO. 1 OF 1 SHEETS		CONTRACT NO.		STA. TO STA.	
		08-00027-00-RS		10+00 TO 88+81.23	
		FED. ROAD DIST. NO. 1 ILLINOIS FED. AID PROJECT			

**Hoefferle-Butler Engineering, Inc.**  
 Consulting Civil Engineers • Land Surveyors  
 PROFESSIONAL DESIGN FIRM LICENSE NO. 084-00819  
 8714 S. ROBERTS ROAD, WOODRIDGE HILLS, ILLINOIS 60457  
 (708) 599-8800 FAX (708) 599-8700