

FAU RTE	SECTION	COUNTY	TOTAL SHEETS	SHEET NO
2651	06-00081-00-RS	DUPAGE	13	4
STA. 38+00.00		TO STA. 44+00.00		
FED. ROAD DIST. NO. 1		ILLINOIS		FED. AID PROJECT
CONTRACT NO. 63031				

- (A) HOT MIX ASPHALT SURFACE REMOVAL, 3"
- (C) HOT-MIX ASPHALT SURFACE REMOVAL, 1" BETWEEN BACK OF CURB AND SIDEWALK

- (B) EXISTING CURB & GUTTER TO REMAIN
- (D) FRAMES AND LIDS TO BE ADJUSTED (SPECIAL) -- TO MATCH NEW GRADE AS REQUIRED

- (H) PORTLAND CEMENT CONCRETE SURFACE REMOVAL (VARIABLE DEPTH), SEE TYPICAL CROSS SECTION.

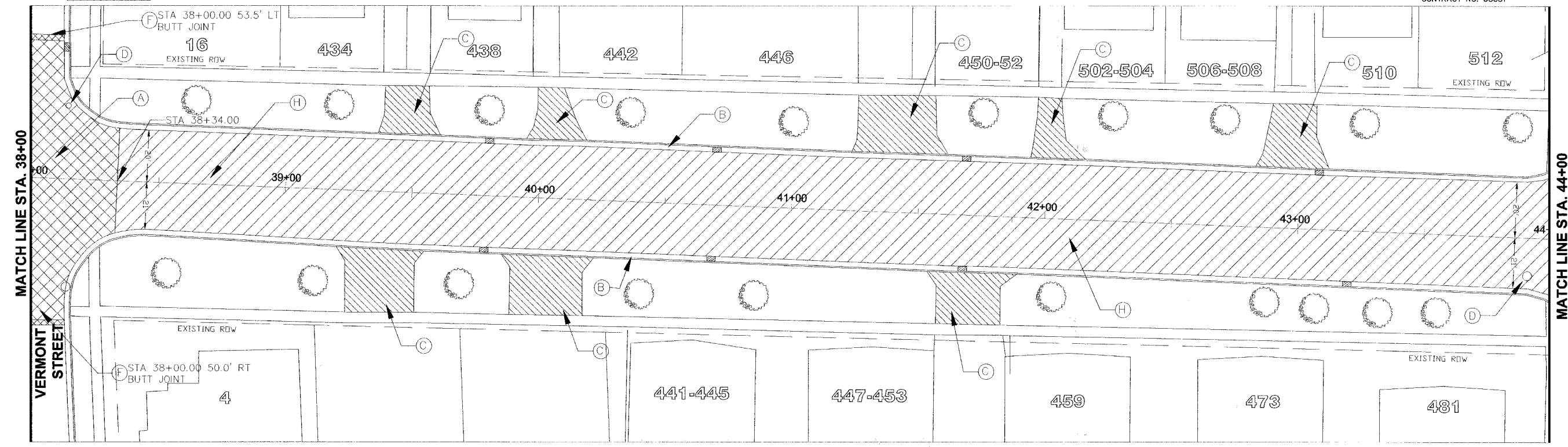

**ARDMORE AVENUE - EXISTING CONDITIONS**

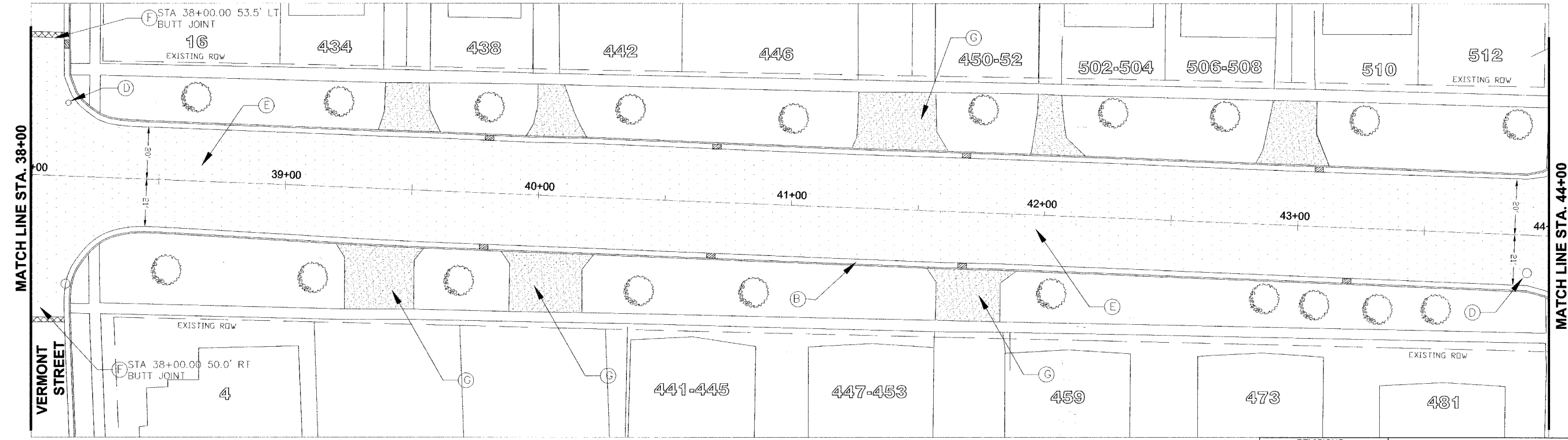
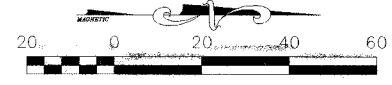

**ARDMORE AVENUE - PROPOSED IMPROVEMENTS**

- (E) RESURFACE PAVEMENT (STA 32+18.25 TO STA 43+65.00)  
1" POLYMERIZED LEVELING BINDER (MACHINE METHOD), IL-4.75, N50  
2" HOT MIX ASPHALT SURFACE COURSE, MIX "D", N70  
RESURFACE PAVEMENT (STA 43+65.00 TO STA 54+42.00)  
3/4" POLYMERIZED LEVELING BINDER (MACHINE METHOD), IL-4.75, N50  
2" HOT MIX ASPHALT SURFACE COURSE, MIX "D", N70
- (F) HOT-MIX ASPHALT SURFACE REMOVAL--BUTT JOINT

- (G) RESURFACE DRIVEWAY PAVEMENT  
1" HOT MIX ASPHALT SURFACE COURSE, MIX "D", N50  
MATCH WITH TOP OF CURB AND SIDEWALK

- (H) PORTLAND CEMENT CONCRETE SURFACE REMOVAL (VARIABLE DEPTH), SEE TYPICAL CROSS SECTION.

REVISIONS	
NAME	DATE
PER IDOT REVIEW	02/25/08

ILLINOIS DEPARTMENT OF TRANSPORTATION  
VILLAGE OF VILLA PARK  
**ARDMORE AVENUE RESURFACING  
DEVELOPMENT PLAN**  
STA 38+00 TO STA 44+00  
SCALE: 1" = 20'  
DATE: 12/28/07  
DRAWN BY: C.C.  
CHECKED BY: S.K.