

FAU RTE	SECTION	COUNTY	TOTAL SHEETS	SHEET NO
2651	06-00081-00-RS	DUPAGE	13	6
STA. 50+00.00		TO STA. 54+42.00		
FED. ROAD DIST. NO. 1	ILLINOIS	FED. AID PROJECT		
CONTRACT NO. 63031				

(C) HOT-MIX ASPHALT SURFACE REMOVAL, 1" BETWEEN BACK OF CURB AND SIDEWALK

(B) EXISTING CURB & GUTTER TO REMAIN

(H) PORTLAND CEMENT CONCRETE SURFACE REMOVAL (VARIABLE DEPTH), SEE TYPICAL CROSS SECTION.

(D) FRAMES AND LIDS TO BE ADJUSTED (SPECIAL) -- TO MATCH NEW GRADE AS REQUIRED

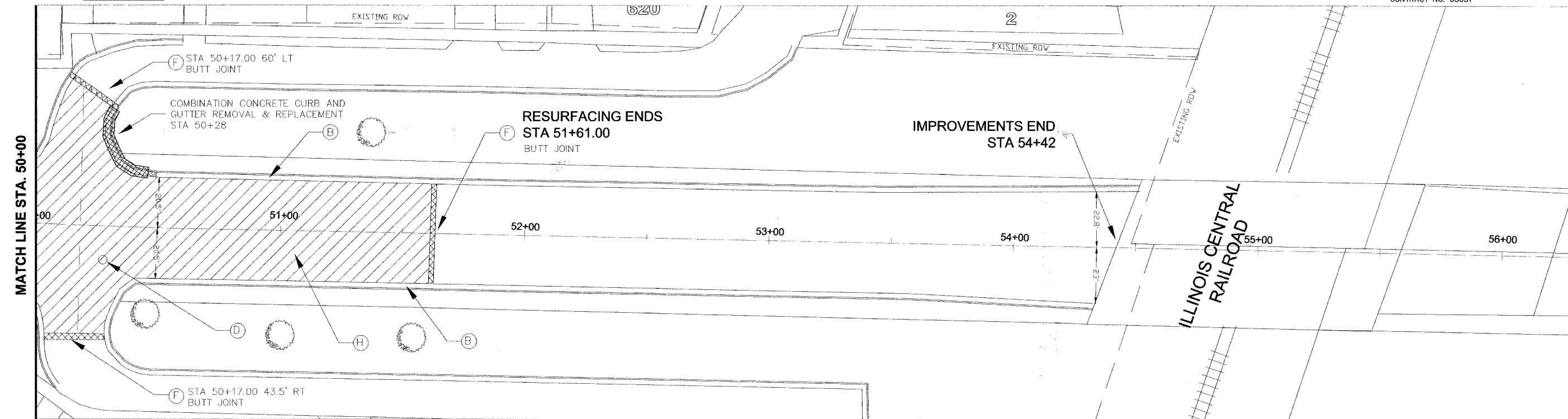

**ARDMORE AVENUE - EXISTING CONDITIONS**

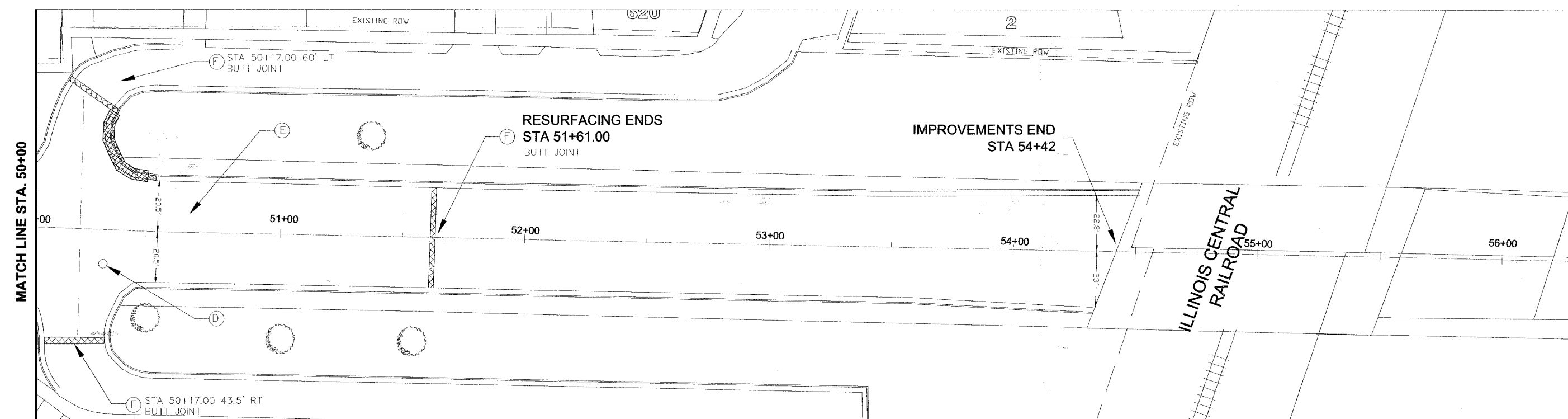
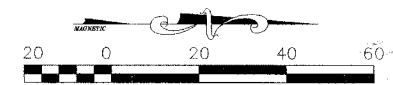

**ARDMORE AVENUE - PROPOSED IMPROVEMENTS**

(E) RESURFACE PAVEMENT (STA 32+18.25 TO STA 43+65.00)  
 1" POLYMERIZED LEVELING BINDER (MACHINE METHOD), IL-4.75, N50  
 2" HOT MIX ASPHALT SURFACE COURSE, MIX "D", N70  
 RESURFACE PAVEMENT (STA 43+65.00 TO STA 54+42.00)  
 3/4" POLYMERIZED LEVELING BINDER (MACHINE METHOD), IL-4.75, N50  
 2" HOT MIX ASPHALT SURFACE COURSE, MIX "D", N70

(F) HOT-MIX ASPHALT SURFACE REMOVAL-BUTT JOINT

(G) RESURFACE DRIVEWAY PAVEMENT  
 1" HOT MIX ASPHALT SURFACE COURSE, MIX "D", N50  
 MATCH WITH TOP OF CURB AND SIDEWALK

REVISIONS	
NAME	DATE
PER IDOT REVIEW	02/25/06

ILLINOIS DEPARTMENT OF TRANSPORTATION  
 VILLAGE OF VILLA PARK  
**ARDMORE AVENUE RESURFACING  
 DEVELOPMENT PLAN**  
 STA 50+00 to STA 54+42.00

SCALE: 1" = 20'  
 DATE: 12/28/07

DRAWN BY: C.C.  
 CHECKED BY: S.K.