

F.A.P. RTE.	SECTION	COUNTY	TOTAL SHEETS	SHEET NO.
301	3HBR-2	WINNEBAGO	171	43
STA.		TO STA.233+00		
FED. ROAD DIST. NO.		ILLINOIS FED. AID PROJECT		

# STAGE 1

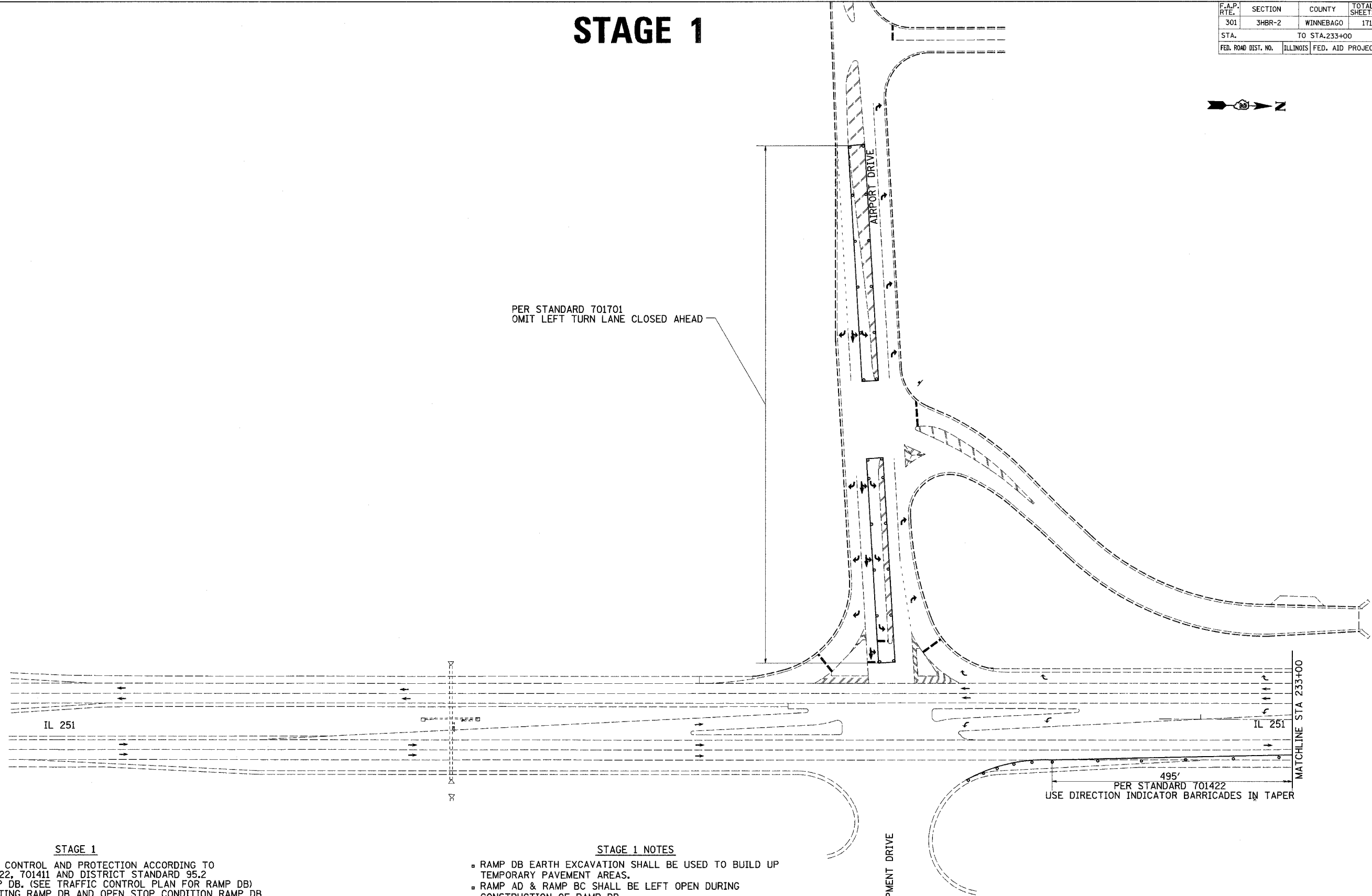

PER STANDARD 701701  
OMIT LEFT TURN LANE CLOSED AHEAD

IL 251

IL 251

MATCHLINE STA 233+00

495'  
PER STANDARD 701422  
USE DIRECTION INDICATOR BARRICADES IN TAPER

DEVELOPMENT DRIVE

**STAGE 1**

1. SET UP TRAFFIC CONTROL AND PROTECTION ACCORDING TO STANDARDS 701422, 701411 AND DISTRICT STANDARD 95.2
2. CONSTRUCT RAMP DB. (SEE TRAFFIC CONTROL PLAN FOR RAMP DB)
3. CLOSE THE EXISTING RAMP DB AND OPEN STOP CONDITION RAMP DB AND REMOVE EXISTING PAVEMENT.
4. SHOULDER REMOVAL AND REPLACEMENT. (SEE TRAFFIC CONTROL PLAN FOR RAMP BC & AD)
5. CONSTRUCT TEMPORARY PAVEMENT AT RAMPS CB & DA & TEMPORARY RAMPS BD & AC TO BE USED IN STAGE 3A & 3B.
6. CLOSE TEMPORARY RAMPS TO TRAFFIC USING TYPE III BARRICADES AND DRUMS AT 10' CENTERS.

**STAGE 1 NOTES**

- RAMP DB EARTH EXCAVATION SHALL BE USED TO BUILD UP TEMPORARY PAVEMENT AREAS.
- RAMP AD & RAMP BC SHALL BE LEFT OPEN DURING CONSTRUCTION OF RAMP DB
- RAMP DB & RAMP AD SHALL BE LEFT OPEN DURING CONSTRUCTION OF SHOULDERS AND TEMPORARY PAVEMENT OF RAMP BC.
- RAMP DB & RAMP BC SHALL BE LEFT OPEN DURING CONSTRUCTION OF SHOULDERS AND TEMPORARY PAVEMENT OF RAMP AD.

NOTE: SEE HIGHWAY STANDARDS 701400, 701422, 701701, 701901 AND DISTRICT STANDARD 95.2 FOR OTHER DEVICES NOT SHOWN.  
USE DIRECTION INDICATOR BARRICADES IN TAPER.

PLOT DATE = Fri, Mar 14 09:46:02 2008  
FILE NAME = c:\projects\64292\64292.dgn  
PLOT SCALE = 1/8"=1'-0"  
USER NAME = c:\dwd