

STATE OF ILLINOIS  
DEPARTMENT OF TRANSPORTATION

ROUTE NO.	SECTION	COUNTY	STATES	SHEET NO.	SHEET NO. 11
FAP 301	3HBR-2	WINNEBAGO	171	91	34 SHEETS
FED. ROAD DIST. NO. 7	ILLINOIS	FED. AID PROJECT-			

Contract No. 64292

NORTH CURB LINE

Location	Station	Offset	Theoretical Grade Elevations
End W. Appr. Pav't.	99197.57	-30.42	751.44
A	99207.57	-30.42	751.57
B	99217.57	-30.42	751.70
Beg. of W. Appr. Pav't.	99227.57	-30.42	751.83

NORTH EDGE OF EXTERIOR TRAFFIC LANE

Location	Station	Offset	Theoretical Grade Elevations
End W. Appr. Pav't.	99197.57	-24.00	751.57
A	99207.57	-24.00	751.70
B	99217.57	-24.00	751.83
Beg. of W. Appr. Pav't.	99227.57	-24.00	751.96

NORTH EDGE OF INTERIOR TRAFFIC LANE

Location	Station	Offset	Theoretical Grade Elevations
End W. Appr. Pav't.	99197.57	-12.00	751.82
A	99207.57	-12.00	751.95
B	99217.57	-12.00	752.08
Beg. of W. Appr. Pav't.	99227.57	-12.00	752.21

☉ ROADWAY & STAGE CONSTRUCTION JOINT

Location	Station	Offset	Theoretical Grade Elevations
End W. Appr. Pav't.	99197.57	0.00	752.01
A	99207.57	0.00	752.14
B	99217.57	0.00	752.27
Beg. of W. Appr. Pav't.	99227.57	0.00	752.40

P.G. & SOUTH EDGE OF EXTERIOR TRAFFIC LANE

Location	Station	Offset	Theoretical Grade Elevations
End W. Appr. Pav't.	99197.57	12.00	751.82
A	99207.57	12.00	751.95
B	99217.57	12.00	752.08
Beg. of W. Appr. Pav't.	99227.57	12.00	752.21

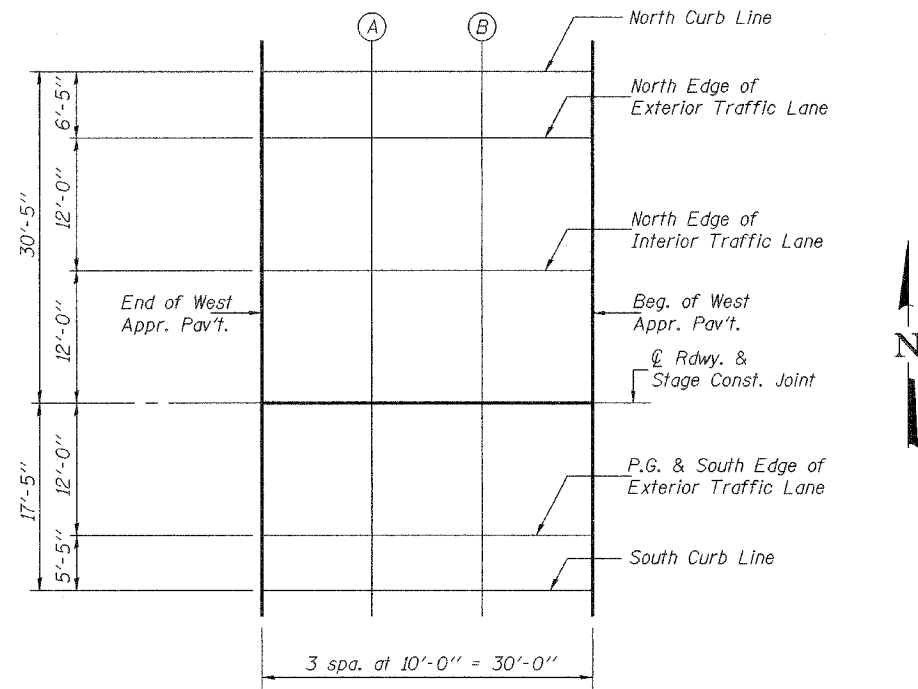

**PLAN**  
West Approach (W.B.)

SOUTH CURB LINE

Location	Station	Offset	Theoretical Grade Elevations
End W. Appr. Pav't.	99197.57	17.42	751.71
A	99207.57	17.42	751.84
B	99217.57	17.42	751.97
Beg. of W. Appr. Pav't.	99227.57	17.42	752.10

DESIGNED	Stephen M. Ryan
CHECKED	Fess Teklehaimanot
DRAWN	h.t. duong
CHECKED	SMR/FT

EXAMINED	Thomas J. Domagala	Apr. 25, 2008
PASSED	Ralph E. Anderson	

**TOP OF WEST APPROACH  
SLAB ELEVATIONS (W.B.)  
F.A.P. RTE. 301 - SEC. 3HBR-2  
WINNEBAGO COUNTY  
STATION 993+43.82  
STRUCTURE NO. 101-0065 (E.B.)  
STRUCTURE NO. 101-0066 (W.B.)**