

STATE OF ILLINOIS  
DEPARTMENT OF TRANSPORTATION

ROUTE NO.	SECTION	COUNTY	TOTAL SHEETS	SHEET NO.
FAP 301	3HBR-2	WINNEBAGO	171	99
FED. ROAD DIST. NO. 7		ILLINOIS	FED. AID PROJECT-	

SHEET NO. 13  
34 SHEETS

Contract No. 64292

NORTH CURB LINE

Location	Station	Offset	Theoretical Grade Elevations
End W. Appr. Pav't.	99197.57	-17.42	751.65
A	99207.57	-17.42	751.78
B	99217.57	-17.42	751.92
Beg. of W. Appr. Pav't.	99227.57	-17.42	752.05

P.G. & NORTH EDGE OF EXTERIOR TRAFFIC LANE

Location	Station	Offset	Theoretical Grade Elevations
End W. Appr. Pav't.	99197.57	-12.00	751.76
A	99207.57	-12.00	751.90
B	99217.57	-12.00	752.03
Beg. of W. Appr. Pav't.	99227.57	-12.00	752.16

☉ ROADWAY & STAGE CONSTRUCTION JOINT

Location	Station	Offset	Theoretical Grade Elevations
End W. Appr. Pav't.	99197.57	0.00	751.95
A	99207.57	0.00	752.08
B	99217.57	0.00	752.22
Beg. of W. Appr. Pav't.	99227.57	0.00	752.35

SOUTH EDGE OF INTERIOR TRAFFIC LANE

Location	Station	Offset	Theoretical Grade Elevations
End W. Appr. Pav't.	99197.57	12.00	751.76
A	99207.57	12.00	751.90
B	99217.57	12.00	752.03
Beg. of W. Appr. Pav't.	99227.57	12.00	752.16

SOUTH EDGE OF EXTERIOR TRAFFIC LANE

Location	Station	Offset	Theoretical Grade Elevations
End W. Appr. Pav't.	99197.57	24.00	751.51
A	99207.57	24.00	751.65
B	99217.57	24.00	751.78
Beg. of W. Appr. Pav't.	99227.57	24.00	751.91

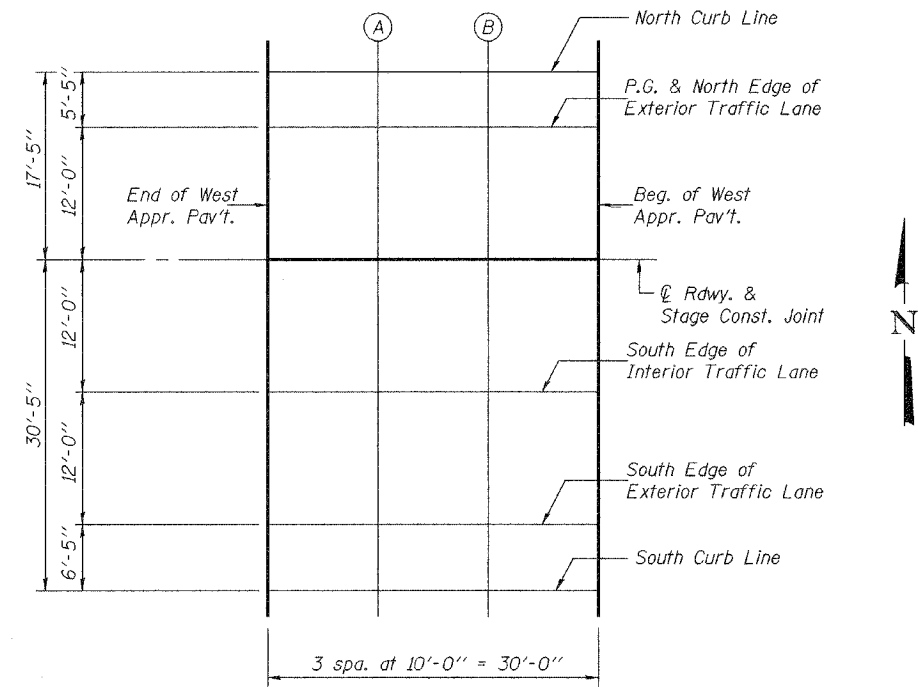

**PLAN**  
West Approach (E.B.)

DESIGNED	Stephen M. Ryan
CHECKED	Fess Teklehaimanot
DRAWN	h.t. duong
CHECKED	SMR/FT

EXAMINED	Thomas J. Domagala ENGINEER OF SOIL DESIGN
PASSED	Ralph E. Anderson ENGINEER OF BRIDGES AND STRUCTURES

Apr. 25, 2008

**TOP OF WEST APPROACH  
SLAB ELEVATIONS (E.B.)  
F.A.P. RTE. 301 - SEC. 3HBR-2  
WINNEBAGO COUNTY  
STATION 993+43.82  
STRUCTURE NO. 101-0065 (E.B.)  
STRUCTURE NO. 101-0066 (W.B.)**