

STATE OF ILLINOIS  
DEPARTMENT OF TRANSPORTATION  
DIVISION OF HIGHWAYS

**PROPOSED  
HIGHWAY PLANS**

F.A.P. ROUTE 754 (IL 76)  
SECTION 101M  
PROJECT F-0754(009)  
BOONE COUNTY  
C-92-029-07

FOR INDEX OF SHEETS, SEE SHEET NO. 2  
FOR STATE STANDARDS, SEE SHEET NO. 2

F.A.P. RTE.	SECTION	COUNTY	TOTAL SHEETS	SHEET NO.
*754	101M	BOONE	48	1
FED. ROAD DIST. NO.	ILLINOIS	CONTRACT NO. 64A45		

(IL 76)

D-92-096-04

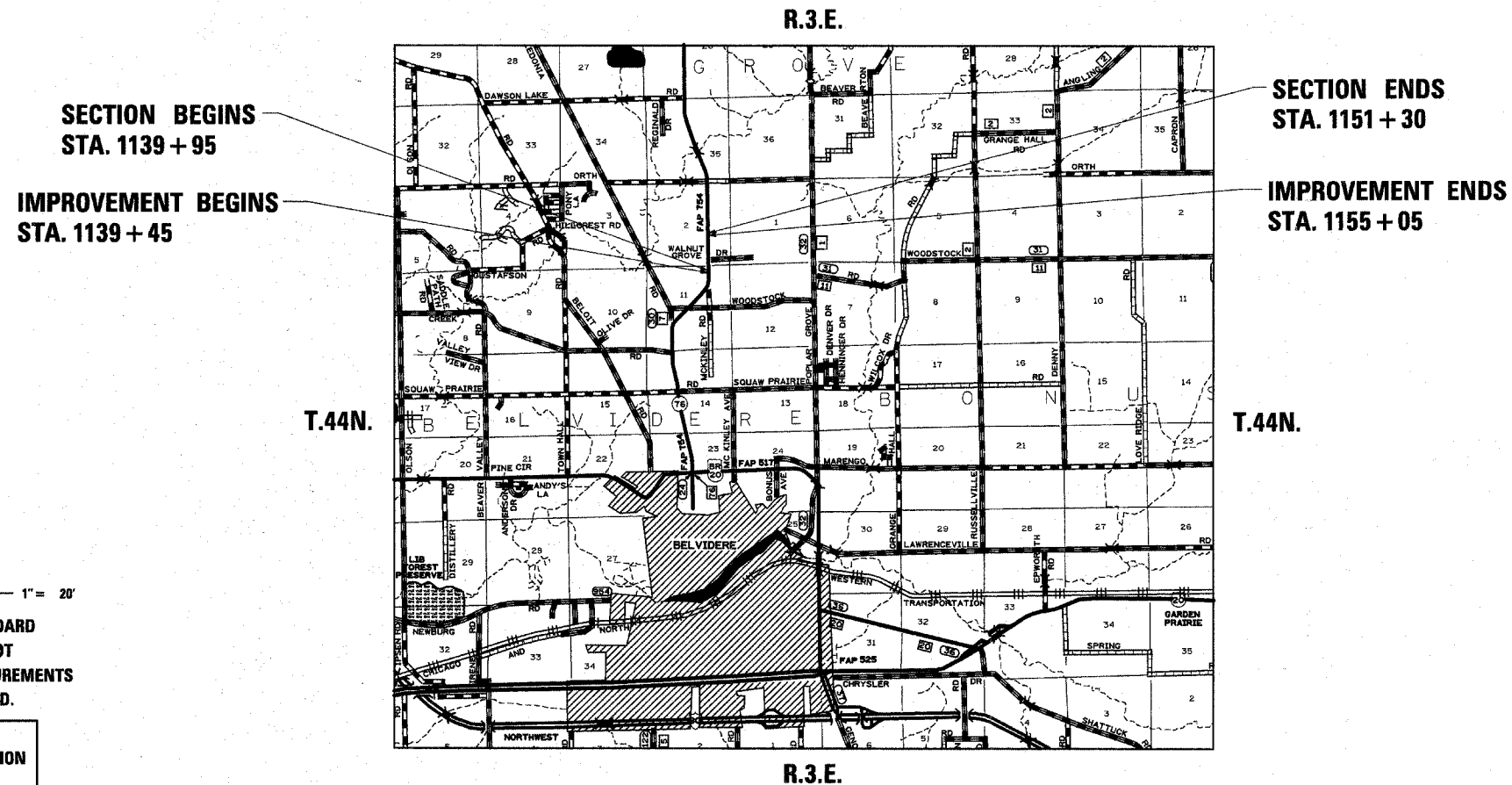
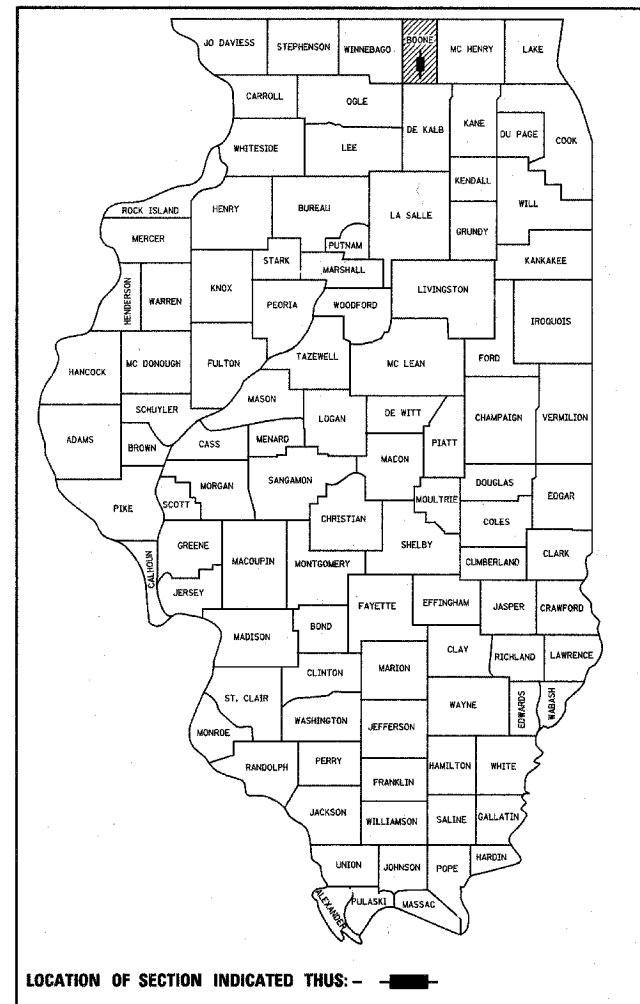

BELVIDERE TOWNSHIP SECTION - 11

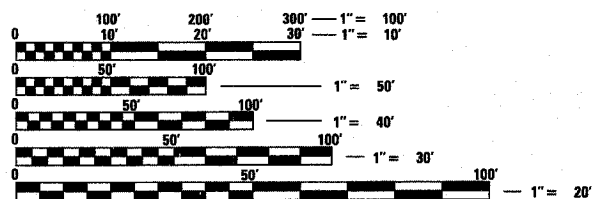

FULL SIZE PLANS HAVE BEEN PREPARED USING STANDARD ENGINEERING SCALES. REDUCED SIZED PLANS WILL NOT CONFORM TO STANDARD SCALES. IN MAKING MEASUREMENTS ON REDUCED PLANS, THE ABOVE SCALES MAY BE USED.

J.U.L.I.E.  
JOINT UTILITY LOCATION INFORMATION FOR EXCAVATION  
1-800-892-0123  
OR 811

PROJECT ENGINEER: MASOOD AHMAD  
SENIOR SQUAD LEADER: SAM ABDULLAH(815)-284-5935  
SQUAD ENGINEER: MATT FARMER(815)-284-5938

CONTRACT NO. 64A45

NET LENGTH OF PROJECT = 1135 LIN. FEET = 0.215 MILES  
GROSS LENGTH OF PROJECT = 1135 LIN. FEET = 0.215 MILES

STATE OF ILLINOIS  
DEPARTMENT OF TRANSPORTATION  
DIVISION OF HIGHWAYS

SUBMITTED March 11, 2008

James F. Brown  
DEPUTY DIRECTOR OF HIGHWAYS, REGION ENGINEER

May 9, 2008  
Eric E. Jarama  
ENGINEER OF DESIGN AND ENVIRONMENT

May 9, 2008  
Christina M. Reed  
DIRECTOR OF HIGHWAYS, CHIEF ENGINEER

**PRINTED BY THE AUTHORITY  
OF THE STATE OF ILLINOIS**