

HORIZONTAL AND VERTICAL CONTROL

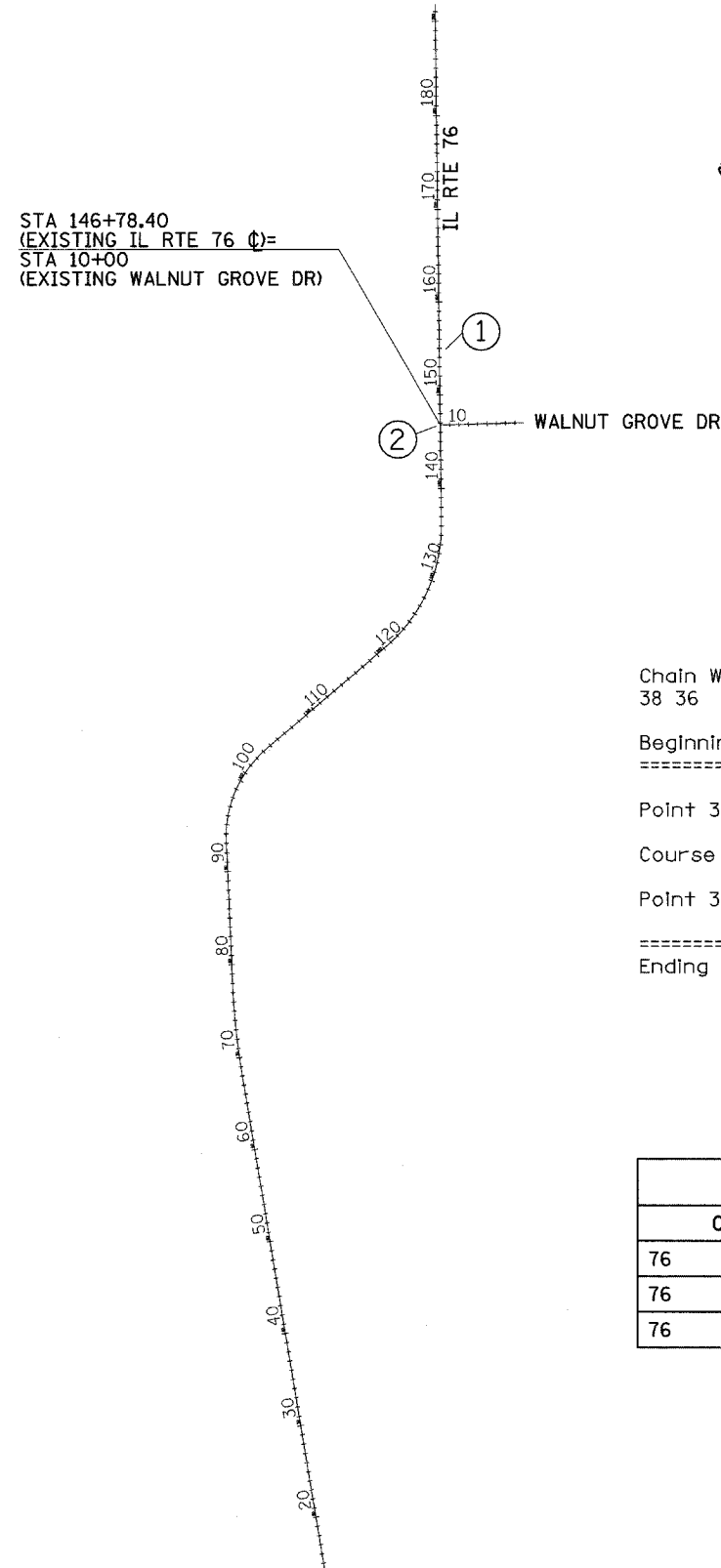

STA 146+78.40
(EXISTING IL RTE 76 Ⓢ)=
STA 10+00
(EXISTING WALNUT GROVE DR)

Chain WALNUTG contains:
38 36

Beginning chain WALNUTG description

Point 38 N 2,059,794.4541 E 2,653,632.4575 Sta 10+00.0000

Course from 38 to 36 88° 28' 07.8289" Dist 883.3033'

Point 36 N 2,059,818.0565 E 2,654,515.4455 Sta 18+83.3033

Ending chain WALNUTG description

CURVE POINT NUMBERS					
CHAIN	CURVE	PI	CC	PC	PT
76	200	200	201	202	203
76	210	210	211	212	213
76	220	220	221	222	223

Chain 76 contains:
20 CUR 200 CUR 210 CUR 220 35

Beginning chain 76 description

Point 20 N 2,047,517.2920 E 2,652,405.2200 Sta 14+30.0281

Course from 20 to PC 200 350° 30' 20.4906" Dist 5,394.4209'

Curve Data

Curve 200
P.I. Station 73+10.9381 N 2,053,317.6452 E 2,651,435.1661
Delta = 6° 53' 49.8501" (RT)
Degree = 0° 42' 35.0292"
Tangent = 486.4891'
Length = 971.8030'
Radius = 8,072.8944'
External = 14.6451'
Long Chord = 971.2163'
Mid. Ord. = 14.6186'
P.C. Station 68+24.4490 N 2,052,837.8200 E 2,651,515.4123
P.T. Station 77+96.2520 N 2,053,803.6346 E 2,651,413.1219
C.C. N 2,054,169.4410 E 2,659,477.7241

Course from PT 200 to PC 210 357° 24' 10.3406" Dist 1,531.4823'

Curve Data

Curve 210
P.I. Station 99+25.2061 N 2,055,930.4021 E 2,651,316.6528
Delta = 51° 58' 56.4009" (RT)
Degree = 4° 40' 31.3708"
Tangent = 597.4719'
Length = 1,111.8310'
Radius = 1,225.4784'
External = 137.8887'
Long Chord = 1,074.0891'
Mid. Ord. = 123.9429'
P.C. Station 93+27.7343 N 2,055,333.5439 E 2,651,343.7259
P.T. Station 104+39.5653 N 2,056,319.3385 E 2,651,770.1956
C.C. N 2,055,389.0739 E 2,652,567.9455

Course from PT 210 to PC 220 49° 23' 06.7415" Dist 1,680.0301'

Curve Data

Curve 220
P.I. Station 129+26.5282 N 2,057,938.2773 E 2,653,658.0572
Delta = 50° 10' 31.2850" (LT)
Degree = 3° 19' 27.2184"
Tangent = 806.9328'
Length = 1,509.3840'
Radius = 1,723.5819'
External = 179.5406'
Long Chord = 1,461.6135'
Mid. Ord. = 162.6027'
P.C. Station 121+19.5954 N 2,057,412.9881 E 2,653,045.5119
P.T. Station 136+28.9794 N 2,058,745.1334 E 2,653,646.9294
C.C. N 2,058,721.3647 E 2,651,923.5114

Course from PT 220 to 35 359° 12' 35.4565" Dist 5,543.9532'

Point 35 N 2,064,288.5594 E 2,653,570.4766 Sta 191+72.9326

Ending chain 76 description