

F.A.P. RTE.	SECTION	COUNTY	TOTAL SHEETS	SHEET NO.
17	15T-2	CARROLL	71	22
STA.		TO STA.		
FED. ROAD DIST. NO.		ILLINOIS FED. AID PROJECT		

# STA. 1240+74 6'x5' DOUBLE BOX CULVERT

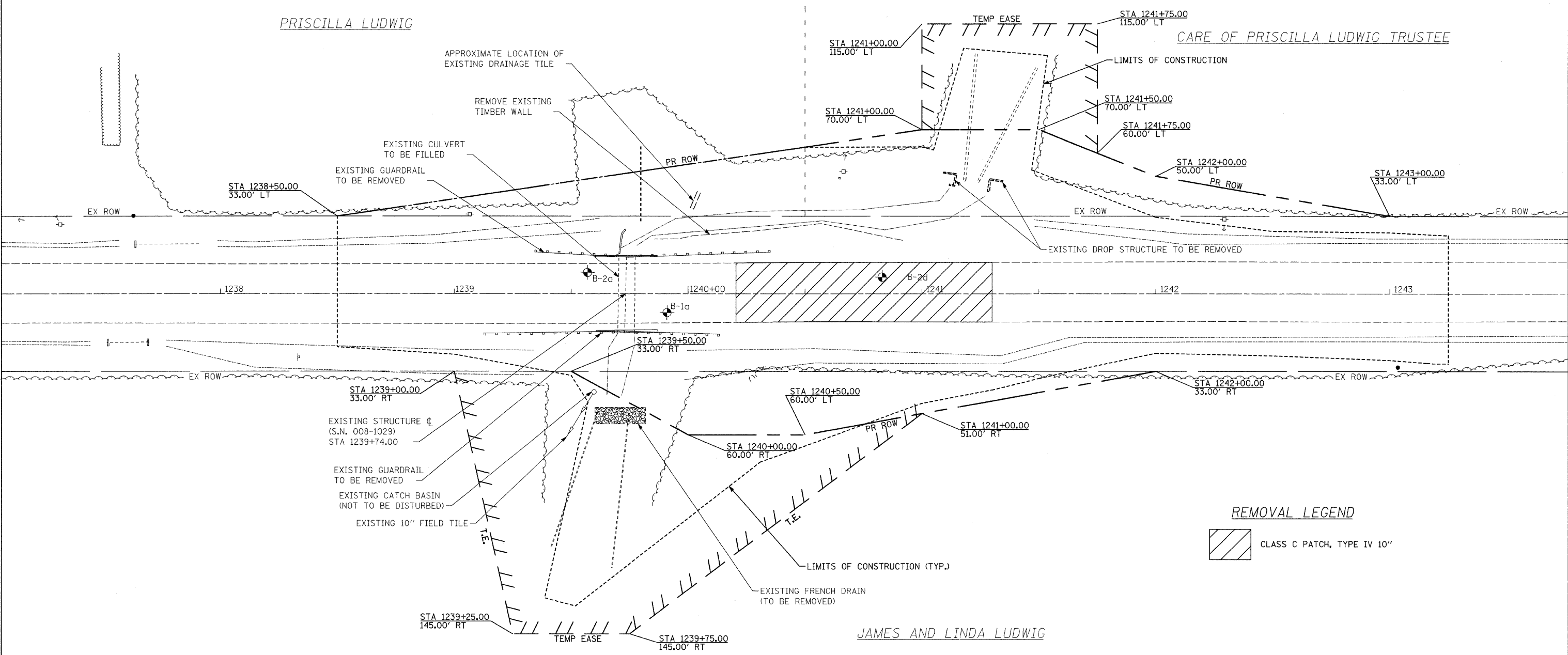

**REMOVAL LEGEND**  
 CLASS C PATCH, TYPE IV 10"

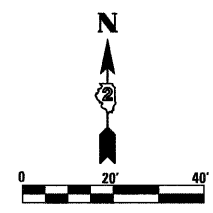

REVISIONS	
NAME	DATE

ILLINOIS DEPARTMENT OF TRANSPORTATION

SCALE: VERT. \_\_\_\_\_  
 HORIZ. \_\_\_\_\_

DATE \_\_\_\_\_

DRAWN BY: JDS  
 CHECKED BY: RJA

PLOT DATE = Mon Jan 28 08:54:19 2008  
 FILE NAME = I:\Projects\Carroll\64C35\1164\1164.L73.to.0gle.coo\Ina Henson\proj\est.Fila Maurer\Stutz\Final.plans\Revised\1078066RCKG.dwg  
 PLOT SCALE = 28.0000' / IN.  
 USER NAME = hensonk