

STATE OF ILLINOIS  
DEPARTMENT OF TRANSPORTATION

ROUTE NO.	SECTION	COUNTY	TOTAL SHEETS	SHEET	SHEET NO.
F.A.P. 301	29T-1	JO DAVIESS	30	13	9 SHEETS
FED. ROAD DIST. NO. 7	SUB. PROJ.	FED. AID PROJ. NO.			

Contract #64C58

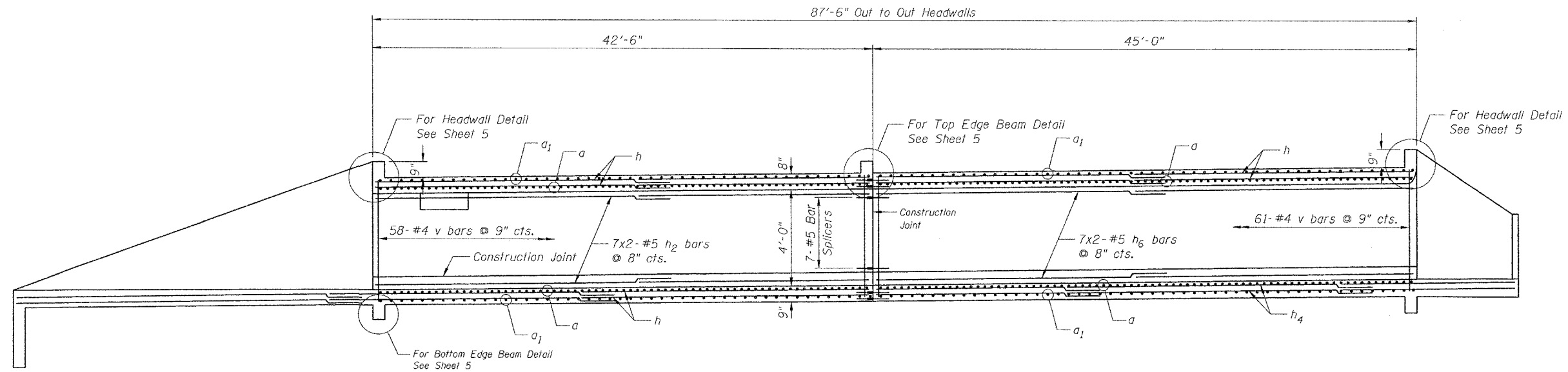

**LONGITUDINAL SECTION  
CENTER WALL**

(Looking North)

\*Measured Perpendicular to Roadway

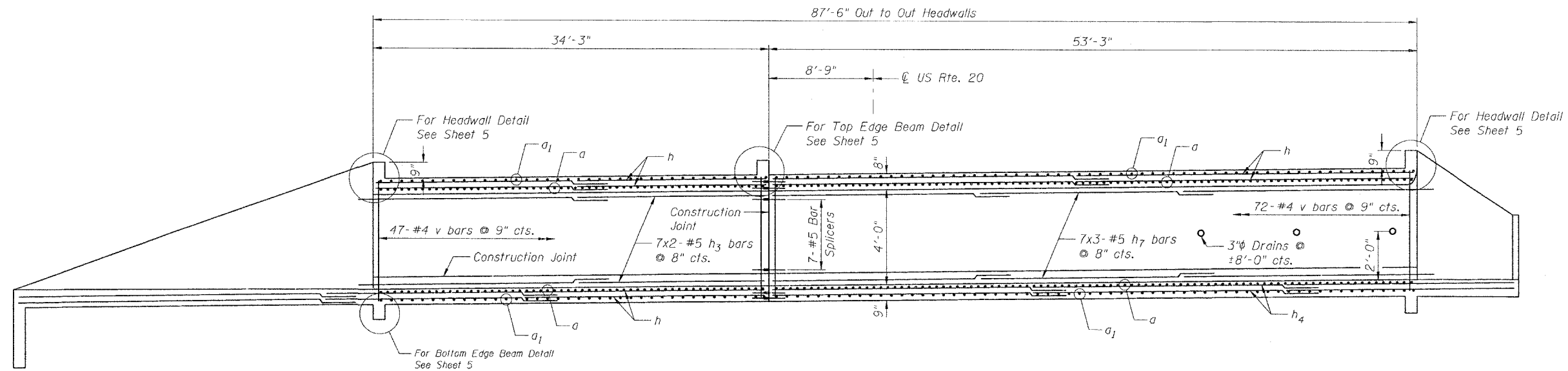

**LONGITUDINAL SECTION  
SOUTH WALL**

(Looking North)

\*Measured Perpendicular to Roadway

**NOTES**

1. Bars indicated thus: 7x2-#5 etc. indicates 7 lines of bars with 2 lengths per line.
2. Minimum Bar Laps (Unless noted otherwise)

Barrels

#4 bars	1'-4"
#5 bars	1'-8"
#6 bars	2'-0"

DESIGNED	LAS
CHECKED	DAZ
DRAWN	SAW
CHECKED	LAS

**CULVERT SECTIONS  
US ROUTE 20/IL ROUTE 84  
OVER UNNAMED TRIBUTARY  
TO SMALLPOX CREEK  
F.A.P. 301 SECTION 29T-1  
JO DAVIESS COUNTY  
STATION 924+32.00  
STRUCTURE NO. 043-1077**