

F.A.S. RTE.	SECTION	COUNTY	TOTAL SHEETS	SHEET NO.
1177	(110,111)T	LEE	59	16
STA.		TO STA.		
FED. ROAD DIST. NO.		ILLINOIS FED. AID PROJECT		

STA. 277 + 15 DOUBLE 54" EQUIVALENT ARCH PIPE CULVERT

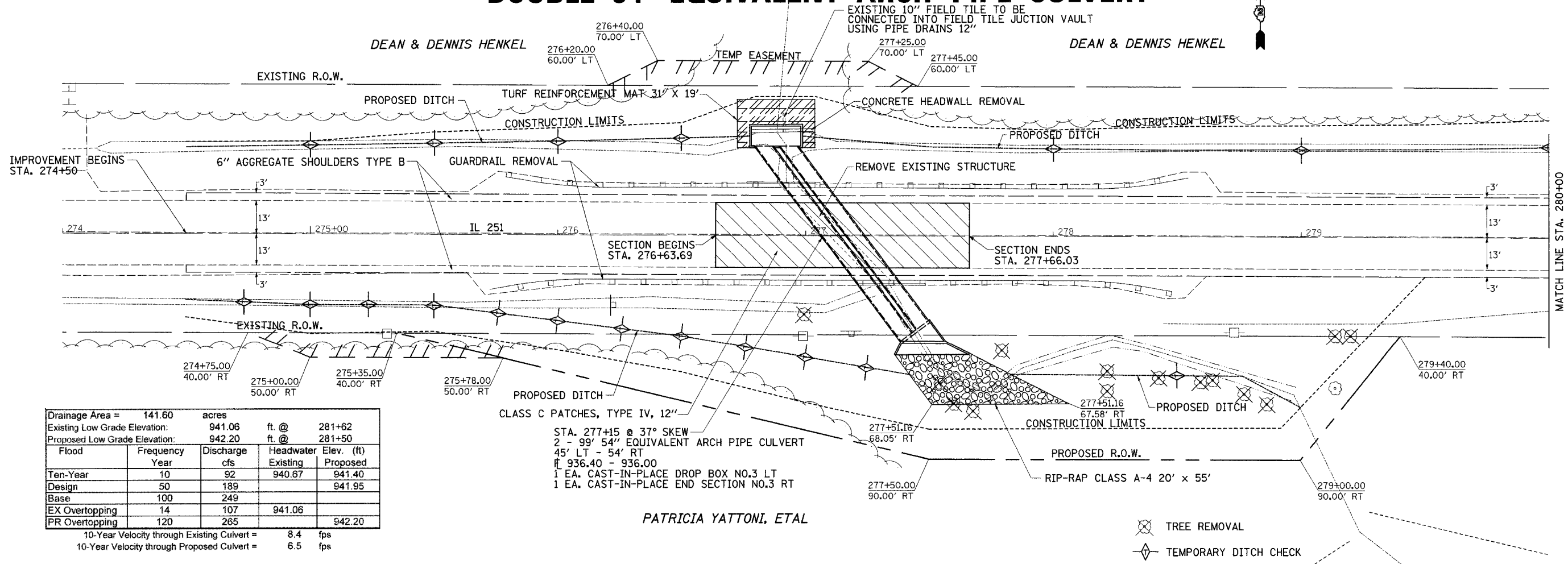

Drainage Area =	141.60	acres			
Existing Low Grade Elevation:	941.06	ft. @ 281+62			
Proposed Low Grade Elevation:	942.20	ft. @ 281+50			
Flood Year	Frequency	Discharge	Headwater Elev. (ft)	Existing	Proposed
Ten-Year	10	92	940.67	941.40	
Design	50	189		941.95	
Base	100	249			
EX Overtopping	14	107	941.06		
PR Overtopping	120	265		942.20	

10-Year Velocity through Existing Culvert = 8.4 fps
 10-Year Velocity through Proposed Culvert = 6.5 fps

STA. 277+15 @ 37° SKEW
 2 - 99' 54" EQUIVALENT ARCH PIPE CULVERT
 45' LT - 54' RT
 1 EA. CAST-IN-PLACE DROP BOX NO.3 LT
 1 EA. CAST-IN-PLACE END SECTION NO.3 RT

PATRICIA YATTONI, ETAL

- TREE REMOVAL
- TEMPORARY DITCH CHECK

DATE: _____
 BY: _____
 SURVEYED _____
 ALIGNED _____
 CHECKED _____
 NOTE BOOK NO. _____
 DATE FILED _____

DATE: _____
 BY: _____
 PROFILE SURVEYED _____
 GRADES CHECKED _____
 NOTE BOOK NO. _____
 STRUCTURE NOTATIONS CHECKED _____

DATE: Tue Feb 26 10:28:55 2008
 FILE NAME: c:\projects\2008\1177\1177.dwg
 USER: jay

