

# HORIZONTAL AND VERTICAL CONTROL

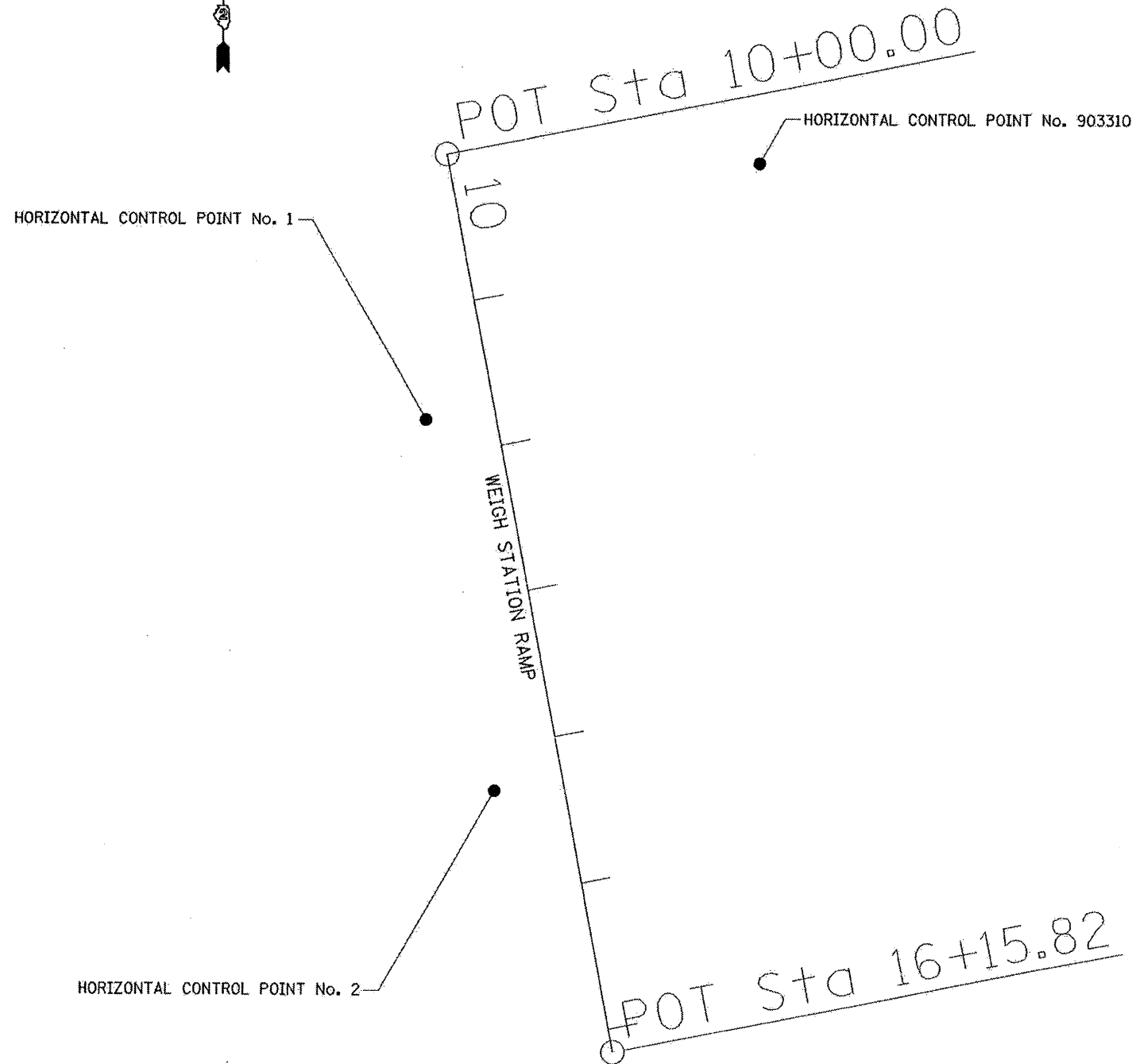

Chain EBSCALE contains:  
1000 1001

Beginning chain EBSCALE description

Point 1000 N 1,781,161.6483 E 2,248,421.2847 Sta 10+00.0000

Course from 1000 to 1001 169° 02' 14.0783" Dist 615.8221'

Point 1001 N 1,780,557.0643 E 2,248,538.3961 Sta 16+15.8221

Ending chain EBSCALE description

FILE NAME =  
c:\projects\p202908\vd02908hvc.dgn

USER NAME = ditzlorva  
PLOT SCALE = 50.0000' / 1" L  
PLOT DATE = Wed Mar 12 13:12:06 2008

DESIGNED -  
DRAWN -  
CHECKED -  
DATE -

REVISED -  
REVISED -  
REVISED -  
REVISED -

**STATE OF ILLINOIS  
DEPARTMENT OF TRANSPORTATION**

**HORIZONTAL AND VERTICAL CONTROL**

SCALE: SHEET NO. OF SHEETS STA. TO STA.

F.A.I. RTE.	SECTION	COUNTY	TOTAL SHEETS	SHEET NO.
80	081-1WS-2M-1	ROCK ISLAND	18	7
FED. ROAD DIST. NO. ILLINOIS FED. AID PROJECT			CONTRACT NO. 64D93	