

PAVEMENT ELEVATIONS

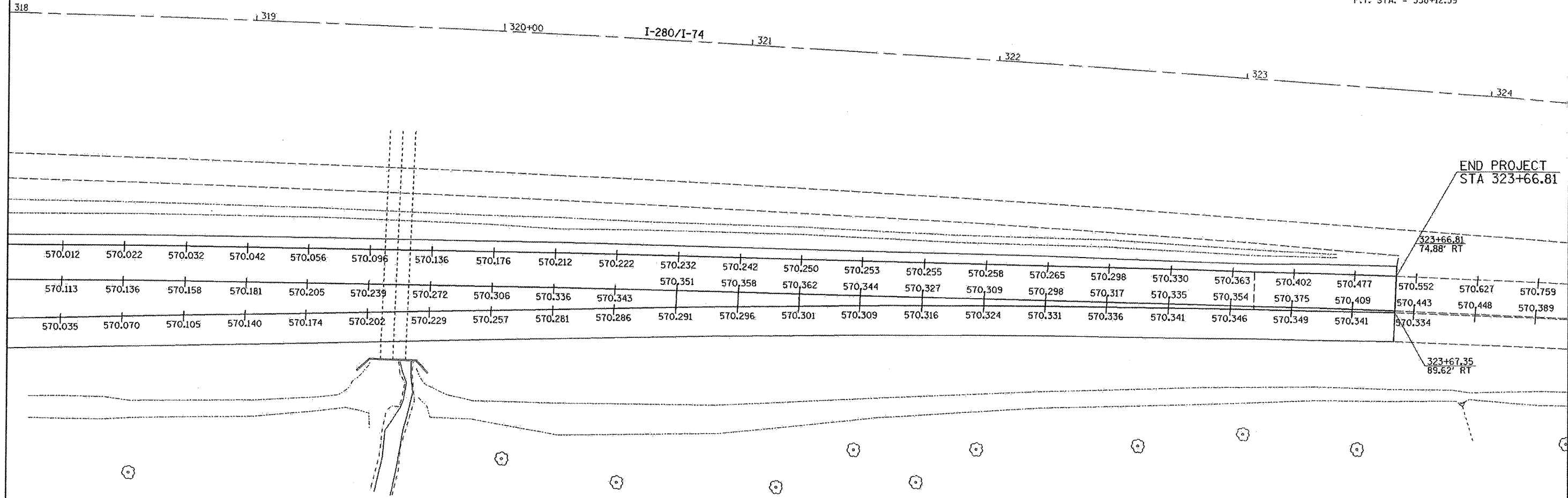

EXIST. CURVE 310
 PI STA. = 325+48.73
 $\Delta = 12^\circ 40' 58''$ (RT)
 $D = 0^\circ 29' 59''$
 $R = 11,464.32'$
 $T = 1,274.07'$
 $L = 2,537.72'$
 $E = 70.58'$
 $e = \text{-----}$
 $T.R. = \text{-----}$
 $S.E. \text{ RUN} = \text{-----}$
 $P.C. \text{ STA.} = 312+74.67$
 $P.T. \text{ STA.} = 338+12.39$



Station	Offset from I-74/I280 Left EOP of RAMP	LT	14' Joint	Offset from I-74/I280 Right EOP of RAMP	RT	Total Pavement Width
31825	92.38	570.012	570.113	121.42	570.035	29.04
31850	91.78	570.022	570.136	120.16	570.070	28.37
31875	91.19	570.032	570.158	118.90	570.105	27.71
31900	90.60	570.042	570.181	117.64	570.140	27.04
31925	89.98	570.056	570.205	116.18	570.174	26.20
31950	89.35	570.096	570.239	114.72	570.202	25.37
31975	88.73	570.136	570.272	113.26	570.229	24.53
32000	88.10	570.176	570.306	111.80	570.257	23.70
32025	87.41	570.212	570.336	110.15	570.281	22.73
32050	86.73	570.222	570.343	108.49	570.286	21.76
32075	86.04	570.232	570.351	106.84	570.291	20.80
32100	85.35	570.242	570.358	105.18	570.296	19.83
32125	84.50	570.250	570.362	103.59	570.301	19.09

Station	Offset from I-74/I280 Left EOP of RAMP	LT	14' Joint	Offset from I-74/I280 Right EOP of RAMP	RT	Total Pavement Width
32150	83.64	570.253	570.344	102.00	570.309	18.35
32175	82.79	570.255	570.327	100.41	570.316	17.62
32200	81.94	570.258	570.309	98.81	570.324	16.88
32225	80.89	570.265	570.298	97.40	570.331	16.51
32250	79.84	570.298	570.317	95.98	570.336	16.13
32275	78.80	570.330	570.335	94.56	570.341	15.76
32300	77.75	570.363	570.354	93.14	570.346	15.39
32325	76.76	570.402	570.375	91.94	570.349	15.19
32350	75.76	570.477	570.409	90.74	570.341	14.99
32375	74.76	570.552	570.443	89.54	570.334	14.78
32400	73.76	570.627	570.448	88.34		14.58
32425		570.759	570.389			

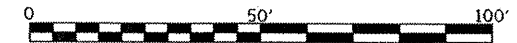

FILE NAME = c:\projects\p203008\vd03008shts.dgn	USER NAME = ditzleraa	DESIGNED -	REVISED -
		DRAWN -	REVISED -
		CHECKED -	REVISED -
		DATE -	REVISED -

**STATE OF ILLINOIS
 DEPARTMENT OF TRANSPORTATION**

PAVEMENT ELEVATIONS

SCALE: SHEET NO. OF SHEETS STA. TO STA.

F.A.I. RTE. 74	SECTION 181-3WSM-1	COUNTY ROCK ISLAND	TOTAL SHEETS 13	SHEET NO. 13
CONTRACT NO. 64D94			FED. ROAD DIST. NO. ILLINOIS FED. AID PROJECT	