

Bench Mark: Chiseled "X" N.W. Wingwall S.N. 098-0080, Elev. 631.397.

Existing Structure: S.N. 098-0079 & 098-0080 built in 1972 as F.A Route 403, Sec. 195-3B-3 at Sta. 2238+50.00.
 Each dual structure consists of an (8)-span, 3-unit (2-span, 4-span, 2-span), reinforced concrete deck on 3 steel box girders, with pile bent spill thru abutments and pile supported solid wall piers.
 Length is 1200' bk. to bk. of abutments, and the width is 42'-0" out to out of deck. Concrete deck to be removed and replaced.
 The contractor shall temporarily brace the box girders during removal and reconstruction. Traffic shall be maintained by crossovers.

No salvage

STATE OF ILLINOIS
 DEPARTMENT OF TRANSPORTATION

ROUTE NO.	SECTION	COUNTY	TOTAL SHEETS	SHEET NO.
FAI 88	195-3B-D	WHITESIDE		3 / SHEETS
FED. ROAD DIST. NO. 7	ILLINOIS	FED. AID PROJECT		

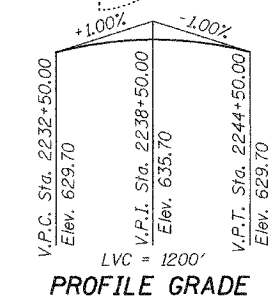
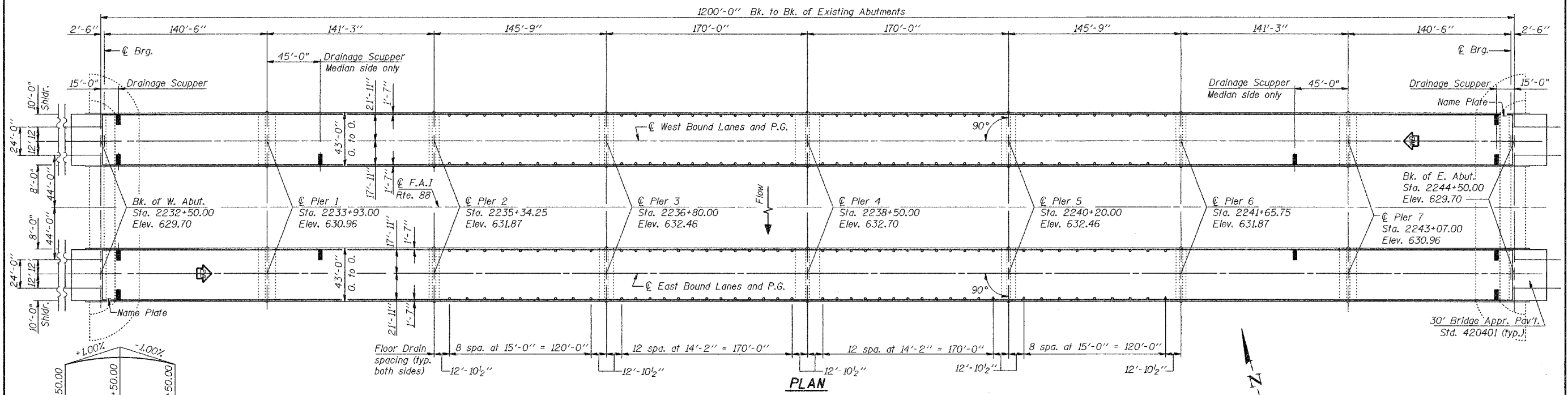
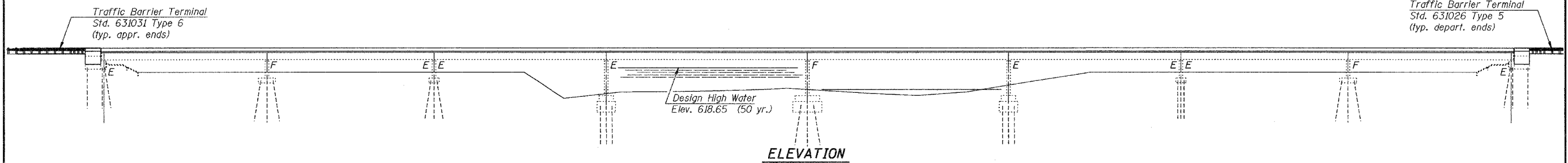

LOADING HS20-44 & ALT.
 Allow 50#/sq. ft. for future wearing surface.
DESIGN SPECIFICATIONS
 1996 AASHTO with 1997, 1998, 1999 & 2000 Interims

DESIGN STRESSES

FIELD UNITS Existing Structure	FIELD UNITS New Construction
$f_c = 1,200$ psi (Slab)	$f_c = 3,500$ psi
$f_c = 1,400$ psi (Substructure)	$f_y = 60,000$ psi (Reinforcement)
$f_s = 20,000$ psi (Reinforcement)	$f_y = 36,000$ psi (M 270 Grade 36)
$f_y = 36,000$ psi (Structural Steel)	$f_y = 50,000$ psi (M 270 Grade 50)
$v = 75$ psi (Footings)	

SEISMIC DATA
 Seismic Performance Category (SPC) = A
 Bedrock Acceleration Coefficient (A) = 0.034g
 Site Coefficient (S) = 1.2

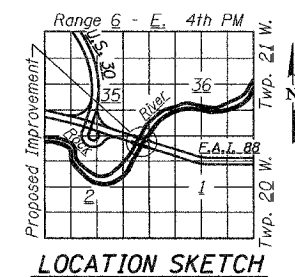

GENERAL PLAN
 F.A.I. ROUTE 88 OVER
 ROCK RIVER
 PUBLIC WATER
 F.A.I. ROUTE 88 - SECTION 195-3B-D
 WHITESIDE COUNTY
 STATION 2238+50.00
 STRUCTURE NO. 098-0079 (E.B.)
 STRUCTURE NO. 098-0080 (W.B.)

FOR INFORMATION ONLY

DESIGNED	December 13 2001
CHECKED	EXAMINED
DRAWN R. Sommer	ENGINEER OF BRIDGE DESIGN
CHECKED	PASSED
	ENGINEER OF BRIDGES AND STRUCTURES

EXPIRES 11-30-2002

FILE NAME =	USER NAME = #USER#	DESIGNED -	REVISED -	STATE OF ILLINOIS DEPARTMENT OF TRANSPORTATION	EXISTING PLAN VIEW AND ELEVATION	F.A. RTE.	SECTION	COUNTY	TOTAL SHEETS	SHEET NO.	
#FILE#		DRAWN	REVISED			88	(195-3B-3M-1)	Whiteside	8	6	
	PLOT SCALE = #SCALE#	CHECKED	REVISED			SCALE: _____ SHEET NO. OF _____ SHEETS STA. _____ TO STA. _____					
	PLOT DATE = #DATE#	DATE	REVISED			FED. ROAD DIST. NO. ILLINOIS FED. AID PROJECT CONTRACT NO. 64D97					